

SENCOR®

Let's live!

SCA MH01

Wireless charging car mount

INSTRUCTIONS FOR USE



Wireless charging car mount SCA MH01



The wireless charging car mount is compatible with all devices according to the Qi standard. Other devices may not support the wireless charging feature.

ATTENTION:

The charging mount should not obstruct the car driver's view or limit the driving. For appropriate mount location, please follow the regulations and laws in force for your country and the countries where your vehicle is supposed to move.

Installation

You can attach the charging mount using two following methods:

Mount installation - attachment on the car dashboard ventilation grid

- Assembly individual parts according to the drawing and adjust the mount position.
- Press the mount feet to open the clip and insert the clip's feet onto the ventilation grid opening on the car dashboard. If needed, adjust the mount position by loosening/tightening the joint threaded nut located at the mount back.

ATTENTION:

Proceed carefully and make sure that the type of your ventilation grids is suitable for fitting these mobile phone mounts. This will prevent damage to the ventilation grids and the car's dashboard.

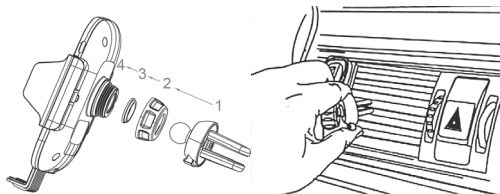

Installing telescopic mount - attachment the suction cup

- Assemble individual parts according to the drawing and adjust the mount position.
- The mount suction cup area must be cleaned and degreased in advance. Release the suction cup, put it on the desired area without projections and press it against flat surface with the locking lever. To remove the mount attached to the surface, first release the locking lever, then lift the suction cup's soft part.
- If needed, adjust the mount position by loosening/tightening the joint threaded nut located at the mount back.

Tip: If the mount's suction cup gets blocked by dust or other dirt, wash it with lukewarm water.

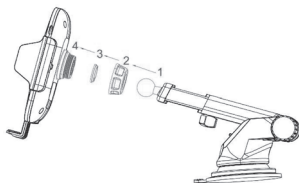

Inserting and removing your mobile phone in/from the mount

- Connect the charging cable to the mount, then connect the other end to your car's socket. For fast wireless charging, a Qualcomm fast charging adapter should be used.
- Approaching your mobile phone to the mount will enable the infrared sensor, making the mount open automatically for you to insert your mobile phone easily. When the phone is inserted in the mount, the mount jaws will close automatically and the wireless charging will start.

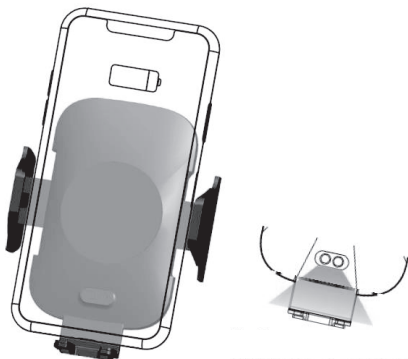

- To remove the mobile phone from the mount, press the side buttons located on both sides at the mount's bottom. When the button is pressed, the mount jaws will automatically open and release the phone.

Note:

First, make sure that your mobile phone supports wireless charging feature and has no buttons in the area pressed by the mount. To preserve correct functionality, the infrared sensor must be kept clean and free of defects. For successful wireless charging, it's recommended to use a mobile phone with original rear cover and without protective case or stickers (such as magnetic ones).

ATTENTION:

Never handle the mount with your mobile phone inserted while the vehicle is in motion.

LED indicator

The LED indicator shows the following states:

- The red colour indicates that an incompatible device has been inserted (without wireless charging support) and no wireless charging takes place.
- The blue colour indicates charging in progress or fully charged state.

Specifications

Automatically opening mount for phones with wireless charging
The charging is compatible with smart phones supporting the Qi standard

Charging

Qi wireless charging technology
Fast wireless charging support - Samsung 10 W / iPhone 7.5W

Mount

Automatic infrared sensor for mount opening
Easy one-hand handling
Mount for window and ventilation outlet installation
Swivelling in 360 degrees

Specification

Input: 5V/2A, 9V/1.67A
Output: 5V/1.5 A, 9V/1.2 A
USB adapter requirements (not included in supply)
Standard charging (5W) - USB adapter 5V/2A min.
Fast charging (7.5-10W) - USB adapter compatible with the Quick Charge 3.0/2.0

Package contents:

1 x mount with wireless charger
1 x 1m USB-C cable
1 x Ventilation fastener
1 x Window fastener
1 x User's manual

INSTRUCTIONS AND INFORMATION ON DISPOSING OF USED PACKAGING MATERIALS

Dispose of used packaging material at a site designated for waste in your municipality.

DISPOSING OF USED ELECTRICAL AND ELECTRONIC EQUIPMENT



This symbol on products or original documents means that used electric or electronic products must not be added to ordinary municipal waste. Take these products to authorized collection points for proper disposal, renewal and recycling. Or in some European Union states or other European countries the products can be returned to the local retailer when buying an equivalent new product. Disposing of this product correctly helps save valuable natural resources and prevents damage to the environment by improper waste disposal. Ask your local authorities or collection facility for more details. In accordance with national regulations penalties may be imposed for the incorrect disposal of this type of waste.

For business entities in European Union states

If you want to dispose of electric or electronic devices, ask your retailer or supplier for the necessary information.

Disposal in other countries outside the European Union

This symbol is valid in the European Union. If you wish to dispose of this product, request the necessary information about the correct disposal method from the local council or from your retailer.



This appliance meets all the basic requirements of the EU directives.

The text, design and technical specifications may be changed without prior notice and we reserve the right to make these changes.

The original version is in the Czech language.

Address of the manufacturer:

FAST ČR, a.s., Černokostecká 1621, Říčany CZ-251 01

Warranty conditions

Warranty card is not a part of the device packaging.

This product is warranted for the period of 24 months from the date of purchase to the end-user. Warranty is limited to the following conditions. Warranty is referred only to the customer goods using for common domestic use. The claim for service can be applied either at dealer's shop where the product was bought, or at below mentioned authorized service shops. The end-user is obligated to set up a claim immediately when the defects appeared but only till the end of warranty period. The end user is obligated to cooperate to certify the claiming defects. Only completed and clean (according to hygienic standards) product will be accepted. In case of eligible warranty claim the warranty period will be prolonged by the period from the date of claim application till the date of taking over the product by end-user, or the date the end-user is obligated to take it over. To obtain the service under this warranty, end-user is obligated to certify his claim with duly completed following documents: receipt, certificate of warranty, certificate of installation.

This warranty is void especially if apply as follows:

- Defects which were put on sale.
- Wear-out or damage caused by common use.
- The product was damaged by unprofessional or wrong installation, used in contrary to the applicable instruction manual, used in contrary to legal enactment and common process of use or used for another purpose which has been designed for.
- The product was damaged by uncared-for or insufficient maintenance.
- The product was damaged by dirt, accident of force majeure (natural disaster, fire, and flood).
- Defects on functionality caused by low duality of signal, electromagnetic field interference etc.
- The product was mechanically damaged (e.g. broken button, fall).
- Damage caused by use of unsuitable media, fillings, expendable supplies (batteries) or by unsuitable working conditions (e.g. high temperatures, high humidity, quakes).
- Repair, modification or other failure action to the product by unauthorized person.
- End-user did not prove enough his right to claim (time and place of purchase).
- Data on presented documents differs from data on products.
- Cases when the claiming product cannot be indentified according to the presented documents (e.g. the serial number or the warranty seal has been damaged).

Authorized service centers

Visit **www.sencor.eu** for detailed information about authorized service centers.