

SENCOR®

SCD-5035MR

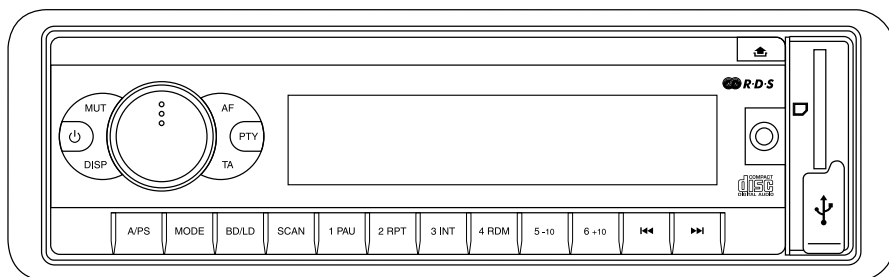

**CAR STEREO CD/CDR/CDRW/MP3/WMA PLAYER WITH PLL FM STEREO RADIO / RDS
USB / SD / MMC CARD INPUT / FRONT AUX IN
FLIP DOWN/DETACHABLE FRONT PANEL**

**STEREO SYSTÉM DO AUTOMOBILU S PŘEHRAVAČEM CD/CDR/CDRW/MP3/WMA
RÁDIOPŘIJÍMAČ PLL FM STEREO/RDS
VSTUP PRO USB/SD/MMC KARTY, PŘEDNÍ VSTUP AUX
VYKLÁPĚCÍ A ODNÍMACÍ ČELNÍ PANEL**

**STEREO SYSTÉM DO AUTOMOBILU S PREHRAVAČOM CD/CDR/CDRW/MP3/WMA
RÁDIOPRIJÍMAČ PLL FM STEREO/RDS
VSTUP PRE USB/SD/MMC KARTY, PREDNÝ VSTUP AUX
VYKLÁPAČÍ A ODNÍMATELNÝ ČELNÝ PANEL**

**AUTÓS SZTEREORENDSZER CD/CDR/CDRW/MP3/WMA
LEJÁTSZÓVAL PLL FM SZTEREO/RDS RÁDÍÓ
USB/SD/MMC KÁRTYA BEMENET, ELÜLSŐ AUX BEMENET
KIHAJTHATÓ ÉS LEVEHETŐ ELŐLAP**

**STEREOFONICZNY SYSTEM SAMOCHODOWY Z ODTWARZACZEM CD/CDR/CDRW/MP3/WMA
RADIOODBIORNNIK PLL FM STEREO/RDS
WEJŚCIE NA KARTY USB/SD/MMC, PRZEDNIE WEJŚCIE AUX
ODCHYLANY I ZDEJMOWANY PANEL PRZEDNI**

**АВТОМОБИЛЬНАЯ СТЕРЕОМАГНИТОЛА CD/CDR/CDRW/MP3/WMA
С РАДИОПРИЕМНИКОМ FM И СИСТЕМОЙ ФАЗОВОЙ АВТОПОДСТРОЙКИ ЧАСТОТ / RDS
РАЗЪЕМ USB / SD / MMC CARD / ВХОДНОЙ РАЗЪЕМ AUX IN НА ПЕРЕДНЕЙ ПАНЕЛИ
ОТКИДАЮЩАЯ/СЪЕМНАЯ ПЕРЕДНЯЯ ПАНЕЛЬ**

**AUTOMOBILINIS STEREOFONINIU CD/CDR/CDRW/MP3/WMA GROTUVAS
SU PLL FM STEREOFONINIŲ RADIJUMI / RDS
USB / SD / MMC KORTELIJŲ ĮVESTIES LIZDAS / PRIEKINIS PAGALBINIS ĮVESTIES LIZDAS
ATVERČIAMAS/NUIMAMAS PRIEKINIS SKYDELIS**

EN

CZ

SK

HU

PL

RU

LT

LOCATION OF PARTS AND CONTROLS

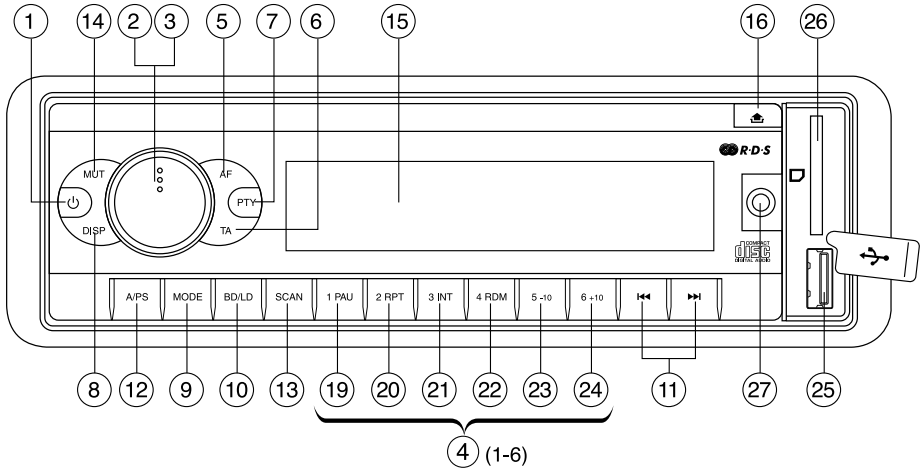

1. POWER ON/OFF (⏻)
2. FUNCTION SELECT BUTTON: BASS/TREBLE/BALANCE/FADER/TA SEEK/PI SOUND/RETUNE/MASK DPI/EON/BEEP/TA VOL/ADJ TIME/AUDIO DSP
3. VOL UP/VOL DOWN FOR BASS/TREBLE/BALANCE/FADER/TA SEEK/PI SOUND/RETUNE/MASK DPI/EON/BEEP/TA VOL/ADJ TIME/AUDIO DSP
4. PRESET STATIONS (1,2,3,4,5,6)
5. 'AF' function (ALTERNATIVE FREQUENCIES)
6. 'TA' function (TRAFFIC ANNOUNCEMENT)
7. 'PTY' function (PROGRAM TYPE)
8. DISPLAY BUTTON (DISP)
9. MODE BUTTON (MODE)
10. BAND/LOUDNESS BUTTON (BD/LD)
11. AUTOMATIC OR MANUAL TUNING (FREQ UP ►► OR FREQ DOWN ◀◀)/ CD TRACK/SEARCH BUTTON
12. AUTO SEEK SEARCH TUNING (A/PS)
13. 'SCAN' AUTOMATIC TUNING CONTROL (SCAN)
14. MUTE BUTTON (MUT)
15. LCD DISPLAY
16. PANEL RELEASE BUTTON (🔒)
17. CD SLOT
18. CD EJECT BUTTON (⏏)
19. PAUSE BUTTON
20. REPEAT BUTTON
21. INTRO BUTTON (Preview all Tracks)
22. RANDOM BUTTON
- 23, 24. + 10 TRACK SEARCH DOWN/UP
25. USB PORT
26. MULTI-MEDIA CARD (MMC) / SD CARD SLOT
27. FRONT AUX IN

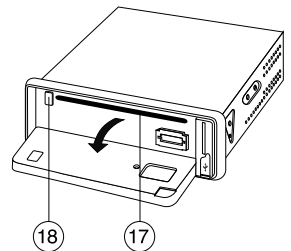

ISO CONNECTOR

RCA Line Out: Red (right) White (left)

CONNECTOR A

4. MEMORY +12V
5. AUTO ANTENNA OUTPUT
7. +12V (TO IGNITION KEY)
8. GROUND

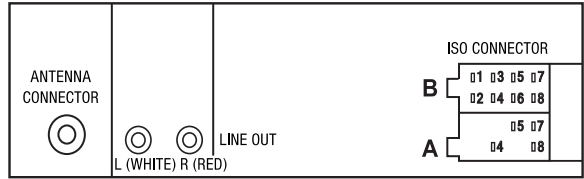

Note: (connector A no. 7) must be connected by car ignition key in order to avoid that car battery becomes weak when the car will be not used for long period.

CONNECTOR B

1. REAR RIGHT SPEAKER (+)
2. REAR RIGHT SPEAKER (-)
3. FRONT RIGHT SPEAKER (+)
4. FRONT RIGHT SPEAKER (-)
5. FRONT LEFT SPEAKER (+)
6. FRONT LEFT SPEAKER (-)
7. REAR LEFT SPEAKER (+)
8. REAR LEFT SPEAKER (-)

Maintenance

FUSE REPLACEMENT

If the fuse blows, check the power connection and replace the fuse. If the fuse blows again after the replacement, there may be an internal malfunction. In this case, consult your nearest repairing center.

Warning

Use the specified amperage fuse for each lead. Use of a higher amperage fuse may cause serious damage.

INSTALLATION

PRECAUTIONS

- Choose the mounting location carefully so that the unit will not interfere with the normal driving functions of the driver.
- Avoid installing the unit where it would be subject to high temperatures, such as from direct sunlight or hot air from the heater, or where it would be subject to dust, dirt or excessive vibration.
- Use only the supplied mounting hardware for a safe and secure installation.
- Be sure to remove the front panel before installing the unit.

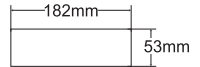

NOTE: Inclination angle for car radio installation must not exceed 30° otherwise the front panel will not open.

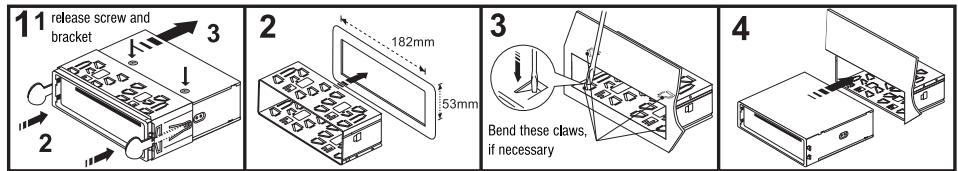

Note: Keep the release key in a safe place as you may need it in future to remove the unit from the car.

TO SUPPORT THE UNIT

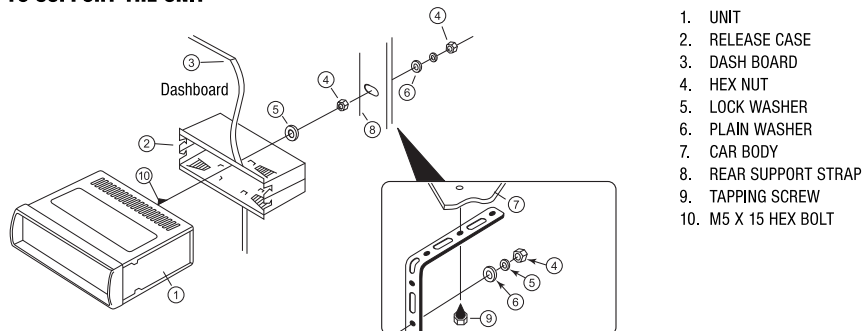



1. UNIT
2. RELEASE CASE
3. DASH BOARD
4. HEX NUT
5. LOCK WASHER
6. PLAIN WASHER
7. CAR BODY
8. REAR SUPPORT STRAP
9. TAPPING SCREW
10. M5 X 15 HEX BOLT

Detaching and attaching the front panel

The front panel of this unit can be detached in order to prevent the unit from being stolen.

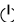
FOLDING DOWN AND DETACHING/ATTACHING THE FRONT PANEL

Before detaching the front panel, be sure to press the  button (1) OFF first.

Then press the  button (16), let the Front Panel arrive in horizontal position and detach the panel by pulling it towards you as illustrated.

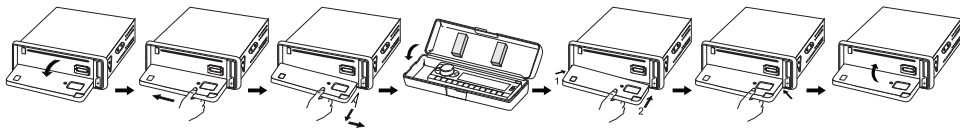

Notes:

- Do not press the front panel hard against the unit when attaching it. It can be easily attached by pressing it lightly against the unit.
- When you carry the front panel with you, put it in the supplied front panel case.
- Do not press hard or give excessive pressure to the display window of the front panel when attaching it to the unit.

CLEANING THE CONNECTOR

The unit may not function properly if the connectors between the unit and the front panel are contaminated with dirt. In order to prevent this from happening, detach the front panel by pressing the  button and clean the connector from time to time.

Clean the connector with a cotton swab together with contact cleaner as illustrated. Be sure to clean them carefully pin by pin and make sure not to damage the connecting points.

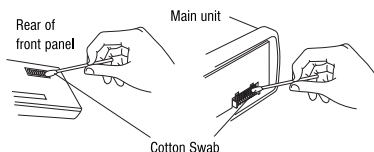

OPERATION

1. POWER ON/OFF

By pressing this key, the unit is on or off.



This unit is turned on by pressing any key.

2.3. FUNCTION SELECT BUTTON: BASS/TREBLE/BALANCE/FADER/TA SEEK/PI SOUND/RETUNE/MASK DPI/EON/BEEP/TA VOL/ADJ TIME/AUDIO DSP

Turning the VOL knob Right or Left (3), you can adjust VOL/BASS/TREB/BAL/FAD. To select other functions, press the VOL (3) knob shortly until the desired functions is shown on the display. Figure 1 shows how control functions are selected using the VOL knob.



Fig. 1 Selection of sound control functions
1. VOL 2. SEL 3. BAS 4. TRE 5. BAL

Turning the VOL knob Right or Left. Increase or decrease the volume by turning  or . These buttons can be used to adjust the BASS, TREBLE, BALANCE and FADER.

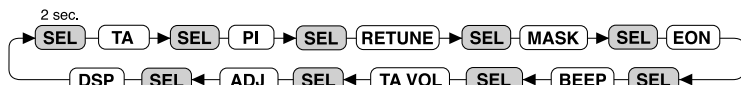

Press and hold VOL to adjust TA/PI/RETUNE/MASK/EON/BEEP/TA VOL/ADJ/DSP.

TA SEEK/TA ALARM

- TA SEEK mode:

When newly turned station does not receive TP information for 5 sec., the radio retunes to next station which has not the same station (PI) as the last station, but has the TP information.

In TA seek mode, the current station can be changed to the completely different station because the unit searches TP station when the field strength of the current station is very weak, or the current station has no TP signal.

- TA ALARM mode:

Any automatic retune mode is not activated, just can hear Beep sound.

PI SOUND

Action when 2 stations with different programme identification (PI) codes are on the same frequency:

SOUND: The radio switches to the new channel for a few seconds and then switches back again.

MUTE: The radio is muted.

RETUNE L/S

RETUNE L: Select 90 seconds as the initial time of automatic TA search.

RETUNE S: Select 30 seconds as initial time.

MASK DPI/ALL

MASK DPI: masked only the AF which has different PI.

MASK ALL: masked the AF which has different PI and NO RDS signal with field strength.

EON

Selected EON condition, ON or OFF.

BEEP

ALL: Button sound is on permanently.

2nd: Button sound is triggered by secondary button functions (hold button down for a while).

OFF: Button sound is off.

TA VOL

Traffic Announcement Volume

ADJ

Digital Clock. To adjust, turn VOL knob to right for hours and turn VOL knob to left for minutes.

DSP Modes

CLASSIC, ROCK, POP, FLAT, NONE

4. PRESET STATIONS (1,2,3,4,5,6)

(A) RADIO MODE:

When pressed shortly, these keys select a preset station directly. When pressed longer than 1 sec., current station is stored in preset memory bank.

(B) CD/MP3/WMA PLAYER MODE:

1. PAUSE 2. RPT 3. INT 4. RDM

USING THE RDS FUNCTION

What is RDS?

The RDS (Radio Data System) is a digital information system developed by the EBU (European Broadcast Union).

Piggy-backed on normal FM broadcasts, RDS offers a variety of information services and automatic retuning functions for RDS-compatible car stereos.

In 1988, RDS became available in the United Kingdom, France, West Germany, Ireland and Sweden. Test transmissions are being conducted in many other European countries. It is expected that RDS will be available in most Western European countries in the near future.

5. 'AF/REG' function (ALTERNATIVE FREQUENCIES)

When pressed shortly, AF/REG switching mode is selected.

When AF/REG switching mode is selected, the radio checks the signal strength of the AF all the time. When pressed long, it is activated as regional mode ON/OFF.

- Regional mode ON:

AF switching or PI SEEK is implemented to the station which have all PI codes same as current station. REG segment is turned on, in LCD display.

- Regional mode OFF

The regional code in the format of PI code is ignored when AF switching or PI SEEK is implemented.

6. 'TA' function (TRAFFIC ANNOUNCEMENT)

When pressed shortly, it is activated as TA mode on or off

When TA mode is on and traffic announcement is transmitted

- When the unit is in CD/MP3 mode, it will switch to radio mode temporarily.
- If the volume level was under the threshold point, it will be raised to the threshold point.
- When TP station is received, TP segment is turned on in LCD display.

7. 'PTY' function (PROGRAM TYPE)

Each press of PTY button will toggle between PTY Music, PTY Speech and PTY Off.

When PTY Music is selected, press Buttons (1-6) for desired program types. Unit automatically search for corresponding programs.

1 Pop M, Rock M	2 Easy M, Light M	3 Classics, Other M
4 Jazz, Country	5 Nation M, Oldies	6 Folk M

When PTY Speech is selected, press Buttons (1-6) for desired program types. Unit automatically search for corresponding programs.

1 News, Affairs, Info	2 Sport, Educate, Drama	3 Culture, Science, Varied
4 Weather, Finance, Children	5 Social, Religion, Phone IN	6 Travel, Leisure, Document

Tips: Since each button number can store multiple program types, i.e. Button 1 stores Pop and Rock music, to switch between Pop and Rock music, simply press button 1 repeatedly until the desired program type shows in display.

8. DISPLAY (DISP)

Press **DISP** button to switch between display informations such as radio frequencies, clock, track and other informations depending on the playing MODE.

9. MODE BUTTON (MODE)

By pressing this key, user can select. AUX/TUNER/CD-MP3/USB or MMC/SD mode.

10. BAND BUTTON (BAND)

Each band is toggled cyclically by pressing this key FM1—FM2—FM3.

11. AUTOMATIC OR MANUAL TUNING (FREQ UP ►►► OR FREQ DOWN ◀◀◀)

(A) RADIO MODE

When pressed shortly, these keys are operated as MANUAL tuning mode.

When pressed longer than 1 sec., they are operated as SEEK tuning mode.

(B) CD/MP3 PLAYER MODE

When pressed shortly, they are operated as TRACK UP or TRACK DOWN mode.

When pressed longer than 1 sec., they are operated as CUE or REVIEW mode.

12. AUTO SEEK SEARCH TUNING (A/PS)

By pressing shortly, the radio searches for each preset station.

When field strength level is bigger than the threshold level of stop level, the radio is holding at that preset number for 5 sec. with releasing mute, and then searches again.

By pressing longer than 1 sec, and then 6 strongest stations are preset to the corresponding preset number. When AS operation is finished, the radio executes the preset scan.

13. 'SCAN' AUTOMATIC TUNING CONTROL (SCAN)

This key is operated as RADIO SCAN. The operation is similar as normal search but different thing is holding 5 seconds on every station detected in RADIO SCAN mode.

14. MUTE BUTTON (MUT)

Press this button, audio will disappear. Press this button again in order to hear audio newly.

15. LCD DISPLAY

The Liquid Crystal Display will display the current state of the unit.

16. OPEN THE FRONT PANEL

Press  button and the front panel will open.

CD/MP3/WMA CONTROL LOCATION OF PARTS

TRACK/SEARCH BUTTON (11)

FORWARD AND REVERSE TRACK SEARCH (or changing songs)

Press the SKIP button (◀◀◀ or ►►►) during play to go to the desired track(song).

◀◀◀ ...REVERSE ... ►►► FORWARD

Press and hold the SKIP button (◀◀◀ or ►►►) during play to scan the disc at high speed. When the desired music section of the disc is found, release the button. Normal play will resume.

17. CD SLOT

18. CD EJECT BUTTON

Press the  button to remove the CD.

19. PAUSE BUTTON

During "PLAY", press (19) 'PAU' button to "PAUSE". Press it again to resume play.

20. REPEAT BUTTON

When this button is pressed, 'RPT' indication is displayed and play of the selected track will be continually repeated until the Track repeat mode is cancelled by pressing 'RPT' button again.

21. INTRO BUTTON (Preview all Tracks)

When this button is pressed, 'INT' indication is displayed and the first several seconds of each track of the disc are played. Press again to stop intro and listen to track.

22. RANDOM BUTTON

When this button is pressed, 'RDM' indication is displayed and each track of the disc are played in random instead of normal progression.

To cancel RANDOM mode, press 'RDM' button (22) again.

23, 24. 10 TRACK DOWN/UP SELECT: (In case of MP3/WMA files)

M5: 10 Track down / M6: 10 Track up

HOW TO SELECT MP3/WMA FILES

A. Searching by Track:

- Press "A/PS". Digit starts blinking.
- Rotate "VOL" / VOL " knob until the desired track number shows then press VOL knob.
- Song number you selected will start to play.

B. Searching by Folder:

- Press "A/PS" twice.
- Rotate "VOL" / VOL " knob to select folder name then press VOL knob.
- Rotate "VOL" / VOL " knob to select file to play then press VOL knob to start playback.

Connecting it to Portable MP3 Player

25. USB Port

Using USB cable to connect Your Portable MP3 Player.

26. MULTI-MEDIA CARD (MMC) / SD CARD SLOT

Support MP3/WMA ID3 format music only.

* IMPORTANT INFORMATION:

BECAUSE OF THE GREAT VARIETY OF PRODUCTS WITH USB, SD AND MMC CARD PORTS AND THEIR SOMETIMES QUITE MANUFACTURER-SPECIFIC FUNCTIONS WE CAN NEITHER GUARANTEE THAT ALL DEVICES WILL BE RECOGNIZED NOR THAT ALL OPERATING OPTIONS THAT ARE POSSIBLE IN THEORY WILL ACTUALLY WORK

27. FRONT AUX IN

Convenient easy to use front "AUX IN" input jack, allows easy connection of Portable Media and digital MP3 Players.

RESET

Reset button is placed on the housing.

The reset button is to be activated for the following reason:

- Initial installation of the unit when all wiring is completed.
- All the function button do not operate.
- Error symbol on the display.

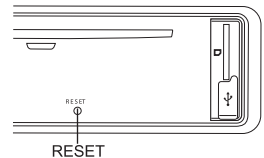

CAUTION & MAINTENANCE

The detachable panel FM car radio with CD player is an example of superior design and craftsmanship. The following suggestions will help you care for the product so that you can have many years of enjoyment.

1. Do not touch the contacts on the front panel or the unit body.
2. The product can only operate on 12V-14V DC power supply, negative ground.
3. Avoid exposing your product to high temperature and humidity.
4. Handle the product with care. Dropping it can damage circuit boards and cause the product to malfunction.
5. Modifying or tampering with internal components can cause damage and invalidate the warranty.
6. Always remove the CD from the unit when it has finished playing or not being used.

TROUBLESHOOTING GUIDE

SYMPTOM	POSSIBLE CAUSE	SOLUTION
No sound or power	Speaker cord disconnected.	Check to see that all the power and speaker leads are securely connected.
	Bad power connection.	
	Blown fuse.	Replace fuse with same amperage.
No sound in one channel	Mis-adjusted balance control.	Check balance control.
	Damaged speaker wire or speaker.	Reverse left and right channel speaker leads If no sound from other side, check or replace speaker wire. If no sound from both sides, replace both speakers.
Poor FM reception	Insensitive or defective antenna.	Replace with a good sensitivity antenna.
CD sound quality poor	Disc reading malfunction.	Try a different disc.
	Disc may be damaged or dirty.	Clean Disc with a soft cloth.
	Lens may need cleaning.	Insert a quality lens cleaning disc.

NOTE:

Good ground connections eliminate most electrical noise problems and require tight contact with the metal vehicle chassis. Remove plastics, paint or rust for good electrical contact.

TECHNICAL SPECIFICATIONS

CD/MP3/WMA PLAYER SECTION

Signal to Noise Ratio.....	> 60 dB
Channel Separation.....	> 50 dB (1kHz)
Frequency Response.....	20Hz - 20 kHz

TUNER (FM)

Frequency range.....	87.5-108 MHz
Sensitivity.....	2.8 μ V
Stereo separation.....	30 dB
Signal to noise ratio.....	50 dB
Channel step.....	50 kHz

LINE-OUT

Output.....	1.5 V (max.)
Impedance.....	10k Ohm

GENERAL

Power Supply.....	12V DC (10.8-15.6V allowable)
Speaker impedance.....	4 or 8 ohm
Output power.....	50W x 4CH
Fuse.....	10A

INSTRUCTIONS AND INFORMATION REGARDING THE DISPOSAL OF USED PACKAGING MATERIALS

Dispose of packaging material at a public waste disposal site.

DISPOSAL OF USED ELECTRICAL AND ELECTRONIC APPLIANCES



The meaning of the symbol on the product, its accessory or packaging indicates that this product shall not be treated as household waste. Please, dispose of this product at your applicable collection point for the recycling of electrical & electronic equipment waste. Alternatively in some states of the European Union or other European states you may return your products to your local retailer when buying an equivalent new product. The correct disposal of this product will help save valuable natural resources and help in preventing the potential negative impact on the environment and human health, which could be caused as a result of improper liquidation of waste.

Please ask your local authorities or the nearest waste collection centre for further details.

The improper disposal of this type of waste may fall subject to national regulations for fines.

For business entities in the European Union

If you wish to dispose of an electrical or electronic device, request the necessary information from your seller or supplier.

Disposal in other countries outside the European Union

If you wish to dispose of this product, request the necessary information about the correct disposal method from local government departments or from your seller.



This product meets all the basic EU regulation requirements that relate to it.

Changes to the text, design and technical specifications may occur without prior notice and we reserve the right to make these changes.

