

SENCOR®

SCT 8015MR

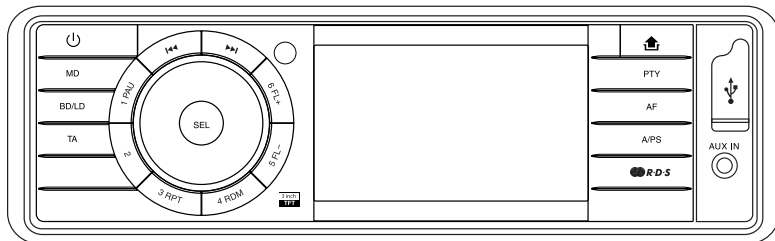

CAR STEREO MP3/WMA/MPEG4 PLAYER WITH PLL FM STEREO RADIO

- RADIO DATA SYSTEM • 3 INCH TFT-LCD DISPLAY • USB / SD/MMC CARD INPUT • TOUCH SCREEN CONTROL • FLIP DOWN/DETACHABLE FRONT PANEL

EN

STEREO PŘEHŘÁVAČ MP3/WMA/MPEG4 DO AUTOMOBILU S PLL STEREO RÁDIEM

- RDS (RADIO DATA SYSTEM) • 3PALCOVÝ TFT-LCD DISPLEJ • SLOT PRO USB A KARTU SD/MMC • DOTEKOVÁ OBRAZOVKA • SKLOPNÝ/ ODNÍMATELNÝ ČELNÍ PANEL

CZ

STEREO PREHŘÁVAČ MP3/WMA/MPEG4 DO AUTOMOBILU S PLL STEREO RÁDIOM

- RDS (RADIO DATA SYSTEM) • 3-PALCOVÝ TFT-LCD DISPLEJ • SLOT NA USB A KARTU SD/MMC • DOTYKOVÁ OBRAZOVKA • SKLOPNÝ/ODNÍMATELNÝ ČELNÝ PANEL

SK

AUTÓS MP3/WMA/MPEG4 SZTEREO LEJÁTSZÓ PLL SZTEREO RÁDIÓVAL

- RDS (RADIO DATA SYSTEM) • 3-HŰVELYKES TFT-LCD KIJELZŐ • USB ÉS SD/MMC KÁRTYA-RÉS • ÉRINTŐKÉPERNYŐ • LEHAJTHATÓ / LEVEHETŐ ELŐLAP

HU

ODTWARZACZ SAMOCHODOWY MP3/WMA/MPEG4 Z RADIEM PLL STEREO

- RDS (RADIO DATA SYSTEM) • 3-CALOWY WYŚWIETLACZ TFT-LCD • SLOT NA USB I KARTĘ SD/MMC • EKRAN DOTYKOWY • POCHYLANY/ WYJMOWANY PANEL PRZEDNI

PL

АВТОМОБИЛЬНЫЙ СТЕРЕО MP3/WMA/MPEG4 ПЛЕЕР С PLL FM СТЕРЕОРАДИО

- СИСТЕМА РАДИОИНФОРМАЦИИ • 3-ДЮЙМОВЫЙ TFT-ЖК ДИСПЛЕЙ • ВХОД ДЛЯ USB / SD/ ММС КАРТЫ • СЕНСОРНАЯ ПАНЕЛЬ УПРАВЛЕНИЯ • ОТКИДНАЯ/СЪЕМНАЯ ПЕРЕДНЯЯ ПАНЕЛЬ

RU

AUTOMOBILINIS STEREOFONINIS MP3/WMA/MPEG4 GROTVAS SU PLL FM STEREOFONINIŲ RADIJUMI

- RADIJO DUOMENŲ SISTEMA • 3 COL. TFT-LCD EKRANAS • USB / SD/MMC KORTELĖS LIZDAS • JUTIKLINIS EKRANAS • NULENKIAMAS/NUIMAMAS PRIEKINIS SKYDELIS

LT

INSTALLATION

PRECAUTIONS

- Choose the mounting location carefully so that the unit will not interfere with the normal driving functions of the driver.
- Avoid installing the unit where it would be subject to high temperatures, such as from direct sunlight or hot air from the heater, or where it would be subject to dust, dirt or excessive vibration.
- Use only the supplied mounting hardware for a safe and secure installation.
- Be sure to remove the front panel before installing the unit.

NOTE: Inclination angle for car radio installation must not exceed 30° otherwise the front panel will not open.

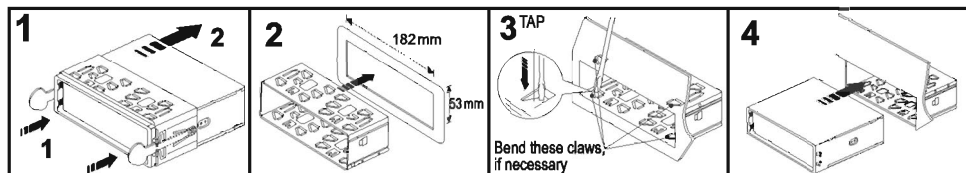

NOTE: Keep the release key in the safe place as you may need it in future to remove the unit from the car.

Detaching and attaching the front panel

The front panel of this unit can be detached in order to prevent the unit from being stolen.

FOLDING DOWN AND DETACHING/ATTACHING THE FRONT PANEL

Before detaching the front panel, be sure to press the button (1) OFF first.

Then press the button, let the Front Panel arrive in horizontal position and detach the panel by pulling it towards you as illustrated.

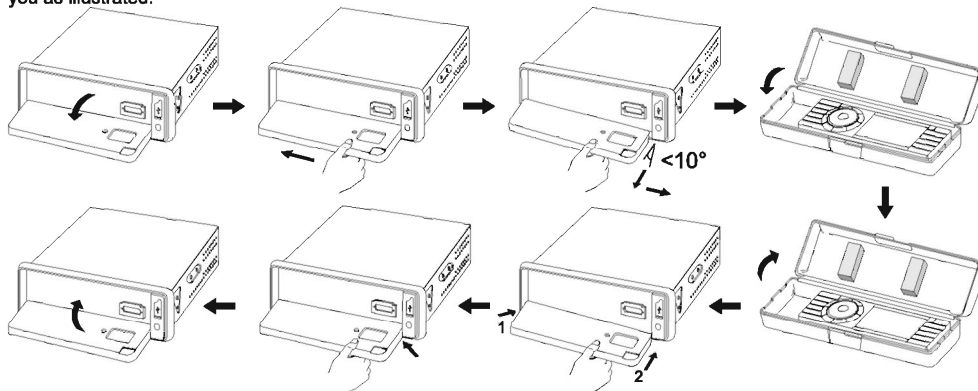

Notes:

- Do not press the front panel hard against the unit when attaching it. It can be easily attached by pressing it lightly against the unit.
- When you carry the front panel with you, put it in the supplied front panel case.
- Do not press hard or give excessive pressure to the display window of the front panel when attaching it to the unit.

CLEANING THE CONNECTOR

The unit may not function properly if the connectors between the unit and the front panel are contaminated with dirt. In order to prevent this from happening, detach the front panel by pressing the button and clean the connector from time to time.

Clean the connector with a cotton swab together with contact cleaner as illustrated. Be sure to clean them carefully pin by pin and make sure not to damage the connecting points.

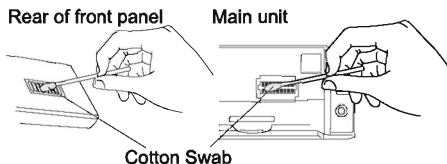

TO SUPPORT THE UNIT

1. UNIT
2. RELEASE CASE
3. DASH BOARD
4. HEX NUT
5. LOCK WASHER
6. PLAIN WASHER
7. CAR BODY
8. REAR SUPPORT STRAP
9. TAPPING SCREW
10. M5 X 15 HEX BOLT

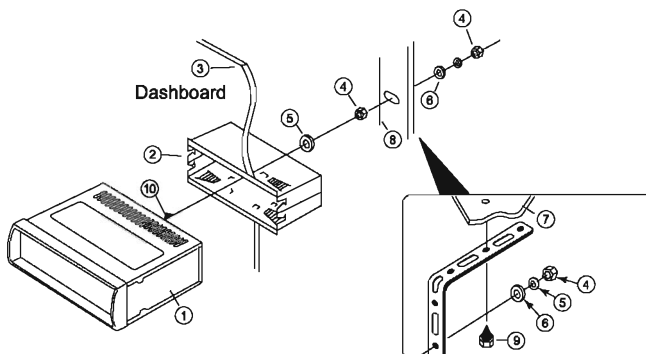

WIRE CONNECTION

IN / OUT CONNECTOR

Audio Out: White (L) Red (R)

Connect this wire to rear seat A/V monitor system

Line Out (Front): White (L) Red (R)

Line Out (Rear): White (L) Red (R)

2 Video Outputs: Yellow

Connect to external A/V system to display

Video In: Yellow

Connect to external Video equipment

Rear camera In: Blue

Connect to rear camera output

CONTROL WIRE

Parking (Gray): Connect this wire to car hand brake system

Tel mute (Black): Connect to mobile phone unit

When receiving calls, audio sound will be muted.

Rear camera (Red): Connect to reverse gear light

During back gear condition, this wire should be connected to high voltage.

DRIVING WITHOUT VIDEO DISPLAY

Follow the installation below so when the car is in motion, no video will come out from the LCD screen. Only sound can be heard from speaker.

Note:

- Only sound can be heard when car is in motion.
- Refer and follow your country's law regarding driving with video.

Caution:

- Do not attempt to install it by yourself if the instruction is not clear to you. Consult you dealer concerning the installation procedures.

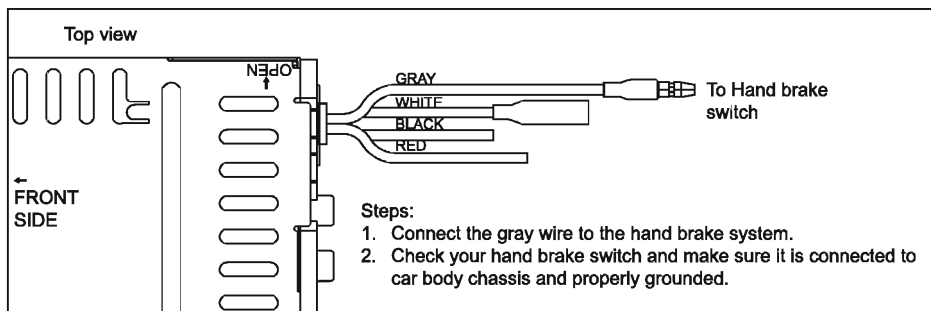

DRIVING WITH VIDEO DISPLAY

By following the installation below, video will always be shown on LCD screen no matter the car is in motion or not.

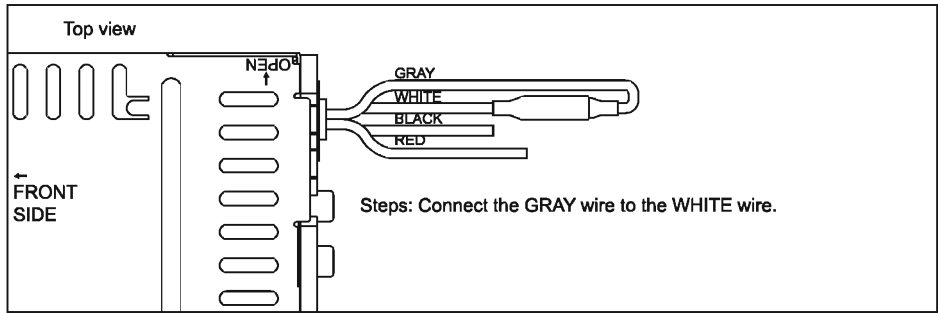

INSTALLING REAR CAMERA FOR PARKING/REVERSE MOTION

You can install an separate camera at the car rear end so when doing parking or reverse motion, the unit will automatically switch the video to the rear camera to guide the driver.

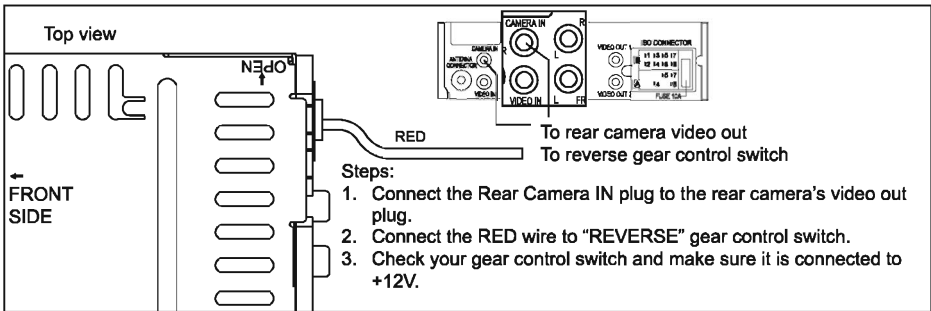

CONNECTOR A

- 4. MEMORY +12V
- 5. AUTO ANTENNA OUTPUT
- 7. +12V (TO IGNITION KEY)
- 8. GROUND

NOTE: (connector A no. 7) must be connected by car ignition key in order to avoid that car battery becomes weak when the car will be not used for long period.

CONNECTOR B

- 1. REAR RIGHT SPEAKER (+)
- 2. REAR RIGHT SPEAKER (-)
- 3. FRONT RIGHT SPEAKER (+)
- 4. FRONT RIGHT SPEAKER (-)
- 5. FRONT LEFT SPEAKER (+)
- 6. FRONT LEFT SPEAKER (-)
- 7. REAR LEFT SPEAKER (+)
- 8. REAR LEFT SPEAKER (-)

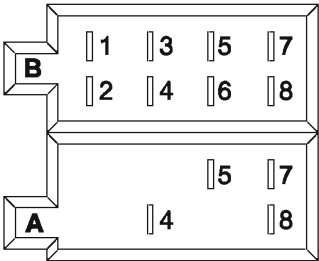

Maintenance

FUSE REPLACEMENT

If the fuse blows, check the power connection and replace the fuse. If the fuse blows again after the replacement, there may be an internal malfunction. In this case, consult your nearest repairing center.

Warning

Use the specified amperage fuse for each lead. Use of a higher amperage fuse may cause serious damage.

LOCATIONS OF PARTS (MAIN UNIT)

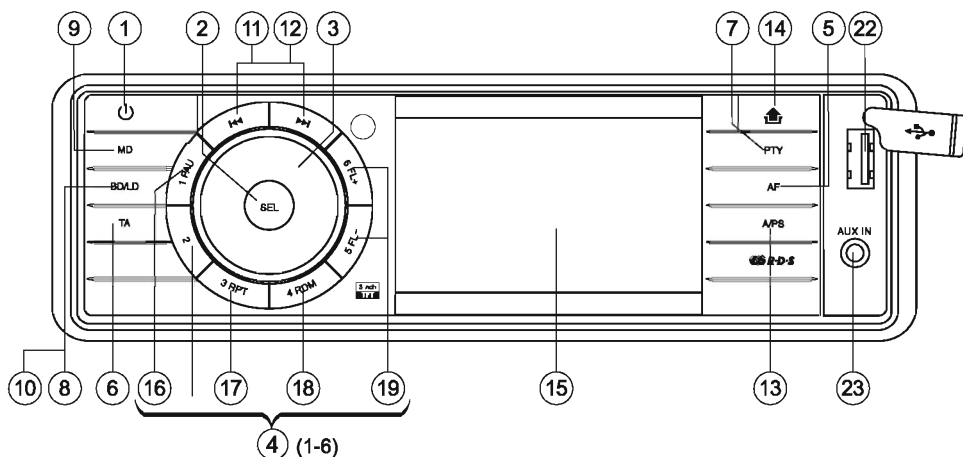

1. POWER ON/OFF (⏻)
2. SELECT FUNCTION BUTTON
3. VOLUME CONTROL
4. PRESET STATIONS (1,2,3,4,5,6)
5. 'AF' FUNCTION BUTTON (ALTERNATIVE FREQUENCIES)
6. 'TA' FUNCTION BUTTON (TRAFFIC ANNOUNCEMENT)
7. 'PTY' FUNCTION (PROGRAM TYPE)
8. LOUDNESS BUTTON (LD)
9. MODE BUTTON (MD)
10. BAND BUTTON (BD)
11. TRACK / SEARCH BUTTON (◀◀ / ▶▶)
12. AUTO SEEK TUNING (◀◀ / ▶▶)
13. AUTO SEEK SEARCH TUNING (A/PS)
14. PANEL RELEASE BUTTON (🔒)
15. TFT-LCD DISPLAY
16. PLAY/PAUSE BUTTON
17. REPEAT BUTTON
18. RANDOM BUTTON
19. PREVIOUS/NEXT FOLDER
20. RESET BUTTON
21. SD/MMC CARD SLOT
22. USB PORT
23. FRONT AUX IN

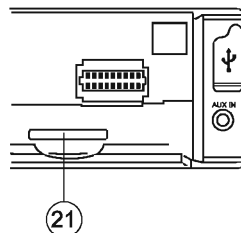
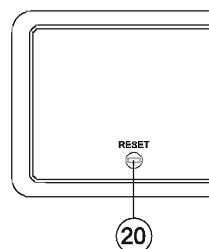

Locations of Parts (Remote Control)

1. POWER ON/OFF (⏻)
2. MODE
3. PLAY/PAUSE
4. TITLE
5. SELECT
6. SEEK+/SEEK- / TRACK/SEARCH
7. VOL +/VOL-
8. GOTO
9. AUDIO
10. ENTER
11. NAVIGATION
12. AUTO SEEK / PRESET SCAN / REPEAT
13. RANDOM / BAND / LOUDNESS
14. DUAL
15. PAL / NTSC SYSTEM
16. SUBTITLE
17. SETUP
18. EQUALIZER
19. SLOW MOTION
20. ZOOM / A-B REPEAT
21. STOP
22. CLOCK / ON SCREEN DISPLAY
23. MUTE
24. MAIN MENU
25. STEP (FRAME BY FRAME PLAYBACK)
26. PROGRAM TYPE
27. ALTERNATIVE FREQUENCIES
28. TRAFFIC ANNOUNCEMENT
29. PREVIOUS/NEXT FOLDER
30. TWO DIGIT TRACKS SEARCHS
31. KEYPAD

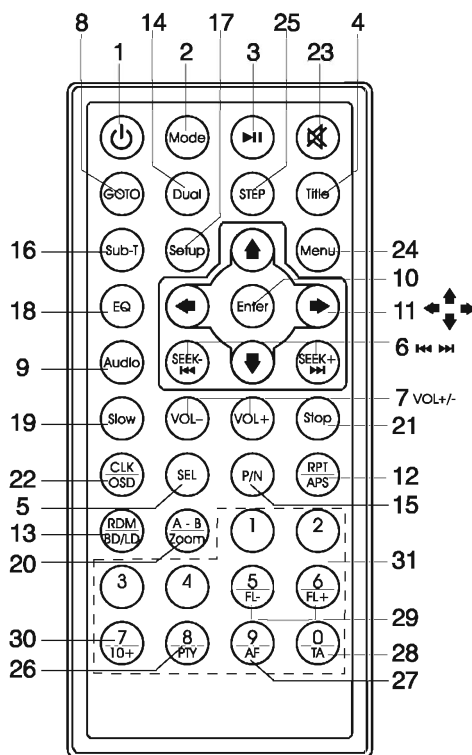

Use and care of the remote control

Installing the battery

Slide the tray out on the back of the remote control and insert the battery with the (+) and minus (-) poles pointing in the proper direction.

When use for the first time, pull out the film protruding the tray.

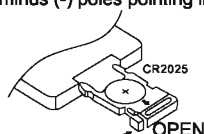

CAUTIONS

- Remove the battery if the remote control is not used for a month or longer.
- Do not recharge, disassemble, heat or dispose the battery on fire.
- Do not store the battery with metallic materials.
- In the event of battery leakage, wipe the remote control completely clean and install a new battery
- When disposing of used batteries, please comply with government regulations or environmental public institution's rule that apply in your country/area.
- Always check carefully that you are loading the battery with plus (+) and minus (-) poles facing the proper directions.

Using the remote control

Point the remote control in the direction of the front panel to operate.

IMPORTANT

- Do not store the remote control in high temperatures or direct sunlight.
- Do not let the remote control fall onto the floor, where it may become jammed under the brake or accelerator pedal.

OPERATIONS

Turning the unit ON/OFF (⏻)

Press "⏻" to turn on unit. To turn off, press the button again.

MAIN MENU

This is the root of the screen hierarchy and you can simply access all features by tapping on the touch screen buttons.

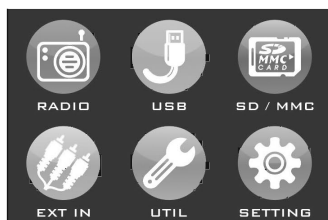

Selecting a source (MODE)

Press **MODE** repeatedly to switch between TUNER, AUX IN, USB, SD/MMC mode.

Adjusting Volume

Head Unit: Rotate **VOL** knob right or left to increase or decrease volume.

Remote Control: Press **VOL+** or **VOL-** to increase or decrease volume.

Mute Button

Remote Control: Press **M** button to mute the sound at once. Press again to return to previous volume level.

Loud Button (LD)

Press and hold **LD** button to turn on/off LOUD feature.

Equalizer (EQ)

Main Unit: On main menu, touch **SETTINGS** > **EQ SETTINGS**. Under *Dsp-preset*, select by touching the desired EQ setting.

Remote: Press **EQ** button. Under *Dsp-preset*, select the desired EQ by pressing (◀/▶).

CLOCK

To show clock, switch to **RADIO** mode and press **CLK** on remote control.

How to Set Clock

1. Press **UTIL** on main menu.
2. Press (⏮/⏭) to set the time.
3. Press **X** to save and exit.

DUAL SETTINGS

DUAL is a feature that lets user listen to radio while the passenger at the back can watch video. This unit supports connection of external AV device such as portable TV through the AUDIO OUT and VIDEO OUT port.

1. Connect the AUDIO OUT and VIDEO OUT port at the back of head unit to the LINE IN of external AV device.
2. Press and hold **MODE**. Select memory card or USB source.
3. Press **DUAL** key on remote control to select which mode you want to control.

T = TUNER, C = CARD, U = USB

Note: You will need to connect an external portable TV or monitor when using this feature.

VIEWING PHOTO

1. Insert disc, USB memory stick or SD/MMC card containing picture file format.
2. Using remote (◀/▶), select PHOTO function and press **ENTER**.
3. Using remote (⬆/⬇), select a file to view and press **ENTER**.

Note:

Press **MENU** on remote control to exit photo playback.

Press **MENU** on remote control will also go back one level or return to previous menu.

RESET

Reset button is placed on the housing. To reset, use a sharp point object and press and hold the **RESET** button for 2 seconds.

The reset button is to be activated for the following reason:

- Initial installation of the unit when all wiring is completed.
- All the function buttons does not operate.
- Error symbol on the display.

LISTENING TO RADIO**Band (BD)**

Pressing this key repeatedly will toggle cyclicly between each band. FM1---FM2---FM3.

Automatic or Manual tuning (SEEK + / SEEK -)

When pressed short, these keys are operated as MANUAL tuning mode.

When pressed longer than 1 sec., they are operated as AUTOMATIC tuning mode.

Auto Seek/Preset scan (A/PS)

Preset Scan (PS) - By pressing shortly, the radio plays each preset station for 5 seconds.

Auto Seek (AS) - By pressing longer than 1 sec, auto seek is activated. The 6 strongest stations are preset and stored in the corresponding preset number. When Auto Seek operation is finished, the radio executes the preset scan.

Storing and Recalling Frequencies

If you press any of the NUMBER (1-6) you can easily store up to six broadcast frequencies for later recall with the touch of a button.

1. Choose a desired **BAND**.
2. When you find a frequency that you want to store in memory, press a **NUMBER(1-6)** and hold until the preset number shows and lit in the display.
3. The selected radio station frequency has been stored in memory. The next time you press the same **NUMBER (1-6)** the radio station frequency is recalled from memory.

Note: Up to 6 stations can be stored in each band.

Currently Tuned Station

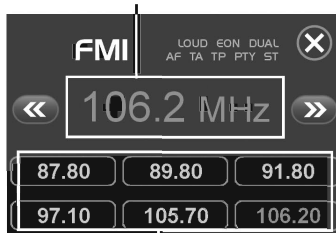

Preset Memory Station 1-6

USING THE RDS FUNCTION**What is RDS?**

The RDS (Radio Data System) is a digital information system developed by the EBU (European Broadcast Union). Piggy-backed on normal FM broadcasts, RDS offers a variety of information services and automatic retuning functions for RDS-compatible car stereos. In 1988, RDS became available in the United Kingdom, France, West Germany, Ireland and Sweden.

'AF' Function (Alternative Frequencies)

- Press **AF** to toggle alternative frequency On/Off.
- When AF is ON, the radio checks the signal strength of the AF all the time, when it becomes too weak, the unit search for a better signal within AF lists then switch to that frequency.

'TA' Function (Traffic Announcement)

When pressed short, it is activated as TA mode on or off. When TA mode is on and traffic announcement is transmitted.

- If the volume level was under the threshold point, it will be raised to the threshold point.

'PTY' Function (Program Type)

1. Press and hold **PTY** button to turn ON Program type.
2. Rotate **VOL** knob to select program type.
3. Once desired program shows, simply press **PTY** button once more and unit start searching for available stations.

Note: Program type will flash when searching for stations.

OPERATIONS COMMON FOR MP3/WMA/MPEG4

Previous/Next Folder

During MP3 playback, press and hold **FL-/FL+** button to go to previous /next folder.

Note: Disc / media sources must contain folder name for this function to work.

Specifying particular track

During playback, all track file names under a folder will be displayed on the screen categorized by Music, Photo, Video. Simply tap the screen on which category you want to play and rotate the volume knob to select file then push volume knob to start playback.

Random Playback

Press **RDM** during playback to play the tracks in random/shuffle order. Press it again to cancel.

Tips RDM is SHUFFLE on screen.

Stopping Playback

1. Press **Stop** on remote control during playback to stop playback. That position is stored in memory.
2. Press **▶||** to continue. Playback starts from the position at which it was stopped.

Note: There is no STOP function in audio playback. Audio playback uses ▶|| function.

Fast Forward / Fast Reverse

Note: ◀◀ or ▶▶ on remote control is the same function as ◀◀ or ▶▶ on head unit.

1. During playback, press and hold **◀◀** or **▶▶** unit scans at the speed of $\times 2$ - $\times 4$ - $\times 8$ - $\times 16$ - $\times 20$
2. To resume normal playback at a desired point, press **▶||**.

Note: No sound is played during fast forward / fast reverse.

Finding the Beginning of Tracks

During playback, press **◀◀** or **▶▶**.

◀◀: Press to start playback from the beginning of the previous chapter or track.

▶▶: Press to start playback from the beginning of the following chapter or track.

Pause Playback

During playback, press **▶||**. Press again to resume playback.

A-B Repeat Playback

This feature allows you to loop playback a section of the movie starting from Point A to B.

1. Press the **▶||** button to play the movie.
2. Once you have located the section you wish to playback on loop repeat, press and hold **A-B** button. You will see "Rep-A" on the screen.
3. Let the movie play on until you have reached the end of the section you wish to watch on continuous loop. Once you have reached this point, press and hold **A-B** button again. "Rep-A-B" will appear on your screen. Playback will now start from Point A-B.
4. To stop A-B repeat playback, press and hold **A-B** button once more until "A-B CANCEL" disappears and normal playback resumes.

Displaying information (OSD)

During playback, you can see all information and current play settings. Display will show related playback time, elapse time, title number, chapter number and other information.

1. Press **OSD** on the remote control once. Unit will display the play time and the disc elapse time.
2. Press it once more and all other settings information will be displayed.

LISTENING TO MP3/WMA

Repeat tracks

You can choose between repeat playback of a single track or all tracks.

1. Press **RPT** on the remote control during playback.
2. Every time you press this button, the unit switches to the following settings:

Repeat 1 – Repeat the current playback track.

Repeat Folder – Repeat the currently played folder.

Repeat All – Repeat all folders and tracks.

Repeat – Repeat function is OFF.

TITLE

During music playback, press **TITLE** on remote to return to audio file lists.

SD/MMC Card Input

Support MP3/WMA ID3 format music only.

1. Press button and the front panel will open.
2. Detach the panel by pulling it towards you.
3. Carefully insert the SD/MMC card into the disc slot, attach back the panel. Unit starts playback automatically.

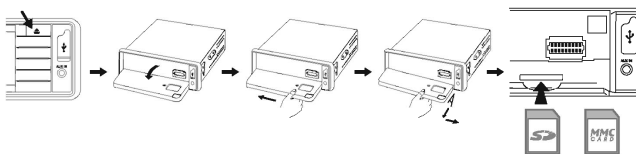

Front USB Port

Using USB cable to connect Your Portable MP3 Player.

* IMPORTANT INFORMATION:

BECAUSE OF THE GREAT VARIETY OF PRODUCTS WITH USB, SD AND MMC CARD PORTS AND THEIR SOMETIMES QUITE MANUFACTURER-SPECIFIC FUNCTIONS WE CAN NEITHER GUARANTEE THAT ALL DEVICES WILL BE RECOGNIZED NOR THAT ALL OPERATING OPTIONS THAT ARE POSSIBLE IN THEORY WILL ACTUALLY WORK

Front Aux In

Convenient easy to use front "AUX IN" input jack, allows easy connection of Portable Media and other digital MP3 Players.

PLAYING MPEG4

Repeat Playback

1. Press **RPT** on the remote control during playback.
2. Every time you press this button, the unit switches to the following settings:

Repeat 1 – Repeat the current playback track.

Repeat All – Repeat all folders and tracks.

Repeat OFF – Turn off repeat function.

Searching for particular track using GOTO

You can use the GOTO function to search for a desired track number or particular point of a track to play.

1. Press **GOTO** on the remote control during playback. Time and track number search appears.
2. Enter the minutes and seconds for the currently played track if you want to search by time. Press **Enter**.
3. Enter track number if you want to search by tracks. Press **Enter**.

Changing the subtitle language during playback (Multi-subtitle)

With MPEG4 featuring multi-subtitle recordings, you can switch between subtitle languages during playback.

1. Press **Sub-T** on the remote control during playback. Press repeatedly until the supported desired subtitle appears.

Folder Name Track file names

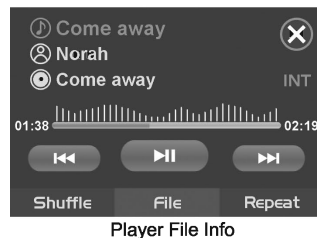
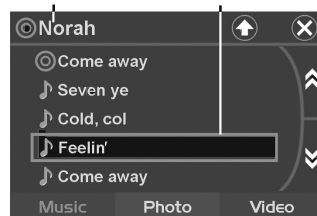

Player File Info

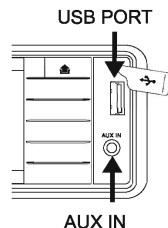

Slow motion playback

This feature lets you slow down playback.

1. Press **Slow** on the remote control during playback.
2. Pressing it repeatedly will switch you to the following steps: 1/2 - 1/3 - 1/4 - 1/5 - 1/6 - 1/7.

Note:

- To resume normal playback, press **PLAY/PAUSE (▶||)**.
- There is no sound during slow motion playback.

Zooming in During Playback

You can zoom in into the picture during playback.

1. Press **ZOOM** on the remote control during playback.
2. Every time you press this button, the unit will zoom 2 - 3 - 4 - 1/2 - 1/3 - 1/4 times and OFF.

Frame-by-frame playback

This lets you move ahead one frame at a time during playback.

1. Each time you press **Step** button on remote control, you move ahead one frame.

To return to normal playback, press **▶||**.

PAL / NTSC (P/N)

Press and hold **P/N** button to switch between PAL, NTSC system.

Customizing Audio/Video Settings

AUDIO SETUP

1. Press **VOL** knob to enter AUDIO setup. Selected item will be highlighted. You can set BASS, TREBLE, BALANCE, FADER, TA VOLUME.
2. Press **◀◀** or **▶▶** button to select item. Rotate **VOL** knob to make adjustments.
3. Press **VOL** knob to exit settings.

VIDEO SETUP

1. Press and hold **VOL** knob to enter VIDEO setup. Selected item will be highlighted. You can set BRIGHTNESS, CONTRAST, SATURATION, HUE, SHARPNESS.
2. Press **◀◀** or **▶▶** button to select item. Rotate **VOL** knob to make adjustments.
3. Press and hold **VOL** knob to exit settings.

Note: Depending on model's feature, some items may not **show on screen**.

SETTING THE MPEG4 PLAYER

You can flexibly customize the unit to suit your preference. You can set the language and other video and audio settings so when playback starts it will always use your preferred settings.

Important:

1. Play any video file before you can access the setup.
2. Press **Setup** on the remote control.
3. Use (**◀**/**▶**) to return / enter category.

Settings	Category	Options
System Setup	TV System	NTSC, PAL, AUTO
	Auto Play	ON, OFF
	TV Type	4:3PS, 4:3LB, 16:9
	Password	Setup password
	Rating	Setup rating level
	Default	Restore to factory settings

Settings	Category	Options
Language Setup	OSD Language	Select preferred options appear on screen
	Audio Language	
	Subtitle Language	
	Menu Language	
	MPEG4 Language	
Video Setup	Brightness	Use navigation keys on remote control to setup desired level.
	Contrast	
	Hue	
	Saturation	
	Sharpness	

Setting Rating Password

- 1 Press **Setup** on the remote control.
- 2 Using Navigation keys select *System Setup > Password* and press **Enter**.
- 3 Enter the default password '**0000**' and press **Enter** to unlock first and then enter new 4 digit password and press **Enter**. The unlock logo will switch to lock indicating password has been set.

Note:

- The default password is '**0000**'.
- In case you forgot your password, you can use the master password '**0000**' to unlock and reset the password.
- Master password will only work while **SETUP** button is press during playback.

TECHNICAL SPECIFICATIONS

MP3/WMA PLAYER SECTION

Signal to Noise Ratio	> 60 dB
Channel Separation	> 50 dB (1kHz)
Frequency Response	20 Hz - 20 kHz

TUNER (FM)

Frequency Range	87.5-108 MHz
Channel Step	50 kHz
Sensitivity	2.8 μ V
Stereo Separation	30 dB
Signal to Noise Ratio	50 dB

LINE-OUT

Output	1300 mV (max.)
Impedance	10k Ohm

AUX-IN

Frequency Response	20 Hz - 20 kHz
Sensitivity	775 mV
Impedance	20k Ohm

GENERAL

Power Supply	12V DC (10.8-15.6V allowable)
Speaker Impedance	4 or 8 Ohm
Output power	40W \times 4CH
Fuse	10A

Note: Specification and the design are subject to possible modification without notice due to improvements.

HANDLING INSTRUCTIONS FOR THE DISPOSAL OF USED PACKAGING MATERIAL

Dispose of the packaging material in the designated place for waste disposal.

ELECTRONIC AND ELECTRIC APPLIANCE DISPOSAL INSTRUCTIONS



Information for users for the disposal of electric and electronic devices

This symbol on products or original documents means that used electric or electronic products must not be added to standard communal waste. For proper disposal, renewal and recycling hand over these products to determined collection points. Or as an alternative in some European Union states or other European countries you may return your products to the local retailer when buying an equivalent new product.

Through the correct disposal of this product you will help retain valuable natural resources and prevent potential negative effects on the environment, which could result from its incorrect disposal of waste. Ask about other details at the local council or at the nearest collection point.

In accordance with national regulations penalties may be imposed for the incorrect disposal of this type of waste.

For business entities in European Union states

If you want to dispose of electric or electronic devices, ask your retailer or supplier for the necessary information.

Disposal in other countries outside the European Union.

This symbol is valid in the European Union. If you wish to dispose of this product, request the necessary information about the correct disposal method from the local council or from your retailer.



This product meets all the basic EU regulation requirements that relate to it

Changes in the text, design and technical specifications may change without prior notice and we reserve the right to make these changes.