

# SENCOR®

## SCD-7606BMR

### INSTRUCTION MANUAL

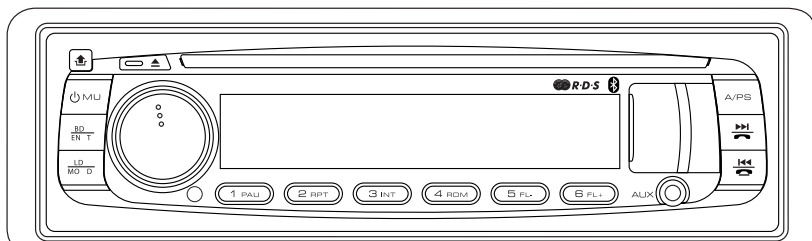

CAR STEREO CD/MP3/WMA PLAYER WITH PLL FM STEREO RADIO  
RADIO DATA SYSTEM WITH PTY USB / SD/MMC / FRONT AUX INPUT  
BLUETOOTH FUNCTION IN MOBILE PHONE  
DETACHABLE FRONT PANEL

STEREO SYSTÉM DO AUTOMOBILU S CD/MP3/WMA PŘEHRÁVAČEM A PLL FM STEREO RÁDIEM  
RDS (RADIO DATA SYSTEM) S FUNKCÍ PTY / VSTUP PRO USB A KARTY MMC/SD  
PŘEDNÍ VSTUP AUX IN / FUNKCE BLUETOOTH PRO MOBILNÍ TELEFON  
ODNÍMATELNÝ SYSTÉM ČELNÍHO PANELU

STEREOSYSTÉM DO AUTOMOBILU S CD/MP3/WMA PREHRÁVAČOM A PLL FM STEREO RÁDIOM  
RDS (RADIO DATA SYSTEM) S FUNKCIOU PTY / VSTUP PRE USB A KARTY MMC/SD  
PREDNÝ VSTUP AUX IN / FUNKCIA BLUETOOTH PRE MOBILNÝ TELEFÓN  
ODNÍMATELNÝ SYSTÉM ČELNÉHO PANELA

AUTÓS SZTEREO RENDSZER CD/MP3/WMA LEJÁTSZÓVAL ÉS PLL FM SZTEREO RÁDIOVAL  
RDS (RADIO DATA SYSTEM) PTY FUNKCIÓVAL / USB ÉS MMC/SD KÁRTYA BEMENET  
ELŐLSÓ AUX IN BEMENET / BLUETOOTH FUNKCIÓ MOBILTELEFONHOZ  
LEVEHETŐ ELŐLAP RENDSZER

SAMOCODOWY SYSTEM STEREO Z ODTWARZACZEM CD/MP3/WMA I RADIEM STEREO PLL FM  
RDS (RADIO DATA SYSTEM) Z FUNKCJĄ PTY / WEJŚCIE NA USB I KARTY MMC/SD  
PRZEDNIE WEJŚCIE AUX IN / FUNKCJA BLUETOOTH DLA TELEFONÓW KOMÓRKOWYCH  
ZDEJMOWANY SYSTEM PANELU PRZEDNIEGO

АВТОМОБИЛЬНАЯ СТЕРЕОМАГНИТОЛА МР3/ММА С ФУНКЦИЕЙ PLL, СТЕРЕО РАДИО FM  
СИСТЕМА РАДИОИНФОРМАЦИИ С PTY USB / SD/MMC / ДОПОЛНИТЕЛЬНЫМ ВХОДОМ AUX НА ПЕРЕДНЕЙ ПАНЕЛИ  
ФУНКЦИЯ BLUETOOTH В МОБИЛЬНОМ ТЕЛЕФОНЕ  
СЪЕМНАЯ ПЕРЕДНЯЯ ПАНЕЛЬ

CD/MP3/WMA AUTOMAGNETOLA SU PLL FM STEREOFONINIŲ RADIJŲ  
RADIO DUOMENŲ SISTEMA SU PTY USB / SD/MMC / PRIEKINIŲ PAGALBINIŲ ĮVADŲ  
MOBILIOJO TELEFONO „BLUETOOTH“ FUNKCIJA  
NUIMAMAS PRIEKINIS SKYDELIS

EN

CZ

SK

HU

PL

RU

LT

Thank you for purchasing this product. Before installing, turning on and setting up the product, please read the entire user's manual even if you are already proficient in using similar products. This user's manual contains important information for safe and optimal use of all features and functions of the product. Pay special attention to instructions in the paragraph "Important safety instructions". Keep the user's manual in case of future need. The descriptions of the operation and use of the product in this user's manual serve solely as information for the user. In order for us to be able to offer products of the highest quality we reserve the right to make improvements and modifications without prior notice.

## 1. Important safety measures



Please read and adhere to the following instructions!

Under no circumstances is the supplier of the device responsible for any direct or indirect damages resulting from not adhering to the following instructions.

- To prevent injury by electrical shock, do not open the case of the device. The device does not include parts, which the user can repair themselves. Entrust all repairs and adjustments to an authorised service centre.
- Do not allow children to use or to play with the car radio – they are not able to identify the possible risks connected with the operation of electrical devices. Store the packaging material of the car radio (especially the plastic wrapping foils) out of children's reach – there is a risk of their suffocation.
- Do not expose the device to dripping or spraying water or another liquid. Do not under any circumstances pour any liquid onto or into the device. Do not place any containers filled with water or another liquid (e.g. cup or bottle) on the device or in its vicinity. Do not work with the product if you have wet hands. Do not use the device in a damp environment, near bodies of water, water reservoirs, etc.
- Learn how to use the car radio before using it. Do not use the car radio with the volume turned up high. Using the car radio with the volume turned up high may present a risk to you and other passengers in the vehicle. Set the volume of the radio so that you can follow what is happening around you. Do not set the volume of the car radio very high. Long-term use of the car radio set at a high volume presents a risk of permanent hearing damage. We recommend that all more complicated operations of the car radio are performed when the vehicle is not moving. Operation while driving the vehicle may lead to possibly dangerous situations.
- To increase the safety of the car radio user, some functions are enabled only when the hand brake is engaged. The car radio is installed in such a way that it recognises that the car has the hand brake engaged – any modifications to the wiring connections of the car radio that disable this function are dangerous and in some countries constitute an infringement of valid laws and regulations in force.
- Install the device in such a way that safe driving of the vehicle is ensured. To prevent accidents or infringing the law, never use the front video panel while driving. At the same time the video being played back should be outside the attention range of the driver. In some countries the watching of videos, not only applicable to the driver, but also the passengers may constitute an infringement of valid laws and regulations in force. If this is the case, it is necessary to adhere to valid laws and regulations in force.
- Install the car radio and its accessories so that its operation does not interfere with the driving of the vehicle and so that in critical situations (e.g. during intensive braking) the safety of passengers is not put at risk.
- Limit the use of the car radio when the motor of the vehicle is off – this presents a risk of discharging the car battery and subsequent problems with starting the motor.
- Do not park the vehicle in direct sunlight for extended periods of time – risk of overheating and malfunction of the car radio. In such circumstances do not turn on the car radio immediately but rather wait several minutes until the temperature in the interior of the vehicle stabilises with the use of the car's air conditioning system.
- We recommend that you have your car radio installed by a specialised company.
- Before inserting the car radio into the installation opening in the vehicle's dash board, check that the car radio has been connected correctly.
- Only use the supplied or recommended accessories with the car radio. Unauthorised accessories may damage the device or the vehicle.
- When drilling or cutting out the opening into the car body necessary for the installation of the car radio, consult this procedure with a dealer of the car brand before commencing.
- The car radio is designed to be powered from the dashboard's 12V power supply with a grounded negative (minus) lead in the electrical installation of the vehicle. Be careful when installing the car radio into certain buses, trucks, construction machinery, caravans, etc. – some of these vehicles use a 24V power supply in

- the dashboard system - connecting the car radio to this voltage risks causing irreparable damage to it. The voltage of the vehicle's electrical system is documented in its technical certificate.
- Before installing the car radio or before making changes to the installation, disconnect the negative (minus) lead on the vehicle's battery.
  - Read the user's manual for information about connecting the power supply.
  - Secure the installed cables or cable bundles using insulating tape, cable clamps, etc., the protection of cables and winding insulating tape around them is necessary in locations where the cables pass through partitions in metal parts of the vehicle's body. The cables need protection especially in areas near moving parts of the vehicle (e.g. pedals).
  - Also wind insulating tape around unused cables in cable bundles or unused loudspeaker cables.
  - Do not install the cables near hot components. This risks damaging the cable insulation, electrical short circuit and a fire hazard.
  - Take care to avoid short circuits of cables (between individual cable bundles or the vehicle's frame) – high short circuit currents may cause the vehicle to catch fire.
  - Under no circumstances should you connect the power supply of additionally installed appliances by removing insulation on a cable and attaching the appliance's power cable to an uninsulated cable. This risks overloading the system and subsequent burning of a fuse.
  - When replacing a burnt fuse, use a fuse of the same size as the burnt fuse with the same current rating.
  - Use high performance loudspeakers with a power output of at least 40 W and an impedance of 4 or 8 ohms. Using loudspeakers with a lower impedance risks damaging the loudspeaker coil, it may catch on fire and subsequently lead to its destruction. If loudspeakers with a level of impedance exceeding the specification here described are used, the car radio amplifier will not achieve the performance described in its documentation.
  - After the car radio is turned on the voltage on terminal A5 (cable with blue insulation connected to terminal no. 5 of the ISO A connector) will be 12 V (max. 100mA), which can be used to control the relay of an electrically extended antenna or (if the vehicle is equipped with a wire antenna moulded in the windscreen) for powering an antenna preamplifier or for controlling a switch mode power supply relay (optional) of a high performance amplifier.
  - Dirt and/or air humidity condensed on the player's sensor system may cause problems with the playback of discs, or block its function.
  - It is not possible to play disc types which are not specified in this user's manual.
  - Do not use damaged (scratched, deformed) or dirty discs.
  - The player displays ID3 tag texts (if they are recorded on the disc being played back).
  - After the disc is inserted the player will commence playback with a certain time delay necessary for the evaluation of the disc contents by the player.
  - After turning off the device, wait at least 10 seconds before turning it on again.
  - If the device requires repairs or adjustment, always contact a qualified authorised service centre. If the device is exhibiting unusual behaviour, contact an authorised service centre.
  - Due to the wide range of SD/MMC cards/USB devices available on the market, compatibility with all types of SD/MMC cards/USB devices cannot be ensured.

#### **NOTE**

- Dispose of flat batteries according to the laws in force in your country.
- All screens (OSD) and images will be based on the English version.
- The design and specifications contained in the user's manual may differ from the actual product.







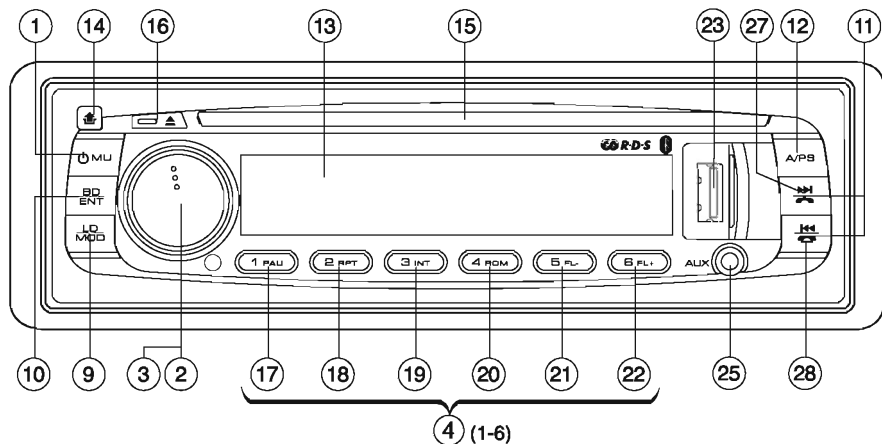

#### **Remote control and batteries**

- Do not expose the remote control or the batteries to direct sunlight or sources of heat, such as heaters, heat exchangers, stoves or other appliances (including amplifiers) producing heat. Do not use or leave the device in the vicinity of an open fire.
- Neither the remote control nor the batteries may be exposed to dripping or running water and objects filled with water must not be placed on them, e.g. vases. Protect against exposure to rain, spraying or pouring of any kind of liquid. Do not use outdoors. Not following these instructions creates a danger of damage to the remote control or the battery.
- Do not use this device near water.
- It is necessary pay attention to the environmental impact aspects of battery disposal.
- The incorrect use of batteries may cause the leakage of the electrolyte and corrosion. To ensure that the remote control works correctly, proceed according to the instructions below:
- Do not insert the batteries in the wrong polarity orientation.

- Do not charge, heat, open or short circuit the batteries.
- Do not throw batteries into a fire.
- Do not leave discharged batteries in the remote control.
- Do not combine various types of batteries or new and old batteries.
- If you will not be using the remote control for a longer period of time, remove the batteries to prevent potential damage caused by a subsequent battery leakage.
- If the remote control is not working correctly or its operational range is reduced, change all batteries for new ones.
- If electrolyte leaks out from the batteries, have the remote control cleaned at an authorised service centre.

# LOCATIONS OF CONTROLS



1. POWER ON/OFF (  ) / MUTE (MU)
2. FUNCTION SELECT BUTTON: BASS/TREBLE/BALANCE/FADER / CALL LIST/DISPLAY/INITIAL VOLUME/ADJUST TIME/TA VOLUME/EON/ ALTERNATIVE FREQUENCIES/TRAFFIC ANNOUNCEMENT/PROGRAM TYPE/DSP SOUND/TA ALARM/PI MUTE/RETUNE/ MASK DPI
3. VOL UP/VOL DOWN FOR BASS/TREBLE/BALANCE/FADER
4. PRESET STATIONS (1,2,3,4,5,6)
5. 'AF' FUNCTION (ALTERNATIVE FREQUENCIES)
6. 'TA' FUNCTION (TRAFFIC ANNOUNCEMENT)
7. 'PTY' FUNCTION (PROGRAM TYPE)
8. EQUALIZER (DSP)
9. MODE / LOUDNESS BUTTON (LD/MOD)
10. BAND / ENTER BUTTON (BD/ENT)
11. AUTOMATIC OR MANUAL TUNING (FREQ UP  OR FREQ DOWN /CD TRACK/SEARCH BUTTON
12. AUTO SEEK SEARCH TUNING (A/PS)
13. LCD DISPLAY
14. PANEL RELEASE BUTTON (  )
15. CD SLOT
16. CD EJECT BUTTON (  )
17. PAUSE BUTTON (PAU)
18. REPEAT BUTTON (RPT)
19. INTRO BUTTON (Preview all Tracks) (INT)
20. RANDOM BUTTON (RDM)
- 21, 22. SEARCH PREVIOUS / NEXT FOLDER (FL- / FL+)
23. USB PORT
24. SD/MMC CARD SLOT
25. AUX IN
26. PHONE NUMBER (  )
27. ANSWER A CALL (  )
28. END A CALL (  )

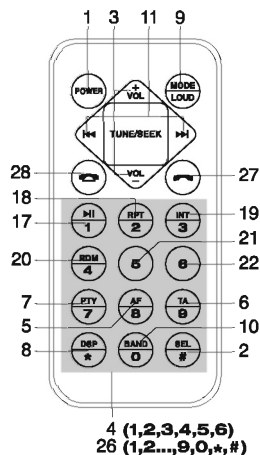

4 (1,2,3,4,5,6)  
26 (1,2,...,9,0,\*,#)

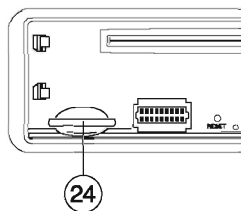

# INSTALLATION

## PRECAUTIONS

- Choose the mounting location carefully so that the unit will not interfere with the normal driving functions of the driver.
- Avoid installing the unit where it would be subject to high temperatures, such as from direct sunlight or where it would be subject to dust, dirt or excessive vibration.
- Use only the supplied mounting hardware for a safe and secure installation.
- Be sure to remove the front panel before installing the unit.

## Mounting angle adjustment

Adjust the mounting angle to less than 20°.

## MOUNTING EXAMPLE

### Installation in the dashboard

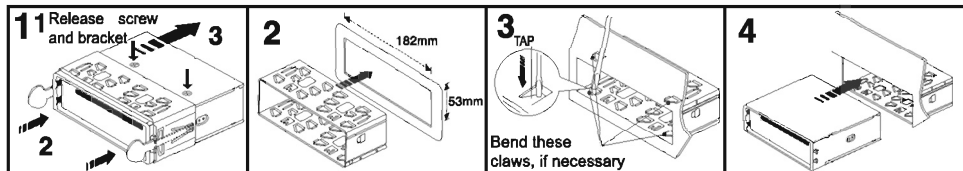

**Note:** Keep the release key in a safe place as you may need it in the future to remove the unit from the car.

## TO SUPPORT THE UNIT

1. UNIT
2. RELEASE CASE
3. DASH BOARD
4. HEX NUT
5. LOCK WASHER
6. PLAIN WASHER
7. CAR BODY
8. REAR SUPPORT STRAP
9. TAPPING SCREW

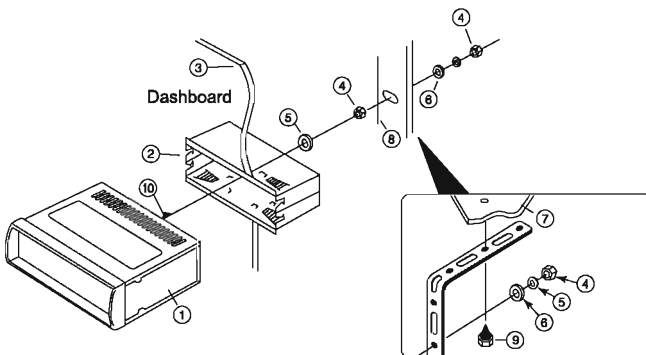

## Detaching and attaching the front panel

The front panel of this unit can be detached in order to discourage the thief from stealing the unit.

### DETACHING THE FRONT PANEL

Before detaching the front panel, be sure to press the to power-off the unit first. Press the button to release front panel.

Pull out the panel towards you in order to detach completely the panel from the main unit. Refer to instruction.

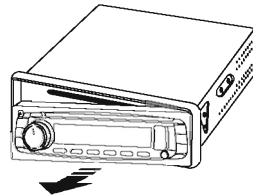

### ATTACHING THE FRONT PANEL

Make sure the front panel is in the right way up when attaching it to the unit as it cannot be attached upside down. Bring side B of panel to side A of main unit. Insert the panel in and push until it clicks.

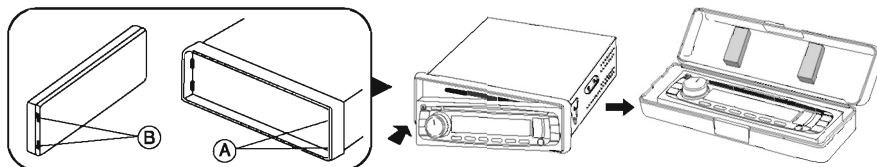

**Notes:**

- Do not press the front panel hard against the unit when attaching it. It can be easily attached by pressing it lightly against the unit.
- When you carry the front panel with you, put it in the supplied front panel case.
- Do not press hard or give excessive pressure to the display window of the front panel when attaching it to the unit.

**CLEANING THE CONNECTOR**

The unit may not function properly if the connectors between the unit and the front panel are contaminated with dirt. In order to prevent this from happening, detach the front panel by pressing the  button and clean the connector from time to time.

Clean the connector with a cotton swab together with contact cleaner as illustrated. Be sure to clean them carefully pin by pin and make sure not to damage the connecting points.

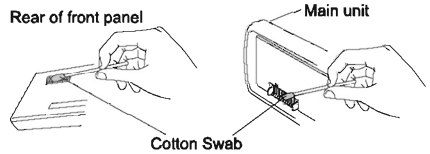

**ISO CONNECTOR**

**RCA Jack Line Out:**  
Red (right) White (left)

**CONNECTOR A**

4. MEMORY +12V
5. AUTO ANTENNA OUTPUT
7. +12V (TO IGNITION KEY)
8. GROUND

**Note:** (connector A no. 7) must be connected by car ignition key in order to avoid that car battery being drained when the car will be not used for long period.

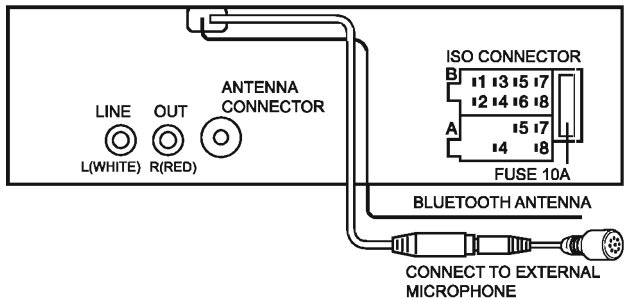

**CONNECTOR B**

1. REAR RIGHT SPEAKER (+)
2. REAR RIGHT SPEAKER (-)
3. FRONT RIGHT SPEAKER (+)
4. FRONT RIGHT SPEAKER (-)
5. FRONT LEFT SPEAKER (+)
6. FRONT LEFT SPEAKER (-)
7. REAR LEFT SPEAKER (+)
8. REAR LEFT SPEAKER (-)

**Maintenance**

**FUSE REPLACEMENT**

If the fuse blows, check the power connection and replace the fuse. If the fuse blows again after the replacement, there may be an internal malfunction. In this case, consult your nearest repair center.

**Warning**

Use the specified fuse amperes for each lead. Use of a higher fuse amperes may cause serious damage.

# OPERATING INSTRUCTIONS

## 1. POWER ON/OFF

Press and hold this key to switch the unit on and off. Also this unit can be turned on by pressing any key. If you just press this key briefly, it will turn to MUTE. To return to sound, press it briefly again.



## 2. SELECT

### 3. VOLUME UP/DOWN

Turn the VOL knob Right or Left (3) to adjust VOL/BASS/TREB/BAL/FAD. To select other functions, continue to press the VOL knob until the desired function is shown on the display. See Figure 1.



Fig. 1 Selection of sound control functions  
1. VOL 2. BAS 3. TRB 4. BAL 5. FAD

Turn the VOL knob  or  to increase or decrease the volume levels. These buttons can also be used to adjust the BASS, TREBLE, BALANCE and FADER.



Press and hold **VOL** knob to adjust CALL LIST/DISPLAY/INITIAL VOLUME/ADJUST TIME/TA VOLUME/EON/ALTERNATIVE FREQUENCIES/TRAFFIC ANNOUNCEMENT/PROGRAM TYPE/DSP SOUND/TAALARM/PI MUTE/RETUNE/ MASK DPI

## CALL LIST

### Incoming/Outgoing calls:

- Press the ENT button. **IN CALL**: Shows the last 20 incoming calls.
- Press the ENT button again. **OUT CALL**: Shows the last 20 outgoing calls.

### Telephone book:

You can transfer up to 20 contacts (Telephone book entries) from the connected mobile phone to the device and thus dial and call the contact from the device.

- Turn the **VOL** knob to select telephone book entries.
- Press the ENT button. Subsequently **PB01** appears and the name and call number of the first memory slot is shown.
- Press the  button on the device to select the dialled call number.

### Note:

**Using CALL LIST mode must be connecting the telephone to the device first**

- Activate the Bluetooth function on your mobile phone and conduct a search for Bluetooth devices. After a successful search the entry **CarBT** appears for the device in the display of the mobile phone.
- Select this entry for the connection and for the subsequent password request enter the password 1234 for the device. You may possibly have to confirm the connection structure once more. After a successful coupling **CONN OK** appears briefly in the device's display.

## DISPLAY

Display informations such as radio frequencies, clock, track and other informations depending on the playing MODE.

## INITIAL VOLUME

Turn **VOL** knob to adjust Initial Volume level.

## ADJUST TIME

Can adjust clock time. Turn **VOL** knob clockwise to set hours and counter clockwise to set minutes.

## TA VOLUME

Turn **VOL** knob to adjust TA Volume (The volume level when Traffic announcement is transmitted).

## EON

Turn **VOL** knob to selected EON condition, ON or OFF.



## USING THE RDS FUNCTION

### What is RDS?

The RDS (Radio Data System) is a digital information system developed by the EBU (European Broadcast Union). Piggy-backed on normal FM broadcasts, RDS offers a variety of information services and automatic retuning functions for RDS-compatible car stereos.

In 1988, RDS became available in the United Kingdom, France, West Germany, Ireland and Sweden. Test transmissions are being conducted in many other European countries. It is expected that RDS will be available in most western European countries in the near future.

### 'AF/REG' function (ALTERNATIVE FREQUENCIES)

When AF/REG mode is selected, the radio checks the signal strength of the AF all the time.

#### – **Regional mode ON:**

AF switching or PI SEEK is implemented to the station which have all PI codes same as current station. REG segment is turned on, in LCD display.

#### – **Regional mode OFF**

The regional code in the format of PI code is ignored when AF switching or PI SEEK is implemented.

### 'TA' function (TRAFFIC ANNOUNCEMENT)

When TA mode is on and traffic announcement is transmitted

- When the unit is in CD/MP3 mode, it will switch to radio mode temporarily.
- If the volume level was under the threshold point, it will be raised to the threshold point.
- When TP station is received, TP segment is turned on in LCD display.

### 'PTY' function (PROGRAM TYPE)

You can select PTY mode by turning Volume knob as below.

PTY OFF/NEWS/AFFAIRS/INFO/SPORT/EDUCATE/DRAMA/CULTURE/SCIENCE/VARIED/POP M/ROCK  
M/EASY M/LIGHT M/CLASSICS/OTHER M/WEATHER/FINANCE/CHILDREN/SOCIAL/RELIGION/PHONE  
IN/TRAVEL/LEISURE/JAZZ/COUNTRY/NATION M/OLDIES/FOLK M/DOCUMENT

## DSP SOUND

Turn VOL knob to select DSP mode (Classic, POP, Rock, Flat)

## TA ALARM/SEEK

### TA SEEK mode:

When newly turned station does not receive TP information for 5 sec., the radio retunes to next station which has not the same station (PI) as the last station, but has the TP information.

In TA seek mode, the current station can be changed to the completely different station because the unit searches TP station when the field strength of the current station is very weak, or the current station has no TP signal.

### TA ALARM mode:

Any automatic retune mode is not activated, just can hear Beep sound.

## PI MUTE/SOUND

Action when 2 stations with different programme identification (PI) codes are on the same frequency:

**SOUND:** The radio switches to the new channel for a few seconds and then switches back again

**MUTE:** The radio is muted

## RETUNE L/S

**RETUNE L:** Select 90 seconds as the initial time of automatic TA search.

**RETUNE S:** Select 30 seconds as initial time.

## MASK DPI/ALL

**MASK DPI:** masked only the AF which has different PI.

**MASK ALL:** masked the AF which has different PI and NO RDS signal with field strength.

#### 4. PRESET STATIONS (1-6)

Six numbered preset buttons store and recall stations for each band.

##### **Storing a station:**

1. Select a band (if needed)
2. Select a station
3. Hold a preset button longer than one second. Preset station number appears in the display when station is saved.

##### **Recall a station:**

1. Select band (if needed)
2. Press a preset button for less than one second to select stored station.

**Note:** This unit is equipped with built-in memory I.C. (Integrated Circuits) to save user settings such as tuner preset stations and audio control settings. To cancel these settings, switch to Radio mode, press and hold button "1" for 2 seconds (do not release button) followed by pressing MOD button. Unit will automatically restart after 5 seconds.

#### 5. 'AF/REG' function (ALTERNATIVE FREQUENCIES)

Operation: See the SEL button of the 'AF/REG' function (ALTERNATIVE FREQUENCIES) section.

#### 6. 'TA' function (TRAFFIC ANNOUNCEMENT)

Operation: See the SEL button of the 'TA' function (TRAFFIC ANNOUNCEMENT) section

#### 7. 'PTY' function (PROGRAM TYPE)

Operation: See the SEL button of the 'PTY' function (PROGRAM TYPE) section

#### 8. EQUALIZER (DSP)

Press DSP to select between (Classic, Rock, POP, Flat) equalizer modes.

#### 9. MODE / LOUDNESS BUTTON (LD/MOD)

Press MD to select between: AUX/TUNER/CD-MP3/USB/MMC/SD/AD2P modes.

**LOUDNESS:** Press and hold the button to select LOUDNESS mode.

#### 10. BAND SELECTOR BUTTON (BD)

Push this switch to select the desired band. FM1---FM2---FM3.

#### 11. AUTOMATIC OR MANUAL TUNING (FREQ UP ►► OR ◀◀ FREQ DOWN)

##### **(A) RADIO MODE**

When pressed for less than 1 second, these keys operate as SEEK Tuning mode.

When pressed longer than 1 second, they operate as MANUAL tuning mode.

If the keys are not pressed for 3 seconds, they will return to Automatic mode.

##### **(B) CD/MP3 PLAYER MODE**

When pressed for less than 1 second, these keys operate as TRACK UP or TRACK DOWN mode.

When pressed longer than 1 second, they will operate as CUE or REVIEW mode.

#### 12. AUTOMATICALLY STORE STATIONS (A/PS)

Select six strong stations and store them in current band.

1. Select a band (if needed)
2. Hold A/PS button for more than three seconds. The new stations replace stations already stored in that band.

##### **Preset Scan**

Scan stations stored in current band

1. Select a band (if needed)
2. Hold A/PS for more than one second but less than three seconds. Radio pauses for five seconds at each station. Press A/PS again to stop scanning when desired station is reached.

#### 13. ACTIVE MATRIX DISPLAY

The Active Matrix Display will display the current state of the unit.

#### 14. OPEN PANEL RELEASE BUTTON ( )

Press  button and the front panel will open.

## CD/MP3 CONTROL

### Inserting the CD

Carefully slide the CD or CD-R or CD-RW through the CD slot into the CD compartment. The CD starts playing automatically.

### TRACK/SEARCH BUTTON

#### FORWARD ►► AND REVERSE ◀◀ TRACK SEARCH (11)

Press and release to advance to next track or to return to the beginning of the current track (track number will be displayed). Press and hold to fast forward ►► or reverse ◀◀. Play will begin at the point when you release the button.

### 15. CD SLOT

### 16. CD EJECT BUTTON ( )

Press the EJECT  button to remove the CD. The receiver will automatically switch to radio mode.

### 17. PAUSE BUTTON (PAU)

Press PAU button to pause CD playback. Press again to resume playback.

### 18. REPEAT BUTTON (RPT)

When this button is pressed, 'RPT' indication is displayed and the selected track will be continually repeated until the Track Repeat mode is cancelled by pressing 'RPT' button again.

### 19. INTRO BUTTON (Preview all Tracks) (INT)

When this button is pressed, 'INT' indication is displayed and the first several seconds of each track are played. Press again to stop intro and listen to current track.

### 20. RANDOM BUTTON (RDM)

When this button is pressed, 'RDM' indication is displayed and each track is played in random order instead of normal progression. To cancel RANDOM mode, press 'RDM' button again.

### 21, 22. SEARCH PREVIOUS / NEXT FOLDER: (In case of MP3/WMA files) (FL- / FL+)

Press Button 5: Previous Folder / Press Button 6: Next Folder

## HOW TO SELECT MP3/WMA FILES

### Searching by Track:

- Press "A/PS", then search track is activated.
- Turn "VOL" knob to left or right, select first digit desired.
- Press "VOL" knob, then the first digit is fixed and second digit will flash.
- Turn "VOL" knob to left or right, select 2'nd 3'rd respectively.
- Press "BD/ENT", the song selected will start.

### Searching by Character:

- Press "A/PS" twice, then character search mode is activated.
- Turn "VOL" knob to left or right, you can select the desired letter.
- Press "VOL" knob, repeat steps above for 2'nd 3'rd character.
- The songs with the same character that you selected is displayed.
- Turn "VOL" knob to left or right, you can select the desired song.
- Press "BD/ENT", then the song selected will start.

### Searching by File Name:

- Press "A/PS" 3 times, then folder search is activated.
- Turn "VOL" knob to left or right, you can select the desired folder.
- Press "BD/ENT", then the folder is fixed and the first file will be played.

## Připojení přenosného MP3 přehrávače

### 23,24. USB PORT / SD/MMC MEMORY CARD

The device is equipped with a USB interface and a memory card reader for SD/MMC cards. MP3 or WMA files stored on these media can be played.

1. Plug your USB storage medium into the USB port.
2. If you use a memory card, insert it into the memory card reader.

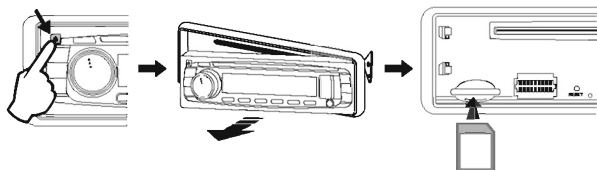

3. The player automatically switches to the input used and starts playback.
4. See the section on operations common for audio files on how to control USB or memory card playback.

#### Note:

- Due to the great variety of devices with USB and SD/MMC card interfaces that sometimes have manufacturer-specific functions, we cannot guarantee that all media will be recognized and that all operational functions will be available with this device.
- You cannot operate USB hard drives on the device.

### 25. FRONT AUX IN

An external audio source (e.g. portable MP3 player) can be connected to the AUX IN socket to be played back by the vehicle loudspeakers.

- Connect the AUX IN socket with the audio output of the external device.

## Memory Backup

This unit is equipped with built-in memory I.C. (Integrated Circuits) to save user settings such as tuner preset stations and audio control settings. Whenever power is unplugged, these settings will not be lost.

## HOW TO USE BLUETOOTH IN YOUR CAR AUDIO

The microphone unit must be connected to the device in order to use the Bluetooth functions. In addition a mobile phone is required that supports the Bluetooth data transmission.

### Connecting the telephone to the device

- Activate the Bluetooth function on your mobile phone and conduct a search for Bluetooth devices. After a successful search the entry **CarBT** appears for the device in the display of the mobile phone.
- Select this entry for the connection and for the subsequent password request enter the password **1234** for the device. You may possibly have to confirm the connection structure once more.

After a successful coupling **CONN OK** appears briefly in the device's display.

### Call accept/end

With an incoming call you hear the call signal via your mobile phone, whilst in the device's display is shown the call number.

- You accept an incoming call by the "☎" button on the device.
- You end the call by pressing the "☎" button on the device.

### Rejecting a call

- With an incoming call press the "☎" button on the device to reject the call.

### To call

- Press the "☎" button on the device. **DIAL** appears in the display.
- With the number buttons on the device enter the telephone number that you want to call.
- Press the "☎" button again. The number is dialled and **CALLING** appears in the display.

## Redial

- Hold down the “” button on the device for approx. 2 seconds.
  - If previously no call number was selected via the number buttons on the device the last selected mobile phone call number is dialled.
  - If previously a call number was selected via the number buttons on the device this call number is dialled.

## Caller lists

Press and hold **SEL** button to select CALL LIST mode.

### Incoming/Outgoing calls:

- Press the **ENT** button. **IN CALL**: Shows the last 20 incoming calls.
- Press the **ENT** button again. **OUT CALL**: Shows the last 20 outgoing calls.

### Telephone book:

You can transfer up to 20 contacts (Telephone book entries) from the connected mobile phone to the device and thus dial and call the contact from the device.

- Turn the **VOL** knob to select telephone book entries.
- Press the **ENT** button. Subsequently **PB01** appears and the name and call number of the first memory slot is shown.
- Press the “” button on the device to select the dialled call number.

### **Deleting the caller lists and telephone book entries**

Press and hold the “” button on the device until **RESET** appears in the display. The Bluetooth connection to the mobile phone is severed and all telephone book entries and caller lists on the device are deleted.

### **Audio streaming (A2DP)**

The device uses the A2DP profile (Advanced Audio Distribution Profile) and therefore can playback your mobile phone's audio data.

- Select an audio file from your mobile phone and start the playback.

In the device's display appears the entry **A2DP** and the audio data will be played back via the speakers connected to the device.

#### **NOTICE:**

- *On the mobile phone it may possibly be necessary to switch playback via the Bluetooth stereo headset. Consult the operating manual of your mobile phone for more information.*
- *With a few mobile phones the device does not automatically switch to the A2DP mode. In this case you switch to the A2DP mode by pressing the **MOD** button several times until the notice **BT MUSIC** or **A2DP** appears in the display.*

### **AVRCP (Audio Video Remote Control Profile)**

The device uses the AVRCP profile thus facilitating the control of audio devices.

- With the Preset 1(17) button on the device you can stop and/or restart the playback of audio files on the mobile phone.
- With the buttons **◀◀** or **▶▶** on the device or on the remote control you can access the previous or next audio file on the mobile phone

# TECHNICAL SPECIFICATIONS

## CD/MP3 PLAYER SECTION

Signal to Noise Ratio	> 60 dB
Channel Separation	> 50 dB (1kHz)
Frequency Response	20 Hz - 20 kHz

## TUNER FM

Frequency range	87.5-108 MHz
Channel step	50 kHz
Sensitivity	2.8 $\mu$ V
Stereo separation	30 dB
Signal to noise ratio	50 dB

## LINE-OUT

Output	1.5V (max.)
Impedance	10k Ohm

## GENERAL

Power Supply	12V DC (10.8-15.6V allowable)
Speaker impedance	4 or 8 Ohm
Output power	40W $\times$ 4CH
Fuse	10A

**Note:** Specification and the design are subject to possible modification without notice due to improvements.

## Instructions for the correct disposal of the product

---

### INSTRUCTIONS AND INFORMATION REGARDING THE DISPOSAL OF USED PACKAGING MATERIALS

Dispose of packaging material at a public waste disposal site.

### DISPOSAL OF USED ELECTRICAL AND ELECTRONIC APPLIANCES



The meaning of the symbol on the product, its accessory or packaging indicates that this product shall not be treated as household waste. Please, dispose of this product at your applicable collection point for the recycling of electrical & electronic equipment waste. Alternatively in some states of the European Union or other European states you may return your products to your local retailer when buying an equivalent new product.

The correct disposal of this product will help save valuable natural resources and help in preventing the potential negative impact on the environment and human health, which could be caused as a result of improper liquidation of waste. Please ask your local authorities or the nearest waste collection centre for further details. The improper disposal of this type of waste may fall subject to national regulations for fines.

#### For business entities in the European Union

If you wish to dispose of an electrical or electronic device, request the necessary information from your seller or supplier.

#### Disposal in other countries outside the European Union

If you wish to dispose of this product, request the necessary information about the correct disposal method from local government departments or from your seller.



This appliance complies with EU rules and regulations regarding electromagnetic and electrical safety.

Changes to the text, design and technical specifications may occur without prior notice and we reserve the right to make these changes.