

EN CZ SK HU PL

## CONTROL PANEL LAYOUT

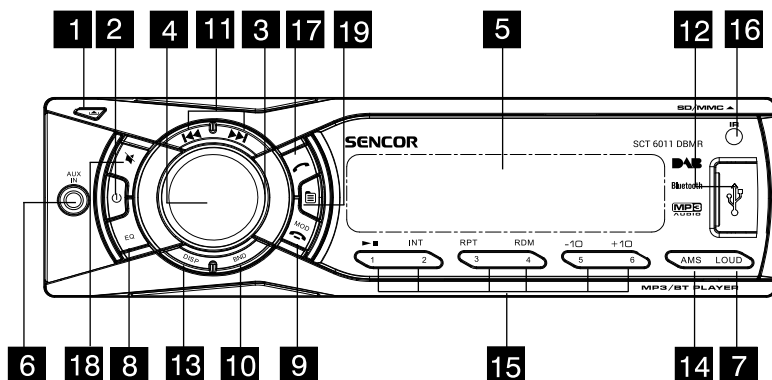

- |   |                           |
|---|---------------------------|
| 1. Release Button   | 12. USB Port              |
| 2. Power Button   | 13. Disp Button           |
| 3. Volume Control   | 14. Preset Stations/AMS   |
| 4. Setting the Sound Characteristics  | 15. Number Button         |
| 5. LCD Display  | 16. Remote Control Sensor |
| 6. AUX IN   | 17. Telephone Button      |
| 7. Loud Button  | 18. Mute Button           |
| 8. EQ Button  | 19. Menu Button           |
| 9. Mode Switch/Hang up Button (AM/FM – DAB – Bluetooth – USB – SD – AUDIO IN) |                           |
| 10. Band Button   |                           |
| 11. Tune/Select Tracks  |                           |

## INSTALLATION

- Before final installation, connect the wiring temporarily and make sure it is all working properly.
- Use only the parts included with the unit to ensure proper installation. The use of unauthorized parts can cause malfunctions.
- This item must be installed by an authorized dealer in order to keep the warranty valid.
- Install the unit where it does not get in the driver's way and cannot injure the passenger if there is a sudden stop, like an emergency stop.
- Avoid installing the unit where it would be subject to high temperature, such as direct sunlight, or hot air, heater or where it would be subject to dust dirt or excessive vibration.
- Be sure to remove the front panel before installing the unit.

### DIN FRONT/REAR-MOUNT

This unit can be properly installed either from Front (conventional DIN Front-mount) or Rear (DIN Rear-mount installation, utilizing threaded screw holes at the sides of the unit chassis). For details, refer to the following illustrated installation methods A and B.

- **DIN FRONT-MOUNT (Method A)**  
Installation the unit

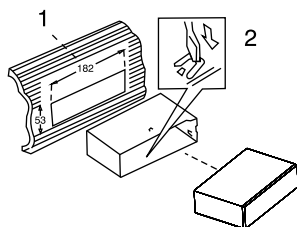

1. Dashboard
2. Holder

After inserting the half sleeve into the dashboard, select the appropriate tab according to the thickness of the dashboard material and bend them inwards to secure the holder in place.

**Removing the unit**

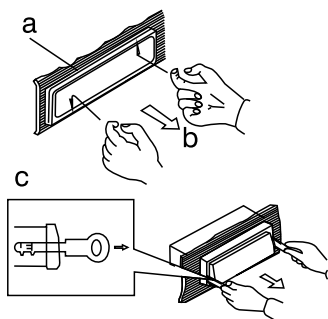

- a. Frame
- b. Insert fingers into the groove in the front of frame and pull out to remove the frame. (When re-attaching the frame, point the side with a groove down wards and attach it.)
- c. Insert the levers supplied with the unit into the grooves at both sides of the unit as shown in figure until they click. Pulling the levers makes it possible to remove the unit from the dashboard.

- **DIN REAR-MOUNT (METHOD B)**

Installation using the screw holes on the sides of the unit.  
Fastening the unit to the factory radio mounting bracket.

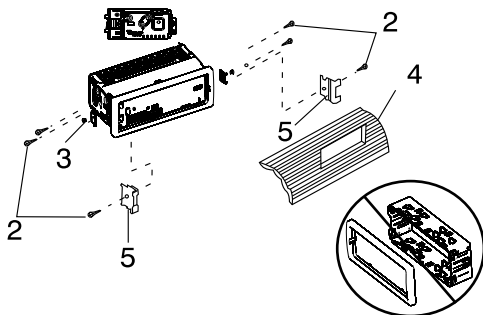

1. Select a position where the screw holes of the bracket and the screw holes of the main unit become aligned (are fitted) and tighten the screws at 2 places on each side.
2. Screw
3. Factory radio mounting bracket.
4. Dashboard or Console
5. Hook (Remove this part)

Note: the mounting box, outer trim ring, and half-sleeve are not used for method B installation.

## 2. DETACHABLE CONTROL PANEL (D.C.P.)

### Removing The Detachable Control Panel (D.C.P.).

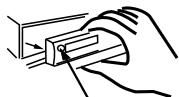

PANEL RELEASE BUTTON

1. Turn the power off
2. Press the D.C.P release button
3. Remove the D.C.P

### Attaching the DCP

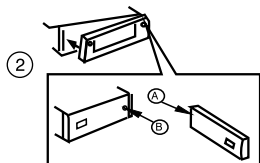

1. Attach the panel at the right side first, with point B on the main unit touching point A on the D.C.P (As shown on the diagram).
2. Then press the left side of D.C.P onto the main unit until a click sound is heard.

### CAUTION

- DO NOT insert the D.C.P from the left side. Doing so may damage it.
- The D.C.P can easily be damaged by shocks. After removing it, place it in a protective case and be careful not to drop it or subject it to strong shocks.
- When the release button is pressed and the D.C.P is unlocked, the car's vibrations may cause it to fall. To prevent damage to the D.C.R always store it in a protective case after detaching it.
- The rear connector that connects the main unit and the D.C.P is an extremely important part. Be careful not to damage it by pressing on it with fingernails, pens, screwdrivers, etc.

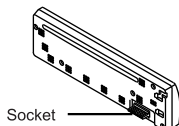

#### Note:

If the D.C.P is dirty, wipe off the dirt with soft, dry cloth only. And use a cotton swab soaked in isopropyl alcohol to clean the socket on the back of the D.C.P

## ELECTRICAL CONNECTION

- a. Make sure your car battery is a 12 volt (6 filler caps) negative ground system (if not, a converter will be necessary).
- b. Before starting wiring connections, disconnect the power supply by removing the fuse from the fuse box.
- c. Connect the power wire to one of the extra terminals of the fuse box.
- d. Connect the black ground wire to a metal part of the car. It is important to make good contact.
- e. Make other wiring connections as shown.
- f. If your car does not have ISO connector, you can procure it from any car accessory shop.

**Notes: INCORRECT WIRING OR OPERATION WILL AVOID THE WARRANTY OF THIS UNIT.**

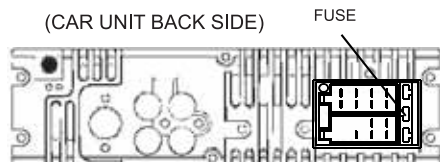

#### Fuse Replacement:

To replace the fuse, pull out the blown fuse from the socket. Insert a new one with same rating

# GENERAL OPERATION

## POWER ON/OFF BUTTON (⏻)

Press POWER button or any other button on the front of the radio to turn the unit on.

Press POWER button again to turn the unit off.

## MENU BUTTON

Press MENU Button to navigate through the menu items, (RDS on/off • PTY • AF on/off • TA on/off • CT on/off • LOC on/off • AREA europe/asia/Mideast/aust/usa • DISCON bluetooth • CLK display • 24h/12h • BEEP on/off) while the desired menu item is displayed, use Volume control to adjust the selected function:

Under normal listening (no MENU displayed) has repeatedly pushed Rotary control these functions

- **VOLUME (VOL) -> BASS (BAS) -> TREBLE (TRE) -> BALANCE (BAL) -> FADER (FAD) -> SUB-W (on/off)**

Rotate Volume Control to adjust desired level within 3 seconds.

## - LOC/DXMODE

Use this mode to change between Local and Distant (DX) tuning mode. Local mode improves reception in some areas where the signal is too strong.

## - BEEP MODE (BEEP ON / OFF)

BEEP OFF: disable audible beep tone when any function is accessed.

BEEP ON: enable audible beep tone.

## EQ BUTTON (PRESET EQUALIZER)

**FLAT (off) -> POP -> USER -> TECHNO -> ROCK – CLASSIC -> JAZZ -> VOCAL**

At DSP off mode preset equalizer will be controlled by Bass / Treble setting.

## LOUD BUTTON

Use this LOUDNESS control to increase bass output.

## TELEPHONE BUTTON

Press this button to answer / accept the call.

During the talking, press and hold to transfer the call.

## HANDS UP BUTTON

Press this button to reject / end the call.

## SUB-WOOFER ON/OFF

Press SELECT button for more than 3 seconds to activate or turn off SUB-woofer (Sub-woofer on/off is an optional feature)

## - SWITCHING BETWEEN LATIN AND EUROPE FREQUENCY

In Radio mode, Press MENU button until "LATIN" or "AREA EUR" is displayed. Rotate Volume Knob to switch between LATIN and (Europe) frequency. Leave it for 3-4 seconds until current frequency menu resumes or press any button to continue operation. Every time desired area frequency is selected, frequency and tuning step will be switched to corresponding settings automatically.

## MOD BUTTON

- Press this button to select different sources, sequence as follow:
  - A) Radio mode (AM/FM)
  - B) DAB mode
  - C) BT AUDIO (Bluetooth)
  - D) USB playback
  - E) SD playback
  - F) AUDIO IN (AUX)

## FRONT AUXINPUT

Connect the external device to the front 3.5mm jack on front panel, then press Mode button to select AUDIO IN mode. Press Mode button again to cancel this Mode and return to previous mode.

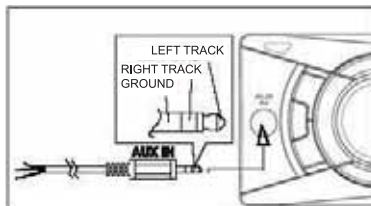

## DISP BUTTON

Press DISP button once to display current playing status (e.g. Frequency of Radio/AUX/Music information (Elapsed time and ID3) of USB/SD-MMC play).

- During USB / SD-MMC play, Elapsed time and ID3 tag of current track will be displayed in sequence.

## AUTO MEMORY STORE BUTTON (AMS)

AUTO MEMORY STORE: Press AMS button long to enter Auto Store mode, this feature will automatically scan the current band and enter up to 6 strongest stations into the 6 preset memories. To stop Auto Store & Scan, press the AMS button again.

## TUNING UP / DOWN BUTTON (◀◀▶▶)

Press this button to search for radio stations.

## BAND BUTTON

Press this button to change between bands FM1, FM2, FM3, MW1, MW2(AM).

## RESET BUTTON

The RESET button is located on the front panel (as shown on the diagram). To press it vertically with a ballpoint pen or metal object will activate it. The reset button is to be activated for the following reasons:

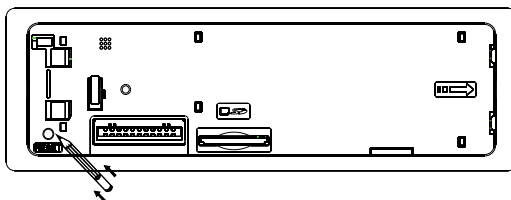

- Initial installation of the unit when all wiring is completed.
- All the function buttons do not operate.
- Error symbol on the display.

**Note:** If the unit cannot function normally after resetting, please use a cotton swab soaked in isopropyl alcohol to clean the socket on the back of the control panel.

## LIQUID CRYSTAL DISPLAY PANEL (LCD)

The LCD panel display the frequency, time and activated functions.

### NOTE:

It is a characteristic of LCD panel that if subjected to cold temperatures for an extended period of time, they will take longer time to illuminate than under normal conditions, in addition, the visibility of the numbers on the LCD may slightly decrease. The LCD read-out will return to normal when temperatures increase to a normal range.

## STATION PRESET BUTTONS (M1-M6)

You can store & recall six preset radio stations by pressing M1-M6 buttons

TO STORE A STATION:

- 1) select a band (if needed)
- 2) select a station by tuning up / down button
- 3) hold a preset button which you want store the station for at least 2 seconds.  
The preset number will appear on the display accompanied by a beeps sound.

TO RECALL A STATION:

- 1) select a band (if needed)
- 2) press a preset button briefly to recall the stored station.

## MP3/SD/USB OPERATIONS

### M1) PLAY/PAUSE AND FIRST TRACK BUTTON

Press this button briefly to pause MP3 play, press again to release pause.

### M2) INTRO SCAN BUTTON

Press this button to select Intro Scan function, the first 10 seconds of each track will be played sequentially until this button is pressed again, then normal play will resume at the current track.

### M3) REPEAT BUTTON

Pressing this button will activate Repeat Function in the following order:

Repeat On → Repeat Off

### M4) RANDOM PLAYBUTTON

When random play mode is selected, the tracks will be played in random order, press this key one more time to cancel random play mode.

### M5/6) TRACK UP AND TRACK DOWN BUTTON (-10/+10)

Under normal play mode, press the Track Up Button for less than 1 second to skip the playback to the next track, or press the Track Down Button for less than 1 seconds to return to the beginning of the current track, press this button one more time to skip to the previous track.

When any of these buttons is pressed for more than 1 second, the MP3 player will enter Cue/Review mode, this is indicated by the flashing track number on the LCD. When the key is released, normal play will resume.

## MMC/SD CARD & USB DEVICE OPERATIONS

### START THE USB DEVICE MODE

1. The USB socket is accessible as indicated in picture 1. (R1)
2. Plug in the USB drive / Switch to USB PLAY by push of MODE key device completely as indicated in picture 2(R2) and display will show READING to indicate that the USB drive / device is being plugged in correctly & the download has begun.
3. All the USB files playback function is same as normal MP3 files playback.

**Warning:** Excessive weight or size USB drive/device may cause permanent & serious damage to the unit and may cause access to the buttons on the front panel impossible. User must use an extension cable (provide by USB device manufacturer) to connect with USB socket to prevent any damage cause.

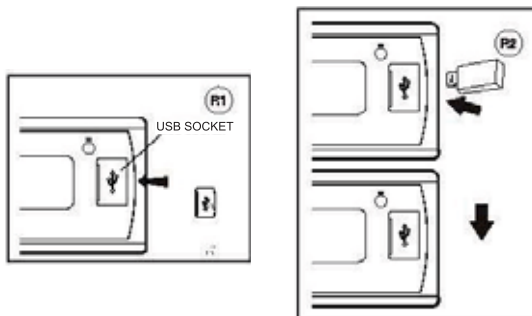

## TO STOP USB PLAYBACK

1. The USB drive / device is unplugged, the unit will stop playback.  
Or user can use mode button to switch to other mode.
2. User can use the mode button to choose USB mode (only if USB drive / device is inserted in the unit) or any other modes, when they are in any mode.

## USB SPECIFICATION

- \* SUPPORT MAX 32G USB FLASH MEMORY
- \* SUPPORT MAX 9999 SONGS
- \* USB 1.1 DEVICE SUPPORT
- \* USB 2.0 DEVICE SUPPORT (TRANSFER SPEED SAME AS VER 1.1)
- \* FILE MANAGER: FAT12/FAT16/FAT32
- \* CURRENT SUPPLY: MAX 500mA

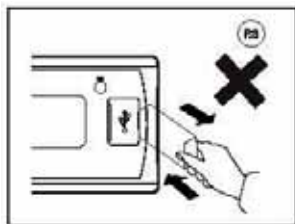

## CAUTION

1. Always unplugged the USB gently from the unit, excessive force used will cause permanent & serious damage to the unit & the USB drive / device.

## COMPATIBILITY

Due to the fast changing technology world, this unit may or may not be compatible to all the USB drive / device available with all the future technology, especially those USB drive / device which require to install a driver. Always choose a compatible USB drive / device which is compatible with this unit.

## NOTE:

This unit is not compatible with portable Hard-Disc.

## START THE SD MODE

1. The Micro SD card slot is located behind the front panel as indicated in (R4).
2. Insert the Micro SD card into the card slot in the correct direction until a CLICK sound is heard.
3. Select the SD PLAY by repeated push of MODE key.
4. All the SD files playback function is same as normal MP3 files playback.

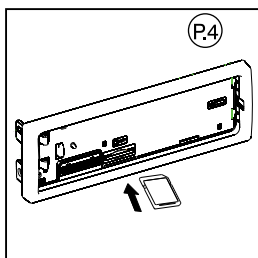

## TO STOP SD CARD PLAYBACK

1. Push on the end of the SD card to eject the SD card. Once the SD card is taken out.
2. User can use the mode button to choose SD mode (only if SD is inserted in the unit) or any other modes, when they are in any mode.



#### SD/MMC SPECIFICATION

- \* SUPPORT MAX 32G SD/MMC CARD
- \* SUPPORT MAX 9999 SONGS
- \* FILE MANAGER FAT12, FAT16, FAT32 SUPPORTED

#### CAUTION

2. Please make sure to insert the Micro SD card in the correct direction / orientation as indicated in picture 6(R5). Wrong insert will cause permanent & serious damage to the unit & the Micro SD card.

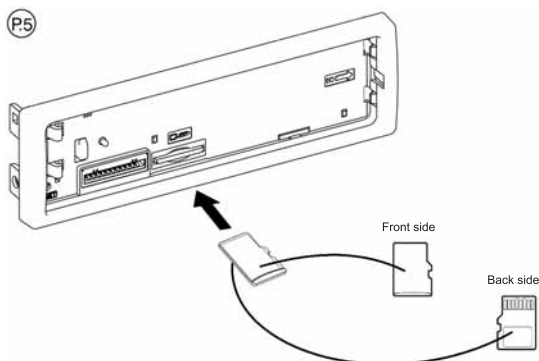

## BLUETOOTH OPERATION INSTRUCTION

#### Communication

1. Select BT audio source by repeated push of MODE key. Display shows message "NODEVICE". Turn on Bluetooth function on user's mobile and select Bluetooth name "SCT 6011DBMR".
2. Wait until paired and connecting is Unit display shows "PAIRED" after Bluetooth successful connected with user's mobile.

#### Operation

1. Incoming call telephone numbers will be displayed on the LCD. Press the green colour mark button to receive the call and when the call is finished, press the red colour mark button to hang up.
2. When the call phone is playing music, adjust the panel to BT MUSIC and turn to Bluetooth Music Mode and the unit will play the music which is stored in the cellphone (Note: Some cellphones do not support BT function and Bluetooth Music Mode).

## LISTENING TO THE DIGITAL AUDIO BROADCASTS (DAB)

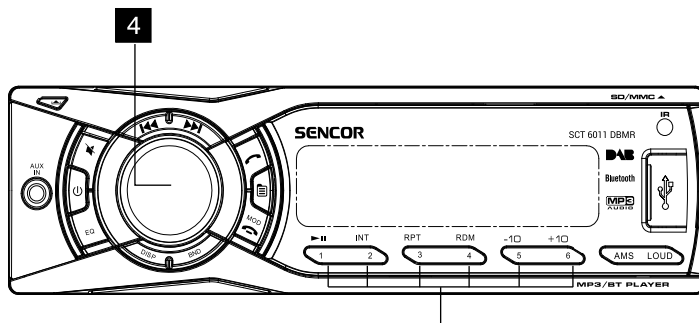

- Hold for about 2 seconds to memorize the current station.
- Press briefly to recall memorized station.

1. Press MOD on the main unit repeatedly to select DAB.
2. Under DAB mode, press enter (4) button to sect scan.
3. Press ◀▶/▶▶ repeated until the desired channel/frequency appears.

Item	Selectable Setting - push MODE key
SCAN ◀	Press (4) Button to confirm, The system scan for all available DAB stations and broadcasts the first station.
RESET ◀	Press (4) Button to confirm, The 18 strongest stations of the selected band DAB 1, 2, 3 are saved in channel manual.
12V	<div> <div></div> <div>ANTENNA OFF: Select when using the DAB aerial without the booster.</div> </div> <div> <div></div> <div>ANTENNA12V: Select when using the DAB aerial with the booster (12V).</div> </div>

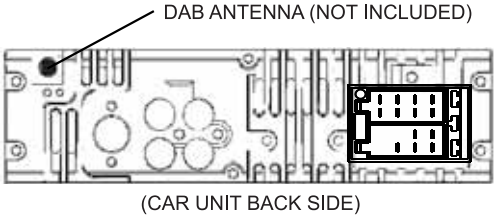

## SPECIFICATIONS

### RADIO SECTION

#### FM

Frequency Range	87.5- 107.9 MHz (USA) 87.5- 108.0 MHz (EUR)
Usable Sensitivity	Better than 10dB at S/N 30dB
Stereo Separation	35 dB AT 1 kHz
S/N Ratio	50 dB

#### AM (MW)

Frequency Range	530-1710 KHz (USA) 522-1620 KHz (EUR)
Usable Sensitivity	Better than 45dB
S/N Ratio	40 dB

#### DAB

Frequency Range:	174.928MHz to 239.200MHz
Usable Sensitivity:	<- 93dB
Stereo Separation:	50dB
S/N Ratio:	65dB

### GENERAL

Power Supply	DC 11 - 14V
Polarity	Negative Ground
Speaker impedance	4 Ω
Power Output	50W × 4

**REMARK:**  
**Specifications subject to change without notice.**

## **INSTRUCTIONS AND INFORMATION REGARDING THE DISPOSAL OF USED PACKAGING MATERIALS**

Dispose of packaging material at a public waste disposal site.

## **DISPOSAL OF USED ELECTRICAL AND ELECTRONIC APPLIANCES**



The meaning of the symbol on the product, its accessory or packaging indicates that this product shall not be treated as household waste. Please, dispose of this product at your applicable collection point for the recycling of electrical & electronic equipment waste. Alternatively in some states of the European Union or other European states you may return your products to your local retailer when buying an equivalent new product. The correct disposal of this product will help save valuable natural resources and help in preventing the potential negative impact on the environment and human health, which could be caused as a result of improper liquidation of waste. Please ask your local authorities or the nearest waste collection centre for further details. The improper disposal of this type of waste may fall subject to national regulations for fines.

### **For business entities in the European Union**

If you wish to dispose of an electrical or electronic device, request the necessary information from your seller or supplier.

### **Disposal in other countries outside the European Union**

If you wish to dispose of this product, request the necessary information about the correct disposal method from local government departments or from your seller.



This product meets all the basic EU regulation requirements that relate to it.

Changes to the text, design and technical specifications may occur without prior notice and we reserve the right to make these changes.

# SENCOR®

## EN Warranty conditions

Warranty card is not a part of the device packaging.

This product is warranted for the period of 24 months from the date of purchase to the end-user. Warranty is limited to the following conditions. Warranty is referred only to the customer goods using for common domestic use. The claim for service can be applied either at dealer's shop where the product was bought, or at below mentioned authorized service shops. The end-user is obligated to set up a claim immediately when the defects appeared but only till the end of warranty period. The end user is obligated to cooperate to certify the claiming defects. Only completed and clean (according to hygienic standards) product will be accepted. In case of eligible warranty claim the warranty period will be prolonged by the period from the date of claim application till the date of taking over the product by end-user, or the date the end-user is obligated to take it over. To obtain the service under this warranty, end-user is obligated to certify his claim with duly completed following documents: receipt, certificate of warranty, certificate of installation.

### **This warranty is void especially if apply as follows:**

- Defects which were put on sale.
- Wear-out or damage caused by common use.
- The product was damaged by unprofessional or wrong installation, used in contrary to the applicable instruction manual, used in contrary to legal enactment and common process of use or used for another purpose which has been designed for.
- The product was damaged by uncared-for or insufficient maintenance.
- The product was damaged by dirt, accident of force majeure (natural disaster, fire, and flood).
- Defects on functionality caused by low duality of signal, electromagnetic field interference etc.
- The product was mechanically damaged (e.g. broken button, fall).
- Damage caused by use of unsuitable media, fillings, expendable supplies (batteries) or by unsuitable working conditions (e.g. high temperatures, high humidity, quakes).
- Repair, modification or other failure action to the product by unauthorized person.
- End-user did not prove enough his right to claim (time and place of purchase).
- Data on presented documents differs from data on products.
- Cases when the claiming product cannot be indentified according to the presented documents (e.g. the serial number or the warranty seal has been damaged).

### **Authorized service centers**

Visit [www.sencor.eu](http://www.sencor.eu) for detailed information about authorized service centers.