

SENCOR®

SFP 4408

User's manual

MP3 PLAYER



EN

Before operating this unit, please read all instructions.

SAFETY INSTRUCTIONS

This user's manual contains important safety instructions and information related to correct device use. To prevent any accident, please read it carefully and make sure you have understood all instructions.

Don't expose this device to extreme temperatures and in particular, don't leave in a vehicle with closed windows in summer.

Do not store the device in moist or contaminated environment.

Take care not to drop the device on the floor or expose it to a severe impact. Do not shake the screen forcefully, otherwise damage to the screen or faulty image may occur.

Set volume to a reasonable level. During use, do not raise the headphone volume level too high. If you feel ringing in your ears, stop using the device or turn the volume down.

Do not disassemble this device on your own and do not clean the surface with alcohol or benzene.

Do not use this device in places where using electronic devices is forbidden, such as in an aircraft.

Do not use this device while driving a vehicle or walking on street.

SFP 4408 DESCRIPTION

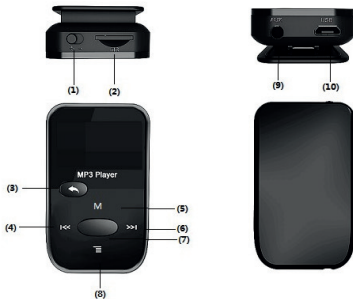

No.	Button	Button function
①		Power on-off
②		MicroSD card slot
③		Return/Quit
④	⏮	Previous
⑤	M	Menu
⑥	⏭	Next
⑦	⏸	Play/Pause
⑧	VOL (Volume)	Volume/Lock/Unlock
⑨		Headphone connector
⑩		MicroUSB socket

CHARGING THE BATTERY

This player is equipped with an internal battery that must be fully charged before first use. Connect one end of the USB cable (supplied) to the MP3 player, then connect the other end to a functional running PC. The battery charging will start. The charging takes about 2 hours. To extend the battery lifetime, we recommend to fully charge the battery before each use.

NOTE:

Connect the USB cable directly to the PC USB socket (not in the hub) to avoid malfunction to the player connection.

PC CONNECTION

Connect your player to the PC using the supplied USB cable. The PC will detect your device automatically. Once detected by the PC, your player will appear as an external drive. This is why the file transfer is being made just like in any other memory device (select the files to be copied and drag them to your device or use the copy and paste feature).

NOTE:

Do not disconnect your player while copying or deleting is in progress to avoid damage to your device and software failure. To disconnect your device from the PC, please use the "Remove hardware safely" icon on the bottom right of the main panel. Once the safety message is displayed, you can disconnect the device.

MUSIC

1. To open the music window, press the "M" button, to start music playback, press ►|| button.
2. Select music: press the | ◀◀ / ▶▶ | to select previous or next track.
3. To adjust volume level: press the "Vol" button briefly, then use the | ◀◀ / ▶▶ | to increase/decrease the volume or long press the "Vol" button to lock/unlock the player.
4. During music playback, press the M button briefly to open the nested menu or long press the M button to close the music window.
5. Hold the ►|| button to turn the player on/off (this is used to end the listening and then resume from the same point).
6. Hold the buttons | ◀◀ / ▶▶ | to fast rewind/forward.
7. To delete a file: To delete a file in the nested menu, press the M button while the music playback is stopped, select the file to be deleted, then press the "M" button to confirm.

RECORDING

1. Press the "M" button to open the recording window.
2. Press the ►|| button to start the recording function.
3. To pause the recording, press the ►|| again, press the Return/Quit button the save the recorded file.
4. Press the M button to open the nested menu and set the recording type.

PLAYBACK

1. Identical environment as in the "Music" mode.
2. You can only play the files recorded in the "Record" mode.

RADIO

1. Press the "M" button to open the FM radio window.
2. Press the "M" button to open the window's nested menus: Save, Record, Delete, Delete all, Auto-search, Normal band, Japan band, Exit.
3. Tuning mode (TUNE): Press the | ◀◀ / ▶▶ | button to increase/decrease the frequency step by step until a channel is found.
Automatic search: To save the found stations, press to ►|| to skip to a next saved station.

NOTE:

Before using the FM radio, please connect your headphones as they act as an antenna.

TEXT

1. Press the "M" button to open the Text window.
2. Press the | ◀◀ / ▶▶ | buttons to browse through the .txt files.
3. Press ▶|| button to enable file reading.
4. Press the | ◀◀ / ▶▶ | buttons to page the text up and down manually.
5. Press the M button to open the nested menu, then use Save Bookmark or Load Bookmark function.

SETTING UP

1. Press the "M" button to open the Setting window.
2. Press | ◀◀ / ▶▶ | buttons to select one of the following modes:
 - Time and date.
 - Backlight time adjustment.
 - Required language selection.
 - Selecting turn off time at idle and automatic power off.
 - Setting display contrast.
 - Memory usage information.
 - Internal memory formatting.
 - Firmware version information.

TROUBLESHOOTING

Symptom	Solution
The player doesn't work	<ol style="list-style-type: none">1. Charge the battery2. Please check if the power button is in the on position.3. Please check if the volume is not set to "0" and make sure that the headphones are connected correctly.4. Damaged music data may generate noise; make sure that the files in the player are not damaged.
The player cannot record/download files	Please make sure that the USB cable is connected correctly.
The player fails to record	Please check if there is enough memory available. Charge the battery.
Strange characters are displayed	Please check if a correct language has been selected.
Unclean FM radio signal	Adjust the position of player and headphones. The headphones can be used as an antenna for signal reception

TECHNICAL SPECIFICATIONS

Screen size	1.1" LCD display (128 x 64)	
Internal memory	8 GB	
Supported audio formats	MP3, WMA	
Data stream	MP3/WMA	8 – 320kb/s
FM radio with 30 memory presets. Voice recording format:	WAV	
Internal battery capacity	170mAh Li-polymer battery	
Headphone power output	5 + 5mW	
Micro USB	2.0	
Support	Windows (8/7, Vista, XP), Mac OS x (10.6 or older), Linux	
Dimensions	54 x 33 x 16 mm (H x W x D)	
Weight	21.2g	

RECYCLING



This symbol means that the relevant electronic product or battery must not be discarded in common household waste in Europe. In order to correctly process the product and battery waste, please dispose of it in accordance with the local laws or requirements to regulate the disposal of electric and electronic equipment and batteries. This will help to protect natural resources and improve the environmental protection standards in view of ecological waste handling and disposal (The Waste Electrical and Electronic Equipment Directive).

CE MARKING



This product meets the EU requirements.

Text, design and technical specifications may change without prior notice and we reserve the right to make changes.

The original version is Czech.

Address of the manufacturer: FAST ČR, a. s., Černokostelecká 1621, Říčany CZ-251 01

SENCOR®

EN Warranty conditions

Warranty card is not a part of the device packaging.

This product is warranted for the period of 24 months from the date of purchase to the end-user. Warranty is limited to the following conditions. Warranty is referred only to the customer goods using for common domestic use. The claim for service can be applied either at dealer's shop where the product was bought, or at below mentioned authorized service shops. The end-user is obligated to set up a claim immediately when the defects appeared but only till the end of warranty period. The end user is obligated to cooperate to certify the claiming defects. Only completed and clean (according to hygienic standards) product will be accepted. In case of eligible warranty claim the warranty period will be prolonged by the period from the date of claim application till the date of taking over the product by end-user, or the date the end-user is obligated to take it over. To obtain the service under this warranty, end-user is obligated to certify his claim with duly completed following documents: receipt, certificate of warranty, certificate of installation.

This warranty is void especially if apply as follows:

- Defects which were put on sale.
- Wear-out or damage caused by common use.
- The product was damaged by unprofessional or wrong installation, used in contrary to the applicable instruction manual, used in contrary to legal enactment and common process of use or used for another purpose which has been designed for.
- The product was damaged by uncared-for or insufficient maintenance.
- The product was damaged by dirt, accident of force majeure (natural disaster, fire, and flood).
- Defects on functionality caused by low duality of signal, electromagnetic field interference etc.
- The product was mechanically damaged (e.g. broken button, fall).
- Damage caused by use of unsuitable media, fillings, expendable supplies (batteries) or by unsuitable working conditions (e.g. high temperatures, high humidity, quakes).
- Repair, modification or other failure action to the product by unauthorized person.
- End-user did not prove enough his right to claim (time and place of purchase).
- Data on presented documents differs from data on products.
- Cases when the claiming product cannot be indentified according to the presented documents (e.g. the serial number or the warranty seal has been damaged).

Authorized service centers

Visit www.sencor.eu for detailed information about authorized service centers.