



EN ■ User Manual

CZ ■ Uživatelská příručka

SK ■ Používateľská príručka

HU ■ Felhasználói kézikönyv

PL ■ Podręcznik użytkownika

**CAR RADIO WITH BLUETOOTH**

**AUTORÁDIO S BLUETOOTH**

**AUTORÁDIO S BLUETOOTH**

**AUTÓRÁDIÓ BLUETOOTH-SZAL**

**RADIO SAMOCHODOWE  
Z BLUETOOTH**

# TABLE OF CONTENTS

|   |    |
|---|----|
| 1. Safety.....                            | 1  |
| 2. Preparation .....                      | 1  |
| 3. Included contents.....                 | 2  |
| 4. Installation of the device .....       | 3  |
| 5. Installation/Connection .....          | 4  |
| 6. Basic controls .....                   | 6  |
| 7. Setting functions .....                | 7  |
| Listening to the radio .....              | 8  |
| Listening from USB devices / SD card..... | 9  |
| Listening from external components.....   | 10 |
| 8. Using Bluetooth .....                  | 11 |
| 9. Product information.....               | 12 |

# 1. SAFETY

## WARNING

Stop the motor vehicle before operating this device.

### Important information:

- To prevent a short circuit, never insert metal items into the device (for example coins or metal tools), or leave any lying on the device.
- **Attention:** Set the volume so that you can hear the noise outside the motor vehicle. Driving with volume set too high may result in an accident.
- **Condensation:** If the motor vehicle has air conditioning, water may condensate on the laser lens. This may cause disc reading errors. In the event that this situation occurs, remove the disc and wait for the moisture to evaporate.
- The pictures in this user's manual are examples used to clearly explain the way the controls are used. Therefore, the picture may differ from the actual device.
- If you come across any problems during the installation, please contact the Sencor vendor.
- Prior to purchasing external components, check with your Sencor vendor that they will be compatible with your model and work in your location.

### Maintenance:

Cleaning the device: Remove any dirt or grime from the panel using dry silicone or a fine wiping cloth. Not following this safety measure may result in damage to the monitor or device.

Cleaning connectors: Remove any dirt or grime from the device's connector and front panel. Use a cotton bud or wiping cloth.

# 2. PREPARATION

How to attach/remove the front panel:

## Attaching

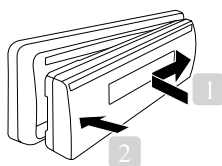

## Removing

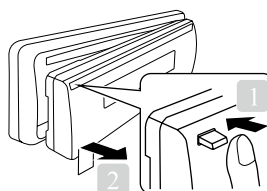

- \* Do not expose the front panel to direct sunlight, excessive heat or humidity. Likewise, avoid locations that are excessively dusty or where there is a risk of splashing by water.
- \* After removing it, store the front panel in its case.
- \* The front panel is a highly precise part of the device that can be damaged by vibrations or impacts.
- \* To prevent the deterioration of the device's characteristics, do not touch its terminal or those on the front panel with your fingers.

## How to reset the device:

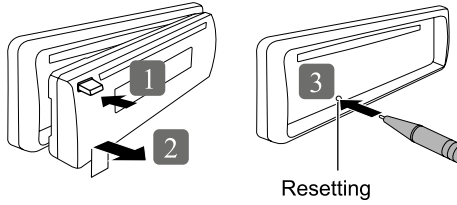

- \* If the device is not working correctly, press the reset button.
- \* When the reset button is pressed, the factory settings will be restored.

## 3. INCLUDED CONTENTS

### Check the device's package contents:

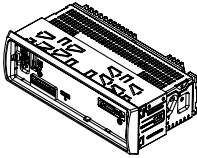

Main unit (with an installation frame)

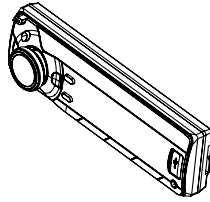

Front panel

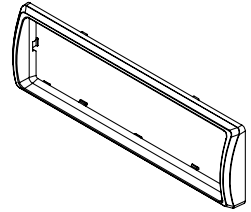

Front frame

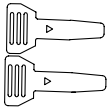

Removal tool (2 pcs)

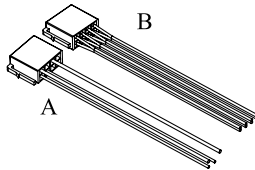

ISO connector (A/B)

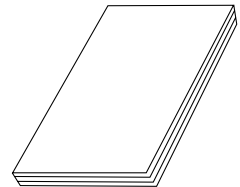

User's manual

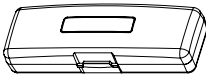

Panel case  
(for the front panel)

## 4. INSTALLATION OF THE DEVICE

1

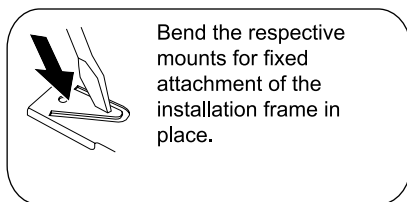
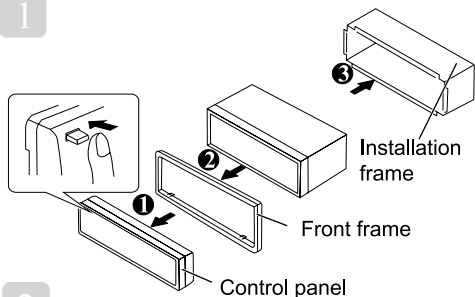

2

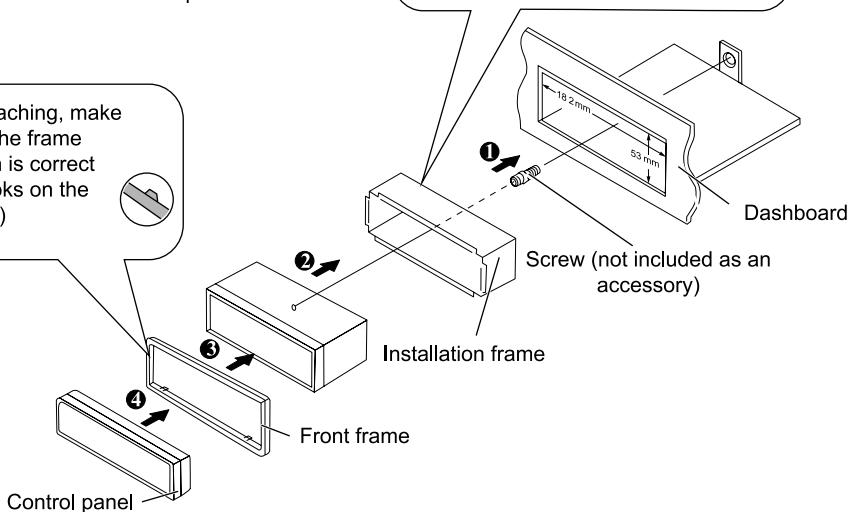
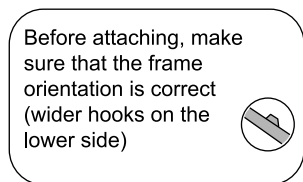

1. Remove the control panel.
2. Place the catch pin on the removal tool into the holes on both sides of the frame and then pull the frame out.
3. Insert the removal tool deep into the holes on both sides and then proceed according to the arrows in the figure on the right.

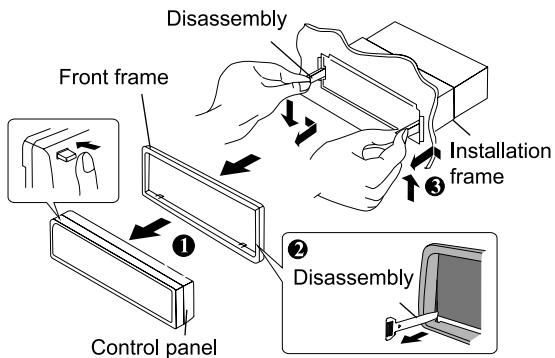

## 5. INSTALLATION/CONNECTION

### Basic procedure:

1. Pull the key out of the ignition and then disconnect the  $\ominus$  terminal on the car battery.
2. Correctly connect the input and output wires.
3. Install the device into the motor vehicle.
4. Reconnect the  $\ominus$  terminal on the car battery.
5. Reset the device.

### Warning:

- This device may only be installed in a motor vehicle with a 12 V DC power supply and a grounded negative pole.
- If you connect the ignition wire (red) and the battery wire (yellow) to the vehicle's chassis (grounding), you may cause a short circuit, which may subsequently cause a fire. Always connect these wires to the power source via a fuse box.
- Prior to installing the device, disconnect the negative battery terminal and perform all electrical connections.
- Insulate unconnected wires using vinyl tape or another similar material. To prevent a short circuit, do not remove the covers on the ends of unconnected wires or terminals.
- After installation, do not forget to ground this device again to the vehicle's chassis.
- If the power supply is not turned on, the cause may be a short circuit of the speaker wire or its contact with the chassis of the vehicle and the activation of the protective function. Therefore, it is necessary to check the speaker wire.

### Attention:

- If your vehicle's ignition does not have the ACC position, connect the ignition wire to the power source that can be turned on and off using the ignition key. If you connect the ignition wire to the power source with a constant voltage supply, e.g. battery wires, this may discharge the battery.
- Install this device into the console of your vehicle. Make sure that the front panel does not hit the lid of the console (if one exists) when opening and closing.
- After installing the device, check that your vehicle's brake lights, blinkers, wipers, etc. are working correctly.
- Mount the device horizontally or at an incline of no more than 30°.
- In the event that the fuse melts, first make sure that the wires are not in contact and are not causing a short circuit, and then replace the old fuse with a new one with the same nominal values.
- Connect the speaker wires correctly to the respective terminals. If sharing  $\ominus$  wires or if you ground them to any metal part of the motor vehicle, the device may be damaged or it may not function incorrectly.
- If you connect only two speakers to the system, connect them either only to the front output or only to the rear output (do not combine the front and rear output).
- The installation and connection of this product required skill and experience. For reasons of safety, have this work performed by professionals.  
If you come across any problems during the installation, please contact a Sencor vendor.

Wire connection:

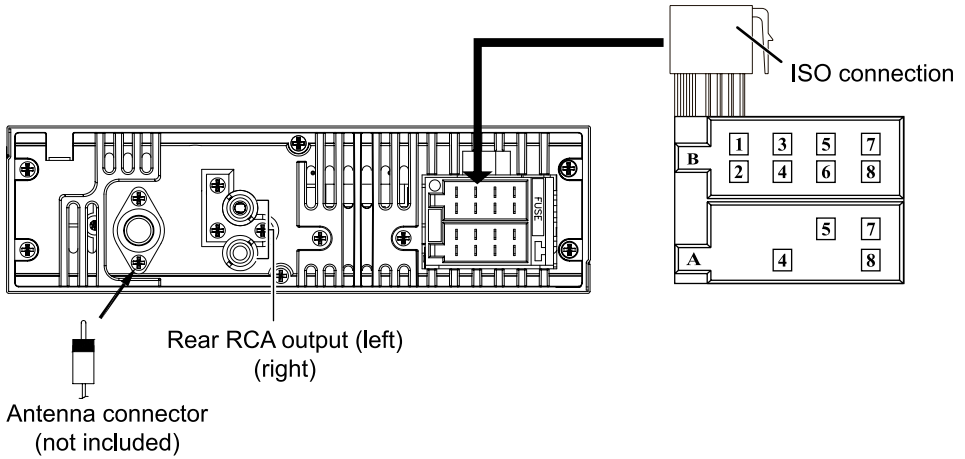





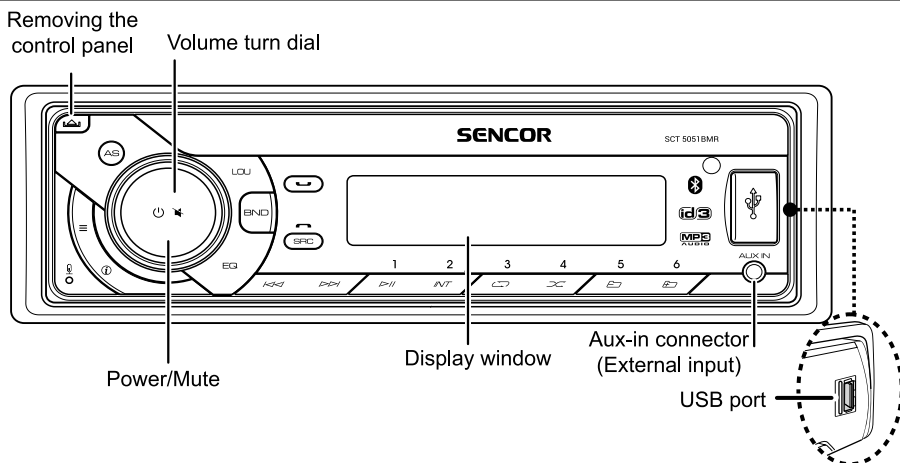

**ISO connector connection table:**

| Pin   | Colour                  | Function   |
|-------|-------------------------|--|
| A4    | Yellow                  | Battery (+) radio memory backup  |
| A5    | Blue                    | Connect to the control terminal of the power amplifier or the antenna power supply (max. 150 mA 12 V DC) |
| A7    | Red                     | Ignition/ACC   |
| A8    | Black                   | Grounding  |
| B1/B2 | Violet ⊕/Violet/Black ⊖ | Right rear speaker   |
| B3/B4 | Grey ⊕/Grey/Black ⊖     | Right front speaker  |
| B5/B6 | White ⊕/White/Black ⊖   | Left front speaker   |
| B7/B8 | Green ⊕/Green/Black ⊖   | Left rear speaker  |

## 6. BASIC OPERATION





When you press or hold down the following button/buttons...

| Main unit   | General controls  |
|---|---|
| SRC   | Selection of available sources (input AUX, Bluetooth, Tuner, USB)   |
| Volume turn dial  | Turn it to increase or decrease the volume.<br>Item selection.  |
| <br>Power/Mute | <ul style="list-style-type: none"> <li>Mute or restore volume.</li> <li>Turning on the device. Press and hold down again to turn off the device.</li> </ul>   |
| BND   | <ul style="list-style-type: none"> <li>Band selection FM (FM1/FM2/FM3) or AM1 (MW1)/AM2 (MW2).</li> <li>When playing media, open the search mode.</li> <li>When playing media, press this button to show ID3 information.</li> </ul>  |
| 1              | Pause/resume playback from a USB device.  |
|               | <ul style="list-style-type: none"> <li>In the radio mode, open the Auto Seek mode (Automatic scanning); press and hold down to open the Manual seek (Manual scanning) mode.</li> <li>In the media playback mode, skip tracks/files; press and hold down for fast playback forward/backwards.</li> </ul> |
|              | <ul style="list-style-type: none"> <li>For opening the Audio Menu mode; press and hold down to open the System Menu mode.</li> <li>Confirm button during track selection.</li> </ul>  |
| LOU   | Press to turn dynamic bass audio amplification on/off.  |
|              | Clock information. Press and hold down to set the clock.  |
| EQ  | For adjusting EQ settings (preset equaliser).   |
|              | <ul style="list-style-type: none"> <li>Receive/make calls.</li> <li>Press and hold down during a call to forward a call.</li> </ul>   |
|              | Reject/hang up a call.  |
| AS  | Press and hold down to activate the automatic save function.  |



## 7. SETTING FUNCTIONS



1. Press  to open the [AUDIO MENU] mode; press and hold down to open the [MENU] mode.
2. Repeatedly press  to select a settings item.
3. Turn the volume control dial to select a value or option.

### [AUDIO MENU]

| Item                                 | Optional settings   |
|--------------------------------------|---|
| BASS ADJUST                          |   |
| BASS LEVEL                           | Set level -7 to +7.   |
| TREBLE ADJUST                        |   |
| TREBLE LEVEL                         | Set level -7 to +7.   |
| BALANCE (Left/right channel balance) | Right and left speaker balance setting in the range from 10R (max. right) to 10L (max. left). |
| FADER (Front/rear channel balance)   | Front and rear speaker balance setting in the range from 10R (max. rear) to 10F (max. front). |

### [MENU] mode settings

1. Press and hold down button  to open the [MENU] mode.
2. Repeatedly press [MENU] to select a settings item.
3. Turn the volume control dial to select a value or option.

| Item  | Optional settings   |
|---|---|
| RDS On/Off  | Turn the RDS function on or off.  |
| PTY <br>(Program type) | In the PTY mode, press button  to select the program type item and then turn the volume control dial to select a category.<br><b>*Available program types:</b><br>POP M; ROCK M; EASY M; LIGHT M; CLASSICS; OTHER M; JAZZ M; COUNTRY; NATION M; OLDIES M; FOLK M; NEWS; AFFAIRS; INFO; SPORT; EDUCATE; DRAMA; CULTURE; SCIENCE; VARIED; WEATHER; FINANCE; CHILDREN; SOCIAL; RELIGION; PHONE IN; TRAVEL; LEISURE; DOCUMENT. |
| AF<br>(Alternative frequencies)   | ON: The device will automatically scan for the same station with a stronger signal.<br>OFF (Off): Cancelling  |
| TA<br>(Traffic announcements)   | ON: When a traffic announcement appears, the device will switch to the tuner mode (irrespective of the current mode) and will start receiving announcements about traffic conditions. When the traffic announcement is finished, the device will return to the previous mode.<br>OFF: Traffic announcements are not received.   |
| CT<br>(clock Time)  | ON: When the Radio data system clock is on, the Radio data system station automatically correct the system clock of car radio.<br>OFF: Turn off this function   |

| Item                                  | Optional settings  |
|---------------------------------------|--|
| BEEP TONE                             | Turn On or Off this beep sound   |
| LOC ON/OFF (Local reception – on/off) | To receive more radio stations or only stations with a strong signal, you may set the sensitivity of the radio.  |
| AREA (Region)                         | Select the respective country region for radio reception: USA; LATIN; EUROPE; RUSSIA; M-EAST (Middle East); ASIA; JAPAN; AUST (Australia)  |
| CLOCK SET (Clock settings)            | Hour and minutes settings  |
| CLOCK FORMAT                          | Select the 12H or 24H time format  |
| RGB                                   | When LED AUTO is shown, the default colour is automatic colour; turn the volume control dial to select a colour – the colour will change in the following order: AUTO – GREEN – BLUE – RED – YELLOW – CYAN – PURPLE – WHITE. |

Attention: for the correct function and reception of the radio and RDS, it is necessary to set the reception region.

Note: activated traffic announcements (TA) mode scans for stations that are broadcasting (indicator TP). If the tuned station does not have TP identification, perhaps due to a weak signal, the device will lower its volume and start scanning for a different station that has identification.

### Listening to the radio:

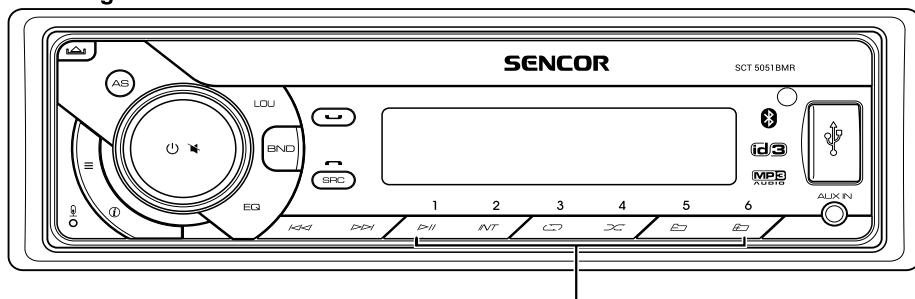

- Hold down for approximately 2 seconds to store the current stations in memory.
- Short press to call up the stored station.

1. Repeatedly press button **BND** to set the broadcast band FM1, FM2, FM3, AM1 (MW1) or AM2 (MW2).
2. Press button **K4** **B4** to scan for stations.

### Overview of RDS functions

The Radio Data System (RDS) is a service, which makes it possible for FM stations to broadcast other digital information together with the standard program signal. Some of them are listed below. It depends on the specific station, which data is used for transmission and when. The device monitors the received data and reacts to it based on its settings.

## Important note

The RDS function only works in countries or areas that have RDS broadcasting. Not all countries or areas have broadcasting with full RDS functionality. RDS may not work correctly if the signal is weak or in the event that the tuned stations are not broadcasting RDS data. The reception of RDS will be significantly affected by geographical conditions.

## AF (Alternative Frequencies)

A list of alternative frequencies providing information about various transmitters broadcasting the same program in the same or neighbouring area.

## TA (Traffic Announcement)

Information about whether traffic information is being broadcast.

## PI (Program Identification)

This is a code that identifies the RDS station.

## PS (Program Service Name)

The name of the current broadcasting station is shown on the display. Sometimes it is used for other messages of the broadcaster.

## TP (Traffic Program)

Information that a given station is using a traffic announcement / news system.

## PTY (Program Type Codes)

This code is used to designate the current program material. This function is used to search for stations corresponding to your selected program category, such as news, easy music, sport, etc. There is a relatively large number of program types and the inclusion of a broadcast program in a certain category also depends on the focus of the given station.

## Listening from USB devices / SD card:

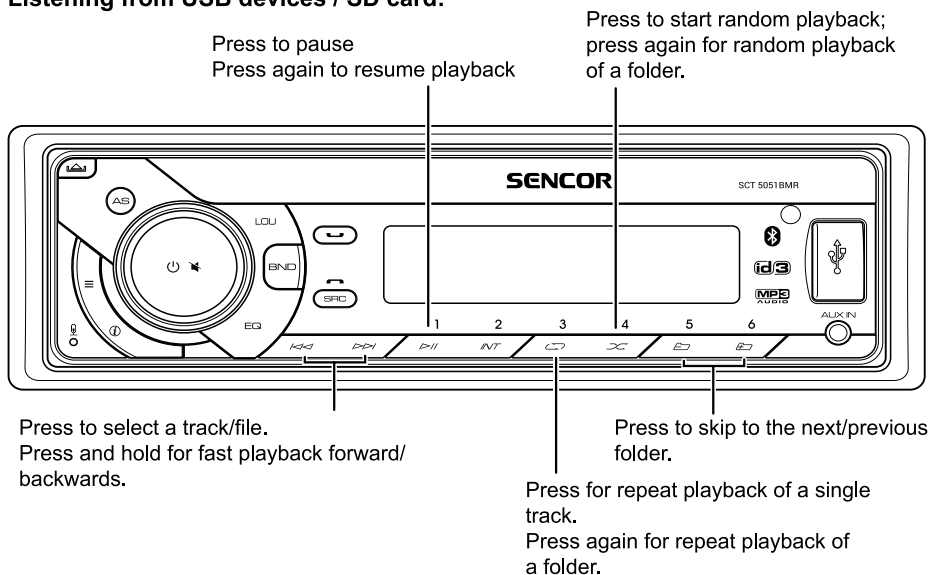

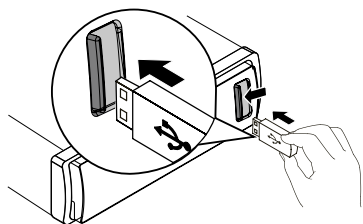

### Playback from USB devices:

1. Slide the USB connector cover marked as  to the right.
2. Connect the USB device to the USB slot. The device will automatically start playback from the USB device.

### Playback from SD card:

1. Remove the front panel of the car radio.
2. Insert an SD card with the contacts facing backwards (into the device) and left.
3. Attach the front panel of the car radio and turn it on.

### Note:

Ensure that you insert the USB device / SD card in the correct direction.

Do not use force to insert the USB device / SD card into the device. Otherwise you could damage the USB device / SD card and the device.

### Listening from external components

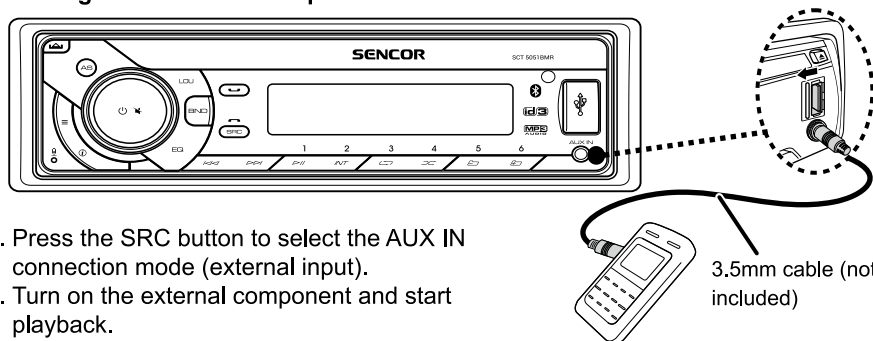

1. Press the SRC button to select the AUX IN connection mode (external input).
2. Turn on the external component and start playback.

## 8. USING BLUETOOTH

### Using Bluetooth hands-free:

This device enables making and picking up telephone calls on telephones supporting Bluetooth. Likewise, you may listen to music from devices supporting Bluetooth. The supported functions also depend on you telephone.

### Getting Started

Before using a Bluetooth device, it must be paired with the device. Pairing is required only once.

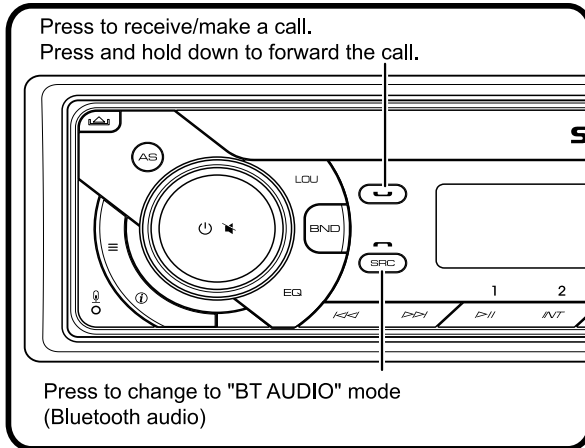

### Pairing Bluetooth devices:

1. Activate Bluetooth on your mobile telephone.
2. Use your telephone to search for the second Bluetooth device.
3. In the pairing list, select "SCT 5052BMR".
4. If pairing is successful, the text [BT ON] (Bluetooth on) will appear on the screen and the paired device will automatically connect to the motor vehicle's audio system.

### Note:

The steps described are only a reference. The specific pairing procedure may differ depending on the type of mobile telephone. For this reason, follow the instructions in the user's manual for your telephone.

### Making calls:

The number can be dialled using a mobile telephone.

1. Using a mobile telephone, dial and make an outgoing call.
2. After finishing dialling, the text [CALLING] will be shown.



### Redialling a number:

1. To redial the last dialled number, press button  on the front panel.
2. The device will show [CALLING] and will start dialling.

### Note:

To make an outgoing call using this device, the Bluetooth mode must be active (button SRC).

### Receiving a call:

1. If an incoming call appears, its telephone number will be shown. If the incoming call does not have a telephone number, [PHONE IN] will be shown.
2. Press  to receive/connect a call.
3. When the conversation is complete, press button  to end the call.

### **Forwarding a call:**

During a call, you can forward the voice from the speaker to mobile telephones.  
During a call, press and hold down button III to forward the voice from the speaker to a mobile telephone.

### **A2DP Bluetooth audio streaming:**

If the connected Bluetooth device supports the advanced audio distribution profile (A2DP), you may listen to music stored on the device using this device. If the device, likewise, supports Audio/Video Remote Control Profile (AVRCP), you may use the control element on this device or on its remote control to playback music stored in the device.

1. Repeatedly press the SRC button to select [BT].
2. Press button ►II to start playback; press it again to pause playback.
3. To skip to the previous/next track, press button I◀◀ / ►►I.

## **9. INFORMATION ABOUT THE PRODUCT**

### **General**

Power supply: 12 V DC (10.5–14.4 V), grounded negative pole

Fuse: 15 A

Suitable speaker impedance: 4–8 ohms

MP3 connection level: 500 mV

### **Audio**

Maximum output power: 40 W × 4 channels

Continuous output power: 20 W × 4 RMS

### **FM tuner**

Frequency range: 87.5 – 108 MHz

Usable sensitivity: Better than 15 dB at a signal to noise ratio of 30 dB

### **AM tuner**

Frequency range: 522–1,620 kHz

Usable sensitivity: Better than 45 dB at a signal to noise ratio of 26 dB

### **USB devices**

USB flash memory: Compatible with USB 1.1 and 2.0

### **Audio files**

- USB or memory file system: FAT16, FAT32
- MP3/WMA bitrate: 32–320 kbps and variable bitrate
- MP3 sampling frequency: 8–48 kHz
- WMA sampling frequency: 32 kHz, 44,1 kHz, 48 kHz
- ID3 tag v1.0 or higher (display depends on music files)

## INSTRUCTIONS AND INFORMATION REGARDING THE DISPOSAL OF USED PACKAGING MATERIALS

Dispose of packaging material at a public waste disposal site.

## DISPOSAL OF USED ELECTRICAL AND ELECTRONIC APPLIANCES



The meaning of the symbol on the product, its accessory or packaging indicates that this product shall not be treated as household waste. Please, dispose of this product at your applicable collection point for the recycling of electrical & electronic equipment waste. Alternatively in some states of the European Union or other European states you may return your products to your local retailer when buying an equivalent new product. The correct disposal of this product will help save valuable natural resources and help in preventing the potential negative impact on the environment and human health, which could be caused as a result of improper liquidation of waste. Please ask your local authorities or the nearest waste collection centre for further details. The improper disposal of this type of waste may fall subject to national regulations for fines.

### For business entities in the European Union

If you wish to dispose of an electrical or electronic device, request the necessary information from your seller or supplier.

### Disposal in other countries outside the European Union

If you wish to dispose of this product, request the necessary information about the correct disposal method from local government departments or from your seller.



This product meets all the basic EU regulation requirements that relate to it.

Changes to the text, design and technical specifications may occur without prior notice and we reserve the right to make these changes.

Hereby, FAST ČR a.s. declares that the radio equipment type SCT 5052BMR is in compliance with Directive 2014/53/EU.

The full text of the EU declaration of conformity is available at the following internet address: [www.sencor.eu](http://www.sencor.eu)

# SENCOR®

## EN Warranty conditions

**Warranty card is not a part of the device packaging.**

This product is warranted for the period of 24 months from the date of purchase to the end-user. Warranty is limited to the following conditions. Warranty is referred only to the customer goods using for common domestic use. The claim for service can be applied either at dealer's shop where the product was bought, or at below mentioned authorized service shops. The end-user is obligated to set up a claim immediately when the defects appeared but only till the end of warranty period. The end user is obligated to cooperate to certify the claiming defects. Only completed and clean (according to hygienic standards) product will be accepted. In case of eligible warranty claim the warranty period will be prolonged by the period from the date of claim application till the date of taking over the product by end-user, or the date the end-user is obligated to take it over. To obtain the service under this warranty, end-user is obligated to certify his claim with duly completed following documents: receipt, certificate of warranty, certificate of installation.

### **This warranty is void especially if apply as follows:**

- Defects which were put on sale.
- Wear-out or damage caused by common use.
- The product was damaged by unprofessional or wrong installation, used in contrary to the applicable instruction manual, used in contrary to legal enactment and common process of use or used for another purpose which has been designed for.
- The product was damaged by uncared-for or insufficient maintenance.
- The product was damaged by dirt, accident of force majeure (natural disaster, fire, and flood).
- Defects on functionality caused by low duality of signal, electromagnetic field interference etc.
- The product was mechanically damaged (e.g. broken button, fall).
- Damage caused by use of unsuitable media, fillings, expendable supplies (batteries) or by unsuitable working conditions (e.g. high temperatures, high humidity, quakes).
- Repair, modification or other failure action to the product by unauthorized person.
- End-user did not prove enough his right to claim (time and place of purchase).
- Data on presented documents differs from data on products.
- Cases when the claiming product cannot be indentified according to the presented documents (e.g. the serial number or the warranty seal has been damaged).

### **Manufacturer:**

FAST ČR, a.s., U Sanitasu 1621, Říčany 251 01, Czech Republic

Visit [www.sencor.com](http://www.sencor.com) for detailed information about authorized service centers.

The original version of the instructions is in the Czech language, other language versions are made by the appropriate translation.





