

# Hand Vacuum Cleaner

User's manual

EN



**SENCOR®**

SVC 220BL / SVC 220SL

Before operating this unit, please read these instruction manual thoroughly even if you have been already familiar with similar device. Only use this device as it is described in this instruction manual. Keep the instruction manual for future reference.

# Hand Vacuum Cleaner

SVC 220BL / SVC 220SL

**Read the instructions carefully before use.**

## HOW TO CHARGE YOUR VACUUM CLEANER

Your VACUUM CLEANER arrives partially charged and therefore requires charging in its holder for 14 hours. This appliance can only be used in conjunction with the charging unit supplied. This appliance should be charged indoor only.

## CAUTIONS AND TAKE CARE

- ◆ This appliance is not intended for use by persons (including children) with reduced physical, sensory or mental capabilities, or lack of experience and knowledge, unless they have been given supervision or instruction concerning use of the appliance by a person responsible for their safety.  
Children should be supervised to ensure that they will not play with the appliance.
- ◆ Do not use outdoors.
- ◆ Do not expose to rain, store indoors.
- ◆ To avoid excessive heat and damage to the unit or batteries, do not operate the vacuum cleaner while in the charging unit.
- ◆ Do not allow to be used as a toy. Close attention is necessary when used by children.
- ◆ Use only as described in this manual. Use only manufacturer's recommended attachments.
- ◆ Do not use extension cord or outlets with inadequate current carrying capacity.
- ◆ Do not handle charger or vacuum cleaner with wet hands.
- ◆ Do not incinerate or mutilate batteries as they will explode at high temperature.
- ◆ Leaks from battery cells can occur extreme usage or temperature conditions. If the liquid gets on the skin wash quickly with soap and water or neutralizer with a mild acid such as lemon juice or vinegar, if the liquid gets into the eyes, flush them immediately with clean water as quickly as possible.
- ◆ Do not pick up anything that is burning or smoking such as cigarettes, matches or hot materials.
- ◆ Do not use without a filter in place.
- ◆ Do not use to pick up flammable or combustible liquids such as gasoline, or use in areas where they may present.
- ◆ Do not pick up large or small pieces of sharp-edge debris such as glass.
- ◆ Locate the adaptor indoors in a cool, dry area not exposed to the severe weather to avoid electrical shock and/or cleaner damage.
- ◆ Use only the adaptor provided to recharge.
- ◆ Repair or replacing the battery should be only done by the manufacturer or the service agent to avoid a hazard.
- ◆ Always disconnect cord from electrical outlet before serving the cleaner.
- ◆ Use only the charger supplied by the manufacturer to recharge this appliance.
- ◆ Charge indoors only.
- ◆ This appliance designed for domestic use only. Not for commercial application.
- ◆ Do not operate any appliance with a damaged cord, plug or charger, or if the appliance is damaged in any way.
- ◆ Do not place the nozzle or unit near eyes or ears when operating.
- ◆ For best performance keep the unit and filters clean, and repair or replace a damaged filter.
- ◆ Never unplug the recharging unit by pulling out the supply cord.
- ◆ Every vacuum cleaner needs the voltage specification. Check that the voltage specification on the type plate corresponds to that of the energy supply.

# Hand Vacuum Cleaner

SVC 220BL / SVC 220SL

EN

## DEVICE DESCRIPTION

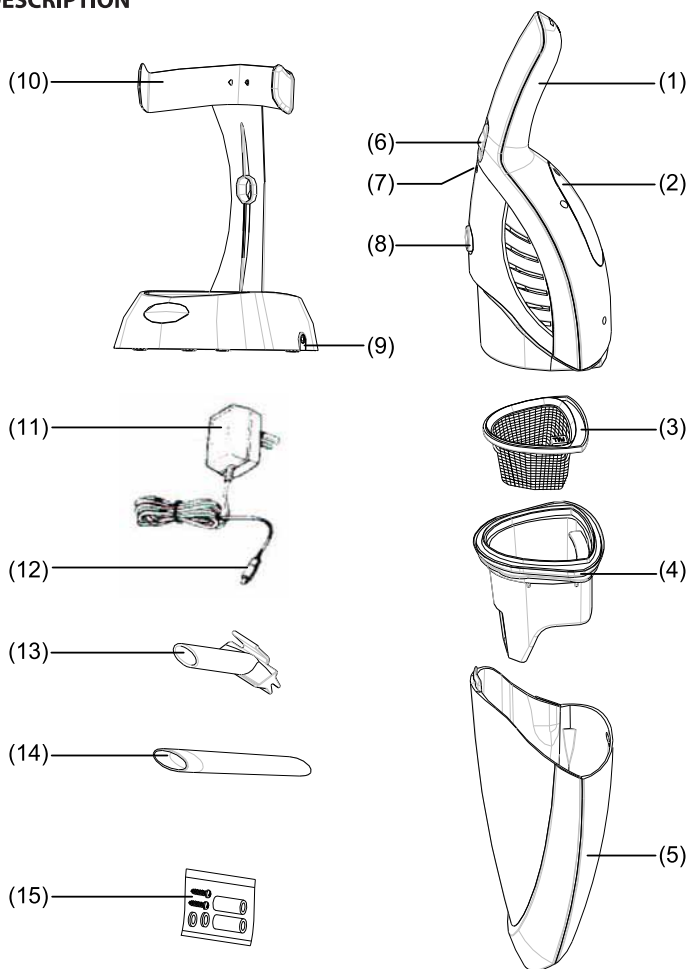

## Part identification

- |                                   |                                  |
|-----------------------------------|----------------------------------|
| (1) Grip                          | (10) Charging holder             |
| (2) Battery cover                 | (11) Adapter                     |
| (3) Filter                        | (12) Charging pin                |
| (4) Filter bracket                | (13) Wet nozzle                  |
| (5) Dust compartment              | (14) Crevice tool                |
| (6) On/Off switch (0: Off; I: On) | (15) Screws, washers and anchors |
| (7) Operating indicator           |                                  |
| (8) Release button                |                                  |
| (9) Charging socket               |                                  |

## CHARGING

- ◆ Ensure that charging socket (9) of VACUUM CLEANER fits correctly into the charging pin (13).
- ◆ Plug the adapter (12) into adjacent socket.
- ◆ The normal charging time for this appliance requires 14 hours.

If the operation of the cleaner has been decreasing and it disallows vacuuming, let the device on until it is completely discharged. Then charge the device again. Repeat this process at least ones a month! If this process does not suits you, you can charge the device accoding to your wish, nevertheless, it is recommended to let the device totally discharge and charge again after 5 common chargings.

## USE YOUR VACUUM CLEANER

- ◆ Push the On/Off switch (6) forward when using it. The cleaner will pick up dirt hidden under the carpet or any other surface. The device will vacuum minute dirt. This is a spring return operation; once you finished using it, keep your hand off the button then the cleaner will be stopped.
- ◆ For desirably sucking minute dirt/dust in small gaps/cracks or other places difficult to reach, it is advised to use the crevice tool (15). For vaccum the liquid on smooth floor, it is useful to use the wet nozzle (liquid scraper) (14).
- ◆ To vacuum dust: Empty the dust compartment if you have vacuumed dust. Dry the compartment and the filter thoroughly.
- ◆ To vacuum liquid: Empty the dust compartment if you have vacuumed liquids. Use the wet nozzle (liquid scraper).
- ◆ Verify the level by holding the appliance verically, the nozzle towards to the ground. Empty the dust compartment before you reach maximum level.

## ASSEMBLY OF CHARGING HOLDER

Your VACUUM CLEANER comes with a specially designed bracket used to hold the unit so that it may recharge while mounted on wall or place on floor (Fig. 1,2).

1. To mount the bracket, place it against the wall for the desired position, trace the mounting hole so the bracket using a sharp pencil, onto the wall or mounting surface. Make sure the wall bracket is vertically positioned.
2. Drill a deiameter hole into each of the marked hole. Insert a plastic anchor into each hole.
3. Drive one screw into the lower anchor leaving screw exposed.
4. Place the bracket on the exposed portmon of screw, slide the bracket downward to let the screw go into the slot.
5. Insert the second screw through the bracket into the upper anchor, tighten it to secure the bracket.

Fig. 1

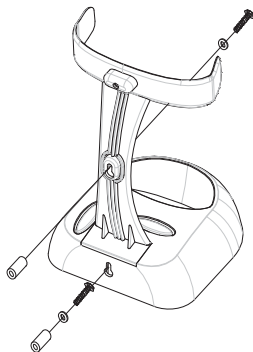
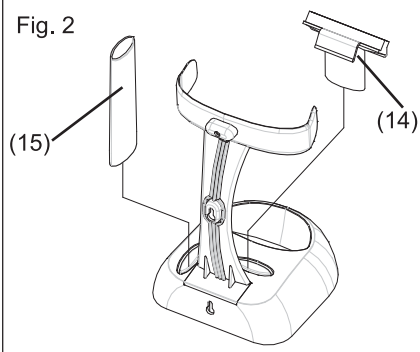

Fig. 2



# Hand Vacuum Cleaner

SVC 220BL / SVC 220SL

EN

## EMPTY YOUR VACUUM CLEANER

- ◆ Always switch off before opening the vacuum cleaner.
- ◆ Press the release button down and detach the dust compartment (Fig.3).
- ◆ Remove the filter from the dust compartment and empty the container (Fig. 4, 5, 6).
- ◆ Brush away any dirt and dust from the filter. A damp cloth can be used to clean inside the dust compartment.
- ◆ To clean the filter more thoroughly, rinse it with cold or tepid water.
- ◆ **Remember!** The filter should be tried before replacing it into the dust compartment.
- ◆ Ensure the filter is correctly fitted before further use.
- ◆ Maximum dust collection will only be obtained with a clean filter and empty dust compartment.

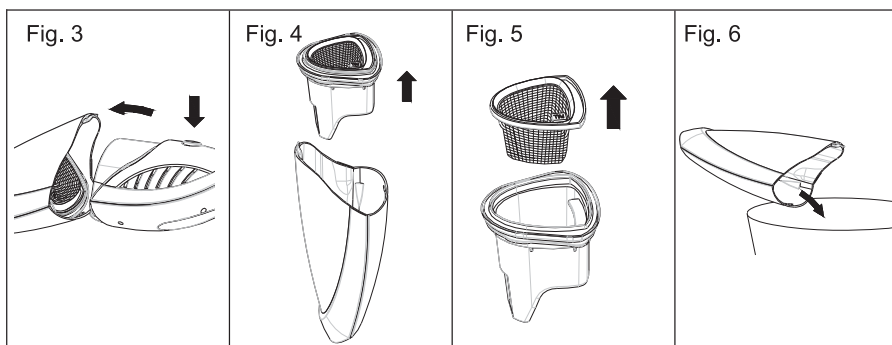

## DISASSEMBLY OF BATTERY

Ensure the device is pulled out from the socket. Let the device on until the engine stops.

1. Loosen the screw at the battery cover of the battery compartment (Fig.7).
2. Take out the battery cover from the battery compartment.
3. Loosen the screws on the terminal blocks with the lead wires connected with the terminals of the battery pack. Remove the battery pack (Fig.8).

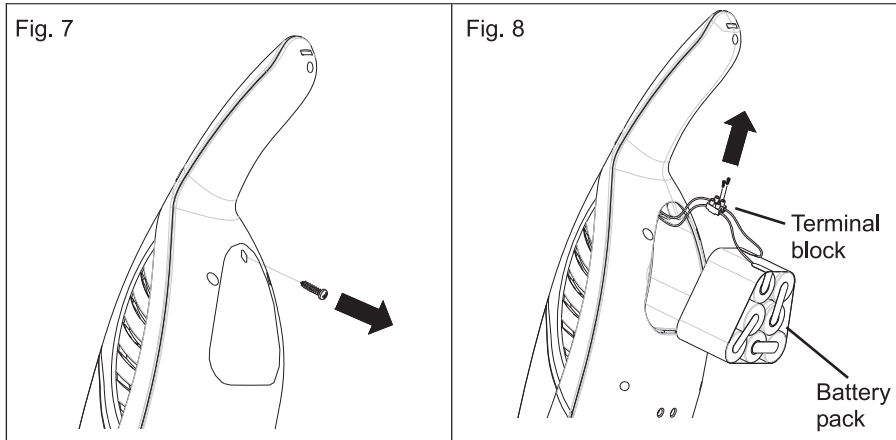

## SERVICE AND REPAIRS

In case of damage or fault have the device repaired at authorised service center.

Damaged supply cord or adapter must be changed by manufacturer or other qualified person in order to avoid a hazard.

## TECHNICAL DATA

Model	SVC 220
Typ	CH-936
Adapter	I/P 230 V, ~ 50 Hz O/P 9 V 150 mA
Battery	Ni-Cd, 1200 mAh x4
Normal charging time	About 14 hodin
Running time	About 12 min
Dimensions	47 x 14,7 x 13,6 cm (without charging holder)
Noisiness	77 dB(A)
Weight	0,89 kg (without charging holder)

The declared noise emission level for this appliance is 77 dB(A), which represents level A of the acoustic power relative to the reference acoustic power of 1 pW.

# Hand Vacuum Cleaner

SVC 220BL / SVC 220SL

EN

## INFORMATION FOR USER

This product has been designed with respect to the environment.  
All plastic parts are signed as recycled.

### DISPOSAL OF USED BATTERIES



This device contains Ni-Cd recharging batteries. In case of liquidation after the end of the effective life, remove the recharging batteries and dispose them at the designated site for disposal waste. You can dispose all the device to authorised service that ensure its correct liquidation.

In the countries of EU, the recharging batteries must not be treated like household or municipal waste. In case of incorrect liquidation of this type of waste the penalty can be fined in compliance with national rules.

The recharging batteries may only be removed from the device when totally discharged.

### LIQUIDATION OF USED ELECTRIC AND ELECTRONIC EQUIPMENT



This symbol on a product, its accessories or packaging signifies that this product must not be treated like household waste. Liquidate the product by submitting it to the collection site for recycling electrical and electronic devices. Independent waste collection systems exist for collecting used electrical and electronic products in countries of the European Union and other European countries. Ensuring the correct liquidation will contribute to the prevention of the occurrence of potential risks to the environment and human health, which could be incurred as a result of incorrect waste management.

Recycling waste material helps maintain natural resources - for the stated reason, please do not liquidate your old electrical and electronic facilities with your household waste. For further information on recycling this product, please contact environmental workers of your local (municipal or regional) office, workers of a waste disposal area or employees of the salespoint at which you purchased this product.

### HANDLING INSTRUCTIONS FOR THE DISPOSAL OF USED PACKAGING MATERIAL

Dispose of used packaging material at a designated site for waste disposal.



This appliance complies with EU rules and regulations regarding electromagnetic compatibility and electrical safety.

