

# Wireless Baby Digital Monitor

User's manual

EN



## SENCOR

SBM 1600

Before first use, please read all instructions contained in this user manual carefully, even if you are already familiar with the use of similar products. Only use this product in accordance with the instructions described in the user manual. Store the user's manual on a safe place where it can be easily retrieved in case of future need.

Save the original packaging, material, warranty card and proof of purchase receipt, at least for the duration of the warranty policy. If you need to ship this product, pack it in the original cardboard box to ensure maximum protection during shipping or transport (e.g., when moving or when you need to send this product for repair).

This product for radio operation may be used in accordance under the General Authority No. VO-R/8/08.2005-23.

# Wireless Baby Digital Monitor

SBM 1600

## CONTENTS

IMPORTANT SAFETY NOTICE .....	3
LIST OF SUPPLIED ITEMS .....	4
PRODUCT DESCRIPTION .....	4
INSTALLATION .....	5
CLEANING AND MAINTENANCE .....	14
DISPOSAL OF USED BATTERIES .....	14
TECHNICAL SPECIFICATIONS .....	15
DISPOSAL OF USED ELECTRICAL AND ELECTRONIC DEVICES .....	16
INSTRUCTIONS AND INFORMATION REGARDING THE DISPOSAL OF USED PACKAGING MATERIALS ..	16

## IMPORTANT SAFETY NOTICE

- 1) Carefully unpack the product, and take care not to throw away any part of the packaging material before you have found all parts of the product.
- 2) This baby monitor is designed as an aid and must not be used as a full replacement for proper supervision of a responsible adult.
- 3) Ensure that the baby unit and the adapter cable are always out of the child's reach (a distance of at least 1m).
- 4) Never place the baby unit into the baby's bed or the baby's enclosure.
- 5) It is not permitted to make construction changes to the product nor to attach HF amplifiers or antennas.
- 6) This appliance must not be used by persons (including children) with physical or mental impairments or by inexperienced persons, unless properly trained or schooled in the safe use of the appliance, or unless they have been properly supervised by a qualified person who will be responsible for their safety.
- 7) Never use accessories that have not been delivered with this product or are not intended for it.
- 8) Under no circumstances should you try to repair or amend the appliance on your own - danger of electric shock! Entrust all repairs and adjustments to a specialised company/service. If you tamper with the product during the warranty period, you run the risk of voiding the warranty.
- 9) Only store and use the appliance away from flammable or volatile materials and solutions.
- 10) Keep the product away from extreme temperatures, direct sunlight and excessive humidity. Do not use in a dusty environment.
- 11) Do not place the product near heaters, open fires or other appliances or equipment that are sources of heat.
- 12) This appliance is designed for household use. Do not use in industrial surroundings or outdoors!
- 13) Do not use the appliance for other purposes than those intended.
- 14) Before connecting this product to an electrical outlet, make sure the voltage stated on the label of the product corresponds to the voltage in your wall socket.
- 15) Do not place the adapter power cord near hot places or sharp objects. Do not place heavy objects on the power cable. Position the cable so that it will not be stepped on or tripped over. Make sure the electric cable is not touching a hot surface.
- 16) If the power cord of the adapter is damaged have it repaired by an authorised service technician to prevent causing a dangerous situation. It is forbidden to use a product with a damaged power cord or plug.
- 17) Do not disconnect the electrical plug from the wall outlet by pulling on the cord.
- 18) Never use the product near a bathtub, wash basin or any other container filled with water.
- 19) Do not spray the product with water or any other liquid. Do not pour water or any other liquids into the product. Do not submerge the product in water or any other liquid.
- 20) If you are not using the product, or if you know that you will not be using it soon, turn it off and disconnect the power adapter from the wall socket. Prior to cleaning, proceed in the same manner.
- 21) If you will not be using the product for an extended period of time, remove the batteries. Otherwise they may leak inside the product and cause irreparable damage.
- 22) For plugging the product into the mains socket, use only the type of adaptor included with the product.
- 23) The manufacturer takes no responsibility for damages caused by the incorrect use of this appliance and its accessories (injuries, burns, scalding, fire, food spoilage, etc.).

# Wireless Baby Digital Monitor

SBM 1600

## LIST OF SUPPLIED ITEMS

- Baby unit
- Baby's unit power adapter
- Parent's unit
- Parent's unit power adapter
- 2 x rechargeable batteries AAA for the parent's unit
- Recharger for the parent's unit
- Belt clip for the parent's unit
- User's manual
- Warranty card

## What else you will need

4 x non rechargeable batteries AA (we recommend alkaline) for the baby's unit (not supplied with the product).

## PRODUCT DESCRIPTION

### Parent's unit

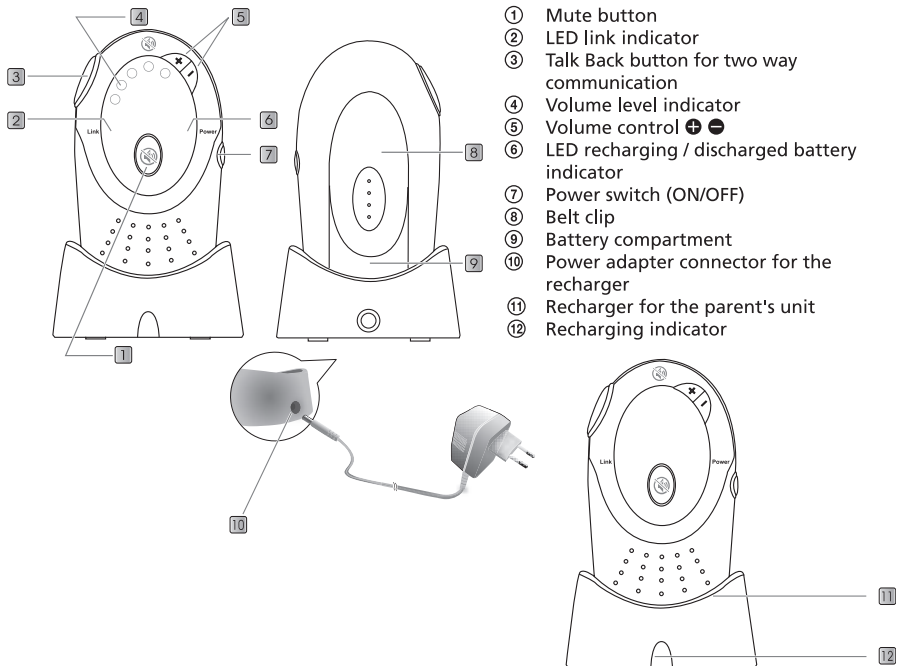

# Wireless Baby Digital Monitor

SBM 1600

NE

## Baby unit

- ① LED link indicator
- ② Night time light
- ③ Night time light switch (ON/OFF)
- ④ Volume control  $\oplus \ominus$
- ⑤ LED recharging / discharged battery indicator
- ⑥ Power switch (ON/OFF)
- ⑦ Power adapter connector
- ⑧ Battery compartment cover lock
- ⑨ Battery compartment

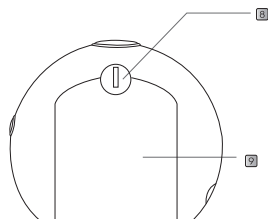
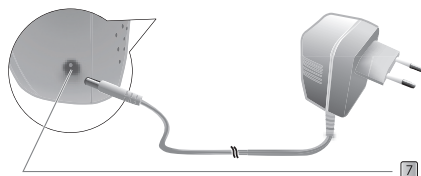
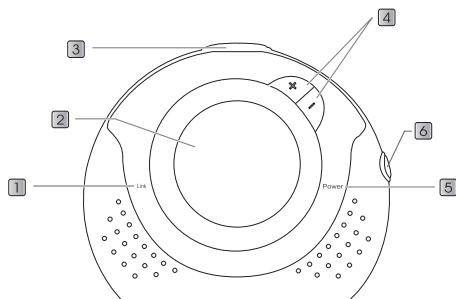

# Wireless Baby Digital Monitor

SBM 1600

## SET UP

### 1. Turn on the baby's unit

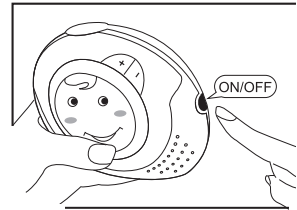

The baby's unit uses either 4 alkaline AA batteries or alternate current from the mains.

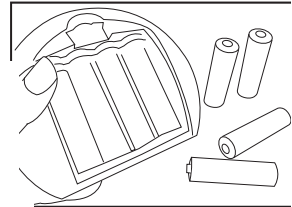

## OPERATION FROM THE MAINS

### 1. Insert the power cable into the socket on the side of the baby's unit.

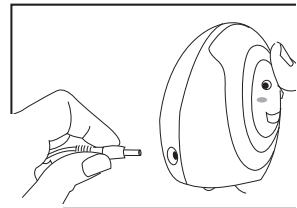

### 2. Connect the other end to the power socket.

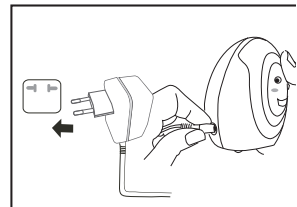

### 3. After connecting to the mains the LED Power indicator (Power) will turn green.

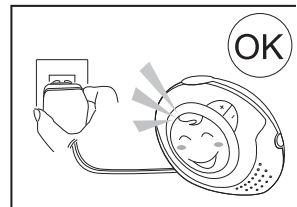

#### Caution:

Use only the power adapter supplied. By using a wrong adapter you may irreparably damage the baby's unit.

# Wireless Baby Digital Monitor

SBM 1600

EN

## BATTERY OPERATION

The baby's unit may also be powered using batteries so that it is possible to use it in places far away from the power socket or during a power outage.

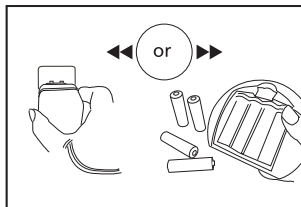

1. Remove the battery compartment cover and insert 4x alkaline AA batteries into the battery compartment of the baby's unit, then return the battery compartment cover to its place.

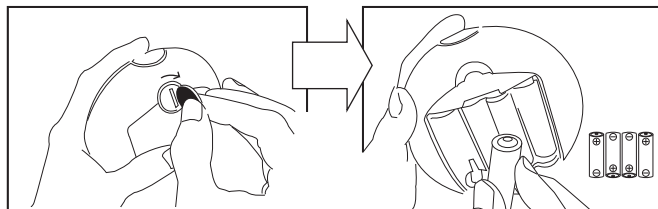

2. The green LED power indicator (Power) will turn on.

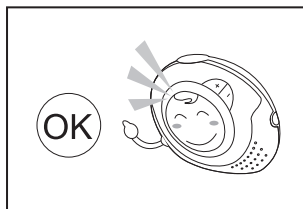

### Caution:

- We recommend the use of 4 x alkaline AA batteries.
- The baby's unit will be powered using the batteries only when it is disconnected from the mains.
- Discharged batteries: The LED power indicator on the baby's unit will flash and the LED link indicator on the parent's unit will flash red.
- Before disconnecting from the mains or removing the batteries, please turn off the baby's unit.

# Wireless Baby Digital Monitor

SBM 1600

## 2. Set up the parent's unit

### 2.1 Power Supply

The parent's unit uses 2x rechargeable AAA batteries.

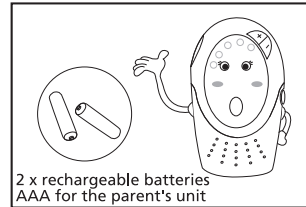

## BATTERY OPERATION

1. Remove the battery compartment cover and insert 2x rechargeable AAA batteries into the battery compartment of the parent's unit, then return the battery compartment cover to its place - see picture.

You should ensure that there are always batteries in the parent's unit.

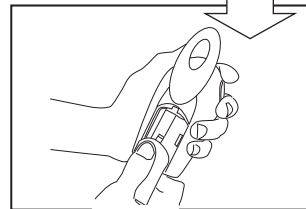
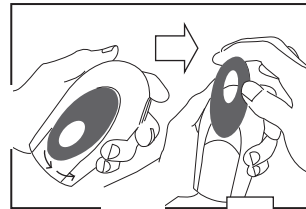

#### Caution:

Never use non-rechargeable batteries in the parent's unit. Use only 2x rechargeable AAA batteries - using any other type may cause irreparable damage to the unit.





# Wireless Baby Digital Monitor

SBM 1600

EN

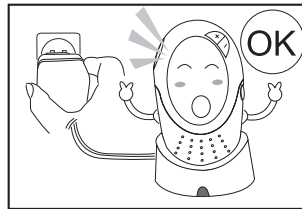
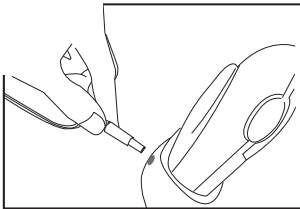
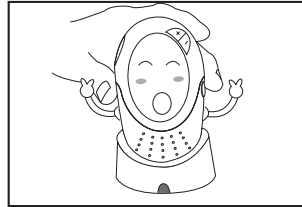
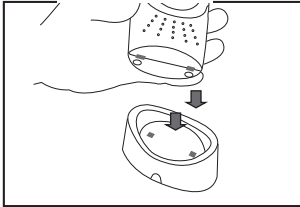
2. Connect the recharger for the parent's unit into a mains power socket.



 **Caution:**  
Use only the power adapter supplied. By using a wrong adapter you may irreparably damage the recharger.

3. Insert the parent's unit into the recharger - the recharger indicator will be red, this will occur even when the parent's unit is not in the recharger.

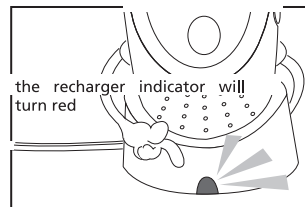
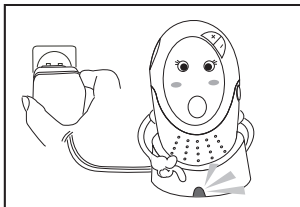

4. If the batteries become discharged the LED power indicator on the parent's unit will flash green. After starting to recharge, it will beep twice and the indicator will flash orange. Once fully recharged the indicator will turn off.

 **Caution:**

- Before using this baby monitor for the first time, charge the parent's unit for a time of at least 8 hours.
- In the recharger indicator is not on, you must insert or replace the batteries.
- If any of the following situations occurs it is necessary to recharge or the replace the batteries:
  - LED recharge indicator does not turn on.
- Discharged batteries: LED recharge indicator is flashing.
- When the parent's unit is in the recharger, it is still possible to use it.
- Before removing the batteries, please turn off the unit.

# Wireless Baby Digital Monitor

SBM 1600

## 1.2 Belt clip

To improve comfort you may attach the belt clip.

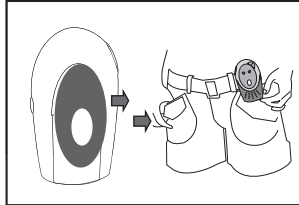

## 3. Check the link

When both units are turned on a green link indicator turns on on both units. If at any time the link between the units is cut off, the link indicators on both units will turn red. On the parent's unit you will also hear a warning signal, which informs you about the loss of the link between the units. If this situation occurs, check that the baby's unit is connected to the mains and whether the baby's unit is turned on.

**Also check that the units are within each others range.**

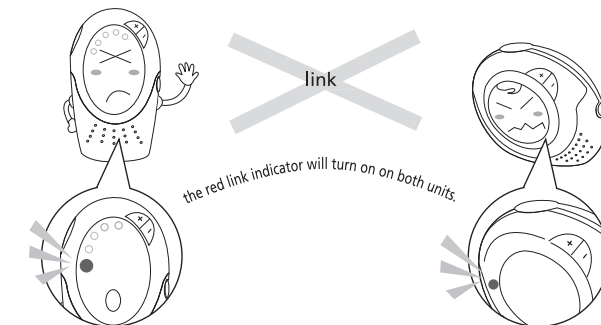
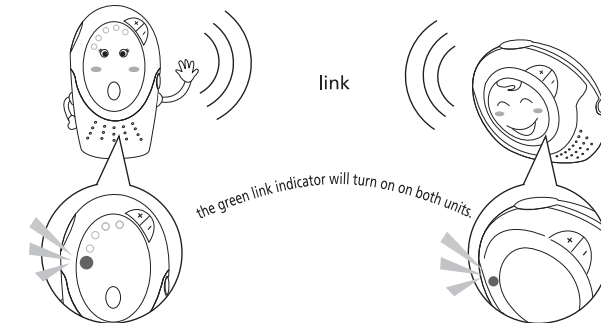

### Caution:

If power is lost, settings will remain unchanged after electrical power is restored.

# Wireless Baby Digital Monitor

SBM 1600

EN

## OPERATION OF THE BABY'S UNIT

Place both units in the same room to check the link. Ensure that the baby's unit is at least 1 m away from the parent's unit.

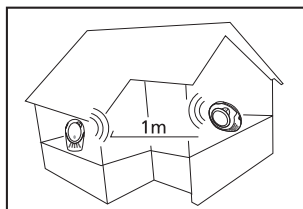

### Note:

If you place the parent's and baby's units too close to one another, you will hear a high tone sound - do not be concerned by this, the device is working correctly. The units are designed so that they may be placed at a certain distance from one another, e.g. in separate rooms. In such a situation place the units further from each other.

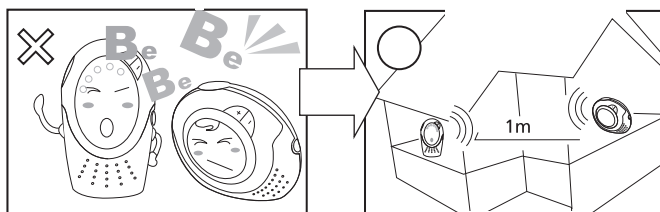

## 1. Volume Adjustment button

### On the parent's or baby's unit:

- On each unit there are 5 volume levels available.
- Press button **+** to turn up the volume or button **-** to turn down the volume. Changing the volume setup of the baby's unit affects the volume when using the Talk Back function (two way communication).

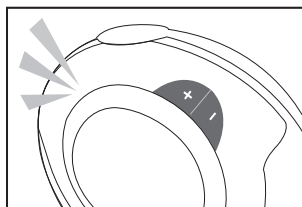
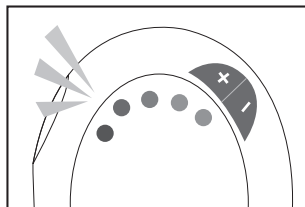



# Wireless Baby Digital Monitor

SBM 1600

## 2. Mute mode and setting microphone sensitivity

When setting the sensitivity do the following:

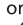
- Press the Mute button on the parent's unit and then within 3 seconds press button   or  to select the required sensitivity level – 1 for low sensitivity (Low) up to 5 for high sensitivity (High) (factory setting is 3).

Note 1: If you press and hold button  or , the sensitivity level will change automatically.

Note 2: When changing to Mute mode the LED indicator should turn on at level 4.

Note 3: To return to normal mode press the Mute button again.

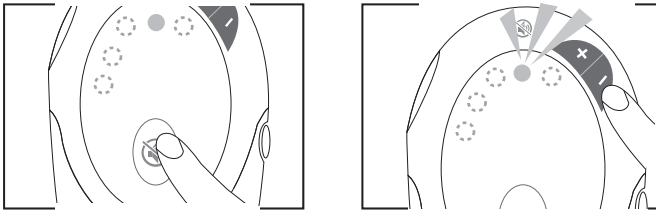

## 3. Talk Back function (Two way communication)

The Talk Back Function (Two way communication) may be used to comfort or to calm down your baby.

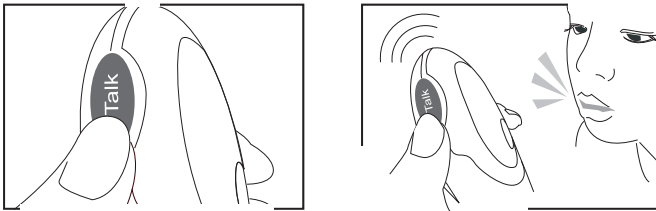

- If you wish to talk to your baby, press and hold the Talk button on the parent's unit.
- If you want to hear your baby again, release the Talk button.

# Wireless Baby Digital Monitor

SBM 1600

EN

## 4. Night time light

The night time light provides your baby with a gentle and relaxing light, making it possible to check your baby without having to turn on the main light in the room.

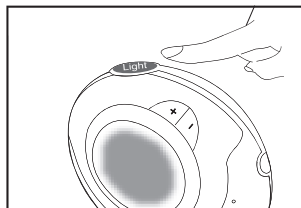
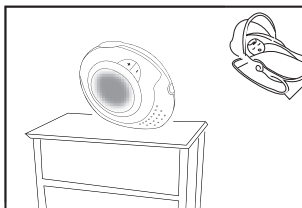

- Press the Light button on the baby's unit. By pressing it again you can turn off this function.

## 5. Volume level indication

Volume level indicators are green and red indicators located in the upper part of the parent's unit, which are turned on depending on the sound level in the baby's room.

There are 8 volume levels available:

- Level 0: 0 green indicators
- Level 1: 1 green indicator
- Level 2: 2 green indicators
- Level 3: 3 green indicators
- Level 4: 4 green indicators
- Level 5: 5 green indicators
- Level 6: 5 green indicators and 1 red indicator
- Level 7: 5 green indicators and 2 red indicators

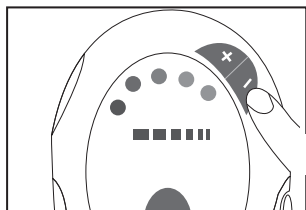

## TROUBLESHOOTING

**Power indicator does not turn on:**

- If you are using mains power adapters, check that they are connected to the mains and turned on.
- If you are using batteries, check that they are correctly inserted and whether they are not discharged.

**Link indicator (Link) is not on:**

- Check that the baby's unit and the parent's unit are turned on.
- If you are using batteries, check that they are correctly inserted and whether they are not discharged.

**Link indicator (Link) is red:**

- The link between your units has been lost. You will also hear a warning signal, which alerts you to the loss of communication between the units. If this situation occurs, check that the power adapters (batteries) are connected correctly and whether the units are with range of each other.

**The parent's unit remains silent or is very quiet:**

- The volume may be set to a level that is too low.
- Maybe the Mute button has been pressed

**A high tone sound is being produced:**

- The units are too close to each other or the volume is set to a level that is too high.
- Move the parent's unit further away from the baby's unit (at least 1 m).
- Lower the volume on the parent's unit.

## CLEANING AND MAINTENANCE

**Caution:**

Before cleaning, always disconnect this device from the power source.

To clean the outer parts of the product, use a soft cloth dipped in lukewarm water. Do not use aggressive cleaning agents, paint thinners or solvents. Using these solutions could damage the surface of the iron.

## DISPOSAL OF USED BATTERIES

This product comes with one alkaline battery. Do not place used batteries into regular household waste.

Dispose of batteries at designated battery disposal points.

# Wireless Baby Digital Monitor

SBM 1600

NE

## TECHNICAL SPECIFICATIONS

### Baby's unit

Frequency range.....	1.88 – 1.9 GHz
Transmission output.....	22 dbm
Effective range in a location without barriers .....	400m
Maximum battery operation time .....	15 hours
Sound detection sensitivity.....	61 - 73 dB (+/- 3 dB)
Power consumption (max.).....	80 mA
Power Supply.....	adapter 6V 400 mA or 4x AA batteries
Dimensions (length x depth x height): .....	109 x 50 x 92 mm
Weight .....	135 g

### Parent's unit

Frequency range.....	1.88 – 1.9 GHz
Transmission output .....	22 dbm
Effective range in a location without barriers .....	400m
Maximum battery operation time .....	8 hours
Reception sensitivity .....	61 - 73 dB (+/- 3 dB)
Power consumption (max.).....	70 mA
Power Supply.....	6V 400 mA or 2x AAA rechargeable batteries
Dimensions (length x depth x height): .....	62 x 40 x 108 mm
Weight .....	90 g

### Adapter

AC .....	230 V/50 Hz
DC .....	6 V/400 mA
Safety class (with regard to electric shock protection).....	II

Amendments to text and technical parameters are reserved.

This product is in accordance with the provision of directive no. 1999/5/ES. The certificate of compliance for this product can be found on the internet site [www.sencor.cz](http://www.sencor.cz).

## INSTRUCTIONS AND INFORMATION REGARDING THE DISPOSAL OF USED PACKAGING MATERIALS

Dispose of packaging material at a public waste disposal site.

## DISPOSAL OF USED ELECTRICAL AND ELECTRONIC APPLIANCES



The meaning of the symbol on the product, its accessory or packaging indicates that this product shall not be treated as household waste. Please, dispose of this product at your applicable collection point for the recycling of electrical & electronic equipment waste. Alternatively in some states of the European Union or other European states you may return your products to your local retailer when buying an equivalent new product. The correct disposal of this product will help save valuable natural resources and help in preventing the potential negative impact on the environment and human health, which could be caused as a result of improper liquidation of waste. Please ask your local authorities or the nearest waste collection centre for further details. The improper disposal of this type of waste may fall subject to national regulations for fines.

### For business entities in the European Union

If you wish to dispose of an electrical or electronic device, request the necessary information from your seller or supplier.

### Disposal in other countries outside the European Union

If you wish to dispose of this product, request the necessary information about the correct disposal method from local government departments or from your seller.



This product meets all the basic EU regulation requirements that relate to it.

Changes to the text, design and technical specifications may occur without prior notice and we reserve the right to make these changes.