

# TUMBLE DRYER

## USER'S MANUAL

**PHILCO**



*Famous for Quality the World Over*

**PD 8 Crown**

**Dear customer,**

**Thank you for buying a PHILCO brand product. So that your appliance serves you well, please read all the instructions in this user's manual.**

# CONTENT

<b>SECTION 1: SAFETY INSTRUCTIONS .....</b>	<b>3</b>
• Safety Instructions.....	3
<b>SECTION 2: INSTALLATION .....</b>	<b>8</b>
• Product Description.....	8
• Installation.....	8
<b>SECTION 3: OPERATIONS .....</b>	<b>10</b>
• Quick Start.....	10
• Before Each Drying.....	11
• Control Panel.....	12
• Other Functions.....	14
• Drying Programmes Table.....	16
<b>SECTION 4: MAINTENANCE.....</b>	<b>17</b>
• Cleaning And Care.....	17
• Trouble Shooting.....	18
• Technical Specifications .....	19
<b>SECTION 5: INFORMATION SHEET .....</b>	<b>20</b>
<b>INSTRUCTIONS AND INFORMATION REGARDING THE DISPOSAL OF USED PACKAGING MATERIALS .....</b>	<b>22</b>
<b>DISPOSAL OF USED ELECTRICAL AND ELECTRONIC APPLIANCES.....</b>	<b>22</b>



**Read all instructions and explanations before use. Follow the instructions carefully. Keep the operation instructions handy for later use. If the appliance is sold or passed on then ensure that the new owner always receives these operation instructions.**



**CAUTION: HOT SURFACE!**



**CAUTION: RISK OF FIRE!**

## SECTION 1: SAFETY INSTRUCTIONS

### Safety Instructions



#### Warning!

To prevent any damages to your and others' life or property, you have to follow the safety notes.

- This product belongs to Category I electrical appliances, and only for drying textiles which have been washed with water in the household. Please pay attention to the safety of power use during the operation!
- The power source with reliable earthing must be used. Its earth wire must be buried under the ground and shall not be connected with the public utilities such as city water pipe or gas pipe etc. The earth wire and null wire shall be distinguished and shall not be connected together.
- The power wire shall be met IEC and must be able to withstand the current above 16 A. To ensure your and your family's safety, please make improvement immediately if any power use at your home does not meet the above-mentioned requirements.
- Do not put more load than recommended. Obey the maximum load volume. See the related chapter in the user manual.
- That the tumble dryer is not to be used if industrial chemicals have been used for cleaning.
- Do not dry unwashed items in the tumble dryer.
- Items that have been soiled with substances such as cooking oil, acetone, alcohol, petrol, kerosene, spot removers, turpentine, waxes and wax removers should be washed in hot water with an extra amount of detergent before being dried in the tumble dryer.
- Items such as foam rubber (latex foam), shower caps, waterproof

textiles, rubber backed articles and clothes or pillows fitted with foam rubber pads should not be dried in the tumble dryer.

- Fabric softeners, or similar products, should be used as specified by the fabric softener instructions.
- The final part of a tumble dryer cycle occurs without heat (cool down cycle) to ensure that the items are left at a temperature that ensures that the items will not be damaged.
- The lint trap has to be cleaned frequently.
- The lint must not to be allowed to accumulate around the tumble dryer.
- Adequate ventilation has to be provided to avoid the back flow of gases into the room from appliance burning other fuels, including open fires.
- The exhaust air must not be discharged into a flue which is used for exhausting fumes from appliance burning gas or other fuels.
- The appliance must not be install behind a lockable door, a sliding door or a door with a hinge on the opposite side to that of the tumble dryer. In such a way that a full opening of the tumble dryer door is restricted.
- Oil-affected items can ignite spontaneously, especially when exposed to heat sources such as in a tumble dryer. The items become warm, causing an oxidation reaction in the oil. Oxidation creates heat. If the heat cannot escape, the items can become hot enough to catch fire. Piling, stacking or storing oil-affected items can prevent heat from escaping and so create a fire hazard.
- If it is unavoidable that fabrics that contain vegetable or cooking oil or have been contaminated by hair care products be placed in a tumble dryer they should first be washed in hot water with extra detergent-this will reduce, but not eliminate, the hazard.
- The appliance should not be overturned during normal use or maintenance.

- Remove all objects from pockets such as lighters and matches.
- This appliance can be used by children aged from 8 years and above and persons with reduced physical, sensory or mental capabilities or lack of experience and knowledge if they have been given supervision or instruction concerning use of the appliance in a safe way and understand the hazards involved. Children shall not play with the appliance. Cleaning and user maintenance shall not be made by children without supervision. (This warning is only for EUROPEAN market)
- If the power cable is damaged, it must be replaced by the manufacturer, its service agent or similarly qualified persons in order to avoid a hazard.
- This appliance is for indoor use only.
- The openings must not be obstructed by a carpet.
- Children of less than 3 years should be kept away unless continuously supervised.
- If the appliance appear high temperature abnormally, please draw the mail plug immediately.
- The appliance is not intended for use by persons (including children) with reduced physical, sensory or mental capabilities, or lack of experience and knowledge, unless they have been given supervision or instruction concerning use of the appliance by a person responsible for their safety. Children should be supervised to ensure that they do not play with the appliance. (This warning is not for EUROPEAN market)



### **Warning!**

Never stop a tumble dryer before the end of the drying cycle otherwise too much heat will diffuse and may cause harm.

## Correct Disposal of this product:



This marking indicates that this product should not be disposed with other household wastes throughout the EU. To prevent possible harm to the environment or human health from uncontrolled waste disposal, recycle it responsibly to promote the sustainable reuse of material resources. To return your used device, please use the return and collection systems or contact the retailer where the product was purchased. They can take this product for environmental safe recycling.

## Electric shock hazard

- Do not draw the power cord forcefully to pull out the mains plug.
- Please do not plug/draw the mains plug with wet hands.
- Do not damage the power cord and the power plug.

## Injury danger

- Do not disassemble and install the dryer under no instruction or supervision.
- Do not stack this dryer on washing machine without stacking kits.(if want stacking on washing machine, please purchase the independent parts and it must be installed by the manufacturer, its service agent or similarly qualified persons in order to avoid a hazard.)
- Do not lean on the opened door of the dryer.
- Do not put any pyrotoxin on the dryer, such as the candle, electric cooker.

## Damage danger

- Do not dry over the rated capacity.
- Do not operate the dryer without the filter door and filter base.



- Do not dry the clothes before being spun.
- Do not expose the dryer directly under the sun, and indoor use only.
- Do not install the dryer in humid and drenching environment.
- While cleaning and maintenance, please do remember to pull out the power plug and do not directly wash the dryer with water.

### **Explosion danger**

Please do not dry the clothes with some flammable substances such as coal oil, alcohol or there will be explosion.

## SECTION 2: INSTALLATION

### Product Description

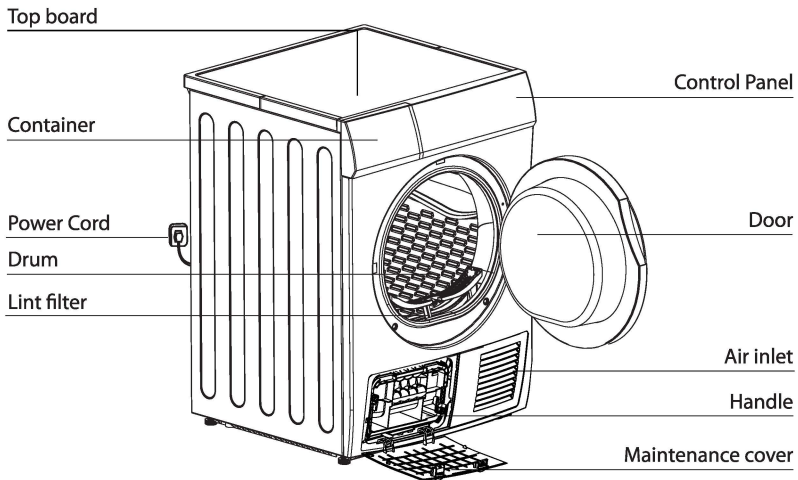

### Accessories

The following parts are optional for specific models.

If your dryer has following parts, please wear gloves and install them following the instruction below.

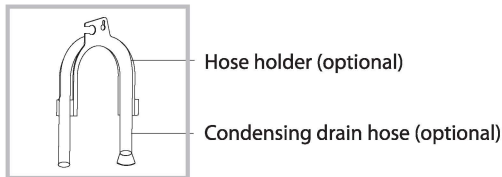

### Installation

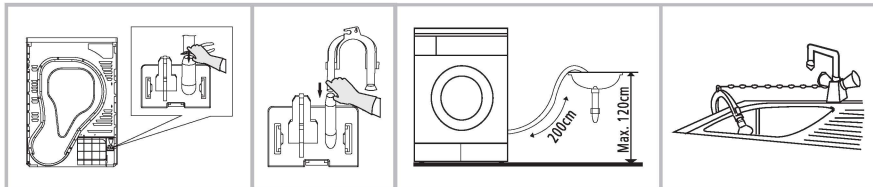

Use pliers to remove the drain hose from the hose connector.

Insert the external drainage hose.

Put the hose holder on the washing basin or any other sink.

## Transport

Move cautiously Do not grasp any salient parts of machine. The machine door can not be used as the handle for delivery.

## Installation Position

1. It is recommended that, for your convenience, the machine is positioned close to your washing machine.
2. The tumble dryer must be installed in a clean place, where dirt does not build up. Air must be able to circulate freely all round the appliance. Do not obstruct the front air inlet or the air intake grilles at the back of the machine.
3. To keep vibration and noise to a minimum when the dryer is in use, it should be placed on a firm and level surface.
4. The feet must never be removed. Do not restrict the floor clearance through deep pile carpets, strips of wood or similar. This might cause heat built-up which would interfere with the operation of the appliance.

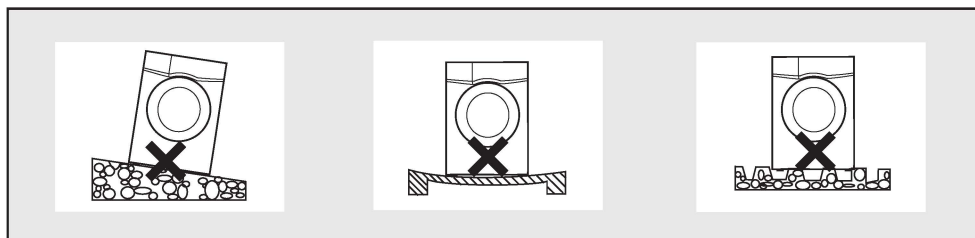

## Level Adjusting

Once in its permanent operating position, check that the dryer is absolutely level with the aid of a spirit level. If it is not, adjust the feet with a tool.

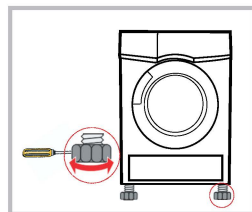

## Power Supply Connection

1. Make sure that the voltage of the power supply is the same as the electric specification of the dryer.
2. Do not connect the dryer with the power connection board, the universal plug or socket.

## SECTION 3: OPERATIONS

### Quick Start

**Note!**

Before using, please make sure it's installed properly.

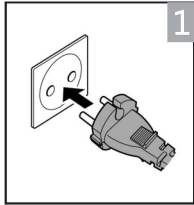

plug in

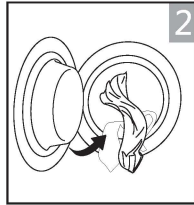

load

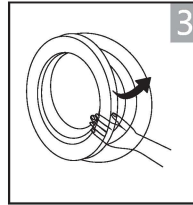

close door

### Drying



on



select program



select function or  
default



start

### After Drying

Buzzer beep or "0:00" on display.

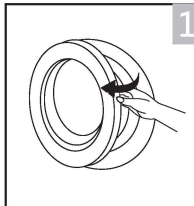

open the door and  
take out laundry

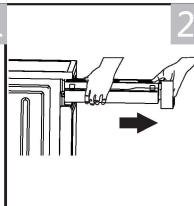

pull out the  
container

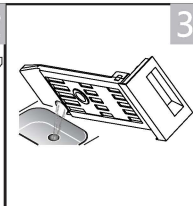

pour out  
condensate water

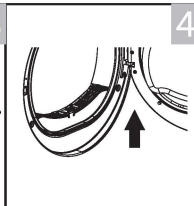

clean the filter

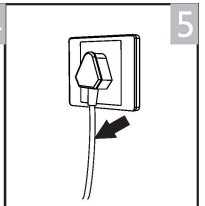

power off

**Note!**

If use the socket with a switch, please press the switch to turn off the power directly.











## Before Each Drying

### Attention!

Before the first cycle, the dust and grease may remain in this dryer during the period of manufacture and transportation, to avoid contaminating your clothes, please follow these steps:

- Put some clean rags into the drum.
  - Plug the power.
  - Select the „Quick“ Programme, press „Start/Pause“ button.
  - After finishing this programme, please follow the „Cleaning And Care“ to clean the lint filter and air condenser on page 19.
1. Before drying, thoroughly spin the laundry in washing machine. High spin speed can reduce the drying time and save energy consumption.
  2. For uniform drying result, sort the laundry according to fabric type and drying programme.
  3. Before drying, please close zips, hooks and eyelets, button up, tie fabric belts, etc.
  4. Do not over dry the clothes, because over dried clothes can easily get creases.
  5. Do not dry the articles containing rubber or similar elastic materials.
  6. The door can be opened only after the programme of the drying machine finishes to prevent human skin from being scalded by hot steam or over heated drying machine.
  7. Clean the lint filter and empty container after each use to avoid extension of drying time and energy consumption.
  8. Do not dry these clothes after dry-clean process.













### The reference weight of dry clothes (each)

	Mixed-fabric clothes (about 800 g)		Jacket (about 800 g cotton)		Jeans (about 800 g)		Towel quilt (about 900 g cotton)
	Single bedsheet (about 600 g cotton)		Work clothes (about 1120 g)		Sleepwear (about 200 g)		Long sleeve shirt (about 300 g cotton)
	Short sleeve shirt (about 180 g cotton)		Short pants (about 70 g cotton)		Socks (about 50 g mixed-weave)		

### Note!

- Never overload.
- Not for textile with dropping water. The dryer could be damaged, even fire.
- Not suitable for silk or woollen textiles.







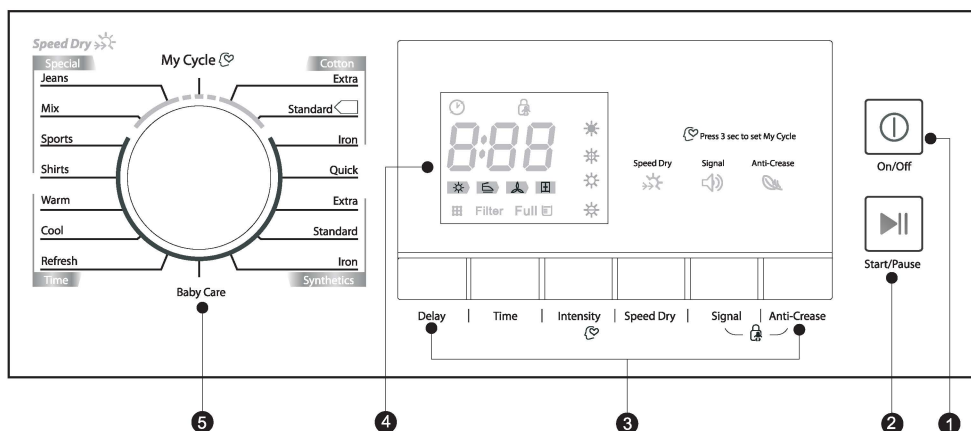







Please pay attention to use the drying machine if the materials of your clothes can not be dried by it or contain the symbols as follows:

 Dry	 Normal	 Not tumble dry normal	 Do not dry
 Line dry/hang to dry	 Drip dry	 Dry flat	 In the shade
 Dry clean	 Do not dry clean	 Dry clean normal cycle with any solvent	 Dry clean normal cycle petroleum solvent only

## Control Panel

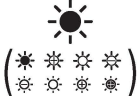

- 1 On/Off**  
Product is switched on or off.
- 2 Start/Pause**  
Press the button to start or pause the drying cycle.
- 3 Specialty function**  
These buttons are used for setting additional functions.
- 4 Display**  
This display shows the setting, estimated remaining time and status messages of your dryer.
- 5 Programmes**  
Different Dryer cycle can be selected according to the user's needs to make the clothes have more effective drying results.

	Fliter Please clean the filter when the „  “ is lighting, after the dryer stops.
	Tank Please empty the container when the „  “ is lighting, after the dryer stops.
	Delay start
	Time
	Child lock
	Remaining Time indicator/Error message
	Cycle phase status
 Filter	Clean filters (warning)
Full 	Empty water container (warning)
	Dryness level (four grades)
	Speed dry indicator
	Signal indicator
	Anti-crease mode
	My cycle

## Programme selector

1. Press the [On/Off] button, when the LED display screen brightens up, rotate the programme knob to select the desired programme.
2. Select the [Delay], [Time], [Intensity], [Speed Dry], [Signal] or [Anti-Crease] functions for additional option.
3. Press the [Start/Pause] button.

## Programme start

The drum will keep rotating after the programme starts, the state light in the display area will flash in sequence, the remaining time displayed will change automatically.

## Programme end

1. The drum will stop running after the programme ends, the buzzer will beep, the display will show "000", the last cycle phase status light will flash. The dryer will start [Anti-crease] function if user doesn't remove the load in 1 minute (refer to page 15). Please press [On/Off] key to cut off power and pull the plug out.
2. Deal with the problem according to "Malfunction display and solutions", if there is an unexpected stop during the drying procedure and the dryer shows information (refer to page 20).

## Other Functions

### Instructions of the [Delay] function

This function is used for delaying clothes drying time within 24 hours. The delay time means the programme will start after x hours. When the delay programme starts, the time starts to decrease on the display and the delay icon blinks. Steps in details

1. Load your laundry and make sure the machine door is closed.
2. Press the [On/Off] button, then to turn the programme selector knob and select a desired programme.
3. You can select the [Anti-Crease] or [Signal] functions according to your need.
4. To press the [Delay] key.
5. Continue to press the [Delay] to select the delay time.
6. After the [Start/Pause] button is pushed, the dryer is at the run condition. The drying procedure will be automatically performed when the delay time is over.
7. If you push the [Start/Pause] button again, the delay function will be paused.
8. If you want to cancel the "Delay" function, please press the [On/Off] button.

### Instructions of the [Time] function

When the warm or cool or refresh programme is selected, the [Time] button can be used to adjust the drying time in 10 min. steps.

### Instructions of the [Intensity] function

Used to adjust the dryness level of the laundry. The level has four grades. The drying time increases 5 minutes in every grade.

1. The intensity function can be activated only before the programme start.
2. Press the [Intensity] button repeatedly to select the drying time.
3. Except the [Cotton Iron] [Quick] [Synthetic Iron] [Baby Care] [Warm] [Cool] [Refresh], all the other programmes can be the [Intensity] function.

### Instructions of the [Speed dry]

Use to curtail shorten the drying time, the [Cotton Extra] [Cotton Standard] [Mix] [Jean] programme can be set the function.

### Instructions of the [Signal] function

Set up the buzzer on or off. In the general condition, the buzzer is on. Please press it if needed. When the buzzer on:

1. The dryer will give the leading sound if press the extra function buttons.
2. If the dryer is running, rotate the function choosing knob, the dryer will remind the operator it is an invalid choose.
3. When the drying programme is end, the buzzer will also remind the user



## Instructions of the [Anti-Crease] function

At the end of the drying cycle, the anti-crease operation time is 30 minutes (default) or 120 minutes (selected). The [Anti-Crease] light shall illuminate when the anti-crease function is selected. This function prevents the laundry from creases. The laundry can be removed during the anti-crease phase. Except [Cool], [Refresh], all the other programmes have this function.

## Instructions of the [My Cycle] function

Used to define and save your favorite programmes that are used frequently.

1. Use the programme selector to select the required programme and other drying functions.
2. Press and hold the [Intensity] button for 3 seconds until the beep and the required programme has been saved.
3. Turn the programme selector to the [My Cycle] position, you can start your favorite programmes. If you want to change the [My Cycle] settings, repeat the steps 1 and 2.

## Instructions of the [Child Lock] feature /

1. This machine incorporates a special child safety lock, which can prevent children from carelessly pressing keys or making the faulty operation.
2. When the dryer is at the operation state except standby state, press the [Anti-Crease] and [Signal] buttons at the same time for over 3 seconds to start child lock function.  
When child lock function is set, the display will show child lock icon and no key can effect to the dryer except [On/Off] button.

Under the start state of the child lock, the [Anti-Crease] and [Signal] buttons shall be pressed at the same time for over 3 seconds to release the child lock function.

# Drying Programmes Table

## PD 8 Crown

Programme	Weight (max)		Application/Properties	Delay	Time
	8.0 kg				
Cotton	For cottons and coloureds made of cotton or linen.				
	Extra	8.0 kg	To dry cotton pieces of clothing. Drying level: extra dry.	Y	N
	Standard		To dry cotton pieces of clothing. Drying level: cupboard dry.		
Iron	To dry cotton pieces of clothing. Drying level: applicable to iron.				
Quick	Quick	3.0 kg	For washing which is to be dried quickly, eg, made of acrylic fibres or for individual small items. Also for subsequent drying.	Y	N
Synthetics	For non-iron washing made of synthetic and blended fabrics, cotton.				
	Extra	3.5 kg	To dry thick or multi-layered synthetic fabrics. Drying level: extra dry.	Y	N
	Standard		To dry thin synthetic fabrics which are not ironed, such as easy care shirts, table linen, baby clothes, socks.		
Iron	To dry thin synthetic fabrics which are also to be ironed, such as knitwear, shirts.				
Baby Care	Baby Care	1.0 kg	To dry small amount of baby clothing.		
Special	Jean	6.0 kg	To dry jeans or leisure clothes that are spun at high speeds in the washing machine.	Y	N
	Mix	3.0 kg	If you can not determine what the clothing's material is, please choose Mix.		
	Sports	3.0 kg	To dry sportswear, thin fabrics, polyester, which are not ironed.		
	Shirts	3.0 kg	For easy care clothes such shirts and blouses with anti-crease mechanism for minimum ironing effort. Place clothes loosely in the dryer. Once dried, hang it on a clothes hange		
My Cycle	My Cycle	—	Define and save your favorite programme.	Y	—
Time	Warm	—	To warm clothes from minimum 10 min. to maximum 120 min. (in 10 min. steps).	Y	Y
	Cool	—	To cool clothes without blowing hot air from minimum 10 min. to maximum 30 min. (in 10 min. steps).		
	Refresh	—	To refresh the clothes that have been kept at closed environments for a long time from minimum 20min. to maximum 150 min. (in 10 min. steps).		

- ☐ This symbol means the energy efficiency test programme „standard cotton programme“, which is accordance with the applicable EN 61121 standard and most suitable to dry normal cotton load at rated load capacity.
- Thick or multi-layered fabrics.e.g. bedlinen, jeans, jackets etc, are not easy to dry. You'd better choose Cotton Extra programme.
- As the uneven material, thick and multi-layered clothes are not easy to dry, it is better to choose the appropriate time drying programme to dry them if some parts of the clothes still damp after programme finished.

## SECTION 4: MAINTENANCE

### Cleaning And Care

#### Clean the lint filter

Leave the dryer to cool down.

1. Open the machine door.
2. Take out the lint filter, pull upward to take it out.
3. Clean the lint filter; wipe off the scrap threads accumulated on the lint filter, with your hand or rinse with water and dry thoroughly.
4. Reinstall the lint filter.

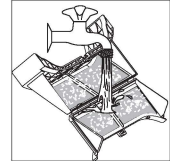
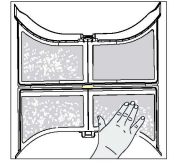
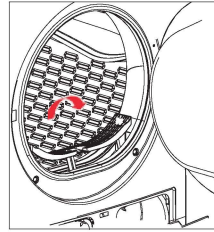

#### Note!

- The lint filter accumulated on the filter will block the air circulation, which will cause the extension of drying time and energy use; therefore, the scrap thread filter shall be cleaned after each use.
- Do disconnect the power cord before cleaning!
- Do not operate the dryer without the lint filter!
- Clean the lint filter after each use to prevent lint accumulation inside the dryer.

#### Wash air condenser

Leave the dryer to cool down.

Residual water may escape, place an absorbent cloth under the maintenance cover.

1. Unlock the maintenance cover.
2. Completely open maintenance cover.
3. Screw both locking levers towards each other.
4. Pull out the air condenser.
5. Clean the air condenser completely, drain thoroughly.
6. Clean the seals.
7. Re-insert the air condenser, handle at the button!
8. Unscrew both locking levers.
9. Close the maintenance cover until it locks into position.  
Please clean the air condenser approx. once every 3 months if frequently used.  
Do not damage the air condenser!

#### Warning!

- Clean with water only; do not use hard/sharp-edged objects!  
Do not operate the dryer without the air condenser!
- During drying, water may collect between the window and the seal, but this does not affect the function of your dryer!

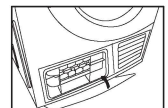
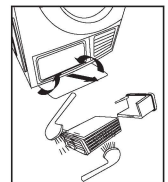
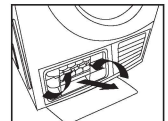
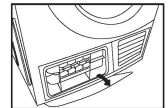

## Empty the water container

1. Hold and pull out the water container with two hands.
2. Tilt the water container, pour out the condensate water.
3. Insert the water container.

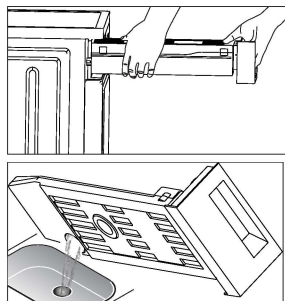

### Warning!



- Empty the water container after each use, the programme will be paused and the „E“ icon will light if the water container is full during the drying process. After the container is emptied, the dryer can be restarted by pressing [Start/Pause] button.
- Do not drink the condensate water.
- Do not use the dryer without the water container.

## Trouble Shooting

Alarm Problem	Alarm Reason	Release
„E30“	Heating problem	Please contact your local service center if the problem persists.
„E32“	Humidity sensor error	
„E33“	Temperature sensor error	

### Warning!

- Only authorised technicians can carry out repairs.
- Before you call service, please check if you have dealt with the fault yourself or if you have followed the user instructions.
- A technician will charge you for advice, even during the warranty period.

Problem	Solution
<ul style="list-style-type: none"> <li>• Display does not on</li> </ul>	<ul style="list-style-type: none"> <li>• Check if the power supply works.</li> <li>• Check if the mains plug is inserted.</li> <li>• Check the selected programme.</li> <li>• Press the [On/Off] button.</li> </ul>
<ul style="list-style-type: none"> <li>• „“ is lighting</li> </ul>	<ul style="list-style-type: none"> <li>• Empty water container.</li> <li>• If the light is still on, please call the service.</li> </ul>
<ul style="list-style-type: none"> <li>• „“ is lighting</li> </ul>	<ul style="list-style-type: none"> <li>• Clean heat exchanger.</li> <li>• Clear lint filter.</li> </ul>
<ul style="list-style-type: none"> <li>• Dryer does not start</li> </ul>	<ul style="list-style-type: none"> <li>• Check the the door has closed.</li> <li>• Check the programme has set.</li> <li>• Check the start button has selected.</li> </ul>
<ul style="list-style-type: none"> <li>• Degree of dryness was not reached or drying time too long</li> </ul>	<ul style="list-style-type: none"> <li>• Clean lint filter and heat exchanger.</li> <li>• Empty container.</li> <li>• Check drain hose.</li> <li>• Dryer installation place is too restricted.</li> <li>• Clean the moisture sensors.</li> <li>• Keep the Air inlet clean.</li> <li>• Use higher drying intensity level programme or time programme.</li> </ul>

### Warning!

If you cannot deal with the fault by yourself and need help:

- Press the [On/Off] button.
- Pull out the mains plug and call the service.

## Technical Specifications

Parameter	Model	PD 8 Crown
Dimension(L*W*H)		615*595*845 (mm)
Ambient temperature		+5 °C ~ +35 °C
Rated input power		2700 W
Rated voltage		220–240 V ~
Rated frequency		50 Hz
Weight of product		41 kg
Rated capacity		8.0 kg

### Note!

- The rated capacity is the maximum capacity, make sure that the dry clothes which are loaded to the appliance do not exceed the rated capacity each time.
- Do not install the tumble dryer in a room when there is a risk of frost occurring. At temperatures around freezing point the tumble dryer may not be able to operate properly.
- There is a risk of damage if the condensate water is allowed to freeze in the pump, hoses and/or condensate water container.

## SECTION 5: INFORMATION SHEET

Philco brand: **PHILCO** 

Brand	Philco
Product number	PDC 8 Crown
Drying capacity (kg) - cotton	8
Condensation clothes dryer	yes
Power efficiency class (A+++... highest efficiency up to D... lowest efficiency)	B
Weighted annual power consumption (kWh)*	560.9
Automatic drum dryer	yes
Power consumption (kWh) - power consumption on „standard program for cotton with full and half loads“	4.74/2.57
Power input when turned off (W)	0,1
Power input when in stand-by (W)	0,8
Weighted duration of „standard program for cotton with full and half loads“ (min.)	111
Weighted duration of „standard program for cotton with full loads“ (min.)	140
Weighted duration of „standard program for cotton with half loads“ (min.)	90
Condensation efficiency class (A ... highest efficiency up to G... lowest efficiency)	B
Average condensation efficiency of „standard program for cotton with full and half loads“ (%)	81
Average condensation efficiency of „standard program for cotton with full and half loads“ (%)	81
Average condensation efficiency of „standard program for cotton with full and half loads“ (%)	81
Acoustic power level of „standard program for cotton with full and half loads“ dB (re 1 pW)	69
Using	free standing
Dimensions cm (h x w x d) cm	84.5 x 59.5 x 61.5
Weight (kg)	41

“Standard program for cotton“ used with full and half loads is a standard drying program, to which the information stated on the information sheet energy label apply. This program is suitable for drying standard wet cotton laundry and is the most effective program with respect to power consumption.

\* Power consumption „X“ kWh per year based on 160 standard drying cycles within a standard program for cotton at full and half load and power mode with low power consumption Actual power consumption per cycle will depend on how the appliance is used.

\*\* Noise level according to European norm EN 60704

The program settings for testing are in accordance with the EN 60456-2011 standard.

## INSTRUCTIONS AND INFORMATION REGARDING THE DISPOSAL OF USED PACKAGING MATERIALS

Dispose of packaging material at a public waste disposal site.

### DISPOSAL OF USED ELECTRICAL AND ELECTRONIC APPLIANCES



The meaning of the symbol on the product, its accessory or packaging indicates that this product shall not be treated as household waste. Please, dispose of this product at your applicable collection point for the recycling of electrical & electronic equipment waste. Alternatively in some states of the European Union or other European states you may return your products to your local retailer when buying an equivalent new product. The correct disposal of this product will help save valuable natural resources and help in preventing the potential negative impact on the environment and human health, which could be caused as a result of improper liquidation of waste. Please ask your local authorities or the nearest waste collection centre for further details. The improper disposal of this type of waste may fall subject to national regulations for fines.

#### **For business entities in the European Union**

If you wish to dispose of an electrical or electronic device, request the necessary information from your seller or supplier.

#### **Disposal in other countries outside the European Union**

If you wish to dispose of this product, request the necessary information about the correct disposal method from local government departments or from your seller.



This product meets all the basic EU regulation requirements that relate to it.

Changes to the text, design and technical specifications may occur without prior notice and we reserve the right to make these changes.



Manufacturer/Importer:  
Fast ČR, a.s.  
Praha 10, Černokostecká 2111  
CZ-10000; CZECH REPUBLIC

**PHILCO**<sup>®</sup> 

**is a registered trademark used under license from  
Electrolux International Company, U.S.A.**