

Washing Machine

OWNER'S MANUAL

PHILCO



Famous for Quality the World Over

PLD 126 D QTL

**Dear customer,
Thank you for buying a PHILCO brand product. So that your appliance serves you well, please read all the instructions in this user's manual.**

CONTENTS

PART 1: SAFETY INSTRUCTIONS	2
Safety Instructions	2
PART 2: INSTALLATION	7
Product Description	7
Installation	8
PART 3: OPERATIONS.....	12
Quick Start	12
Before Each Washing.....	13
Detergent Dispenser.....	14
Control Panel	15
Option	16
Other Functions	17
Programmes.....	19
Washing Programmes Table.....	20
PART 4: MAINTENANCES	21
Cleaning And Care	21
Cleaning The Inlet Filter	21
Cleaning The Drain Pump Filter	22
Trouble Shooting.....	23
Technical Specifications.....	25
PART 5: PRODUCT INFORMATION SHEET	26

Read This Manual

Use all instructions and explanations of the installation before use. Follow the instructions carefully. Keep the operation instructions handy for later use. If the application is sold or passed on then ensure that the new owner always receives those operation instructions.

PART 1: SAFETY INSTRUCTIONS

■ Safety Instructions

For your safety, the information in this manual must be followed to minimize the risk of fire or explosion, electric shock, or to prevent property damage, personal injury or loss of life.

Explanation of the symbols:

Warning!

This combination of symbol and signal word indicates a potentially dangerous situation which may result in death or serious injuries unless it's avoided.

Caution!

This combination of symbol and signal word indicates a potentially dangerous situation which may result in slight or minor injuries or damage to property and the environment.

Note!

This combination of symbol and signal word indicates a potentially dangerous situation which may result in slight or minor injuries.

Warning!

The electric shock!

- If the supply cord is damaged, it must be replaced by the manufacturer, its service agent or similarly qualified persons in order to avoid a hazard.

- The new hose-sets supplied with the appliance are to be used and that old hose-sets should not be reused.
- Before any maintenance the device, unplug the appliance from the mains.
- Always unplug the machine and turn off the water supply after use. The max. inlet water pressure, in pascals. The min. inlet water pressure, in pascals.
- To ensure your safety, power plug must be inserted into an earthed three-pole socket. Check carefully and make sure that your socket is properly and reliably earthed.
- Make sure that the water and electrical devices must be connected by a qualified technician in accordance with the manufacturer's instructions and local safety regulations.

Risk to children!

- EN countries: the appliance can be used by children aged from 8 years and above and persons with reduced physical, sensory or mental capabilities or lack of experience and knowledge if they have been given supervision or instruction concerning use of the appliance in a safe way and understand the hazards involved. Children shall not play with the appliance. Cleaning and user maintenance shall not be made by children without supervision.
- Children of less than 3 years should be supervised to ensure that they do not play with appliance.
- Animals and children may climb into the machine. Check the machine before every operation.
- Kids should be supervised that they do not play with the appliance.

- Remove all packages and transport bolts before using the appliance. Otherwise, serious damage may result.
- Plug must be accessible after installation.

Risk of explosion!

- Do not wash or dry articles that have been cleaned in, washed in, soaked in, or dabbed with combustible or explosive substances (such as wax, oil, paint, gasoline, degreasers, dry-cleaning solvents, kerosene, etc.) This may result in fire or explosion.
- Before hand thoroughly rinse items of washing by hand.

⚠ Caution!

Installing the product!

- This washing machine is for indoor use only.
- It isn't intended to be built-in using.
- The openings must not be obstructed by a carpet.
- Washing machine shall not be installed in bath room or very wet rooms as well as in the rooms with explosive or caustic gases.
- The washing machine with single inlet valve only can be connected to the cold water supply. The product with double inlet valves should be correctly connected to the hot water and cold water supply.
- Plug must be accessible after installation.
- Remove all packages and transport bolts before using the appliance. Otherwise, serious damage may result.

Risk of damaging appliance!

- Your product is only for home use and is only designed for the textiles suitable for machine washing.
- Do not climb up and sit on top cover of the machine.
- Do not lean against machine door.
- Cautions during Handling Machine:
 1. Transport bolts shall be reinstalled to the machine by a specialized person.
 2. The accumulated water shall be drained out of the machine.
 3. Handle the machine carefully. Never hold each protruded part on the machine while lifting. Machine door can not be used as the handle during the conveyance.
 4. This appliance is heavy. Transport with care.
- Please do not close the door with excessive forces. If it is found difficult to close the door, please check if the clothes are put in or distributed well.
- It is forbidden to wash carpets.

Operating the appliance!

- Flammable and explosive or toxic solvents are forbidden. Gasoline and alcohol etc. Shall not be used as detergents. Please only select the detergents suitable for machine washing, especially for drum.
- Make sure that all pockets are emptied. Sharp and rigid items such as coin, brooch, nail, screw or stone etc. may cause serious damages to this machine.

- Please check whether the water inside the drum has been drained before opening its door. Please do not open the door if there is any water visible.
- Be careful of burning when the product drains hot washing water.
- Never refill the water by hand during washing.
- After the program is completed, Please wait for two minutes to open the door.

Packaging/Old appliance



This marking indicates that this product should not be disposed with other household wastes throughout the EU. To prevent possible harm to the environment or human health from uncontrolled waste disposal, recycle it responsibly to promote the sustainable reuse of material resources. To return your used device, please use the collection systems or contact the retailer where the product was purchased. They return and can take this product for environmental safe recycling.

THIS APPLIANCE IS INTENDED TO BE USED ONLY IN HOUSEHOLDS AND NOT IN SIMILAR PREMISES, SUCH AS:

- KITCHENETTES IN SHOPS, OFFICES AND OTHER WORKPLACES;
- APPLIANCES USED APPLIANCES USED BY GUESTS IN HOTELS, MOTELS, AND OTHER ACCOMMODATION FACILITIES;
- APPLIANCES USED IN BED AND BREAKFAST FACILITIES;
- APPLIANCES USED IN CATERING AND OTHER SIMILAR NON-VENDING ENVIRONMENTS

PART 2: INSTALLATION

■ Product Description

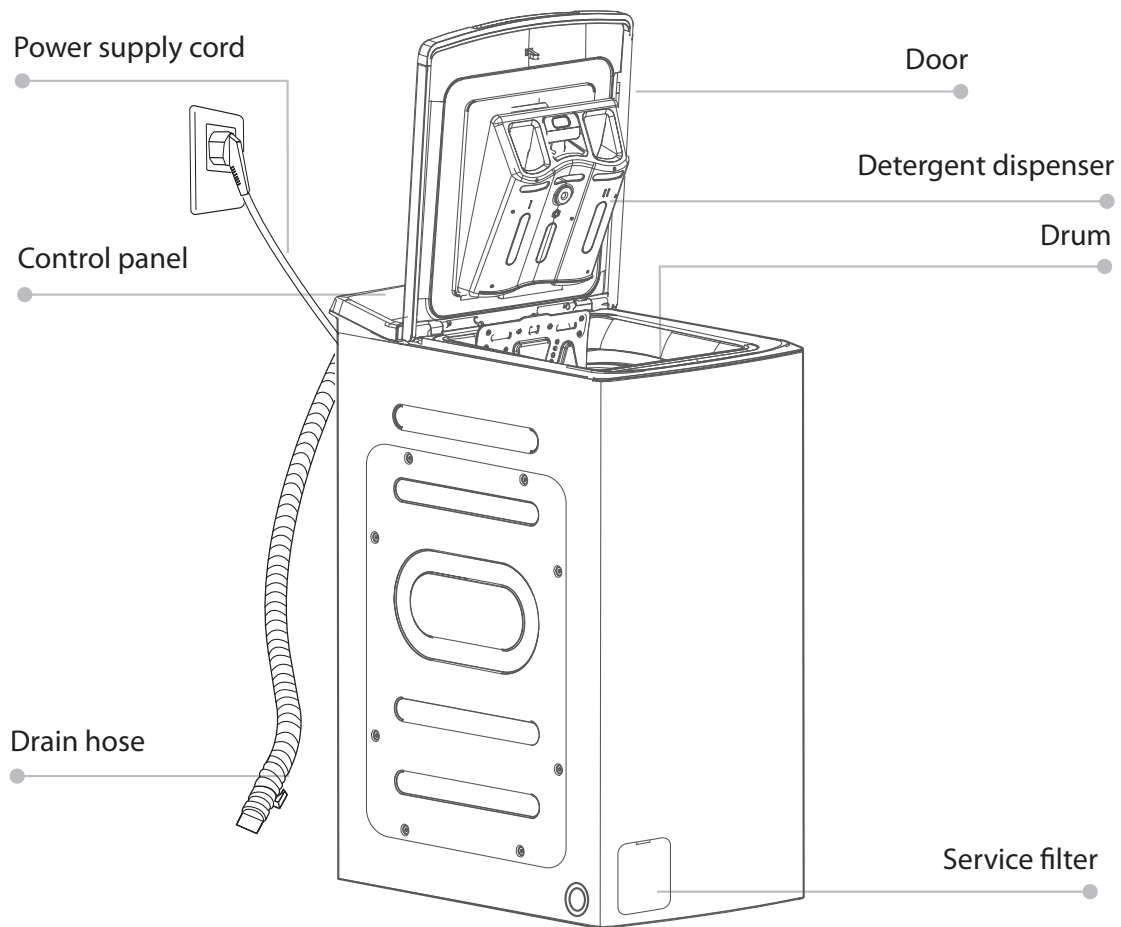

Note!

- The product line chart is for reference only, please refer to real product as standard.

Accessories



Transport hole
plug

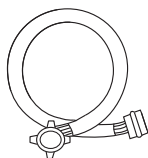

Supply hose cold
water

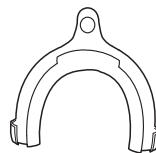

Drain hose
support
(optional)



Owner's manual

■ Installation

Installation area

Warning!

- Stability is important to prevent the product from wandering!
- Make sure that the product should not stand on the power cord.

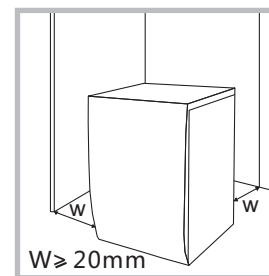

Before installing the machine, the location characterized as follows shall be selected:

1. Rigid, dry, and level surface
2. Avoid direct sunlight
3. Sufficient ventilation
4. Room temperature is above 0°C
5. Keep far away from the heat resources such as coal or gas.

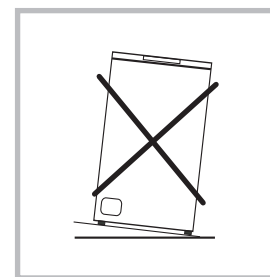

Unpacking the washing machine

Warning!

- Packaging material (e.g. Films, Styrofoam) can be dangerous for children.
- There is a risk of suffocation ! Keep all packaging well away from children.

1. Remove the cardboard box and styrofoam packing.
2. Lift the washing machine and remove the base packing. Make sure the small triangle foam is removed with the bottom one together. If not, lay the unit down with side surface, then remove the small foam from the unit bottom manually.
3. Remove the tape securing the power supply cord and drain hose.
4. Remove the inlet hose from the drum.

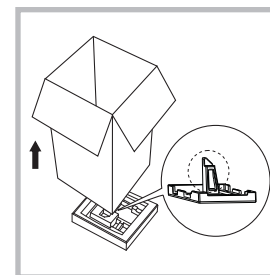

Remove transport bolts

Warning!

- You must remove the transport bolts from the backside before using the product.
- You'll need the transport bolts again if you move the product, so make sure you keep them in a safe place.

Please take the following steps to remove the bolts:

1. Loosen 4 bolts with spanner and then remove them.
2. Stop the holes with transport hole plugs.
3. Keep the transport bolts properly for future use.

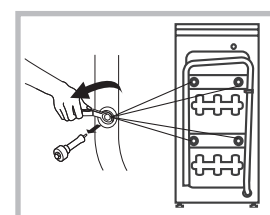

Levelling the washing machine

Warning!

- The lock nuts on all four feet must be screwed tightly against the housing.
1. Check if the legs are closely attached to the cabinet. If not, please turn them to their original positions tighten the nuts.
 2. Loosen the lock nut turn the feet until it closely contacts with the floor.
 3. Adjust the legs and lock them with a spanner, make sure the machine is steady.

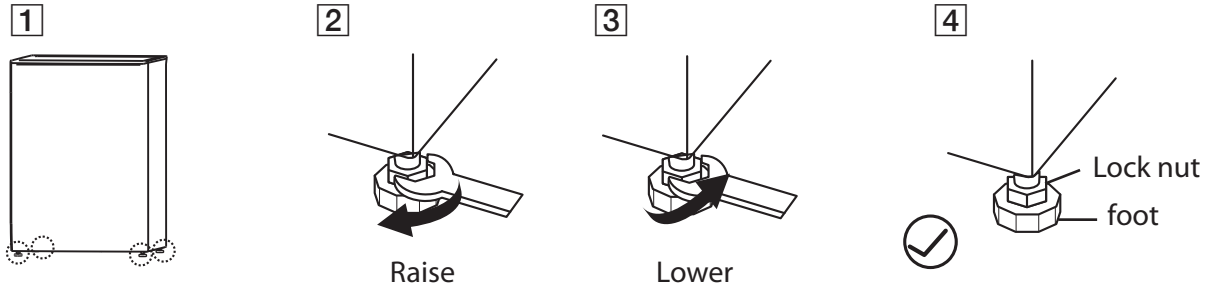

Connect Water Supply Hose

Warning!

- To prevent leakage or water damage, follow the instructions in this chapter
- Do not kink, crush, modify or sever water inlet hose.
- For the model equips hot valve, connect it to hot water tap with hot water supply hose. Energy consumption will decrease automatically for some program.

Connect the inlet pipe as indicated, There are two ways to connect the inlet pipe.

1. Connection between ordinary tap and inlet hose.

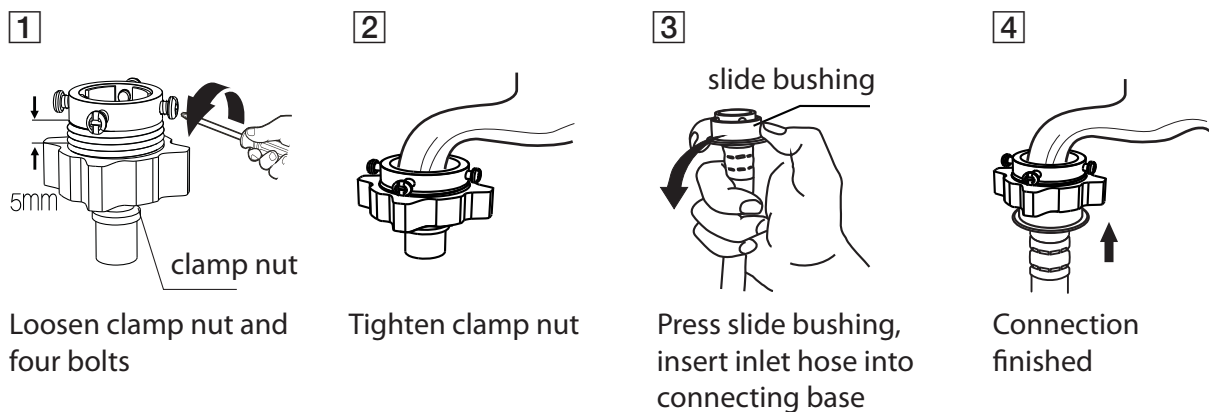

2. Connection between screw tap and inlet hose.



Connect the other end of inlet pipe to the inlet valve at the backside of product and fasten the pipe tightly clockwise.

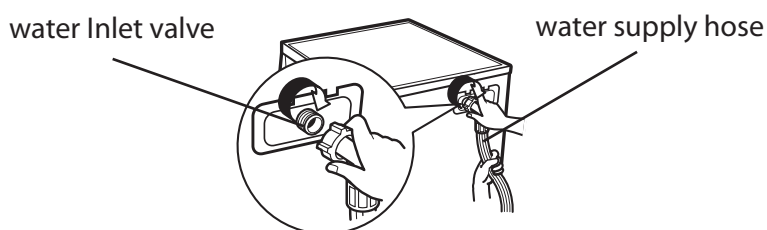

Drain Hose

Warning!

- Do not kink or protract the drain hose.
- Position drain hose properly, otherwise damage might result of water leakage.

There are two ways to place the end of drain hose:

1. Put it into the water trough.

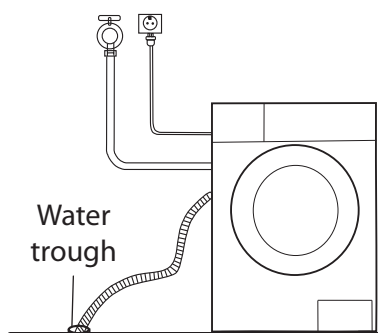

2. Connect it to the branch drain pipe of the trough.

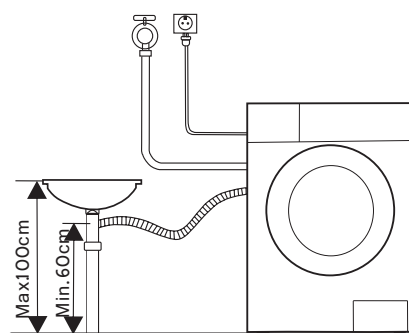

Note!

- If the machine has drain hose support, please install it like the following.

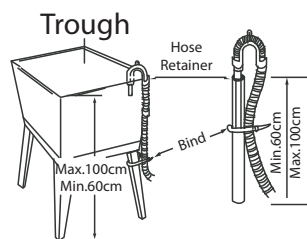
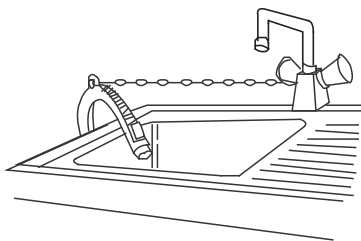

Warning!

- When installing drain hose, fix it properly with a rope.
- If drain hose is too long, do not force it into washing machine as it will cause abnormal noises.

PART 3: OPERATIONS

■ Quick Start

⚠ Caution!

- Before washing, please make sure it's installed properly.

1. Before Washing

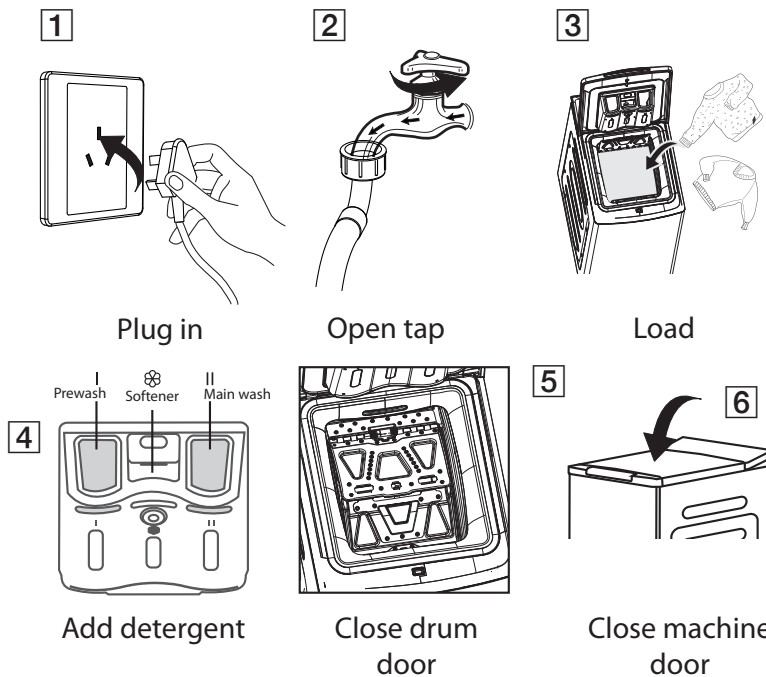

📌 Note!

- Detergent need to be added in "case I" after selecting pre-washing for machines with this function.
- Make sure that the drum flaps are properly locked.

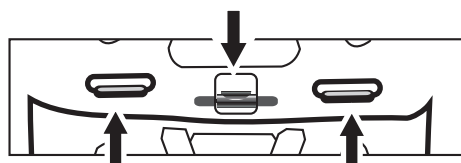

- All metal hooks must be properly hooked inside the rear door flap.

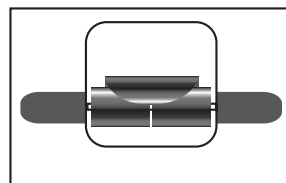

- Check the roller before each laundry ,it must roll smoothly.

2. Washing

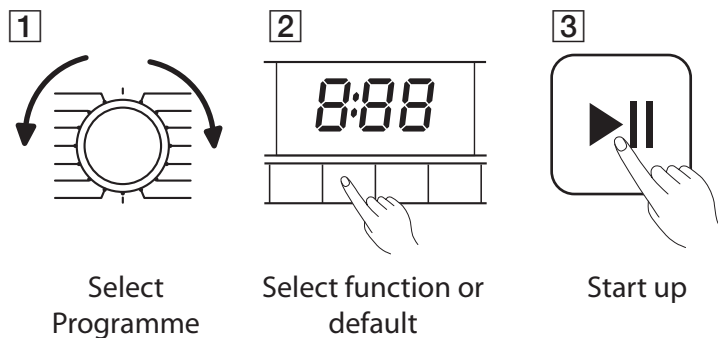

Note!

- If default is selected, step 2 can be skipped.

3. After Washing

"End" on display.

■ Before Each Washing

- The working condition of the washer should be (0-40) °C. If used under 0 °C, the inlet valve and draining system may be damaged. If the machine is placed under condition of 0 °C or less, then it should be transferred to normal ambient temperature to ensure the water supply hose and drain hose are not frozen before use.
- Please check the labels and the explanation of using detergent before wash. Use non-foaming or less-foaming detergent suitable for machine washing properly.

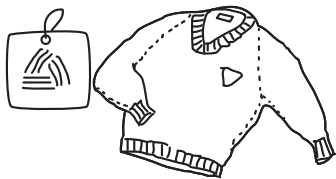

Check the label

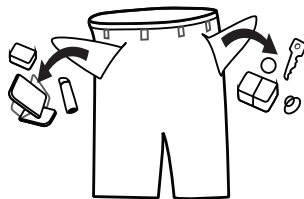

Take out the items out of the pockets

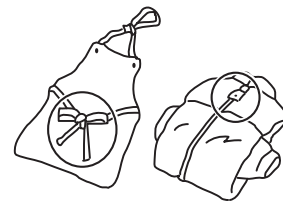

Knot the long strips, zip or button

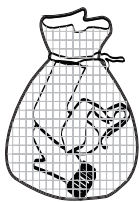

Put small clothes into the pillow slip

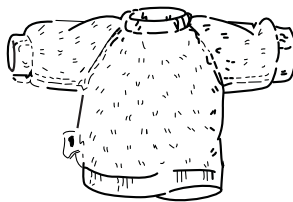

Turn easy-pilling and long-pile fabric inside out

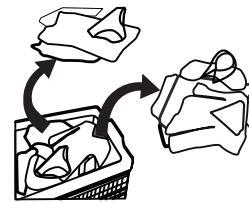

Separate clothes with different textures

Warning!

- When washing a single clothes, it may easily cause great eccentricity and give alarm due to great unbalance. Therefore it is suggested to add one or two more clothes to be washed together so that draining can be done smoothly.
- Don't washing the clothes touching with kerosene, gasoline, alcohol and other flammable materials.

■ Detergent Dispenser

- I Pre Wash detergent
- II Main Wash detergent
- ☼ Softener

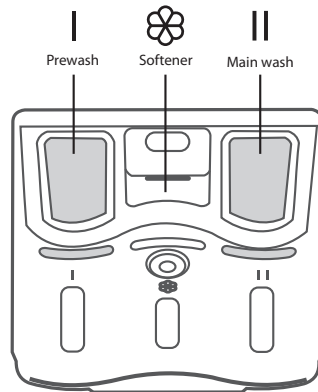

Pull out the dispenser

! Caution!

- Detergent only need to be added in "case I" after selecting pre-washing for machines with this function.
- Do not exceed the "MAX" level mark when filling in detergent, additives or softener.

Programme	I	II	☼
Cotton	<input type="radio"/>	<input checked="" type="radio"/>	<input type="radio"/>
Synthetic	<input type="radio"/>	<input checked="" type="radio"/>	<input type="radio"/>
Mix	<input type="radio"/>	<input checked="" type="radio"/>	<input type="radio"/>
Jeans	<input type="radio"/>	<input checked="" type="radio"/>	<input type="radio"/>
Sportswear	<input type="radio"/>	<input checked="" type="radio"/>	<input type="radio"/>
Baby Care	<input type="radio"/>	<input checked="" type="radio"/>	<input type="radio"/>
Drum Clean			
20 °C		<input checked="" type="radio"/>	<input type="radio"/>

Programme	I	II	☼
Spin Only			
Rinse & Spin			<input type="radio"/>
Wool		<input checked="" type="radio"/>	<input type="radio"/>
Delicate		<input checked="" type="radio"/>	<input type="radio"/>
Rapid 45'	<input type="radio"/>	<input checked="" type="radio"/>	<input type="radio"/>
Quick 15'		<input checked="" type="radio"/>	<input type="radio"/>
ECO 40-60		<input checked="" type="radio"/>	<input type="radio"/>
Intensive		<input checked="" type="radio"/>	<input type="radio"/>

● Means must ○ Means optional

📌 Note!

- As for the agglomerated or ropy detergent or additive, before they are poured into the detergent box, it is suggested to use some water for dilution to prevent the inlet of detergent box from being blocked and overflowing while filling water.
- Please choose suitable type of detergent for the various washing temperature to get the best washing performance with less water and energy consumption.

Control Panel (PLD 126 D QTL)

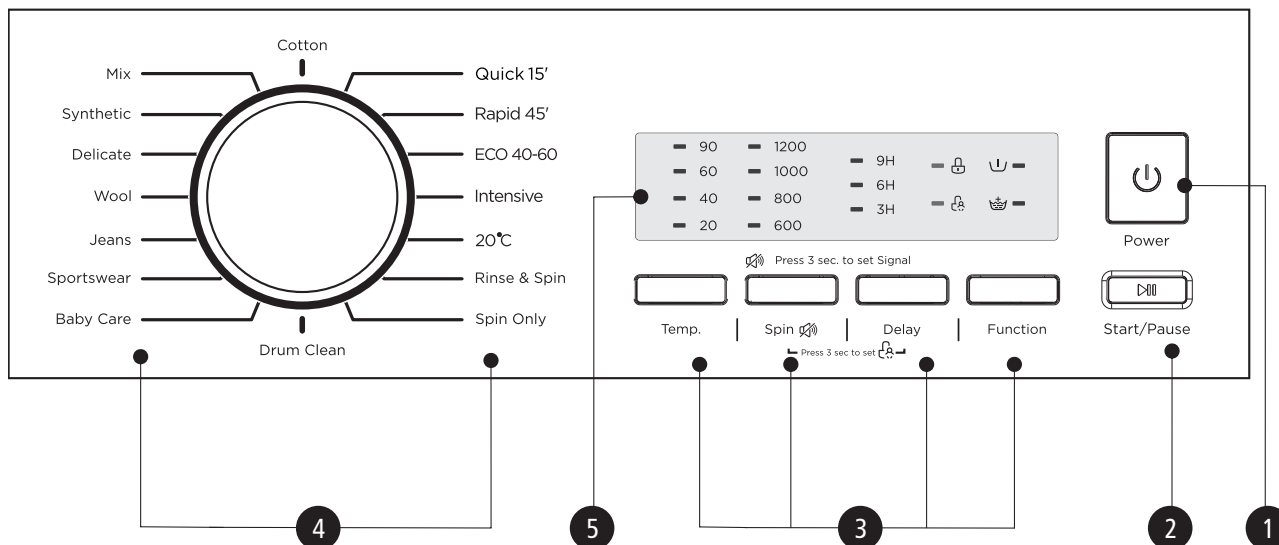

Note!

- The chart is for reference only, Please refer to real product as standard.

1 Off

Product is switched On/Off.

2 Start/Pause

Press the button to start or pause the washing cycle.

3 Option

This allows you to select an additional function and will light when selected.

4 Programmes

Available according to the laundry type.

5 Display

The display shows the settings, options for your washer. The display will remain on through the cycle.

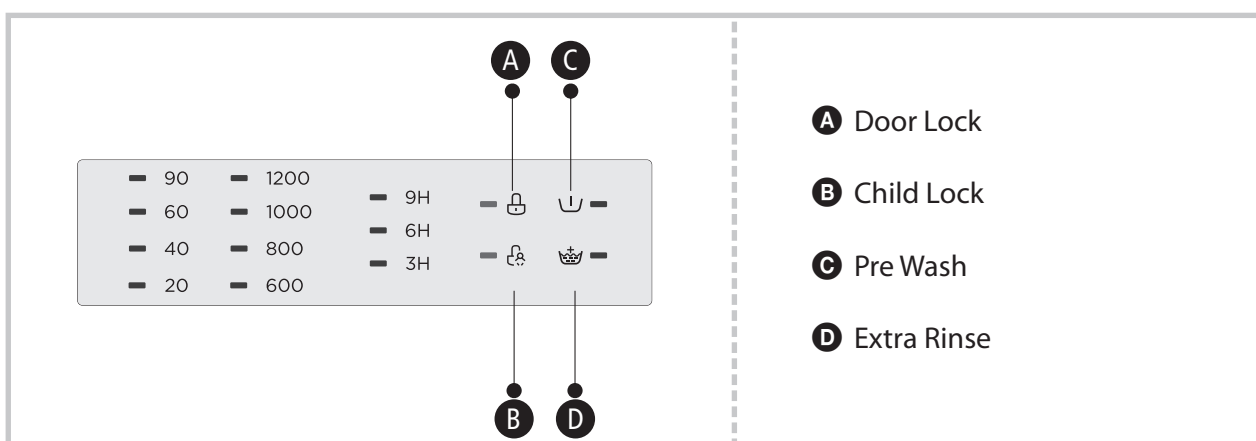

A Door Lock

B Child Lock

C Pre Wash

D Extra Rinse

■ Option

Pre Wash	Pre Wash The Prewash function can get an extra wash before main wash, it is suitable for washing the dust rises to surface of the clothes; You need to put detergent into the Case (I) when select it.
----------	--

Extra Rinse	Extra Rinse The laundry will undergo extra rinse once after you select it.
-------------	--

Delay	Delay Set the Delay function: 1. Select a programme. 2. Press the Delay button to choose the time (the delaying time is 0-24 H/3H-6H-9H). 3. Press [Start/Pause] to commence the delay operation.
-------	--

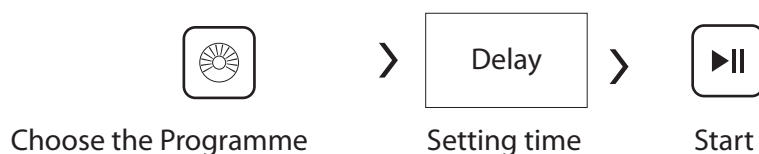

Cancel the Delay function:

Press the [Delay] button until the display be 0H. It should be pressed before starting the programme. If the programme already started, should switch off programme to reset a new one.

⚠ Caution!

- If there is any break in the power supply while the machine is operating, a special memory stores the selected programme and when the power is restarted, the program will continue.

Programme	Option		
	Delay	Extra Rinse	Pre Wash
Cotton	<input type="radio"/>	<input type="radio"/>	<input type="radio"/>
Quick 15'	<input type="radio"/>		
Rapid 45'	<input type="radio"/>	<input type="radio"/>	<input type="radio"/>
ECO 40-60	<input type="radio"/>		
Intensive	<input type="radio"/>		
20 °C	<input type="radio"/>	<input type="radio"/>	
Rinse & Spin	<input type="radio"/>	<input type="radio"/>	
Spin Only	<input type="radio"/>		

Programme	Option		
	Delay	Extra Rinse	Pre Wash
Drum Clean	<input type="radio"/>		
Baby Care	<input type="radio"/>	<input type="radio"/>	<input type="radio"/>
Sportswear	<input type="radio"/>	<input type="radio"/>	<input type="radio"/>
Jeans	<input type="radio"/>	<input type="radio"/>	<input type="radio"/>
Wool	<input type="radio"/>	<input type="radio"/>	
Delicate	<input type="radio"/>	<input type="radio"/>	
Synthetic	<input type="radio"/>	<input type="radio"/>	<input type="radio"/>
Mix	<input type="radio"/>	<input type="radio"/>	<input type="radio"/>

○ Means optional (Some models have intelligent weighing function, please refer to the actual product)

■ Other Functions

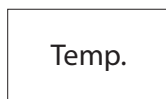

Temp.

Press the button to regulate the temperature (Cold, 20 °C, 40 °C, 60 °C, 90 °C).



Spin

Press the button to change the speed.

1200: 0-600-800-1000-1200

Programme	Default Speed (rpm)	Programme	Default Speed (rpm)
	1200		1200
Cotton	1200	Drum Clean	-
Quick 15'	800	Baby Care	800
Rapid 45'	800	Sportswear	800
ECO 40-60	1200	Jeans	800
Intensive	800	Wool	600
20 °C	1000	Delicate	600
Rinse & Spin	800	Synthetic	1200
Spin Only	800	Mix	800



Child Lock

To avoid mis operation by children.



Choose the Programme



Start



Press [Spin] and [Delay] 3 sec.
till buzzer beep.

⚠ Caution!

- During the "Child Lock" function is activating, the buzzer will beep 3 times. When the buttons are pressed.
- Press the two button 3sec. also to be released the function.
- The "Child Lock" will lock all buttons except Power button.
- Cut off the power supply, the kid's protection is to be released.



Mute the buzzer



Choose the Programme

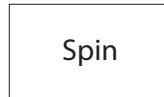

Spin



Press the [Spin] button for 3sec., the buzzer is mute.

To act the buzzer function, press the button again for 3 seconds. The setting will be kept until the next reset.



Caution!

- After Muting the buzzer function, the sounds will not be activated any more.



My Cycle

To memory the frequently used programme.

After choosing the programme and setting the options, press [Temp.] 3 sec. before start to wash.

The default setting course is Cotton.

■ Programmes

Programmes are available according to the laundry type.

Programmes	
Cotton	Hard-wearing textiles, heat-resistant textiles made of cotton or linen.
Synthetic	Wash synthetic articles, for example: shirts, coats, blending. While washing the knitting textiles, detergent quantity shall be reduced due to its loose string construction and easily forming bubbles.
Baby Care	Washing the baby's clothes, it can make the baby's wear cleaner and make the rinse performance better to protect the baby skin.
Rapid 45'	Washing few and not very dirty clothes quickly.
Mix	Mixed load consisting of textiles made of cotton and synthetics.
Sportswear	Washing the activewear.
Jeans	Specially for jeans.
Quick 15'	Extra short programme approx, suitable for lightly soiled washing as a small amounts of laundry.
Delicate	For delicate, washable textiles, e.g. made of silk, satin, synthetic fibres or blended fabrics.
Wool	Hand or machine-washable wool or richwool textiles. Especially gentle wash programme to prevent shrinkage, longer programme pauses (textiles rest in wash liquor).
Spin Only	Extra spin with selectable spin speed.
Rinse&Spin	Extra rinse with spin.
Drum Clean	Specially set in this machine to clean the drum and tube. It applies 90 °C high temperature sterilization to make the clothes washing more green. When this programme is performed, the clothes or other washing cannot be added. When proper amount of chlorine bleaching agent is put in, the barrel cleaning effect will be better. The customer can use this programme regularly according to the need.
ECO 40-60	Default 40 °C, not selectable, suitable for laundry washing at about 40 °C - 60 °C.
Intensive	To increase the washing effects, washing time is increased.
20 °C	Washing brightly colored clothes, it can protect the colors better.

■ Washing Programmes Table

Model: PLD 126 D QTL

Programme	Load (kg)	Temp. (°C)	Default Time
Cotton	6.0	40	2:40
Quick 15'	2.0	Cold	0:15
Rapid 45'	2.5	40	0:45
ECO 40-60	6.0	--	3:16
Intensive	6.0	40	3:48
20 °C	3.0	20	1:01
Rinse & Spin	6.0	--	0:20
Spin Only	6.0	--	0:12
Drum Clean	-	90	1:18
Baby Care	6.0	60	1:42
Sportswear	3.0	40	1:31
Jeans	6.0	60	1:45
Wool	2.0	40	1:07
Delicate	2.0	20	0:49
Synthetic	3.0	40	2:20
Mix	6.0	40	1:37

- Concerning to EN 60456:2016 With (EU)No.1061/2010,
The EU energy efficiency class is: A+++
Energy test program: Intensive 60/40 °C; Speed: The highest speed;
Other as the default.
Half load for 6.0/6.5Kg machine:3.0/3.25Kg.
- Concerning to EN 60456:2016/prA2019 With (EU)2019/2014, (EU)2019/2023,
The EU energy efficiency class is: D
Energy test program: ECO 40-60. Other as the default.
Half load for 6.0/6.5Kg machine:3.0/3.25Kg.
Quarter load for 6.0/6.5Kg machine:1.5/1.5Kg.

Note!

- The parameters in this table are only for user's reference. The actual parameters maybe different with the parameters in above mentioned table.

PART 4: MAINTENANCES

■ Cleaning And Care

Warning!

- Before your maintenance starts, please unplug the machine and close the tap.

Cleaning The Cabinet

Proper maintenance on the washing machine can extend its working life. The surface can be cleaned with diluted non-abrasive neutral detergents when necessary. If there is any water overflow, use the wet cloth to wipe it off immediately. No sharp items are allowed.

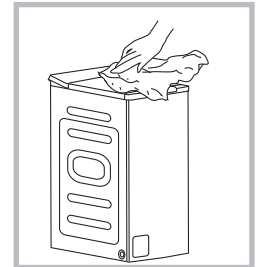

Note!

- Formic acid and its diluted solvents or equivalent are forbidden, such as alcohol, solvents or chemical products, etc.

Cleaning The Drum

The rusts left inside the drum by the metal articles shall be removed immediately with chlorine-free detergents.

Never use steel wool.

Note!

- Don't put laundry in the washing machine during the drum cleaning.

■ Cleaning The Inlet Filter

Note!

- Inlet filter must be cleaned if there is less water.

Washing the filter in the tap

1. Close the tap.
2. Remove the water supply hose from the tap.
3. Clean the filter.
4. Reconnect the water supply hose.

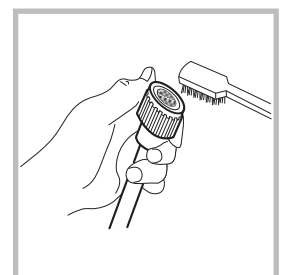
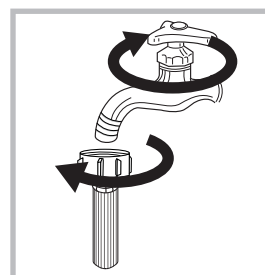

Washing the filter in washing machine:

1. Screw off the inlet pipe from the backside of the machine.
2. Pull out the filter with long nose pliers and reinstall it back after being washed.
3. Use the brush to clean the filter.
4. Reconnect the inlet pipe.

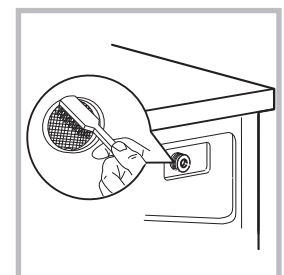
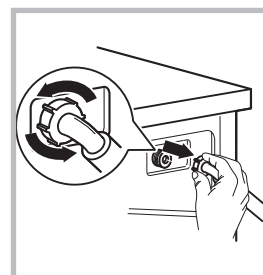

Note!

- If the brush is not clean, you can pull out the filter washed separately;
- Reconnect, turn on the tap.

Clean The Detergent Dispenser

1. Press down the arrow location on softener cover inside the dispenser drawer.
2. Lift the clip up and take out softener cover and wash all grooves with water.
3. Restore the softener cover and push the drawer onto position.

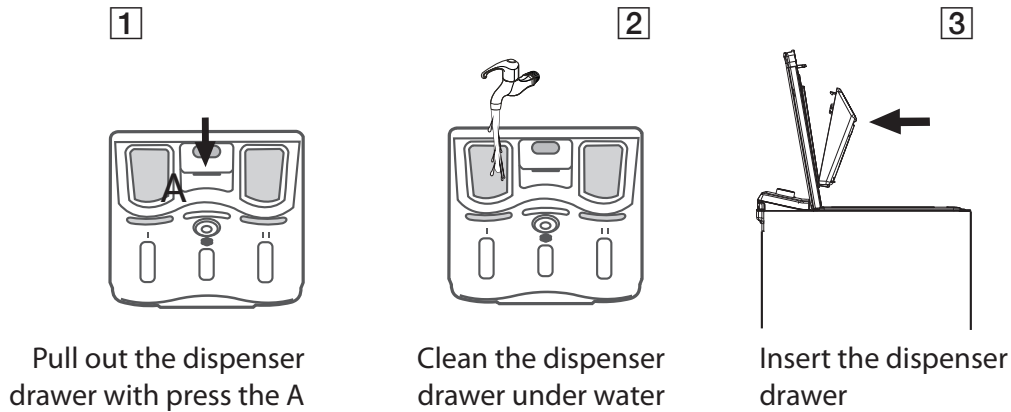

Note!

- Do not use alcohol, solvents or chemical products to clean the machine.

■ Cleaning The Drain Pump Filter

Warning!

- Be careful of the hot water!
- Allow detergent solution to cool down.
- Unplug the machine to avoid electrical shock before washing.
- Drain pump filter can filter the yarns and small foreign matters from the washing.
- Clean the filter periodically to ensure the normal operation of washing machine.

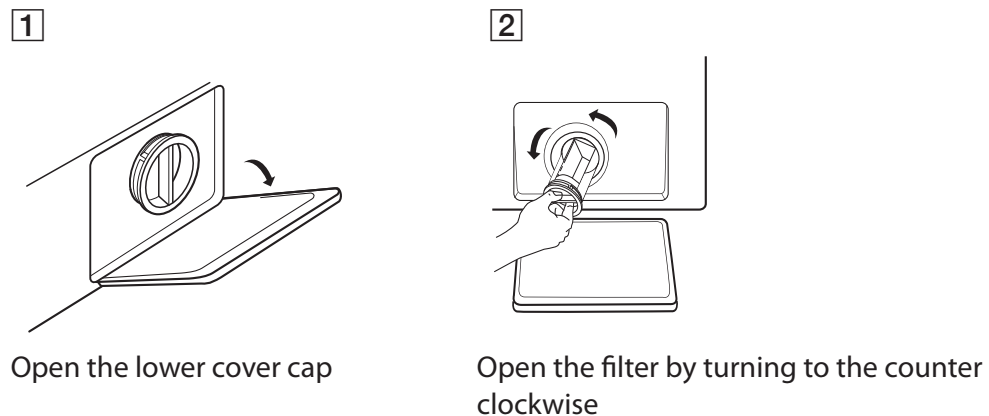

3

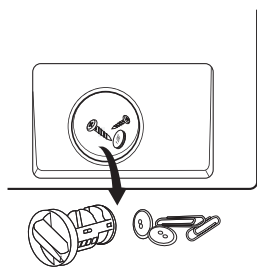

Remove extraneous matter

4

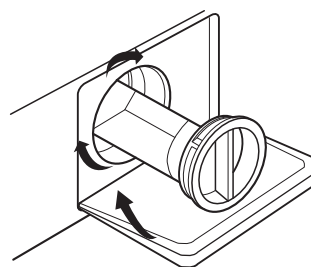

Close the lower cover cap

! Caution!

- Make sure that valve cap and emergency drain hose are reinstalled properly, cap plates should be inserted aligning to hole plates otherwise water may leak.
- When the appliance is in use and depending on the programme selected there can be hot water in the pump. Never remove the pump cover during a wash cycle, always wait until the appliance has finished the cycle, and is empty. When replacing the cover, ensure it is securely re-tightened.

■ Trouble Shooting

The start of the appliance does not work or it stops during operation.
First try to find a solution to the problem, If not, contact the service centre.

Description	Reason	Solution
Washing machine cannot start up.	Door is not closed properly.	Restart after the door is closed. Check if the clothes is stuck.
Door can't be opened.	Washer's safety protection design is working.	Disconnect the power, restart the product.
Water leakage.	The connection between inlet pipe or outlet hose is not tight.	Check and fasten water pipes. Clean up outlet hose.
Detergent residues in the box.	Detergent is dampened or agglomerated.	Clean and wipe the detergent box.
Indicator or display does not light.	Disconnect the power. PC board or harness has connection problem.	Check if the power is shut down and the power plug is connected correctly.
Abnormal noise.		Check if the fixing (bolts) have been removed. Check it's installed on a solid and level floor.

LED display models:

Description			Reason	Solution
Temp.	Speed	Delay	Door is not closed properly.	Restart after the door is closed. Check if the clothes is stuck.
●	●	○		
●	●	○		
○	●	○		
○	●	○		
Temp.	Speed	Delay	Water injecting problem while washing.	Check if the water pressure is too low. Straighten the water pipe. Check if the inlet valve filter is blocked.
●	●	○		
●	●	○		
●	●	○		
○	●	○		
Temp.	Speed	Delay	Overtime water draining.	Check if the drain hose is blocked.
●	●	○		
●	●	○		
○	●	○		
●	○	○		
Temp.	Speed	Delay	Water overflow.	Restart the washer.
●	●	○		
●	●	○		
●	○	○		
○	●	○		
Others			Others	Please try again first, call up service line if there are still troubles.

Note!

- After the check, activate the appliance. If the problem occurs or the display shows other alarm codes again, contact the service.

■ Technical Specifications

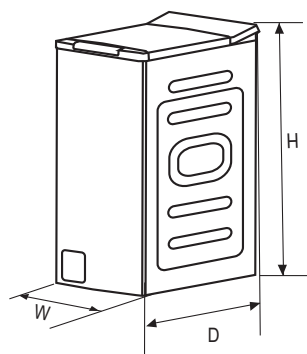

Power Supply	220 - 240 V ~, 50Hz			
MAX. Current	10 A			
Standard Water Pressure	0.1 MPa - 1MPa			
Model	Washing Capacity	Dimension (W/D/H) mm	Net Weight	Rated Power
PLD 126 D QTL	6.0kg	400/610/875	56kg	2100W

PART 5: PRODUCT INFORMATION SHEET

Product Information Sheet

PHILCO 

COMMISSION DELEGATED REGULATION (EU) 2019/2016

Supplier's name or trademark: PHILCO

Supplier's address: U Sanitasu 1621, Říčany 251 01, Czech Republic

Model identifier: PLD 126 D QTL

General product parameters: Top loader washmachine

Parameter	Value		Parameter	Value	
Rated capacity (kg)	6		Dimensions in cm	Height	87
				Width	40
				Depth	61
EEI _w	80		Energy efficiency class*	D	
Washing efficiency index	1.04		Rinsing effectiveness (g/kg)	5	
Energy consumption in kWh per cycle, based on the eco 40-60 programme. Actual energy consumption will depend on how the appliance is used.	-		Water consumption in litre per cycle, based on the eco 40-60 programme. Actual water consumption will depend on how the appliance is used and on the hardness of the water.	43	
Maximum temperature inside the treated textile (°C)	Rated capacity	34	Remaining moisture content (%)	Rated capacity	62
	Half	31		Half	62
	Quarter	23		Quarter	62
Spin speed (rpm)	Rated capacity	1200	Spin-drying efficiency class	C	
	Half	1200			
	Quarter	1200			
Programme duration (h:min)	Rated capacity	3:18	Type	Free-standing	
	Half	2:36			
	Quarter	2:36			
Airborne acoustical noise emissions in the spinning phase (dB(A) re 1 pW)	80		Airborne acoustical noise emission class (spinning phase)	C	

Off-mode (W)	0.5	Standby mode (W)	-
Delay start (W) (if applicable)	4	Networked standby (W) (if applicable)	-
Minimum duration of the guarantee offered by the supplier: 24 months			
This product has been designed to release silver ions during the washing cycle		No	
Additional information:			
Weblink to the supplier's website, where the information in point 9 of Annex II to Commission Regulation (EU) 2019/2023 is found: www.philco.cz			

* A (highest efficiency) to G (lowest efficiency)

TECHNICAL INFORMATION

Technical information can be found on the type plate on the inside of the appliance and on the energy label. The QR code, on the supplied energy label, contains a link to register the appliance in the EU Eprel database. Keep the energy label, the instructions for use, together with other documents supplied with the device.

TESTING INFORMATION

The delivered device is in accordance with EcoDesign and EN60456:2016+A11:2020, CLC/TS 50707:2020, CLC/TS 50677:2019, EN50564:2011, EN60704-1:2010+A11:2012, EN60704-2-4:2012+A11:2020, EN60704-3:2019. Air access requirements for proper operation of the device, the minimum distance from the wall and the dimensions of the device are part of this manual. If you have any further questions, please contact the manufacturer.

CUSTOMER CARE AND SERVICE

Always use original spare parts.

Model name and serial number can be found on the rating plate. Position of rating plate can be changed without notice.

The original spare parts for some specific components are available for a minimum of 7 or 10 years, based on the type of component, from the placing on the market of the last unit of the model.

When contacting our authorized service, have the model designation, serial number and defect description available.

To download documents, visit www.philco.cz.

To report a defect and obtain additional service information, visit <https://philco.cz/podpora-a-servis>.

Subject to change without notice.

INSTRUCTIONS AND INFORMATION REGARDING THE DISPOSAL OF USED PACKAGING MATERIALS

Dispose of packaging material at a public waste disposal site.

DISPOSAL OF USED ELECTRICAL AND ELECTRONIC APPLIANCES



The meaning of the symbol on the product, its accessory or packaging indicates that this product shall not be treated as household waste. Please, dispose of this product at your applicable collection point for the recycling of electrical & electronic equipment waste. Alternatively in some states of the European Union or other European states you may return your products to your local retailer when buying an equivalent new product. The correct disposal of this product will help save valuable natural resources and help in preventing the potential negative impact on the environment and human health, which could be caused as a result of improper liquidation of waste. Please ask your local authorities or the nearest waste collection centre for further details. The improper disposal of this type of waste may fall subject to national regulations for fines.

For business entities in the European Union

If you wish to dispose of an electrical or electronic device, request the necessary information from your seller or supplier.

Disposal in other countries outside the European Union

If you wish to dispose of this product, request the necessary information about the correct disposal method from local government departments or from your seller.



This product meets all the basic EU regulation requirements that relate to it.

Changes to the text, design and technical specifications may occur without prior notice and we reserve the right to make these changes.

Original of this user manual is in czech language.

Výrobce/Manufacturer:
Fast ČR, a.s.
U Sanitasu 1621
Říčany 251 01, CZECH REPUBLIC

Importer to SK:
FAST PLUS, a.s.
Na pántoch 18, 831 06 Bratislava
SLOVAKIA

PHILCO[®] 

is a pending or registered trademark of Electrolux Home Products, Inc. and used under a license from Electrolux Home Products, Inc.