

Washer Dryer

OWNER'S MANUAL

PHILCO



Famous for Quality the World Over

PLWDI 1486 BBI

**Dear customer,
Thank you for buying a PHILCO brand product. So that your appliance serves you well, please read all the instructions in this user's manual.**

CONTENTS

PART 1: SAFETY INSTRUCTIONS	2
PART 2: INSTALLATION.....	9
PRODUCT DESCRIPTION	9
INSTALLATION	10
PART 3: OPERATIONS.....	13
QUICK START	13
BEFORE EACH WASHING	14
DETERGENT DISPENSER	15
DETERGENT RECOMMENDATION.....	16
CONTROL PANEL	17
PROGRAMMES.....	18
OPTION.....	22
PART 4: MAINTENANCE	25
CLEANING AND CARE.....	25
CLEANING THE INLET FILTER	26
CLEANING THE DRAIN PUMP FILTER.....	27
TROUBLE SHOOTING	28
CUSTOMER SERVICE.....	29
TECHNICAL SPECIFICATIONS	29
BUILT-IN INSTALLATION.....	30



CAUTION: HOT SURFACE !



CAUTION: RISK OF FIRE !

PART 1: SAFETY INSTRUCTIONS

THIS APPLIANCE CAN BE USED BY CHILDREN AGED FROM 8 YEARS AND ABOVE AND BY PERSONS WITH REDUCED PHYSICAL, SENSORY OR MENTAL CAPABILITIES OR LACK OF EXPERIENCE AND KNOWLEDGE IF THEY HAVE BEEN GIVEN SUPERVISION OR INSTRUCTIONS CONCERNING USE OF THE APPLIANCE IN A SAFE WAY AND IF THEY UNDERSTAND THE HAZARDS INVOLVED.

CHILDREN MUST NOT PLAY WITH THE APPLIANCE.

CHILDREN YOUNGER THAN 3 YEARS OF AGE SHOULD BE PREVENTED FROM ACCESSING UNLESS THEY ARE UNDER PERMANENT SUPERVISION.

CLEANING AND USER MAINTENANCE CANNOT BE PERFORMED BY CHILDREN WITHOUT SUPERVISION.

IF THE SUPPLY CABLE GETS DAMAGED, HAVE IT REPLACED BY A SPECIALIZED SERVICE CENTRE IN ORDER TO AVOID DANGEROUS SITUATIONS. IT IS PROHIBITED TO USE AN APPLIANCE WITH THE SUPPLY CABLE DAMAGED.

THIS APPLIANCE IS INTENDED TO BE USED ONLY IN HOUSEHOLDS AND NOT IN SIMILAR PREMISES, SUCH AS:

- KITCHENETTES IN SHOPS, OFFICES AND OTHER WORKPLACES;
- APPLIANCES USED APPLIANCES USED BY GUESTS IN HOTELS, MOTELS, AND OTHER ACCOMMODATION FACILITIES;
- APPLIANCES USED IN BED AND BREAKFAST FACILITIES;
- APPLIANCES USED IN CATERING AND OTHER SIMILAR NON-VENDING ENVIRONMENTS

- THE APPLIANCE MUST NOT BE USED WITH MORE DRY LAUNDRY THAN STATED IN THE MACHINE SPECIFICATIONS, SEE INFORMATION SHEET.
- THE DRYER MUST NOT BE USED IF INDUSTRIAL CHEMICALS WERE INVOLVED IN CLEANING.
- MAKE SURE THAT FLUFF DOES NOT ACCUMULATE AROUND THE MACHINE.
- DO NOT DRY UNWASHED PIECES OF CLOTHING IN THE DRUM DRYER.
- PIECES OF CLOTHING STAINED WITH SUCH SUBSTANCES AS EDIBLE OIL, ACETONE, ALCOHOL, PETROL, PARAFFIN, STAIN REMOVERS, TURPENTINE, WAXES OR WAX REMOVERS SHOULD BE WASHED IN HOT WATER WITH AN EXTRA DOSE OF DETERGENT BEFORE THEY ARE DRIED IN A DRUM DRYER.
- PIECES OF CLOTHING SUCH AS FOAM RUBBER (FOAM LATEX), BATHING CAPS, WATERPROOF TEXTILES, RUBBER-COATED ELEMENTS AND CLOTHING OR PILLOWS FILLED WITH FOAM RUBBER SHOULD NOT BE DRIED IN A DRUM DRYER.
- SOFTENERS AND SIMILAR PRODUCTS SHOULD BE USED ACCORDING TO THEIR INSTRUCTIONS FOR USE.
- THE FINAL PHASE OF THE DRUM DRYER CYCLE WILL BE PERFORMED WITHOUT HEATING (COOLING CYCLE) TO ENSURE THAT THE CLOTHING PIECES WILL ACHIEVE SUCH TEMPERATURE THAT WILL PREVENT THEM FROM GETTING DAMAGED.
- REMOVE ALL ITEMS SUCH AS LIGHTERS AND MATCHES FROM POCKETS.



NEVER TURN THE DRUM DRYER OFF BEFORE THE DRYING CYCLE IS COMPLETED UNLESS ALL ITEMS ARE REMOVED AND SPREAD OUT QUICKLY AFTERWARDS SO THAT THE HEAT CAN DISSIPATE.

– THE APPLIANCE MUST NOT BE INSTALLED BEHIND LOCKABLE DOOR, SLIDING DOOR OR DOOR WITH HINGES AT THE OPPOSITE SIDE FROM THE DRUM DRYER IF SUCH INSTALLATION WOULD PREVENT THE DRUM DRYER DOOR FROM OPENING FULLY.



THE APPLIANCE MUST NOT BE POWERED FROM AN EXTERNAL SWITCHING DEVICE SUCH AS TIMER SWITCH OR BE CONNECTED TO A CIRCUIT THAT IS REGULARLY SWITCHED ON AND OFF.

THIS APPLIANCE IS INTENDED FOR WASHING AND DRYING FABRICS FOR WHICH THE MANUFACTURER HAS RECOMMENDED SUCH TREATMENT.

ALWAYS USE PROGRAMMES ACCORDING TO THE FABRIC TYPE.

THE WASHING MACHINE COULD GET DAMAGED WHEN WASHING OR DRYING SHOES.

DO NOT USE TO WASH CARPETS.

USE ONLY DETERGENTS THAT ARE INTENDED FOR WASHING OR DRYING CLOTHES IN AN AUTOMATIC DRUM WASHING MACHINE.



- IF THE SUPPLY CORD GETS DAMAGED, IT MUST BE REPLACED BY THE MANUFACTURER, ITS SERVICE AGENT OR A SIMILARLY QUALIFIED PERSON.
- THE APPLIANCE SHOULD BE CONNECTED TO THE WATER SUPPLY AND DRAIN USING NEW HOSES, NOT USING HOSES THAT HAVE ALREADY BEEN USED.
- ALWAYS DISCONNECT THE APPLIANCE FROM THE MAINS BEFORE PERFORMING ANY MAINTENANCE.
- THE POWER CORD PLUG MUST BE CONNECTED TO A GROUNDED THREE-POLE ELECTRIC OUTLET.
- NEVER USE A POWER OUTLET WITH A RATED VOLTAGE THAT IS DIFFERENT FROM THE APPLIANCE'S VOLTAGE.
- DO NOT USE EXTENSION CORD TO CONNECT THE MACHINE TO THE POWER OUTLET.
- THE APPLIANCE, THE POWER CORD OR THE ELECTRIC OUTLET MUST NOT LIE IN, TOUCH OR BE SUBMERGED IN WATER OR ANY OTHER LIQUID TO AVOID ELECTRICAL HAZARDS.
- THE APPLIANCE MUST NOT STAND ON THE POWER CORD.
- THE POWER CORD MUST NOT BE EXCESSIVELY OR DANGEROUSLY BENT OR COMPRESSED DURING INSTALLATION OR OPERATION.
- THE CONTROLS AND DOOR OF THE APPLIANCE ARE NOT TO BE PLAYED WITH.
- THE GLASS DOOR OF THE APPLIANCE CAN GET HOT DURING OPERATION.
- DO NOT DRY UNWASHED PIECES OF CLOTHING IN THE DRYER.

APPLIANCE INSTALLATION

- THIS APPLIANCE IS INTENDED FOR INTERIOR USE ONLY.
- THE ELECTRIC OUTLET THAT THE POWER CORD IS CONNECTED TO MUST BE EASILY ACCESSIBLE AFTER THE APPLIANCE HAS BEEN INSTALLED.
- REMOVE ALL PACKAGING MATERIALS AND SAFETY TRANSPORT BOLTS BEFORE USING THE APPLIANCE. OTHERWISE THE APPLIANCE OR ITS SURROUNDINGS MIGHT GET SERIOUSLY DAMAGED.
- THE APPLIANCE, THE POWER CORD OR THE ELECTRIC OUTLET MUST NOT LIE IN, TOUCH OR BE SUBMERGED IN WATER OR ANY OTHER LIQUID TO AVOID ELECTRICAL HAZARDS.
- THE PACKAGING MATERIALS MUST BE DISPOSED OF IN A PROPER MANNER.
- DO NOT LIFT OR HANDLE THE APPLIANCE WHEN HOLDING ITS DOOR, CONTROLS, THE UPPER BOARD, HOSES OR POWER CORD.
- THE APPLIANCE MUST BE INSTALLED ONTO A FIRM AND EVEN SURFACE.
- AFTER YOU PLACE THE APPLIANCE, MAKE SURE IT IS LEVEL IN ALL DIRECTIONS USING A SPIRIT LEVEL.
- THE APPLIANCE MUST NOT BE INSTALLED BEHIND LOCKABLE DOOR, SLIDING DOOR OR DOOR WITH HINGES AT THE OPPOSITE SIDE FROM THE DRUM DRYER IF SUCH INSTALLATION WOULD PREVENT THE DRUM DRYER DOOR FROM OPENING FULLY.



THE APPLIANCE MUST NOT BE POWERED FROM AN EXTERNAL SWITCHING DEVICE SUCH AS TIMER SWITCH OR BE CONNECTED TO A CIRCUIT THAT IS REGULARLY SWITCHED ON AND OFF.

PLEASE READ THOSE SAFETY PRECAUTIONS CAREFULLY AND STORE THEM FOR FUTURE REFERENCE.

■ Safety Instructions

For your safety, the information in this manual must be followed to minimize the risk of fire or explosion, electric shock, or to prevent property damage, personal injury or loss of life.

Explanation of the symbols:

Warning!

This combination of symbol and signal word indicates a potentially dangerous situation which may result in death or serious injuries unless it's avoided.

Caution!

This combination of symbol and signal word indicates a potentially dangerous situation which may result in slight or minor injuries or damage to property and the environment.

Note!

This combination of symbol and signal word indicates a potentially dangerous situation which may result in slight or minor injuries.

Packaging/Old appliance



This marking indicates that this product should not be disposed with other household wastes throughout the EU. To prevent possible harm to the environment or human health from uncontrolled waste disposal, recycle it responsibly to promote the sustainable reuse of material resources. To return your used device, please use the collection systems or contact the retailer where the product was purchased. They return and can take this product for environmental safe recycling.

PART 2: INSTALLATION

■ Product Description

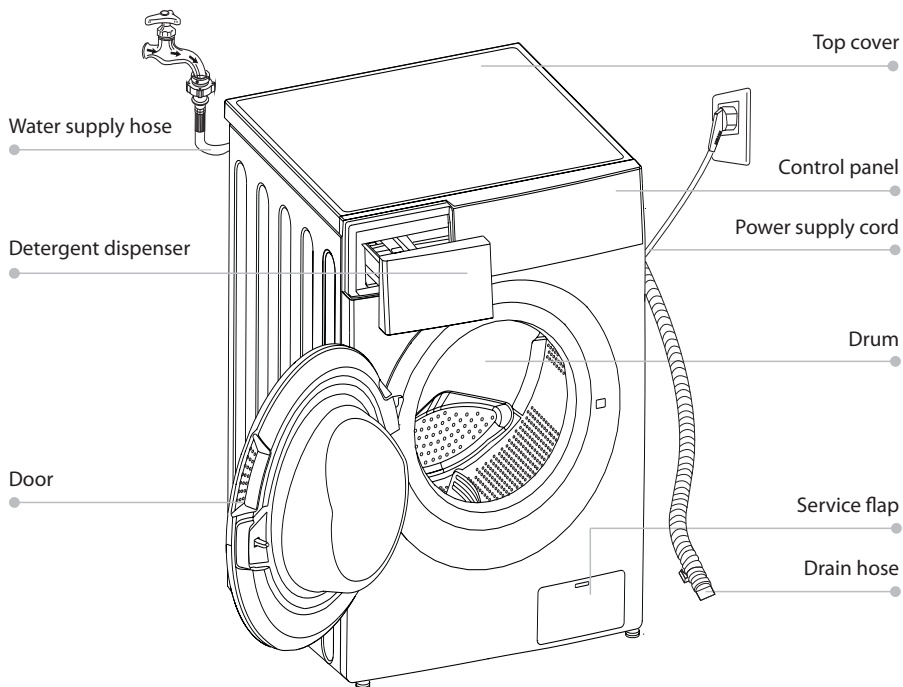

Note!

- The product picture is for illustration only, please refer to real product as reference.

Accessories

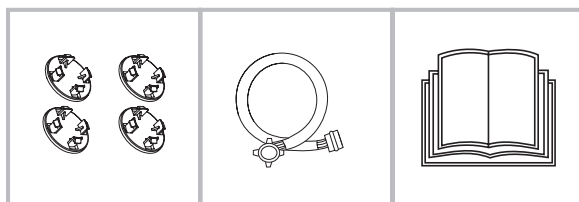

4 x Cover caps

1 x Supply hose
cold water

1 x Owner's
manual

■ Installation

Installation area

Warning!

- Stability is important to prevent the product from wandering! Make sure the machine is standing leveled and stable.
- Make sure that the product does not stand onto the power cord.
- Make sure to maintain the minimum distances from the walls as shown in the picture

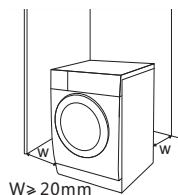

Before installing the machine, the location characterized follows shall be selected:

1. Rigid, dry, and level surface
2. Avoid direct sunlight
3. Sufficient ventilation
4. Room temperature is above 0 °C
5. Keep far away from the heat resources such as coal or gas.



Unpacking the washing machine

Warning!

- Packaging material (e.g. Films, Styrofoam) can be dangerous for children.
- There is a risk of suffocation ! Keep all packaging well away from children.

1. Remove the cardboard box and styrofoam packing.
2. Lift the washer dryer and remove the base packing. Make sure the small triangle foam is removed with the bottom one together. If not, lay the unit down with side surface, then remove the small foam from the unit bottom manually.
3. Remove the tape securing the power supply cord and drain hose.
4. Remove the inlet hose from the drum.

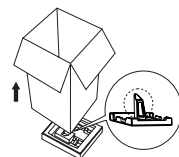

Remove transport bolts

Warning!

- You must remove the transport bolts from the backside before using the product.



Loosen the 4 transport bolts with a spanner.

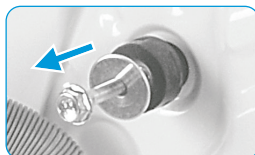

Remove the bolts including the rubber parts and keep them for future use.

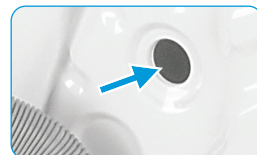

Close the holes using the cover caps.

Levelling the washer dryer

Warning!

- The lock nuts on all four feet must be screwed tightly against the housing.
1. Loosen the lock nut.
 2. Turn the foot until it reaches the floor.
 3. Adjust the legs and lock the nuts with a spanner. Make sure the machine is level and steady.

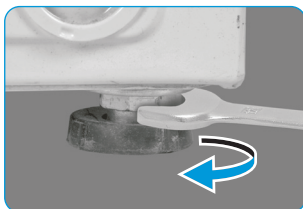

Connect Water Supply Hose

Warning!

To prevent leakage or water damage, follow the instructions in this chapter

- Do not kink, crush or modify water inlet hose.



Connect the water supply hose to the water inlet valve and a water tap with cold water as indicated.



Note!

- Connect manually, do not use tools. Check if the connections are tight.

Drain Hose

Warning!

- Do not kink or protract the drain hose.
- Position drain hose properly ,otherwise damage might result of water leakage.

There are two ways to place the end of drain hose:

1. Put it into the water trough.

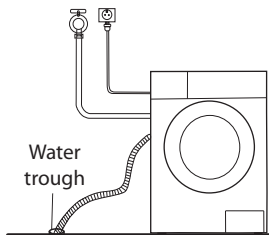

2. Connect it to the branch drain pipe of the trough.

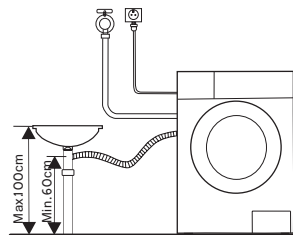

PART 3: OPERATIONS

■ Quick Start

⚠ Caution!

- Before washing, please make sure it's installed properly.
- Your appliance was thoroughly checked before it left the factory. To remove any residual water and to neutralize potential odors, it's recommended to clean your appliance before first use. For this reason, start the Cotton program at 90°C without laundry and detergent.

1. Before Washing

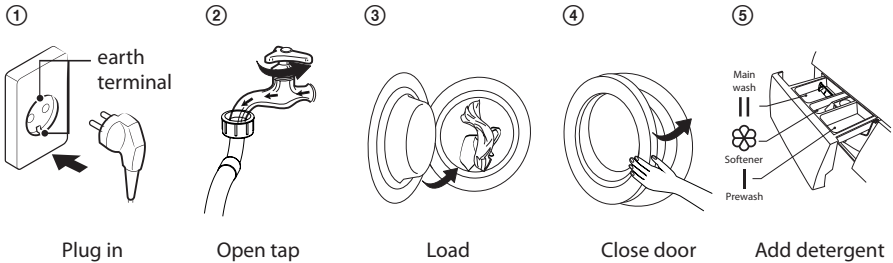

📌 Note!

- Detergent need to be added in compartment I if the pre-wash function is selected.

2. Washing

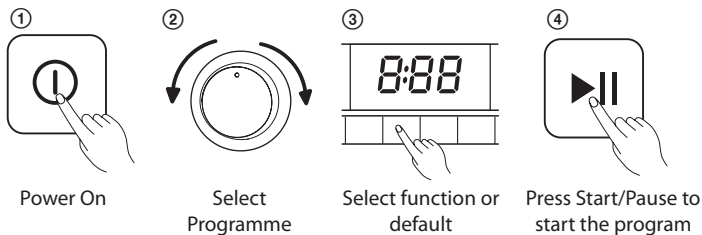

3. After Washing

Buzzer beep or "End" on display.

■ Before Each Washing

- The ambient temperature of the washer dryer should be 5-40°C. If used under 0°C, the inlet valve and draining system may be damaged. If the machine is installed under freezing conditions, it should be transferred to normal ambient temperature to ensure the water supply hose and drain hose can unfreeze before use.
- Please check the labels and the explanation of using detergent before wash. Use non-foaming or less-foaming detergent suitable for machine washing properly.



Check the label



Sort laundry according to color and textile type



Take all items out of the pockets

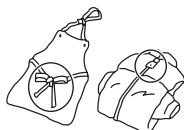

Tie together long textile strips and belts, close zips and button



Put small items into a laundry bag



Turn easy-pilling and long-pile fabric inside out

⚠ Warning!

- Do not wash or dry articles that have been cleaned in, washed in, soaked in, or dabbed with combustible or explosive substances like wax, oil, paint, gasoline, alcohol, kerosene, and other flammable materials.
- Washing single clothes items may easily create big eccentricity and cause alarm due to unbalance. Therefore it is suggested to add one or two more laundry items to the wash so that spin can be done smoothly.

■ Detergent Dispenser

- I Pre wash detergent
- II Main wash detergent
- ☼ Softener
-  Release button to pull out the dispenser

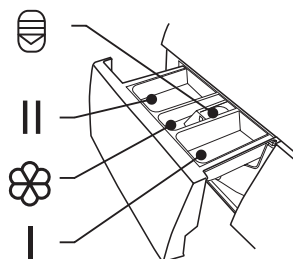

Caution!

- Detergent only need to be added in “compartment I” after selecting pre-wash function.

Programme	I	II	☼
Cotton		●	○
1 Hour W/D		●	○
Jeans		●	○
Mix		●	○
Wool		●	○
Rinse&Spin			○
ECO 40-60		●	○
20°C		●	○

Programme	I	II	☼
Dry Only			
Spin Only			
Quick		●	○
Sport Wear		●	○
Baby Care		●	○
Wash and Dry		●	○
Intensive		●	○

■ Detergent Recommendation

Recommended washing detergent	Wash cycles	Washing temp.	Type of laundry and textile
Heavy-duty detergent with bleaching agents and optical brighteners	Cotton, ECO 40-60, Intensive	40/60	White laundry made from boil-proof cotton or linen
Colour detergent without bleaching agent and optical brighteners	Intensive, Cotton, ECO 40-60, Mix, 20°C	20/30/40	Coloured laundry made from cotton or linen
Color or mild detergent without optical brighteners	20°C	Cold/20	Coloured laundry made from easy care fibres or synthetic materials
Mild washing detergent	20°C	Cold/20	Delicate textiles, silk, viscose
Special wool detergent	Wool	20/30/40	Wool

Note!

- Agglomerating or ropy detergent or additive can be diluted in some water before pouring it into the detergent dispenser, to avoid its inlet to get blocked and thus cause a water overflow.
- Please choose the suitable type of detergent to get a maximum of washing performance and a minimum of water and energy consumption
- To achieve the best cleaning result a proper detergent dosing is important.
- Use a reduced detergent amount if the drum is not filled completely.
- Always adjust the amount of detergent to the water hardness, if your tap water is soft, use less detergent.
- Dose according to how dirty your laundry is, less dirty clothes require less detergent.
- Highly concentrated (compact detergent) requires particularly accurate dosing.

Following symptoms are a sign of detergent overdosing:

- heavy foam formation
- poor washing and rinsing result

Following symptoms are a sign of detergent underdosing:

- laundry turns grey
- built-up of limescale deposits on the drum, the heating element and/or the laundry

Control Panel

PLWDI 1486 BBI

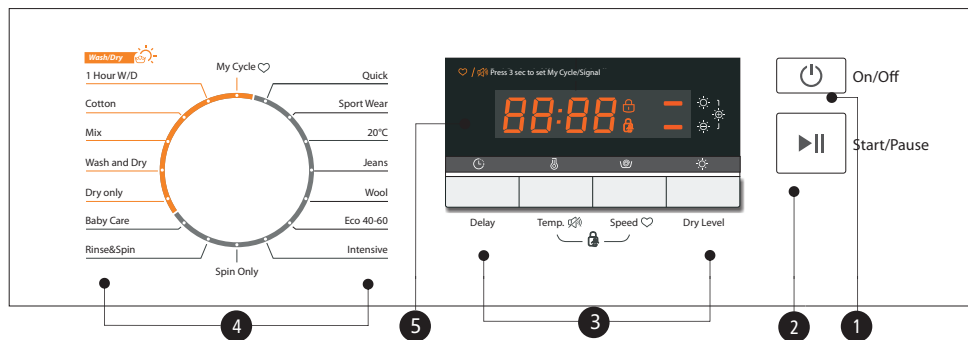

1 On/Off

Turn the appliance on and off.

3 Option

This allows you to select an additional function and will light when selected.

5 Display

The display shows settings, estimated remaining time, options and status messages.

2 Start/Pause

Start or pause your programme.

4 Programmes

Available according to the laundry type.

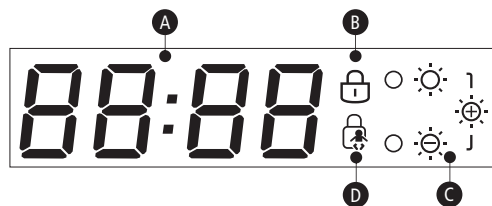

A Wash Time

1:25

Speed

1200

End

End

B Door Lock

C Dry level

Gentle

Normal

Extra

D Child Lock

Delay Time

2h

Error

E20

■ Programmes

Model:PLWDI 1486 BBI

Programme	Washing/Drying (kg) Load	Display Time(H)
	8.0	8.0
		1400
Quick	2.0	0:15
Sport Wear	4.0	1:11
20°C	4.0	1:01
Jeans	8.0	1:45
Wool	2.0	1:07
ECO 40-60	8.0	3:35
Intensive	8.0	3:48
Spin Only	8.0	0:12
Rinse&Spin	8.0	0:20
Baby care	8.0	1:43
☀️ Dry Only	6.0	4:14
☀️ Wash and Dry	8.0/6.0	5:00
☀️ Mix	8.0/6.0	1:20
☀️ Cotton	8.0/6.0	3:49
☀️ 1 Hour W/D	1.0/1.0	0:58

Note!

- The parameters in this table are only for user's reference. The actual parameters maybe different with the parameters in above mentioned table.
- The programme with ☀️ can be chosen dry function.

■ Programmes

PLWDI 1486 BBI							
Cycle	Nominal capacity in kg	Temperature setting	Cycle duration in hours and minutes	Energy consumption in kWh/operating cycle	Water consumption in liter//operating	Highest temperature °C ¹⁾	residual moisture in % /spin speed ²⁾
Quick 15	2.0	cold	0:15	0.030	40.0	Cold	70%/800
20°C	4.0	20	1:01	0.183	44.0	20	65%/1000
Intensive	8.0	40	3:48	1.013	71.0	40	70%/800
Mix	8.0	40	1:20	0.754	71.0	40	70%/800
Cotton	8.0	60	3:54	1.515	71.0	60	53%/1400
ECO 40-60°C	8.0	-	3:38	0.871	64.0	38	53%/1400
	4.0	-	2:48	0.530	46.3	38	53%/1400
	2.0	-	2:48	0.205	33.4	21	53%/1400
Wash an Dry	6.0	-	9:30	4.400	108.4	39	0%/1400
	3.0	-	6:40	2.400	63.5	27	0%/1400

- The above data is for reference only, and the data may change due to different actual use conditions.
- The valves given for programmes other than the ECO 40-60 programme and the Wash and Dry cycle are indicative only.
- Concerning to EN 60456:2016 With (EU)No.1061/2010, The EU energy efficiency class is: A
Energy test program: Intensive Speed:The highest speed; Temp.: 60/40°C; Other as the default. Half load for 8.0Kg machine: 4.0Kg.
- Concerning to EN 60456:2016/prA2019 With (EU)2019/2014, (EU)2019/2023, The EU Wash energy efficiency class is B, Energy test program: ECO 40-60; The EU Wash and dry energy efficiency class is E,Energy test program: Wash and Dry; Extra Dry. Other as the default. Half load for 8.0 Kg machine: 4.0K g. Quarter load for 8.0Kg machine:2.0Kg.

- 1) The highest temperature reached by the laundry in the wash cycle for at least 5 minutes.
- 2) Residual moisture after the wash cycle in water content percent and the spin speed at which this was achieved.
- 3) The ECO 40-60 programme is able to clean normally soiled cotton laundry declared to be washable at 40°C or 60°C, together in the same cycle. This programme is used to assess the compliance with the regulation (EU) 2019/2023.
- 4) The Wash and Dry programme, dry level setting ☀️: Extra Dry is able to clean normally soiled cotton laundry declared to be washable at 40°C or 60°C, together in the same cycle, and to dry it in such a way that it can be immediately stored in a cupboard. This programme is used to assess the compliance with the regulation (EU) 2019/2023.

The most efficient programmes in terms of energy consumption are generally those that perform at lower temperatures and longer duration.

Loading the household washer-dryer up to the capacity indicated for the respective programmes will contribute to energy and water savings.

Noise and remaining moisture content are influenced by the spinning speed: the higher the spinning speed in the spinning phase, the higher the noise and the lower the remaining moisture content.



Caution!

- If there is any break in the power supply while the machine is operating, a special memory stores the selected programme. The machine will continue the programme when the power supply is re-established.

■ Programmes

Programmes are available according to the laundry type.

Programmes	Washing/Drying (kg) Load
Cotton	Hard-wearing textiles, heat-resistant textiles made of cotton or linen.
Baby Care	Washing the baby's clothes, it can make the baby's wear cleaner and make the rinse performance better to protect the baby skin.
Jeans	Specially for jeans.
Mix	Mixed load consisting of textiles made of cotton and synthetics.
Sport Wear	Washing the activewear.
Quick	Extra short programme approx, suitable for lightly soiled washing as a small amounts of laundry.
Wool	Hand or machine-washable wool or richwool textiles. Especially gentle wash programme to prevent shrinkage, longer programme pauses (textiles rest in wash liquor).
Spin Only	Extra spin with selectable spin speed.
Rinse&Spin	Extra rinse with spin.
Dry Only	Select it to dry clothes, the temperature is different .The drying time according to the load .
1Hour W/D	For small synthetic clothes or shirts, load limitation is 1 kg (about 4 shirts). When you have an urgent appointment but no more clean shirt left in your cupboard, this program will help you. Time duration is only 1 hour including wash and dry. Remark: Big towels or jeans is not suitable for this program, they will enlarge the time duration and affect the moisture content.
ECO 40-60	Washing brightly colored clothes, it can protect the colors better. Default 40°C, not selectable, suitable for laundry washing at about 40°C-60°C.
Intensive	To increase the washing effects, washing time is increased.
20°C	20°C default, can choose cold water.
Wash and Dry	The standard energy program.

Note!

- The parameters in this table are only for user's reference. The actual parameters maybe different with the parameters in above mentioned table.
- The programme with  can be chosen dry function.

■ Option

Cycle	Default Temp. (°C)	Default spin speed in rpm	Additional functions
		1400	
Quick	Cold	800	Delay
Sport Wear	40	800	Delay
20°C	20	1000	Delay
Jeans	60	1000	Delay
Wool	40	600	Delay
ECO 40-60	--	1400	Delay
Intensive	40	800	Delay
Spin only	--	1000	Delay
Rinse&Spin	--	1000	Delay
Baby care	60	800	Delay
Dry Only	--	1400	Delay ☀️
Wash and Dry	--	1400	Delay ☀️
Mix	40	800	Delay ☀️
Cotton	40	1400	Delay ☀️
1 Hour W/D	Cold	1400	Delay ☀️

Note!

- For the maximum spin speed, program time, and other details of the ECO 40-60 and Wash and Dry programs, please refer to the content on the Product Fiche page.
- The table shows which cycle offers which options for adjustment. If an adjustment is not possible for a cycle.

■ Option

Delay

Delay

Set the Delay function:

1. Select a programme
2. Press the Delay button to choose the time(the delaying time is 0-24 H.)
3. Press [Start/Pause] to commence the delay operation



On/Off



Choose the
Programme



Setting time



Start

Cancel the Delay function:

Press the [Delay] button until the display be 0H.It should be pressed before starting the programme. If the programme already started, should press the [On/Off] button to reset the programme.



My Cycle

Memory the frequently used programmes

Press [♥]3sec. to memory the running programme. The default is cotton.



Child Lock

To avoid mis operation by children.



On/Off



Start/Pause



Press [Temp.] and
[Speed] 3 sec. till
buzzer beep.



⚠ Caution!

- Press the two button 3 sec. also to be released the function.
- The "Child Lock" will lock all buttons except [On/Off].
- Cut off the power supply , the kid's protection is to be released.
- The child lock will remain effective when the power is resumed for some models.

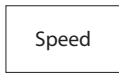

Spin Speed

When needed, the spinning speed can be adjusted pressing the Speed button in the following steps: 1400: 0-400-600-800-1000-1200-1400

! Caution!

- When the lights of speed are off means the spin speed is 0.

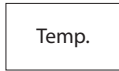

Temp.

Press the button to regulate the temperature(Cold,20°C,30°C, 40°C,60°C,90°C)



Mute the buzzer



On/Off



Start/Pause



Press the [Temp.] button for 3sec. the buzzer is mute.

To act the buzzer function, press the button again for 3 seconds. The setting will be kept until the next reset.

! Caution!

- After Muting the buzzer function, the sounds will not be activated any more.



Dry Level

Press the Dry Level button continuously to choose the dry level: Extra Dry/Normal Dry/ Gentle Dry.

☀ Extra Dry: Need to wear clothes immediately ,we can choose this function

☀ Normal Dry: The normal dry procedure

☀ Gentle Dry: Only to dry slightly and then is just ok .

📌 Note!

- Drying hints
 - Clothes could be dried after spinning
 - To ensure quality dry the textiles,please classify them according to their kinds and the drying temperature.
 - Synthetic should be set the proper drying time .
 - If you want to iron the clothes after drying,please put them for a while.
- Clothes not suitable for drying
 - Particularly delicate items such as synthetic curtains,woolen and silk, clothes with metal inserts,nylon stockings,bulky clothes,such as anoraks,bedcovers,quilts,sleeping bags and duvets must not be dried.
 - Clothes padded with foam-rubber or materials similar to foam-rubber must not be machine dried.
 - Fabrics containing residues of setting lotions or hair sprays, nail solvents or similar solutions must not be machine dried in order to avoid the formation of harmful vapours.

PART 4: MAINTENANCE

■ Cleaning And Care

Warning!

- Always unplug the appliance and close the water tap before cleaning and maintenance.

Cleaning the Cabinet

Proper maintenance on the washing machine can extend its working life. The surface can be cleaned with diluted non-abrasive neutral detergents when necessary. If there is any water overflow, use a cloth to wipe it off immediately.

Never use sharp items to clean the appliance.



Caution!

- Never use abrasive or caustic agents, formic acids or its diluted solvents or similar substances, like alcohol or chemical products.

Cleaning The Drum

Any rust stains left inside the drum by metal articles must be removed immediately using chlorine-free detergents. Never use steel wool for cleaning the drum!

Note!

- Keep any laundry away from the machine while cleaning the drum.

Cleaning The Door Seal And Glass

Wipe the glass and seal after each wash to remove lint and stains. If lint builds up it can cause leakages.

Remove any coins, buttons and other objects from the seal after each wash. Clean the Door Seal and Glass every month to ensure the normal operation of the appliance.

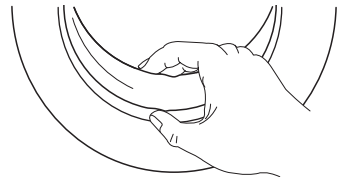

■ Cleaning The Inlet Filter

Note!

- Diminishing water flow is a sign that the filter need to be cleaned.
1. Close the tap and remove the water supply hose from it.
 2. Clean the filter with a brush.
 3. Unscrew the water supply hose from the backside of the machine. Pull out the filter with long nose pliers.
 4. Use a brush to clean the filter.
 5. Reinstall the filter to the water inlet and reconnect the water supply hose.
 6. Clean the Inlet filter every 3 months to ensure the normal operation of the appliance.

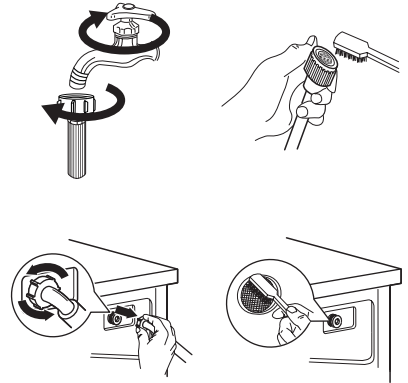

Clean The Detergent Dispenser

1. Press down the release [] on the softener cover and pull the dispenser drawer out of the recess. Clean the inside of the recess with a brush.
2. Lift the softener cover off the dispenser drawer and wash both items with water.
3. Restore the softener cover and push the drawer back into the recess.

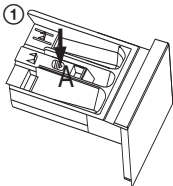

Pull out the dispenser drawer with press the A

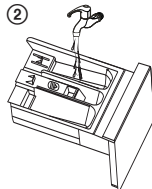

Clean the dispenser drawer under water

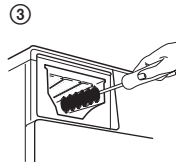

Clean inside the recess with an old toothbrush

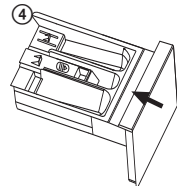

Insert the dispenser drawer

Note!

- Do not use abrasive or caustic agents to clean plastic parts.
- Clean the detergent dispenser every 3 months to ensure the normal operation of the appliance

■ Cleaning The Drain Pump Filter

Warning!

- Be careful of the hot water!
- Allow detergent solution to cool down.
- Unplug the machine to avoid electrical shock before washing.
- Drain pump filter can filter the yarns and small foreign matters from the washing.
- Clean the filter periodically to ensure the normal operation of washing machine.
- Clean the filter periodically every 3 months to ensure the normal operation of the appliance.

①

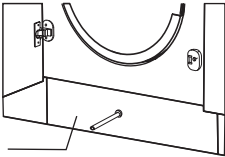

After the power is disconnected, pull out the Dam-Board.

②

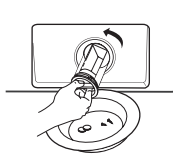

Turn the filter down as shown with the figure and take out sundries matters.

③

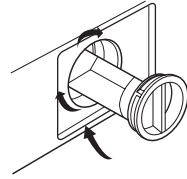

Reinstall each part back after sundries matters are removed.

Caution!

- Make sure emergency drain hose cap and the emergency drain hose are reinstalled properly, otherwise water may leak.

■ Trouble Shooting

Whenever there is a problem with the appliance, check if you can solve it following the tables below. If the problem persists, please contact the customer service.

Description	Possible cause	Solution
Appliance does not start	Appliance does not start	Close the door properly and restart. Check the laundry.
Door can't be opened.	Safety protection is activated.	Safety protection is activated.
Water leakage.	Connections are not tight enough.	Check and fasten the water inlet pipe. Check and clean the outlet hose.
Detergent residues in the detergent dispenser	Detergent is damp and/or clotted.	Clean and wipe the detergent dispenser dry.
Indicator or display does not work	PC board or harness have connection problems.	Switch off the power and check if the mains plug is connected properly.
Abnormal noise.	Fixing bolts still in place. Floor is not solid or level.	Check if the fixing bolts have been removed Make sure the appliance is installed on a solid and level floor.

Error Codes

Description	Possible cause	Solution
E30	Door is not closed properly	Close the door properly and restart.
E10	Water injecting problem during wash cycle.	Check if the water pressure is high enough. Straighten the water pipe. Clean the inlet valve filter.
E21	Overtime water draining	Check the drain hose for blockage.
E12	Water overflow	Restart the appliance.
EXX	Others.	Restart the appliance. If problem persists, please contact the customer service.

■ Customer service

Spare part for your appliance are available for a minimum of 10 years.
In case of questions please contact our customer service at:

Warning!

Risk of electric shock

- Never try repair an appliance which is defective or presumed to be defective.
You may put your own and future users' lives in danger. Only authorised specialists are allowed to carry out this repair work.
- Improper repair will void the warranty and subsequent damages can't be recognized!

Transport

IMPORTANT STEPS WHEN MOVING THE APPLIANCE

- Unplug the appliance and close the water inlet tap.
- Check, if the door and the detergent dispenser are closed properly.
- Remove the water inlet pipe and the outlet hose from the house installations.
- Let the water drain completely from the appliance (see "Maintenance Cleaning the drain pump filter")
- Important: Re-install the 4 transport bolts in the back of the appliance.
- This appliance is heavy. Transport with care. Never hold any protruding part of the machine when lifting.
The machine door cannot be used as a handle.

■ Technical Specifications

Power Supply	220 - 240V ~ 50Hz
MAX. Current	10 A
Standard Water Pressure	0.05 MPa ~ 1MPa

Model	PLWDI 1486 BBI
Power Supply	220 - 240V ~ 50Hz
Washing Capacity	8.0 kg
Drying Capacity	6.0 kg
Dimension(W*D*H)	595*540*825
Weight	64 kg
Rated Power	1900 W
Drying Power	1300 W

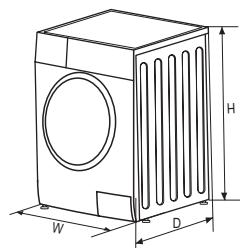

■ Built-in installation

Appendix

Self-tapping screws (ST4*12)



Self-tapping screws (M5*12)



Hinges

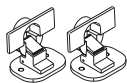

Counter magnet

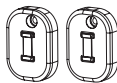

Spacer

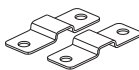

Fixed position paper



Tool

Screw driver



Automatic driver



Ruler



Pencil



Install Steps

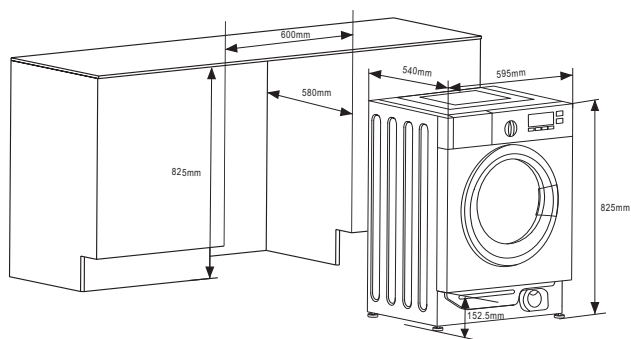

Overview

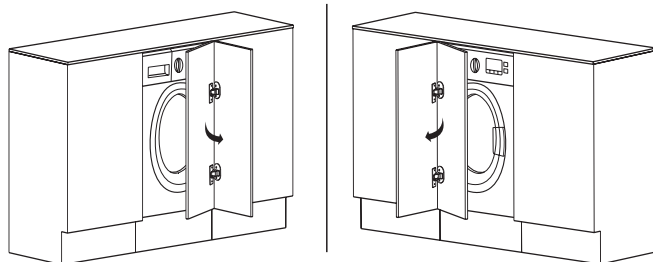

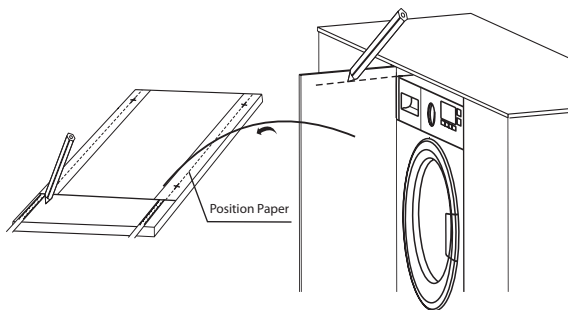

Make the mark on the door

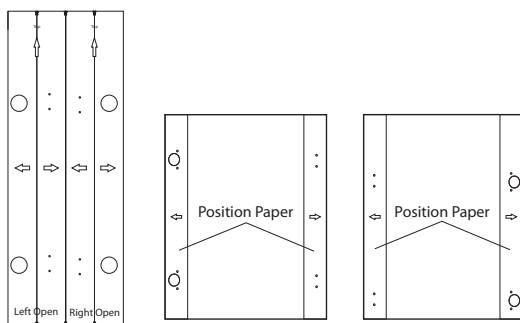

Fixed position paper on the door.

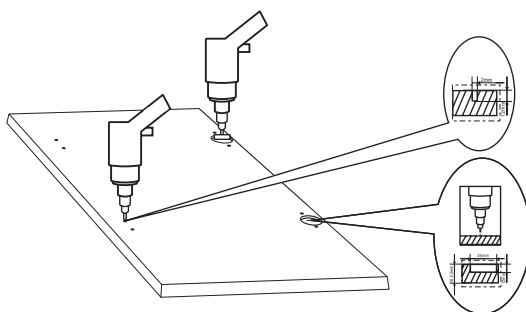

Drill hole on the door

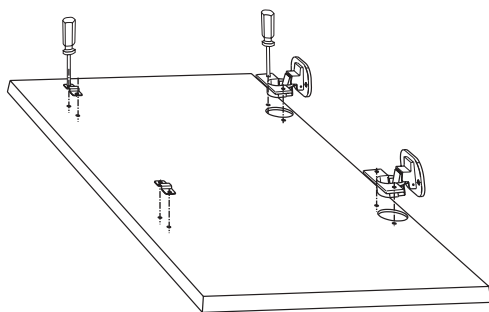

Installation the hinges and spacer

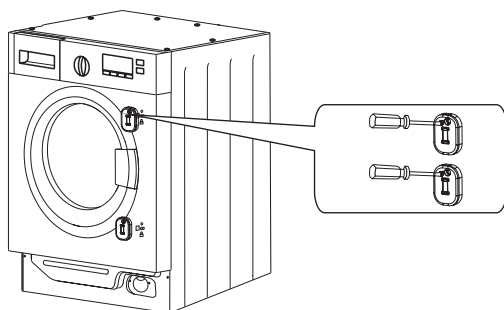

Installation the counter magnet

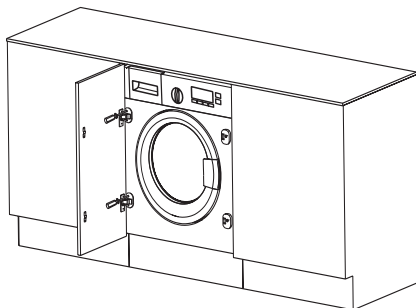

Warning!

- When installing the appliance into the kitchen ensure furniture, if possible, the hoses are placed in either of the two recesses on the back of the appliance. This will help to prevent the hoses from becoming kinked or trapped.

Product Information Sheet



COMMISSION DELEGATED REGULATION (EU) 2019/2014 with regard to energy labelling of household washing machines and household washer-dryers

Supplier's name or trademark: PHILCO

Supplier's address: FAST ČR, a.s., U Sanitasy 1621, Říčany 251 01, Czech Republic

Model identifier: PLWDI 1486 BBI

General product parameters: Built-in wash and dryer combo

Parameter	Value		Parameter	Value	
Rated capacity (kg)	Rated capacity ^(b)	8.0	Dimensions in mm	Height	83
	Rated washing capacity ^(a)	6.0		Width	60
				Depth	54
Energy Efficiency Index	EEI _W ^(a)	60	Energy efficiency class	EEI _W ^(a)	B
	EEI _{WD} ^(b)	78.4		EEI _{WD} ^(b)	E
Washing efficiency index	I _W ^(a)	1.031	Rinsing effectiveness (g/kg dry textile)	I _R ^(a)	5.0
	J _W ^(b)	1.031		J _R ^(b)	5.0
Energy consumption in kWh per cycle, for the washing cycle of the household washdryer, using the eco 40-60 programme at a combination of full and partial loads. Actual energy consumption will depend on how the appliance is used.	0.545		Energy consumption in kWh per cycle, for the wash and dry cycle of the household wash-dryer at a combination of full and half loads. Actual energy consumption will depend on how the appliance is used.	3.600	
Water consumption in litre per cycle, based on the eco 40-60 programme. Actual water consumption will depend on how the appliance is used and on the hardness of the water.	49		Water consumption in litre per cycle, for the wash and dry cycle of household washer-dryer at combination of full and half loads. Actual water consumption will depend on how the appliance is used and on the hardness of the water.	90	

Maximum temperature inside the treated textile (°C) for the washing cycle of the household washer-dryer, using the eco 40-60 programme.	Rated capacity	38	Maximum temperature inside the treated textile (°C) for the washing cycle of the household washerdryer, using the wash and dry cycle.	Rated capacity	39
	Half	38		Half	27
	Quarter	21			
Spin speed (rpm) ^(a)	Rated capacity	1400	Remaining moisture content (%) ^(a)	53.9	
	Half	1400			
	Quarter	1400			
Eco 40-60 programme duration (h:min)	Rated capacity	3:38	Spin-drying efficiency class ^(a)	B	
	Half	2:48			
	Quarter	2:48			
Airborne acoustical noise emissions in the spinning phase (dB(A) re 1 pW)	76		Wash and dry cycle duration (h:mim)	Rated capacity	9:30
				Half	6:40
Type	Built-in		Airborne acoustical noise emission class for the spinning phase for the eco 40-60 programme at rated washing capacity.	B	
Off-mode (W) (if applicable)	0.50		Standby mode (W) (if applicable)	1.00	
Delay start (W) (if applicable)	4.00		Networked standby (W) (if applicable)	N/A	
Minimum duration of the guarantee offered by the supplier: 24 months					
This product has been designed to release silver ions during the washing cycle			No		
Additional information:					
Weblink to the supplier's website, where the information in point 9 of Annex II to Commission Regulation (EU) 2019/2023 is found: www.philco.cz					

^(a) for the eco 40-60 programme.

^(b) for the wash and dry cycle.

TECHNICAL INFORMATION

Technical information can be found on the type plate on the inside of the appliance and on the energy label. The QR code, on the supplied energy label, contains a link to register the appliance in the EU Eprel database. Keep the energy label, the instructions for use, together with other documents supplied with the device.

TESTING INFORMATION

The delivered device is in accordance with EcoDesign and EN 60456;2016/A11:2020, EN60456;2016,CLC/TS 50707:2020, CLC/TS 50677:2019, EN 50564:2011,EN 60704-1:2010+A11:2012.EN IEC 60704-2-16:2019+A11:2020, EN 60704-3:2019, EN IEC 62512:2020, EN IEC 62512:2020/A11:2020. If you have any further questions, please contact the manufacturer.

CUSTOMER CARE AND SERVICE

Always use original spare parts.

Model name and serial number can be found on the rating plate. Position of rating plate can be changed without notice.

The original spare parts for some specific components are available for a minimum of 7 or 10 years, based on the type of component, from the placing on the market of the last unit of the model.

When contacting our authorized service, have the model designation, serial number and defect description available.

To download documents, visit www.philco.cz.

To report a defect and obtain additional service information, visit <https://philco.cz/podpora-a-servis>.

Subject to change without notice.

INSTRUCTIONS AND INFORMATION REGARDING THE DISPOSAL OF USED PACKAGING MATERIALS

Dispose of packaging material at a public waste disposal site.

DISPOSAL OF USED ELECTRICAL AND ELECTRONIC APPLIANCES



The meaning of the symbol on the product, its accessory or packaging indicates that this product shall not be treated as household waste. Please, dispose of this product at your applicable collection point for the recycling of electrical & electronic equipment waste. Alternatively in some states of the European Union or other European states you may return your products to your local retailer when buying an equivalent new product. The correct disposal of this product will help save valuable natural resources and help in preventing the potential negative impact on the environment and human health, which could be caused as a result of improper liquidation of waste. Please ask your local authorities or the nearest waste collection centre for further details. The improper disposal of this type of waste may fall subject to national regulations for fines.

For business entities in the European Union

If you wish to dispose of an electrical or electronic device, request the necessary information from your seller or supplier.

Disposal in other countries outside the European Union

If you wish to dispose of this product, request the necessary information about the correct disposal method from local government departments or from your seller.



This product meets all the basic EU regulation requirements that relate to it.

Changes to the text, design and technical specifications may occur without prior notice and we reserve the right to make these changes.

Original of this user manual is in czech language.

Výrobce/Manufacturer:
Fast ČR, a.s.
U Sanitasu 1621
Říčany 251 01, CZECH REPUBLIC

Distributor:
FAST PLUS, a.s.
Vlčie hrdlo 324/90
821 07 Bratislava, SLOVAKIA

PHILCO[®] 

is a pending or registered trademark of Electrolux Home Products, Inc. and used under a license from Electrolux Home Products, Inc.