

Washing Machine

USER MANUAL

PHILCO



Famous for Quality the World Over

PLDI 127 BTL KING
PLDI 138 BTL KING

Dear customer,
Thank you for buying a PHILCO brand product. So that your appliance serves you well, please read all the instructions in this user's manual.

CONTENTS

PART 1: SAFETY INSTRUCTIONS2
 APPLIANCE INSTALLATION.....6
 SAFETY INSTRUCTIONS7

PART 2: INSTALLATION.....9
 PRODUCT DESCRIPTION9
 INSTALLATION10

PART 3: OPERATIONS.....14
 QUICK START14
 BEFORE EACH WASHING15
 DETERGENT DISPENSER16
 DETERGENT RECOMMENDATION17
 CONTROL PANEL18
 PROGRAMMES.....19
 MODEL: PLDI 127 BTL KING.....19
 PROGRAMMES.....20
 MODEL: PLDI 138 BTL KING.....21
 OPTION.....25

PART 4: MAINTENANCE28
 CLEANING AND CARE.....28
 CLEANING THE INLET FILTER29
 CLEANING THE DRAIN PUMP FILTER.....30
 TROUBLE SHOOTING31
 CUSTOMER SERVICE.....32
 TECHNICAL SPECIFICATIONS32



CAUTION: HOT SURFACE !



CAUTION: RISK OF FIRE !

PART 1: SAFETY INSTRUCTIONS

THIS APPLIANCE CAN BE USED BY CHILDREN AGED FROM 8 YEARS AND ABOVE AND BY PERSONS WITH REDUCED PHYSICAL, SENSORY OR MENTAL CAPABILITIES OR LACK OF EXPERIENCE AND KNOWLEDGE IF THEY HAVE BEEN GIVEN SUPERVISION OR INSTRUCTIONS CONCERNING USE OF THE APPLIANCE IN A SAFE WAY AND IF THEY UNDERSTAND THE HAZARDS INVOLVED.

CHILDREN MUST NOT PLAY WITH THE APPLIANCE.

CHILDREN YOUNGER THAN 3 YEARS OF AGE SHOULD BE PREVENTED FROM ACCESSING UNLESS THEY ARE UNDER PERMANENT SUPERVISION.

CLEANING AND USER MAINTENANCE CANNOT BE PERFORMED BY CHILDREN WITHOUT SUPERVISION.

IF THE SUPPLY CABLE GETS DAMAGED, HAVE IT REPLACED BY A SPECIALIZED SERVICE CENTRE IN ORDER TO AVOID DANGEROUS SITUATIONS. IT IS PROHIBITED TO USE AN APPLIANCE WITH THE SUPPLY CABLE DAMAGED.

THIS APPLIANCE IS INTENDED TO BE USED IN HOUSEHOLDS AND SIMILAR PREMISES, SUCH AS:

- KITCHENETTES IN SHOPS, OFFICES AND OTHER WORKPLACES;
- AGRICULTURAL FACILITIES;
- HOTELS, MOTELS, AND OTHER ACCOMMODATION FACILITIES WHERE APPLIANCES ARE USED BY GUESTS;
- BED AND BREAKFAST FACILITIES;
- COMMON USE FACILITIES IN BLOCKS OF FLATS.

- THE APPLIANCE MUST NOT BE USED WITH MORE DRY LAUNDRY THAN STATED IN THE MACHINE SPECIFICATIONS.
- THE DRYER MUST NOT BE USED IF INDUSTRIAL CHEMICALS WERE INVOLVED IN CLEANING.
- MAKE SURE THAT FLUFF DOES NOT ACCUMULATE AROUND THE MACHINE.
- DO NOT DRY UNWASHED PIECES OF CLOTHING IN THE DRUM DRYER.
- PIECES OF CLOTHING STAINED WITH SUCH SUBSTANCES AS EDIBLE OIL, ACETONE, ALCOHOL, PETROL, PARAFFIN, STAIN REMOVERS, TURPENTINE, WAXES OR WAX REMOVERS SHOULD BE WASHED IN HOT WATER WITH AN EXTRA DOSE OF DETERGENT BEFORE THEY ARE DRIED IN A DRUM DRYER.
- PIECES OF CLOTHING SUCH AS FOAM RUBBER (FOAM LATEX), BATHING CAPS, WATERPROOF TEXTILES, RUBBER-COATED ELEMENTS AND CLOTHING OR PILLOWS FILLED WITH FOAM RUBBER SHOULD NOT BE DRIED IN A DRUM DRYER.
- SOFTENERS AND SIMILAR PRODUCTS SHOULD BE USED ACCORDING TO THEIR INSTRUCTIONS FOR USE.
- THE FINAL PHASE OF THE DRUM DRYER CYCLE WILL BE PERFORMED WITHOUT HEATING (COOLING CYCLE) TO ENSURE THAT THE CLOTHING PIECES WILL ACHIEVE SUCH TEMPERATURE THAT WILL PREVENT THEM FROM GETTING DAMAGED.
- REMOVE ALL ITEMS SUCH AS LIGHTERS AND MATCHES FROM POCKETS.



NEVER TURN THE DRUM DRYER OFF BEFORE THE DRYING CYCLE IS COMPLETED UNLESS ALL ITEMS ARE REMOVED AND SPREAD OUT QUICKLY AFTERWARDS SO THAT THE HEAT CAN DISSIPATE.

– THE APPLIANCE MUST NOT BE INSTALLED BEHIND LOCKABLE DOOR, SLIDING DOOR OR DOOR WITH HINGES AT THE OPPOSITE SIDE FROM THE DRUM DRYER IF SUCH INSTALLATION WOULD PREVENT THE DRUM DRYER DOOR FROM OPENING FULLY.



THE APPLIANCE MUST NOT BE POWERED FROM AN EXTERNAL SWITCHING DEVICE SUCH AS TIMER SWITCH OR BE CONNECTED TO A CIRCUIT THAT IS REGULARLY SWITCHED ON AND OFF.

THIS APPLIANCE IS INTENDED FOR WASHING AND DRYING FABRICS FOR WHICH THE MANUFACTURER HAS RECOMMENDED SUCH TREATMENT.

ALWAYS USE PROGRAMMES ACCORDING TO THE FABRIC TYPE.

THE WASHING MACHINE COULD GET DAMAGED WHEN WASHING OR DRYING SHOES.

DO NOT USE TO WASH CARPETS.

USE ONLY DETERGENTS THAT ARE INTENDED FOR WASHING OR DRYING CLOTHES IN AN AUTOMATIC DRUM WASHING MACHINE.



- IF THE SUPPLY CORD GETS DAMAGED, IT MUST BE REPLACED BY THE MANUFACTURER, ITS SERVICE AGENT OR A SIMILARLY QUALIFIED PERSON.
- THE APPLIANCE SHOULD BE CONNECTED TO THE WATER SUPPLY AND DRAIN USING NEW HOSES, NOT USING HOSES THAT HAVE ALREADY BEEN USED.
- ALWAYS DISCONNECT THE APPLIANCE FROM THE MAINS BEFORE PERFORMING ANY MAINTENANCE.
- THE POWER CORD PLUG MUST BE CONNECTED TO A GROUNDED THREE-POLE ELECTRIC OUTLET.
- NEVER USE A POWER OUTLET WITH A RATED VOLTAGE THAT IS DIFFERENT FROM THE APPLIANCE'S VOLTAGE.
- DO NOT USE EXTENSION CORD TO CONNECT THE MACHINE TO THE POWER OUTLET.
- THE APPLIANCE, THE POWER CORD OR THE ELECTRIC OUTLET MUST NOT LIE IN, TOUCH OR BE SUBMERGED IN WATER OR ANY OTHER LIQUID TO AVOID ELECTRICAL HAZARDS.
- THE APPLIANCE MUST NOT STAND ON THE POWER CORD.
- THE POWER CORD MUST NOT BE EXCESSIVELY OR DANGEROUSLY BENT OR COMPRESSED DURING INSTALLATION OR OPERATION.
- THE CONTROLS AND DOOR OF THE APPLIANCE ARE NOT TO BE PLAYED WITH.
- THE GLASS DOOR OF THE APPLIANCE CAN GET HOT DURING OPERATION.
- DO NOT DRY UNWASHED PIECES OF CLOTHING IN THE DRYER.

APPLIANCE INSTALLATION

- THIS APPLIANCE IS INTENDED FOR INTERIOR USE ONLY.
- THIS APPLIANCE IS INTENDED TO BE BUILT-IN.
- THE ELECTRIC OUTLET THAT THE POWER CORD IS CONNECTED TO MUST BE EASILY ACCESSIBLE AFTER THE APPLIANCE HAS BEEN INSTALLED.
- REMOVE ALL PACKAGING MATERIALS AND SAFETY TRANSPORT BOLTS BEFORE USING THE APPLIANCE. OTHERWISE THE APPLIANCE OR ITS SURROUNDINGS MIGHT GET SERIOUSLY DAMAGED.
- THE APPLIANCE, THE POWER CORD OR THE ELECTRIC OUTLET MUST NOT LIE IN, TOUCH OR BE SUBMERGED IN WATER OR ANY OTHER LIQUID TO AVOID ELECTRICAL HAZARDS.
- THE PACKAGING MATERIALS MUST BE DISPOSED OF IN A PROPER MANNER.
- DO NOT LIFT OR HANDLE THE APPLIANCE WHEN HOLDING ITS DOOR, CONTROLS, THE UPPER BOARD, HOSES OR POWER CORD.
- THE APPLIANCE MUST BE INSTALLED ONTO A FIRM AND EVEN SURFACE.
- AFTER YOU PLACE THE APPLIANCE, MAKE SURE IT IS LEVEL IN ALL DIRECTIONS USING A SPIRIT LEVEL.
- THE APPLIANCE MUST NOT BE INSTALLED BEHIND LOCKABLE DOOR, SLIDING DOOR OR DOOR WITH HINGES AT THE OPPOSITE SIDE FROM THE DRUM DRYER IF SUCH INSTALLATION WOULD PREVENT THE DRUM DRYER DOOR FROM OPENING FULLY.



THE APPLIANCE MUST NOT BE POWERED FROM AN EXTERNAL SWITCHING DEVICE SUCH AS TIMER SWITCH OR BE CONNECTED TO A CIRCUIT THAT IS REGULARLY SWITCHED ON AND OFF.

**PLEASE READ THOSE SAFETY PRECAUTIONS CAREFULLY AND
STORE THEM FOR FUTURE REFERENCE.**

■ **Safety Instructions**

For your safety, the information in this manual must be followed to minimize the risk of fire or explosion, electric shock, or to prevent property damage, personal injury or loss of life.

Explanation of the symbols:

Warning!

This combination of symbol and signal word indicates a potentially dangerous situation which may result in death or serious injuries unless it's avoided.

Caution!

This combination of symbol and signal word indicates a potentially dangerous situation which may result in slight or minor injuries or damage to property and the environment.

Note!

This combination of symbol and signal word indicates a potentially dangerous situation which may result in slight or minor injuries.

Packaging/Old appliance



This marking indicates that this product should not be disposed with other household wastes throughout the EU. To prevent possible harm to the environment or human health from uncontrolled waste disposal, recycle it responsibly to promote the sustainable reuse of material resources. To return your used device, please use the collection systems or contact the retailer where the product was purchased. They return and can take this product for environmental safe recycling.

PART 2: INSTALLATION

■ Product Description

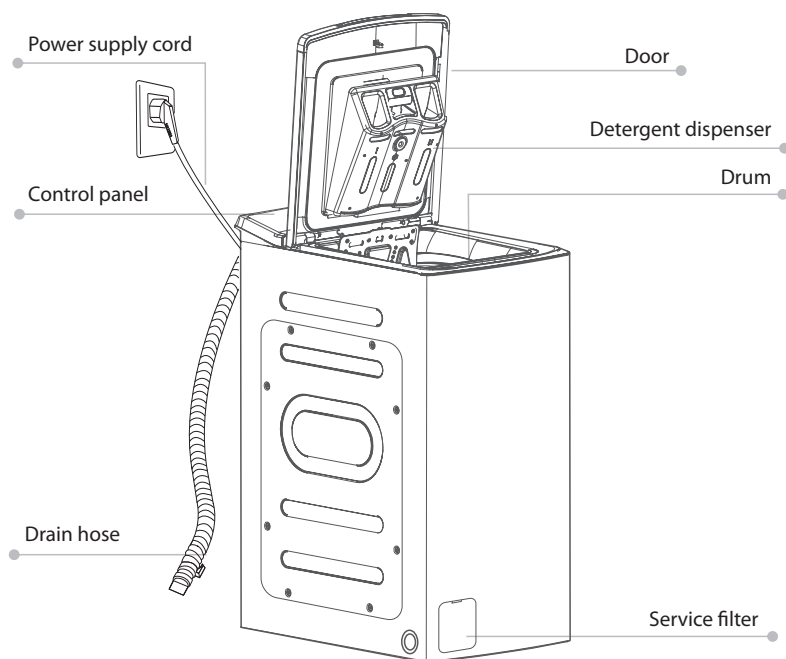

Note!

- The product line chart is for reference only, please refer to real product as standard.

Accessories



Transport hole
plug

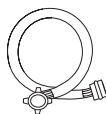

Supply hose cold
water



Owner's manual

■ Installation

Installation area

Warning!

- Stability is important to prevent the product from wandering!
- Make sure that the product should not stand on the power cord.

Before installing the machine, the location characterized as follows shall be selected:

1. Rigid, dry, and level surface
2. Avoid direct sunlight
3. Sufficient ventilation
4. Room temperature is above 0°C
5. Keep far away from the heat resources such as coal or gas.

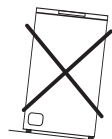
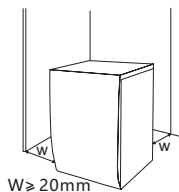

Unpacking the washing machine

Warning!

- Packaging material (e.g. Films, Styrofoam) can be dangerous for children.
 - There is a risk of suffocation ! Keep all packaging well away from children.
1. Remove the cardboard box and styrofoam packing.
 2. Lift the washing machine and remove the base packing. Make sure the small triangle foam is removed with the bottom one together. If not, lay the unit down with side surface, then remove the small foam from the unit bottom manually.
 3. Remove the tape securing the power supply cord and drain hose.
 4. Remove the inlet hose from the drum.

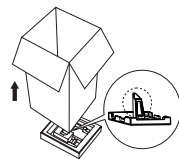

Remove transport bolts

Warning!

- You must remove the transport bolts from the backside before using the product.
- You'll need the transport bolts again if you move the product, so make sure you keep them in a safe place.

Please take the following steps to remove the bolts:

1. Loosen 4 bolts with spanner and then remove them.
2. Stop the holes with transport hole plugs.
3. Keep the transport bolts properly for future use.

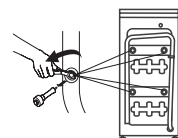

Remove transport bolts

Warning!

- You must remove the transport bolts from the backside before using the product.



Loosen the 4 transport bolts with a spanner.

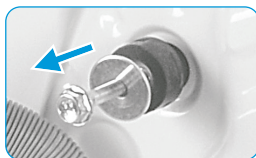

Remove the bolts including the rubber parts and keep them for future use.



Close the holes using the cover caps.

Levelling the washing machine

Warning!

- The lock nuts on all four feet must be screwed tightly against the housing.
- Loosen the lock nut.
 - Turn the foot until it reaches the floor.
 - Adjust the legs and lock the nuts with a spanner. Make sure the machine is level and steady.

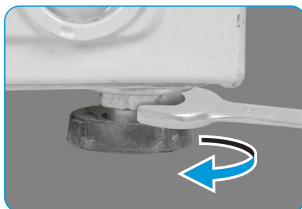

Connect Water Supply Hose

Warning!

To prevent leakage or water damage, follow the instructions in this chapter

- Do not kink, crush or modify water inlet hose.



Connect the water supply hose to the water inlet valve and a water tap with cold water as indicated.



Note!

- Connect manually, do not use tools. Check if the connections are tight.

Drain Hose

Warning!

- Do not kink or protract the drain hose.
- Position drain hose properly ,otherwise damage might result of water leakage.

There are two ways to place the end of drain hose:

1. Put it into the water trough.

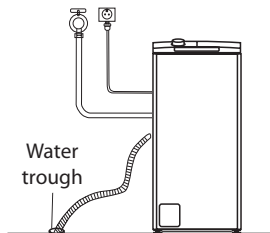

2. Connect it to the branch drain pipe of the trough.

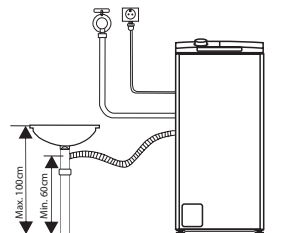

Note!

- If the machine has drain hose support, please install it like the following.

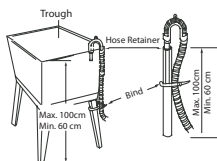
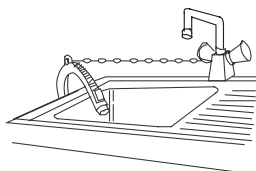

Warning!

- When installing drain hose, fix it properly with a rope.
- If drain hose is too long, do not force it into washing machine as it will cause abnormal noises.

Acoustic Sponge



Note!

- Please make sure to assemble the acoustic sponges, which can effectively reduce the noise caused by the machine while working, in order to provide you with a more peaceful and quiet living environment.

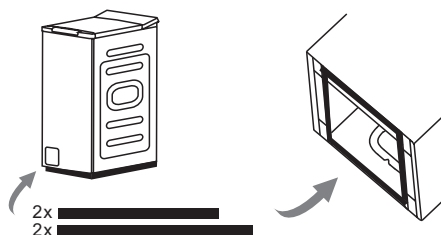

1. Get the machine laid on the floor, using some soft material like foam or clothes between the machine and floor for a protection;
2. Stick the 2x longer sponges to the longer bottom edges of machine, and the 2x shorter sponges to the shorter bottom edges.

PART 3: OPERATIONS

■ Quick Start

⚠ Caution!

- Before washing, please make sure the washing machine is installed properly.
- Your appliance was thoroughly checked before it left the factory. To remove any residual water and to neutralize potential odors, it's recommended to clean your appliance before first use. For this reason, start the Cotton program at 60°C without laundry and detergent.

1. Before Washing

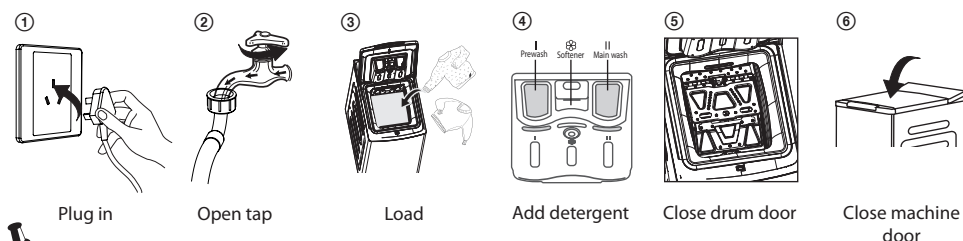

📌 Note!

- Detergent need to be added in "case I" after selecting pre-washing for machines with this function.
- Make sure that the drum flaps are properly locked.



- All metal hooks must be properly hooked inside the rear door flap.
- Check the roller before each laundry, it must roll smoothly.

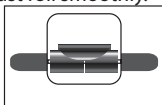

2. Washing

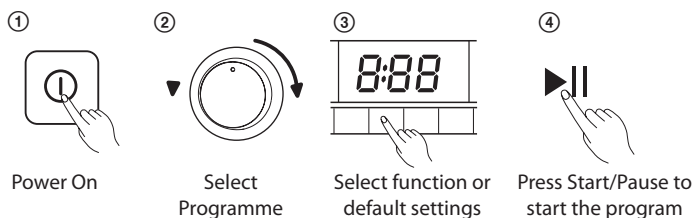

📌 Note!

- If default is selected, step 2 can be skipped.

3. Before Washing

Buzzer beep or "End" on display.

■ Before Each Washing

- The ambient temperature of the washing machine should be 5-40°C. If used under 0°C, the inlet valve and draining system may be damaged. If the machine is installed under freezing conditions, it should be transferred to normal ambient temperature to ensure the water supply hose and drain hose can unfreeze before use.
- Please check the labels and the explanation of using detergent before wash. Use non-foaming or less-foaming detergent suitable for machine washing properly.

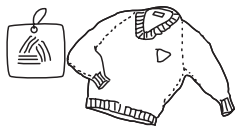

Check the label



Sort laundry according to color and textile type



Take all items out of the pockets



Tie together long textile strips and belts, close zips and button



Put small items into a laundry bag



Turn easy-pilling and long-pile fabric inside out

Warning!

- Do not wash or dry articles that have been cleaned in, washed in, soaked in, or dabbed with combustible or explosive substances like wax, oil, paint, gasoline, alcohol, kerosene, and other flammable materials.
- Washing single clothes items may easily create big eccentricity and cause alarm due to unbalance. Therefore it is suggested to add one or two more laundry items to the wash so that spin can be done smoothly.

Detergent Dispenser

- I

Pre wash detergent
- II

Main wash detergent
- 

Softener

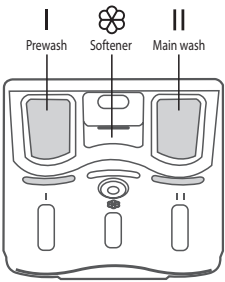

Caution!

- Detergent only need to be added in “case I”after selecting pre-washing for machines with this function.
- Do not exceed the “MAX”level mark when filling in detergent,additives or softener.

Programme	I	II	
My Cycle	○	●	○
Cotton	○	●	○
Synthetics	○	●	○
Mix	○	●	○
Drum Clean			
20 °C		●	○
Intensive		●	○

- Means must
- Means optional

Programme	I	II	
Spin Only			
Rinse & Spin			○
Wool		●	○
Baby Care	○	●	○
Quick 15’		●	○
ECO 40-60		●	○
Bed Linen	○	●	○

■ Detergent Recommendation

Recommended washing detergent	Wash cycles	Washing temp.	Type of laundry and textile
Heavy-duty detergent with bleaching agents and optical brighteners	Cotton,ECO 40-60,Mix	20/40/60	White laundry made from boil-proof cotton or linen
Colour detergent without bleaching agent and optical brighteners	Cotton,ECO 40-60,Mix	Cold/20/40	Coloured laundry made from cotton or linen
Color or mild detergent without optical brighteners	Synthetic	Cold/20/40	Coloured laundry made from easy care fibres or synthetic materials
Mild washing detergent	Synthetic	20/40	Delicate textiles, silk, viscose
Special wool detergent	Wool	20/40	Wool

Note!

- Agglomerating or ropy detergent or additive can be diluted in some water before pouring it into the detergent dispenser, to avoid its inlet to get blocked and thus cause a water overflow.
- Please choose the suitable type of detergent to get a maximum of washing performance and a minimum of water and energy consumption
- To achieve the best cleaning result a proper detergent dosing is important.
- Use a reduced detergent amount if the drum is not filled completely.
- Always adjust the amount of detergent to the water hardness, if your tap water is soft, use less detergent.
- Dose according to how dirty your laundry is, less dirty clothes require less detergent.
- Highly concentrated (compact detergent) requires particularly accurate dosing.

Following symptoms are a sign of detergent overdosing:

- heavy foam formation
- poor washing and rinsing result

Following symptoms are a sign of detergent underdosing:

- laundry turns grey
- built-up of limescale deposits on the drum, the heating element and/or the laundry

Control Panel

Model: PLDI 138 BTL King
PLDI 127 BTL King

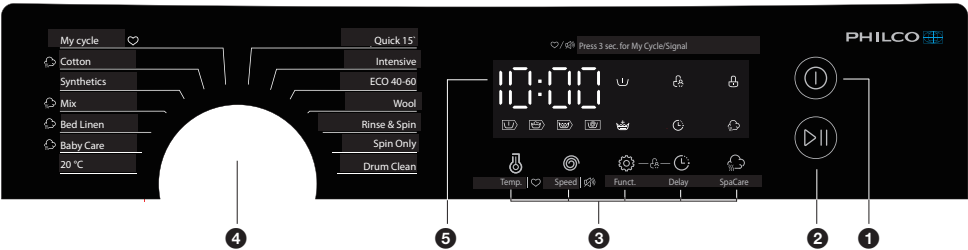

- 1 Power**
Product is on/off.
- 2 Start/Pause**
Press the button to start or pause the washing cycle.
- 3 Option**
This allows you to select an additional function and will light when selected.
- 4 Programmes**
Available according to the laundry type.
- 5 Display**
The display shows the settings, estimated time remaining, options, and status messages for your washer. The display will remain on through the cycle.

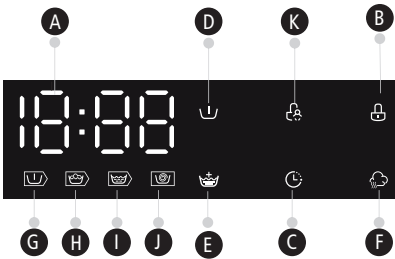

- A Display**
Wash Time 1:25
End End
Delay Time 2h
Error E20
- B Door Lock**
- C Delay**
- D Pre Wash**
- E Extra Rinse**
- F SpaCare**
- G Pre Wash**
- H Wash**
- I Rinse**
- J Spin**
- K Child Lock**

■ Programmes

Model: PLDI 127 BTL King

Programme	Washing/Drying (kg) Load	Display Time(H)
	7.0	7:0
Cotton	7.0	2:40
Synthetics	3.5	2:20
Mix	7.0	1:20
Bed Linen	7.0	1:48
20 °C	3.5	1:01
Baby Care	7.0	2:01
Drum Clean	-	1:18
Spin Only	7.0	0:12
Rinse & Spin	7.0	0:20
Wool	2.0	1:07
Intensive	7.0	3:48
ECO 40-60	7.0	3:28
Quick 15`	2.0	0:15



Note!

- The parameters in this table are only for user's reference. The actual parameters maybe different with the parameters in above mentioned table.

Programmes

PLDI 127 BTL King							
Cycle	Nominal capacity in kg	Temperature setting	Cycle duration in h:min	Energy consumption in kWh/cycle	Water consumption in L/cycle	Highest temperature ature °C ¹⁾	Residual moisiture in % /spin speed in rpm ²⁾
Quick 15	2.0	cold	0:15	0.035	33	Cold	75%/800
20°C	3.5	20	1:01	0.213	43	20	65%/1000
Cotton	7.0	60	2:45	1.420	65	60	60%/1200
Intensive	7.0	40	3:48	1.088	65	40	70%/800
Mix	7.0	40	1:20	0.782	65	40	70%/800
ECO 40- 60°C ³⁾	7.0	-	3:28	0.831	53.0	39	63%/1200
	3.5	-	2:42	0.360	44.0	27	63%/1200
	2.0	-	2:42	0.218	38.0	22	63%/1200

- The above data is for reference only, and the data may change due to different actual use conditions.
- The valves given for programmes other than the ECO 40-60 programme are indicative only.
- Concerning to EN 60456:2016/prA2019 With (EU)2019/2014, (EU)2019/2023,
The EU energy efficiency class is: B
Energy test program: ECO 40-60. Other as the default.
Half load for 7.0kg machine:3.5kg.
Quarter load for 7.0kg machine:2.0kg.

■ Programmes

Model: PLDI 138 BTL King

Programme	Washing/Drying (kg) Load	Display Time(H)
	8.0	8.0
Cotton	8.0	2:40
Synthetics	4.0	2:20
Mix	8.0	1:20
Bed Linen	8.0	1:48
20 °C	4.0	1:01
Baby Care	8.0	2:01
Drum Clean	-	1:18
Spin Only	8.0	0:12
Rinse & Spin	8.0	0:20
Wool	2.0	1:07
Intensive	8.0	0:20
Wool	2.0	1:07
Intensive	8.0	3:48
ECO 40-60°C	8.0	3:38
Quick 15`	2.0	0:15



Note!

- The parameters in this table are only for user's reference. The actual parameters maybe different with the parameters in above mentioned table.

■ Programmes

PLDI 138 BTL King							
Cycle	Nominal capacity in kg	Temperature setting	Cycle duration in hours and minutes	Energy consumption in kWh/operating cycle	Water consumption in liter /operating cycle	Highest temperature ature °C ¹⁾	residual moisture in % /spin speed ²⁾
Quick 15	2.0	cold	0:15	0.026	34	Cold	70%/800
20°C	4.0	20	1:01	0.183	47	20	65%/1000
Cotton	8.0	60	2:45	1.498	71	60	53%/1300
Intensive	8.0	40	3:48	1.013	71	40	70%/800
Mix	8.0	40	1:20	0.784	71	40	65%/1000
ECO 40- 60°C ³⁾	8.0	-	3:38	0.916	59.0	41	54%/1300
	4.0	-	2:48	0.435	47.0	30	54%/1300
	2.0	-	2:48	0.226	38.0	22	53%/1400

- The above data is for reference only, and the data may change due to different actual use conditions.
- The valves given for programmes other than the ECO 40-60 programme are indicative only.
- Concerning to EN 60456:2016/prA2019 With (EU)2019/2014, (EU)2019/2023,
The EU energy efficiency class is: B
Energy test program: ECO 40-60. Other as the default.
Half load for 8.0kg machine:4.0kg.
Quarter load for 8.0kg machine:2.0kg.

- 1) The highest temperature reached by the laundry in the wash cycle for at least 5 minutes.
- 2) Residual moisture after the wash cycle in water content percent and the spin speed at which this was achieved.
- 3) The ECO 40-60 programme is able to clean normally soiled cotton laundry declared to be washable at 40°C or 60°C, together in the same cycle. This programme is used to assess the compliance with the regulation (EU) 2019/2023.

The most efficient programmes in terms of energy consumption are generally those that perform at lower temperatures and longer duration.

Loading the household washer-dryer up to the capacity indicated for the respective programmes will contribute to energy and water savings.

Noise and remaining moisture content are influenced by the spinning speed: the higher the spinning speed in the spinning phase, the higher the noise and the lower the remaining moisture content.



Caution!

- If there is any break in the power supply while the machine is operating, a special memory stores the selected programme. The machine will continue the programme when the power supply is re-established.

■ Programmes

Programmes are available according to the laundry type.

Programmes	
Cotton	Hard-wearing textiles, heat-resistant textiles made of cotton or linen.
Synthetic	Wash synthetic articles, for example: shirts, coats, blending. While washing the knitting textiles, detergent quantity shall be reduced due to its loose string construction and easily forming bubbles.
Baby Care	Washing the baby's clothes, it can make the baby's wear cleaner and make the rinse performance better to protect the baby skin.
Mix	Mixed load consisting of textiles made of cotton and synthetics.
Bed Linen	Washing the bed Linen.
Quick 15'	Extra short programme approx, suitable for lightly soiled washing as a small amounts of laundry.
Wool	Hand or machine-washable wool or richwool textiles. Especially gentle wash programme to prevent shrinkage, longer programme pauses (textiles rest in wash liquor).
Spin Only	Extra spin with selectable spin speed.
Rinse&Spin	Extra rinse with spin.
Drum Clean	Specially set in this machine to clean the drum and tube. It applies 90 °C high temperature sterilization to make the clothes washing more green. When this programme is performed, the clothes or other washing cannot be added. When proper amount of chlorine bleaching agent is put in, the barrel cleaning effect will be better. The customer can use this programme regularly according to the need.
Eco 40-60	Washing brightly colored clothes, it can protect the colors better. Default 40°C, not selectable, suitable for laundry washing at about 40°C-60°C.
Intensive	To increase the washing effects, washing time is increased.
20 °C	Washing brightly colored clothes, it can protect the colors better.



WOOL CARE

The wool wash cycle of this machine has been approved by The Woolmark Company for the washing of machine washable wool products provided that the products are washed according to the instructions on the garment label and those issued by the manufacturer of this washing machine.





Model: PLDI 138 BTL King
PLDI 127 BTL King

Option

Cycle	Default Temp. (°C)	Default spin speed in rpm		Additional functions
Wash cycles		1200	1300	🕒, 👑, 🔄, 🌀
My Cycle	40	800	800	🕒, 👑, 🔄, 🌀
Cotton	40	800	800	🕒, 👑, 🔄, 🌀
Synthetics	40	800	800	🕒, 👑, 🔄
Mix	40	800	800	🕒, 👑, 🔄, 🌀
Bed Linen	40	1000	1000	🕒, 👑, 🔄, 🌀
20 °C	20	1000	1000	🕒, 👑
Baby Care	60	1000	1000	🕒, 👑, 🔄, 🌀
Drum Clean	90	--	--	🕒
Spin Only	--	1000	1000	🕒
Rinse & Spin	--	1000	1000	🕒, 👑
Wool	40	600	600	🕒, 👑
Intensive	40	800	800	🕒
ECO 40-60	--	1200	1300	🕒
Quick 15'	Cold	800	800	🕒

- 
Note!
- For the maximum spin speed, program time, and other details of the ECO 40-60 program, please refer to the content on the Product Fiche page.
 - The table shows which cycle offers which options for adjustment. If an adjustment is not possible for a cycle.

■ Option

Pre Wash	Pre Wash The Prewash function can get an extra wash before main wash, it is suitable for washing the dust rises to surface of the clothes; You need to put detergent into the Case (I) when select it.
Extra Rinse	Extra Rinse The laundry will undergo extra rinse once after you select it.
Delay	Delay Set the Delay function: <ol style="list-style-type: none">1. Select a programme2. Press the Delay button to choose the time (the delaying time is 0-24 H.)3. Press [Start/Pause] to commence the delay operation <div><div></div><div>></div><div></div><div>></div><div></div><div>Choose the Programme</div><div>Setting time</div><div>Start</div></div> <p>Cancel the Delay function: Press the [Delay] button until the display be 0H. It should be pressed before starting the programme. If the programme already started, should switch off programme to reset a new one.</p>
⚠ Caution! <ul style="list-style-type: none">• If there is any break in the power supply while the machine is operating, a special memory stores the selected programme and when the power is restarted, the program will continue.	
Temp.	Temp. Press the button to regulate the temperature (Cold, 20 °C, 30 °C, 40 °C, 60 °C, 90 °C)
Speed	Speed Press the button to change the speed. 1200: 0-400-600-800-1000-1200 1300: 0-400-600-800-1000-1200-1300
	SpaCare SpaCare function can be selected by choose "Cotton", "Mix", "Bed Linen" and "Baby Care". The customers can see the steam in the drum when operate SpaCare function.
	My Cycle To memory the frequently used programme. After choosing the programme and setting the options, press [Temp.] 3 sec. before start to wash. The default setting course is Cotton.



Child Lock

To avoid mis operation by children.



Choose the Programme



Start

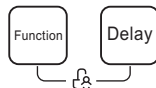

Press [Function.]
and [Delay] 3 sec. till
buzzer beep.



Caution!

- When the Child Lock is activated, the display will alternately show "CL" and the remaining time.
- Pressing any other button will cause the Child Lock indicator to flash for 3 sec.
When the program ends, "CL" and "END" will alternate on the display for 10 sec, then the indicator will flash for 3 sec.
- The Child Lock deactivates the function of all buttons except the On/Off button and the Child lock button!
- Only the simultaneous pressing of the two buttons [Function] and [Delay] can deactivate the Child Lock!
- Please deactivate the Child Lock before selecting a new program!



Mute the buzzer



Choose the
Programme



Press the [Speed]button for
3sec., the buzzer is mute.

To act the buzzer function, press the button again for 3 seconds. The setting will be kept until the next reset.



Caution!

- After Muting the buzzer function, the sounds will not be activated any more.



Note!

Usage counter

1. Unplug the equipment for 10s and reconnect again.
2. Power on and within 10s, please press " Temp." and "SpaCare" on control panel simultaneously and continuously for around 5s until the device display shows digits--the value can indicate the times of equipment usage.
3. Repeat step 1 again and customer can resume to normal operation.

PART 4: MAINTENANCE

■ Cleaning And Care



Warning!

- Before your maintenance starts, please unplug the machine and close the tap.

Cleaning the Cabinet

Proper maintenance on the washing machine can extend its working life. The surface can be cleaned with diluted non-abrasive neutral detergents when necessary. If there is any water overflow, use the wet cloth to wipe it off immediately.

No sharp items are allowed.



Note!

- Formic acid and its diluted solvents or equivalent are forbidden, such as alcohol, solvents or chemical products, etc.

Cleaning The Drum

The rusts left inside the drum by the metal articles shall be removed immediately with chlorine-free detergents.

Never use steel wool.



Note!

- Don't put laundry in the washing machine during the drum cleaning.

■ Cleaning The Inlet Filter

Note!

- Diminishing water flow is a sign that the filter need to be cleaned.

1. Close the tap and remove the water supply hose from it.
2. Clean the filter with a brush.
3. Unscrew the water supply hose from the backside of the machine. Pull out the filter with long nose pliers.
4. Use a brush to clean the filter.
5. Reinstall the filter to the water inlet and reconnect the water supply hose.
6. Clean the Inlet filter every 3 months to ensure the normal operation of the appliance.

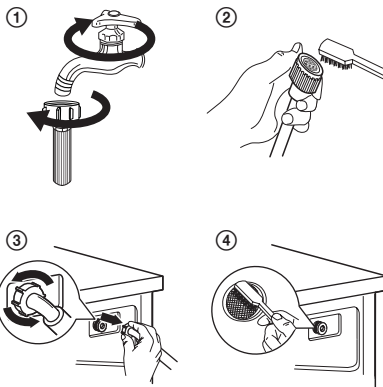

Clean The Detergent Dispenser

1. Press down the arrow location on softener cover inside the dispenser drawer.
2. Lift the clip up and take out softener cover and wash all grooves with water.
3. Restore the softener cover and push the drawer onto position.

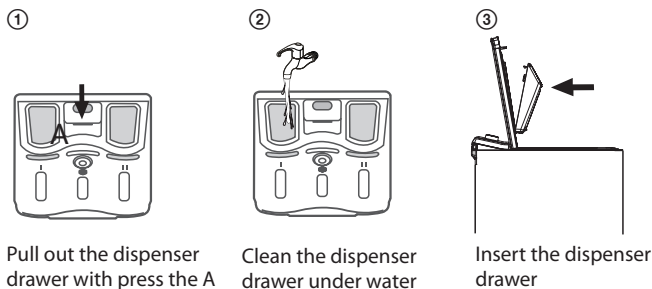

Note!

- Do not use abrasive or caustic agents to clean plastic parts.
- Clean the detergent dispenser every 3 months to ensure the normal operation of the appliance.

■ Cleaning The Drain Pump Filter

Warning!

- Make sure that the machine has finished the washing cycle and is empty. Switch it off and unplug it before cleaning the drain pump filter.
- Be careful of hot water. Allow the water to cool down. Risk of scalding!
- Clean the filter periodically every 3 months to ensure the normal operation of the appliance.

①

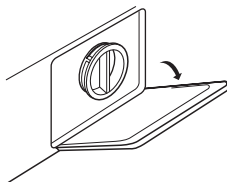

Open the lower cover cap

②

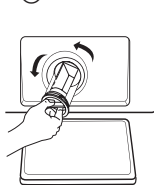

Open the filter by turning to the counter clockwise

③

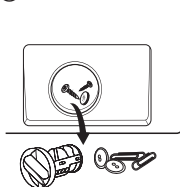

Remove extraneous matter

④

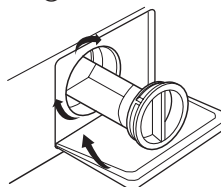

Close the lower cover cap

■ Trouble Shooting

Whenever there is a problem with the appliance, check if you can solve it following the tables below. If the problem persists, please contact the customer service.

Description	Reason	Solution
Washing machine cannot start up	Door is not closed properly	Restart after the door is closed Check if the clothes is stuck
Door can't be opened.	Washer's safety protection design is working	Disconnect the power, restart the product
Water leakage.	The connection between inlet pipe or outlet hose is not tight	Check and fasten water pipes Clean up outlet hose
Detergent residues in the box	Detergent is dampened or agglomerated	Clean and wipe the detergent box
Indicator or display does not work	Disconnect the power PC board or harness has connection problem	Check if the power is shut down and the power plug is connected correctly
Abnormal noise.		Check if the fixing (bolts) have been removed Check it's installed on a solid and level floor

LED display models:

Description	Possible cause	Solution
E30	Door is not closed properly	Restart after the door is closed Check if the clothes is stuck
E10	Water injecting problem while washing	Check if the water pressure is too low Straighten the water pipe Check if the inlet valve filter is blocked
E21	Overtime water draining	Check if the drain hose is blocked
E12	Water overflow	Restart the washer
EXX	Others.	Please try again first, call up service line if there are still troubles



Note!

- After the check, activate the appliance. If the problem occurs or the display shows other alarm codes again, contact the service.

■ Customer service

Spare part for your appliance are available for a minimum of 10 years.
In case of questions please contact our customer service at:

Warning!

Risk of electric shock

- Never try repair an appliance which is defective or presumed to be defective.
You may put your own and future users' lives in danger. Only authorised specialists are allowed to carry out this repair work.
- Improper repair will void the warranty and subsequent damages can't be recognised!

Transport

IMPORTANT STEPS WHEN MOVING THE APPLIANCE

- Unplug the appliance and close the water inlet tap.
- Check, if the door and the detergent dispenser are closed properly.
- Remove the water inlet pipe and the outlet hose from the house installations.
- Let the water drain completely from the appliance (see "Maintenance Cleaning the drain pump filter")
- Important: Re-install the 4 transport bolts in the back of the appliance.
- This appliance is heavy. Transport with care. Never hold any protruding part of the machine when lifting.
The machine door cannot be used as a handle.

■ Technical Specifications

Power Supply	220 - 240V ~ 50Hz
MAX. Current	10 A
Standard Water Pressure	0.1 MPa ~ 1MPa

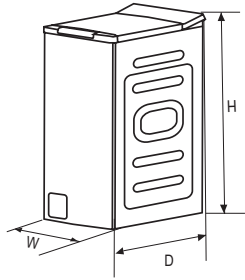

Model	Washing Capacity	Dimension (W*D*Hmm)	Net Weight	Rated Power
PLDI 127 BTL King	7.0kg	400*610*875	56kg	2000W
PLDI 138 BTL King	8.0kg	400*610*875	56kg	2000W

Product Information Sheet



COMMISSION DELEGATED REGULATION (EU) 2019/2014 with regard to energy labelling of household washing machines and household washer-dryers

Supplier's name or trademark: PHILCO

Supplier's address: FAST ČR, a.s., U Sanitasu 1621, Říčany 251 01, Czech Republic

Model identifier: PLDI 127 BTL King

General product parameters:

Parameter	Value		Parameter	Value	
Rated capacity (kg) ^(a)	7.0		Dimensions in mm	Height	88
				Width	40
				Depth	61
Energy Efficiency Index ^(a) (EEI _W)	59.6		Energy efficiency class ^(a)	B	
Washing efficiency index ^(a)	1.031		Rinsing effectiveness (g/kg) ^(a)	5.0	
Energy consumption in kWh per cycle, based on the eco 40-60 programme at a combination of full and partial loads. Actual energy consumption will depend on how the appliance is used.	0.514		Water consumption in litre per cycle, based on the eco 40-60 programme at a combination of full and partial loads. Actual water consumption will depend on how the appliance is used and on the hardness of the water.	45	
Maximum temperature inside the treated textile ^(a) (°C)	Rated capacity	39	Weighted remaining moisture content ^(a) (%)	62.9	
	Half	27			
	Quarter	22			
Spin speed ^(a) (rpm)	Rated capacity	1200	Spin-drying efficiency class ^(a)	C	
	Half	1200			
	Quarter	1200			
Programme duration(a) (h:min)	Rated capacity	3:28	Type	Free-standing	
	Half	2:42			
	Quarter	2:42			

Airborne acoustical noise emissions in the spinning phase ^(a) (dB(A) re 1 pW)	79	Airborne acoustical noise emission class ^(a) (spinning phase)	C
Off-mode (W) (if applicable)	0.5	Standby mode (W) (if applicable)	N/A
Delay start (W) (if applicable)	4.00	Networked standby (W) (if applicable)	N/A
Minimum duration of the guarantee offered by the supplier: 24 months			
This product has been designed to release silver ions during the washing cycle		No	
Additional information:			
Weblink to the supplier's website, where the information in point 9 of Annex II to Commission Regulation (EU) 2019/2023 is found: www.philco.cz			

^(a) for the eco 40-60 programme.

Product Information Sheet



COMMISSION DELEGATED REGULATION (EU) 2019/2014 with regard to energy labelling of household washing machines and household washer-dryers

Supplier's name or trademark: PHILCO

Supplier's address: FAST ČR, a.s., U Sanitasu 1621, Říčany 251 01, Czech Republic

Model identifier: PLDI 138 BTL King

General product parameters:

Parameter	Value		Parameter	Value	
Rated capacity (kg) ^(a)	8.0		Dimensions in mm	Height	88
				Width	40
				Depth	61
Energy Efficiency Index ^(a) (EEI _w)	59.8		Energy efficiency class ^(a)	B	
Washing efficiency index ^(a)	1.031		Rinsing effectiveness (g/kg) ^(a)	5.0	
Energy consumption in kWh per cycle, based on the eco 40-60 programme at a combination of full and partial loads. Actual energy consumption will depend on how the appliance is used.	0.544		Water consumption in litre per cycle, based on the eco 40-60 programme at a combination of full and partial loads. Actual water consumption will depend on how the appliance is used and on the hardness of the water.	48	
Maximum temperature inside the treated textile ^(a) (°C)	Rated capacity	41	Weighted remaining moisture content ^(a) (%)	53.9	
	Half	30			
	Quarter	22			
Spin speed(a) (rpm)	Rated capacity	1300	Spin-drying efficiency class ^(a)	B	
	Half	1300			
	Quarter	1300			
Programme duration(a) (h:min)	Rated capacity	3:38	Type	Free-standing	
	Half	2:48			
	Quarter	2:48			

Airborne acoustical noise emissions in the spinning phase ^(a) (dB(A) re 1 pW)	79	Airborne acoustical noise emission class ^(a) (spinning phase)	C
Off-mode (W) (if applicable)	0.5	Standby mode (W) (if applicable)	N/A
Delay start (W) (if applicable)	4.00	Networked standby (W) (if applicable)	N/A
Minimum duration of the guarantee offered by the supplier: 24 months			
This product has been designed to release silver ions during the washing cycle		No	
Additional information:			
Weblink to the supplier's website, where the information in point 9 of Annex II to Commission Regulation (EU) 2019/2023 is found: www.philco.cz			

^(a) for the eco 40-60 programme.

TECHNICAL INFORMATION

Technical information can be found on the type plate on the inside of the appliance and on the energy label. The QR code, on the supplied energy label, contains a link to register the appliance in the EU Eprel database. Keep the energy label, the instructions for use, together with other documents supplied with the device.

TESTING INFORMATION

Model PLDI 127 BTL King

The delivered device is in accordance with (EU) No 2019/2014; (EU) 2021/340 (EU) No 2019/2023; (EU) 2021/341 EN 60456:2016 + A11:2020. If you have any further questions, please contact the manufacturer.

Model PLDI 138 BTL King

The delivered device is in accordance with (EU) No 2019/2014; (EU) 2021/340 (EU) No 2019/2023; (EU) 2021/341 EN 60456:2016 + A11:2020. If you have any further questions, please contact the manufacturer.

CUSTOMER CARE AND SERVICE

Always use original spare parts.

Model name and serial number can be found on the rating plate. Position of rating plate can be changed without notice.

The original spare parts for some specific components are available for a minimum of 7 or 10 years, based on the type of component, from the placing on the market of the last unit of the model.

When contacting our authorized service, have the model designation, serial number and defect description available.

To download documents, visit www.philco.cz.

To report a defect and obtain additional service information, visit <https://philco.cz/podpora-a-servis>.

Subject to change without notice.

INSTRUCTIONS AND INFORMATION REGARDING THE DISPOSAL OF USED PACKAGING MATERIALS

Dispose of packaging material at a public waste disposal site.

DISPOSAL OF USED ELECTRICAL AND ELECTRONIC APPLIANCES



The meaning of the symbol on the product, its accessory or packaging indicates that this product shall not be treated as household waste. Please, dispose of this product at your applicable collection point for the recycling of electrical & electronic equipment waste. Alternatively in some states of the European Union or other European states you may return your products to your local retailer when buying an equivalent new product. The correct disposal of this product will help save valuable natural resources and help in preventing the potential negative impact on the environment and human health, which could be caused as a result of improper liquidation of waste. Please ask your local authorities or the nearest waste collection centre for further details. The improper disposal of this type of waste may fall subject to national regulations for fines.

For business entities in the European Union

If you wish to dispose of an electrical or electronic device, request the necessary information from your seller or supplier.

Disposal in other countries outside the European Union

If you wish to dispose of this product, request the necessary information about the correct disposal method from local government departments or from your seller.



This product meets all the basic EU regulation requirements that relate to it.

Changes to the text, design and technical specifications may occur without prior notice and we reserve the right to make these changes.

Original of this user manual is in czech language.

[illegible]

NOTES/POZNÁMKY

[illegible]

[illegible]

Výrobce/Manufacturer:
Fast ČR, a.s.
U Sanitasu 1621
Říčany 251 01, CZECH REPUBLIC

Distributor:
FAST PLUS, a.s.
Na pántoch 18
831 06 Bratislava, SLOVAKIA

PHILCO® 

is a pending or registered trademark of Electrolux Home Products, Inc. and used under a license from Electrolux Home Products, Inc.