

# Hot Air Brush

User's manual

EN



**SENCOR®**

SHS 108SL

Prior to using this product, please read the user's manual thoroughly, even in cases, when one has already familiarised themselves with previous use of similar types of products. Only use the product in the manner described in this user's manual. Keep the user's manual in a safe place where it can be easily retrieved for future use.

We recommend saving the original shipping cardboard box, packaging material, receipt and warranty card for the duration of warranty. In the case of transportation, pack the product using the original packaging materials only.

## CONTENTS

IMPORTANT SAFETY INSTRUCTIONS .....	3
DESCRIPTION OF THE HOT AIR BRUSH .....	5
INSTRUCTIONS FOR USE .....	6
MAINTENANCE AND CLEANING .....	6
TECHNICAL SPECIFICATIONS .....	6
INSTRUCTIONS AND INFORMATION REGARDING THE DISPOSAL OF USED PACKAGING MATERIALS ..	7
DISPOSAL OF USED ELECTRICAL AND ELECTRONIC APPLIANCES .....	7

## IMPORTANT SAFETY INSTRUCTIONS

This appliance may be used by children 8 years of age and older and by persons with physical or mental impairments or by inexperienced persons if they are properly supervised or have been informed about how to use of the product in a safe manner and understand the potential dangers. Children must not play with the appliance. Cleaning and maintenance performed by the user must not be performed by unsupervised children.

## IMPORTANT SAFETY INSTRUCTIONS

- Carefully unpack the product and take care not to throw away any part of the packaging before you find all the parts of the product.
- Before connecting this product to the socket outlet, make sure the voltage stated on the label of the product corresponds to the voltage in your wall socket.
- Never use accessories, which have not been supplied with this product or which are not designed for this product.
- Make sure that the electric cable and plug cannot get in contact with water or dampness.
- Do not spray the product with water or any other liquid. Do not submerge this product and any of its components in water, or any liquids.
- This product is designed for household use. Do not use it in industrial environment, or outdoors!
- Do not use sprays in the vicinity of the product.
- If you will not be using the product, disconnect it from the electrical grid. Before cleaning or moving proceed in the same manner.
- Do not place the product on or near an electrical or gas stove. Do not place the product near heat producing products such as fireplaces etc.
- Do not use the product if it has a damaged electric cable / electric cable plug.
- In no case should you attempt to repair the product yourself, do not make any amendments to it – danger of electric shock! Entrust all repairs and adjustments of this product to a specialised company/service. Failure to do so will expose you to a danger of voiding the warranty policy.
- In case the electric cord is damaged, have it replaced by an expert service. Do not use the product if it has a damaged power cord/plug.
- Do not place the power cord of the appliance near hot places or over sharp objects.  
Do not place heavy objects on the power cord, position the cord so that it is not stepped on, or tripped over. Make sure the power cable does not hang over the edge of a table, or that it does not touch a hot surface.
- Do not disconnect the product from the power point by pulling the electric cord – it may damage the electric cord / power point. Disconnect the cable from the power point by gently pulling the plug of the electric cable.
- Do not use the product for any other purposes than those intended.
- When using the appliance in the bathroom, disconnect it from the power source by pulling out the plug, because the vicinity of water presents a hazard even when the appliance is turned off.
- To insure additional safety, it is recommended to install an Residual Current Device (RCD) into the electric circuit to the bathroom with a maximum current rating of 30 mA. Ask a electrician for advice.
- The manufacturer takes no responsibility for damages caused by the incorrect use of this product and its accessories (injuries, burns, scalding, fire, food spoilage, etc.).



Do not use this appliance near baths, showers, washbasins or other containers containing water.

# Hot Air Brush

SHS 108SL

EN

## DESCRIPTION OF THE HOT AIR BRUSH

A

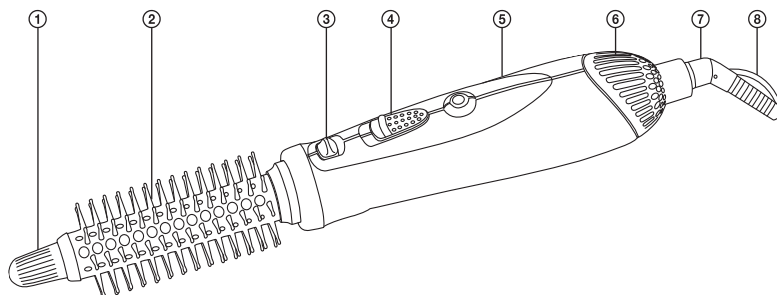

- ① Heat insulated end  
makes safe holding of the styling brush possible when curling hair
- ② Styling brush
- ③ Lock/unlock the brush  
for rotation in both directions to make it easier to release curled hair strands
- ④ Switch 0-1-2  
(off – half power – full power)
- ⑤ Handle
- ⑥ Air inflow openings
- ⑦ 360° swivel power cord end
- ⑧ Hanging loop

# Hot Air Brush

SHS 108SL

## INSTRUCTIONS FOR USE

- 1) Insert the power plug into an electrical power socket.
- 2) To turn on the hot air brush, move switch A④ to position 1 or 2.
- 3) The hot air brush will easily dry damp hair and form a hairstyle.  
To create a bulky hairstyle, brush the hair from the bottom along the individual hair strands from the roots all the way to the hair tips.  
To create a wavy hairstyle, proceed according to the following procedure. Separate a hair strand and place it against the styling brush A②. Rotate the hot air brush so that the hair strand winds up around the styling brush A② from the hair tips all the way to the roots. Keep the styling brush A② at a sufficient distance from the scalp so that hot air does not burn your skin. Hold the strands wound on for about 15 seconds and then unwind them. To make the releasing of the wound hair strand easier, unblock the styling brush by moving switch A③ in the opposite direction of the styling brush A②. As soon as you release switch A③, the rotation of the brush A② will again be blocked. Proceed to wind on more hair strands in the same way.



### Note:

To achieve the best results we recommend that the hot air brush is used on washed hair. After washing your hair, dry it thoroughly using a towel and comb it out. For a longer-lasting effect, set the hairstyle in place using a hair spray.

- 4) When you finish using the hot air brush, turn it off by moving switch A④ to position 0 (off) and disconnect it from the power socket.
- 5) Allow the hot air brush to cool down before putting it away.

## MAINTENANCE AND CLEANING

- Before cleaning, check that the hot air brush is disconnected from the el. power socket and that it has cooled down after use.
- Clean away hair from the styling brush A② and the air inflow openings A⑥ after each use.
- To clean the handle use a soft cloth slightly dipped in lukewarm water.
- Do not use abrasive cleaning products, solvents or thinners for cleaning.

## TECHNICAL SPECIFICATIONS

Nominal voltage.....	230 V
Nominal frequency.....	50/60 Hz
Input power .....	400 W
Safety class (with regard to electric shock protection) .....	II
Noise level.....	76 dB(A)

The declared noise emission level of the appliance is 76 dB(A), which represents a level A of acoustic power with respect to a reference acoustic power of 1 pW.

### Glossary of technical terms

Safety class for electric shock protection:

Class II – Electric shock protection is provided by double or heavy-duty insulation.

Amendments to text and technical parameters are reserved.

## INSTRUCTIONS AND INFORMATION REGARDING THE DISPOSAL OF USED PACKAGING MATERIALS

Dispose of packaging material at a public waste disposal site.

## DISPOSAL OF USED ELECTRICAL AND ELECTRONIC APPLIANCES



The meaning of the symbol on the product, its accessory or packaging indicates that this product shall not be treated as household waste. Please, dispose of this product at your applicable collection point for the recycling of electrical & electronic equipment waste. Alternatively in some states of the European Union or other European states you may return your products to your local retailer when buying an equivalent new product. The correct disposal of this product will help save valuable natural resources and help in preventing the potential negative impact on the environment and human health, which could be caused as a result of improper liquidation of waste. Please ask your local authorities or the nearest waste collection centre for further details. The improper disposal of this type of waste may fall subject to national regulations for fines.

### For business entities in the European Union

If you wish to dispose of an electrical or electronic device, request the necessary information from your seller or supplier.

### Disposal in other countries outside the European Union

If you wish to dispose of this product, request the necessary information about the correct disposal method from local government departments or from your seller.



This product meets all the basic EU regulation requirements that relate to it.

# Hot Air Brush

SHS 108SL