

# Hand Mixer

User's manual

EN



**SENCOR®**

SHM 5201WH

Prior to using this appliance, please read the user's manual thoroughly, even in cases where you have previously familiarised yourself with the operation of similar types of appliances. Only use the appliance in the manner described in this user's manual. Keep this manual for future use.

We recommend saving the original shipping cardboard box, packaging material, receipt and warranty card for the duration of the warranty. During transportation, pack the appliance using the original packaging materials only.

## CONTENTS

IMPORTANT SAFETY INSTRUCTIONS .....	3
DESCRIPTION OF THE APPLIANCE .....	5
OPERATING THE APPLIANCE .....	6
CLEANING AND MAINTENANCE .....	7
TECHNICAL INFORMATION .....	8
INSTRUCTIONS AND INFORMATION REGARDING THE DISPOSAL OF USED PACKAGING MATERIALS ..	8
DISPOSAL OF USED ELECTRICAL AND ELECTRONIC APPLIANCES .....	8

## IMPORTANT SAFETY INSTRUCTIONS

- This appliance may be used by children 8 years of age and older and by persons with physical or mental impairments or by inexperienced persons, if they are properly supervised or have been informed about how to use of the product in a safe manner and understand the potential dangers. Do not allow children to play with the appliance. Cleaning and maintenance must not be performed by children unless they are older than 8 years of age and under supervision.
- Keep this appliance and the power cord out of reach of children younger than 8 years of age.

## IMPORTANT SAFETY INSTRUCTIONS READ CAREFULLY AND STORE FOR FUTURE USE

- Before connecting this appliance to a power socket, make sure the voltage shown on the rating label of the appliance corresponds to the voltage in your power socket.



**Attention:** This appliance is not designed to be controlled using a programmed device, external timer switch or remote control.

- Never use accessories, which have not been supplied with this appliance or which have not been explicitly recommended by the manufacturer for this appliance.
- Do not place the appliance on window sills or on unstable surfaces. Always place the appliance on an even, dry surface.
- Make sure that the power cord and plug cannot come in contact with water or dampness.
- Do not spray the appliance with water or any other liquid.
- Never wash the motor unit under running water or submerge it in water or another liquid.
- The appliance is intended and designed for processing a standard amount of food in the household.
- Do not use the appliance for anything other than its intended purpose.
- Do not use the appliance in an industrial environment or outdoors!
- Do not use sprays in the vicinity of the appliance.
- Before first use, it is necessary to thoroughly wash the accessories (beater/kneading attachments) in hot water using kitchen detergent. Then rinse them with drinking water and dry thoroughly with a fine wiping cloth.
- Always turn off the appliance and disconnect it from the power socket if you will not be using it and if you are leaving it without supervision, before assembly, disassembly or cleaning.
- Before attaching the beater or kneading attachments to the appliance, removing or replacing them, ensure that the appliance is turned off and disconnected from the power socket.
- Always check that the beater or kneading attachments are properly attached before putting the appliance into operation.
- Do not touch the rotating attachments if the appliance is running.
- Do not put your hands or items, such as a kitchen knife, fork or wooden spoon, into the bowl while beating or kneading. An injury could occur or the appliance could be damaged.
- Allow hot liquids or food to cool down before processing them.
- When the beater or kneading attachments are properly attached to the appliance, first submerge them into the ingredients in the bowl and only then put the appliance into operation.
- The appliance must not run on no load. The incorrect use of the appliance may negatively affect its lifetime.
- Do not place the appliance on an electric or gas stove or in its vicinity, do not place it in the vicinity of an open fire or other equipment or appliances that are a source of heat.
- If the power cord is damaged, have it replaced at a professional service centre. It is forbidden to use the appliance if it has a damaged power cord/plug.
- In no case should you attempt to repair the appliance yourself, do not make any alterations to it – danger of injury by electric shock! Entrust all repairs and adjustments of this appliance to a specialised company/service. Tampering with the appliance during the warranty period may void the warranty policy.
- Do not place the power cord near hot places or over sharp objects. Do not place heavy objects on the power cord. Position the cord so that it will not be stepped on or tripped over. Make sure the power cord does not hang over the edge of a table and that it is not touching a hot surface.
- Do not disconnect the appliance from the power point by pulling the electric cord - it may damage the power cord/power socket. Disconnect the cable from the power socket by gently pulling the plug of the power cord.

# Hand Mixer

SHM 5201WH

EN

## DESCRIPTION OF THE APPLIANCE

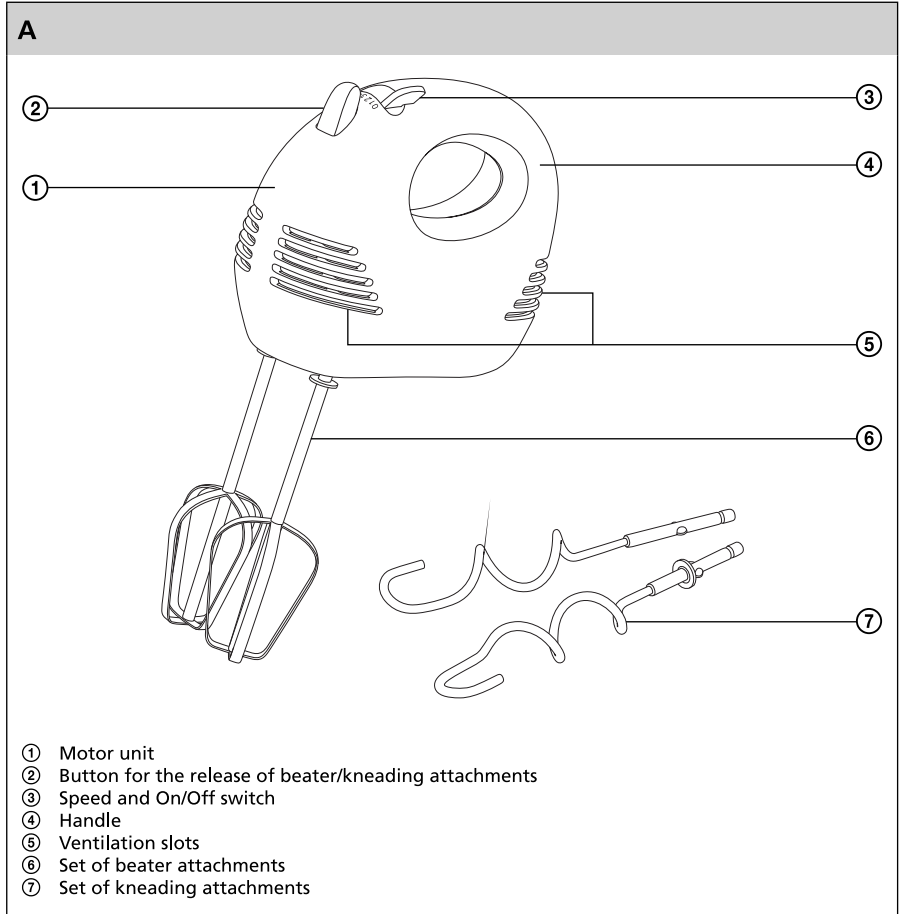

## OPERATING THE APPLIANCE

### 1. Using beater/kneading attachments

- 1.1 Insert the ends of the beater or kneading attachments into the holes on the underside of the appliance. Push them in until they safely click into position.

**Note:**

When attaching the kneading attachments it is necessary to follow the correct procedure. Place the kneading attachment with the ring into the left hole and the kneading attachment without the ring into the right hole.

**Attention:**

Do not combine the beaters and the kneading attachments.

- 1.2 Add the ingredients you wish to process into an appropriate container. Submerge the attachments into the container with the ingredients.
- 1.3 Insert the power cord into the electric power socket. Using the switch 3 set the desired speed in the range of 1–5.  
Note: We recommend starting beating/kneading at a lower speed. Later you can set a higher speed depending on requirements.
- 1.4 After finishing beating/kneading turn off the appliance by sliding the switch 3 to the 0 position. Disconnect the power cord from the el. power socket. To release the attachments press button 2 and remove the attachments.

**Note:**

if the switch 3 is in position 1–5, then button 2 is blocked and the attachment cannot be released.

**IMPORTANT NOTICES!**

**Beater/kneading attachments:** The appliance must be stopped for several minutes after it has been running continuously for 5 minutes. Maximum time of continuous operation is 10 minutes.

### Beater attachments

These are used to prepare batter dough, sponge cake dough, mashed potatoes, whipped cream, whipped egg whites and creams.

### Kneading attachments

These are used for kneading yeast dough, batter dough and dough for noodles, for mixing minced meat, spreads and puff dough.

### Selecting a speed for the beater/kneading attachments

- Level 1 – suitable as the initial speed for mixing a larger amount of food or dry ingredients such as flour, butter and potatoes
- Level 2 – suitable for processing liquid ingredients, for mixing salad dressings
- Level 3 – suitable for mixing ingredients when preparing cakes, biscuits and bread
- Level 4 – suitable for whipping up butter or sugar when preparing sweets, desserts, etc.
- Level 5 – suitable for whipping eggs, sauces, creams, etc.

# Hand Mixer

SHM 5201WH

EN

## Amount and processing time

Beater attachments	Amount	Processing time	Speed selection
Light sauces, creams and soups	approx. 750 ml	approx. 4 minutes	level 2
Mayonnaise	max. 3 egg yolks	approx. 3 minutes	level 5
Mashed potatoes	max. 750 g	max. 4 minutes	level 4
Whipped cream	max. 500 g	max. 5 minutes	level 5
Whipped egg whites	max. 5 egg whites	approx. 4 minutes	level 5
Cake dough	approx. 750 g	approx. 4 minutes	level 3

Kneading attachments	Amount	Processing time	Speed selection
Yeast dough	max. 500 g of flour	max. 5 minutes	level 3



### Note:

Initially beat at a low speed to prevent dough from splattering out. Only thereafter can you change to a higher speed. For easier beating and kneading of dough we recommended soft margarine or butter.

## CLEANING AND MAINTENANCE

- Always turn off the appliance before cleaning it by sliding the switch to position 0 and disconnecting it from the power socket.
- It is necessary to thoroughly clean the beaters or kneading attachments after every use in hot water and kitchen detergent. Then rinse them with drinking water and dry thoroughly with a fine wiping cloth. The beaters and kneading attachments are intended for short term contact with food (including beverages), i.e. max. 4 hours.
- Thoroughly clean the attachments after every use. After finishing mixing (without first disassembling and turning off the appliance) submerge the attachment into warm water and kitchen detergent. Set the speed switch to the highest 5th speed level to release food remains from the attachment. Then turn off the appliance and disconnect it from the power socket.
- To clean the motor unit, use a cloth dipped in a weak detergent solution. Never submerge the motor unit in water or in any other liquid!
- Do not use thinners or solvents or any abrasive cleaning agents to clean the appliance – they may damage the surface.

## TECHNICAL SPECIFICATIONS

Rated voltage .....	220–240 V
Rated frequency .....	50/60 Hz
Rated power input .....	150 W
Safety class (for electric shock protection) .....	II
Noise level .....	63 dB(A)

The declared noise emission level of the appliance is 63 dB(A), which represents a level A of acoustic power with respect to a reference acoustic power of 1 pW.

### Glossary of technical terms

#### Safety class for electric shock protection:

Class II - Electric shock protection is provided by double or heavy-duty insulation.

Due to continuous improvement of the appliance, the manufacturer reserves the right to make changes to the text, design and technical specifications without prior notice.

## INSTRUCTIONS AND INFORMATION REGARDING THE DISPOSAL OF USED PACKAGING MATERIALS

Dispose of packaging material at a public waste disposal site.

## DISPOSAL OF USED ELECTRICAL AND ELECTRONIC APPLIANCES



The meaning of the symbol on the product, its accessory or packaging indicates that this product shall not be treated as household waste. Please, dispose of this product at your applicable collection point for the recycling of electrical & electronic equipment waste. Alternatively in some states of the European Union or other European states you may return your products to your local retailer when buying an equivalent new product. The correct disposal of this product will help save valuable natural resources and help in preventing the potential negative impact on the environment and human health, which could be caused as a result of improper liquidation of waste. Please ask your local authorities or the nearest waste collection centre for further details. The improper disposal of this type of waste may fall subject to national regulations for fines.

#### For business entities in the European Union

If you wish to dispose of an electrical or electronic device, request the necessary information from your seller or supplier.

#### Disposal in other countries outside the European Union

If you wish to dispose of this product, request the necessary information about the correct disposal method from local government departments or from your seller.



This product meets all the basic EU regulation requirements that relate to it.