



### EN ■ Hand Blender

### READ CAREFULLY AND STORE FOR FUTURE USE.

- This appliance may be used by persons with physical or mental impairments or by inexperienced persons, if they are properly supervised or have been informed about how to use the appliance in a safe manner and understand the potential dangers.
- Children must not use this appliance or play with it. Keep this appliance and the power cord out of reach of children.
- Before connecting this appliance to a power socket, make sure the rated voltage stated on its rating label corresponds to the voltage in your power socket.
- The appliance is designed for household use only. It is not intended for use in locations such as:
  - staff kitchens in stores, offices and other workplaces;
  - hotel or motel rooms and other living areas;
  - agricultural farms;
  - bed and breakfast establishments.
- This appliance is designed for blending, chopping and whipping food. Do not use it to process foods that are too hard such as coffee beans, ice cubes, nutmeg, etc.
- Do not use the appliance in an industrial environment or outdoors. Do not use it for any other purposes than those intended.



### Warning:

Incorrect use may lead to injuries.

- Do not place the appliance on an electric or gas stove or in its vicinity, on the edge of a table or on an unstable surface. Only place the appliance on an even, dry and stable surface.
- Only use the appliance with the original accessories that came with it. The containers that are part of this appliance's accessories are not intended for heating food in a microwave oven.
- Make sure that the appliance is correctly assembled before putting it into operation.
- Do not touch moving rotating parts during operation. Otherwise, this could result in injury.
- Be especially careful when handling hot foods and liquids. Hot steam or splashing hot foods and liquids may cause scalding. Allow hot foods and liquids to cool down to at least 45 °C before blending.
- The operating time of the appliance is 1 minute. When using the appliance to hard foodstuffs, interrupt operation already after 15 seconds. Before turning it on again, allow it to cool down for at least 3 minutes. After three consecutive cycles, allow the appliance to cool down for 15 minutes.
- Do not turn on the appliance when it is empty. The incorrect use of the appliance may negatively affect its lifetime.
- Always turn off the appliance and disconnect it from the power socket if you will not be using it and if you will be leaving it without supervision, before assembly, disassembly, cleaning and before moving it.
- Check that the motor unit is turned off, disconnected from the power socket and that the rotating parts have come to a complete stop before disassembling the appliance into its individual parts.

- Clean it according to the instructions in chapter Cleaning and maintenance.
- When handling the blade assembly of the stick blender or chopper, especially when taking the blade assembly out of the bowl, when emptying the bowl and cleaning it, take special care to avoid injury by the blades.
- Do not submerge the motor unit and its power cord in water or any other liquid, or wash these parts under running water.
- Ensure that the power plug contacts do not come into contact with moisture. Do not place heavy items on the power cord. Make sure that the power cord does not hang over the edge of a table or that it is not touching a hot surface.
- Do not disconnect the appliance from the power socket by pulling on the power cord. This could damage the power cord or the socket. Disconnect the power cord from the power socket by pulling on the plug.
- If the power cord is damaged, it must be replaced by an authorised service centre or by another similarly qualified person, this will prevent the creation of a dangerous situation. It is forbidden to use the appliance if it has a damaged power cord.
- Do not use the appliance when it is not functioning properly or showing signs of damage.
- In order to prevent a hazardous situation arising, do not repair the appliance yourself or modify it in any way. Have all repairs performed at an authorised service centre. By tampering with the appliance, you risk voiding your legal rights arising from unsatisfactory performance or quality warranty.

**A**

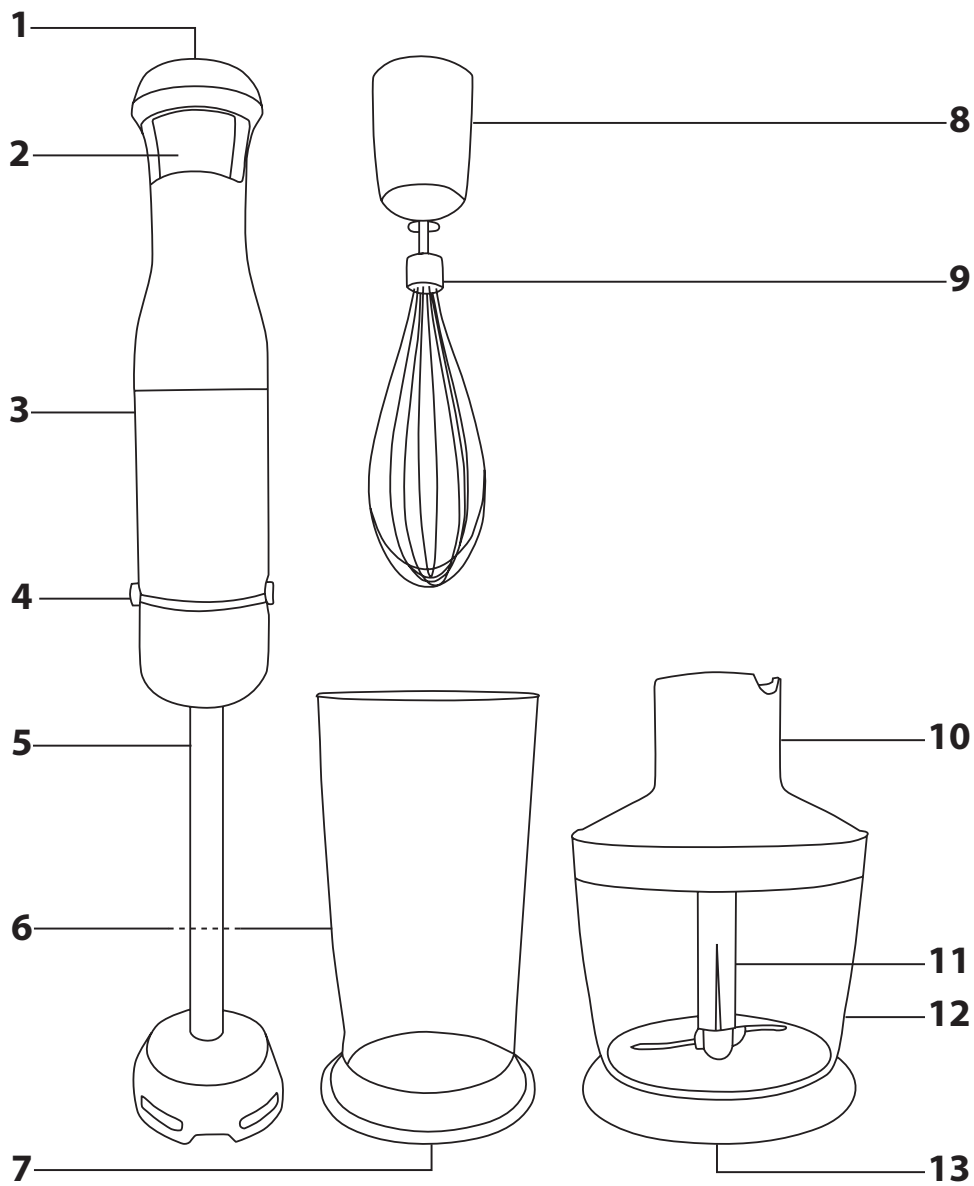

# EN Hand Blender

## User's manual

- Prior to using this appliance, please read the user's manual thoroughly, even in cases, when one has already familiarised themselves with previous use of similar types of appliances. Only use the appliance in the manner described in this user's manual. Keep this user's manual in a safe place where it can be easily retrieved for future use.
- We recommend saving the original cardboard box, packaging material, purchase receipt and responsibility statement of the vendor or warranty card for at least the duration of the legal liability for unsatisfactory performance or quality. In the event of transportation, we recommend that you pack the appliance in the original box from the manufacturer.

### DESCRIPTION OF THE APPLIANCE

<b>A1</b> Speed indicator lights	<b>A6</b> Beaker, volume 800 ml
<b>A2</b> Pulse switch with variable speed control	<b>A7</b> Anti-slip base pad for the beaker serves concurrently as lid for the beaker.
<b>A3</b> Motor unit	<b>A8</b> Whisk holder
<b>A4</b> Buttons (on both sides of the motor unit) serve to release removable accessories.	<b>A9</b> Whisk
<b>A5</b> Removable stick blender attachment	<b>A10</b> Chopper bowl lid
	<b>A11</b> Chopper blade assembly
	<b>A12</b> Chopper bowl, volume 500 ml
	<b>A13</b> Anti-slip feet

#### Note:

The appliance may be hung on an included wall-mounted holder. The mounting of the holder on to a wall requires the use of screws and dowels, which may not be included.

### BEFORE FIRST USE

1. Take the appliance and its accessories out of the packaging materials.
2. Thoroughly wash the removable accessories that are intended to come into contact with food using warm water and a neutral kitchen detergent. Then rinse them with clean water and allow them to dry naturally or dry them out thoroughly using a wiping cloth. Only clean parts **A8** and **A10** using a dampened cloth. Take care that water does not enter into these parts. When cleaning the removable attachment of the stick blender **A5**, do not submerge the top end that connects to the motor unit **A3**.
3. Do not rinse under water or submerge in water the motor unit **A3** and its power cord.



#### Attention:

When cleaning the blade assembly of the stick blender **A5** and chopper **A11**, be especially careful not to injure yourself on the blades.

### INTENDED USE OF THE APPLIANCE

#### Stick blender

- It is suitable for blending soft ingredients and liquids. It is used namely for preparing baby food, various types of cocktails, sauces, spreads, etc.

#### Chopper

- It is suitable for chopping foods such as meat, semi-hard or hard cheese, fruit and vegetables in their raw state, nuts, herbs, etc. Do not attempt to use it to process excessively hard foods such as ice cubes, coffee beans, nutmeg, cocoa beans.

#### Hand mixer

- After attaching the holder **A8** with the whisk **A9** to the motor unit **A3**, you may use the appliance as a hand mixer. A hand mixer is suitable for preparing light batters or for whipping cream, egg whites and creams. Do not use it to whip thick doughs.

### ASSEMBLING AND DISASSEMBLING THE APPLIANCE

- Before you start assembling or disassembling the appliance, check that the motor unit **A3** is turned off and disconnected from the power socket and that the rotating parts have come to a complete stop.

#### Stick blender

1. Attach the stick blender attachment **A5** from underneath to the motor unit **A3**. The connection of both parts is indicated by a click.
2. For blending, use the beaker **A6** or another suitable container intended for coming into contact with food. The anti-slip base pad **A7** also serves as a lid for the beaker **A6**, when you wish to use it for short term storage of food.
3. During disassembly, press and hold down the button **A4** and at the same time remove the stick blender attachment **A5**.

#### Chopper

1. Place the bowl **A12** on an even, dry and stable surface, and seat the blade assembly **A11** on to the central pin at the bottom of the bowl **A12**.
2. Close the bowl **A12** using the lid **A10**, whilst ensuring that the blade assembly shaft **A11** fits into the middle part of the lid **A10** and that the safety locks along the sides of the lid **A10** slide into the safety system of the bowl **A12**. Turn the lid **A10** clockwise all the way. This will secure it in place, and is indicated by a click.
3. Attach the motor unit **A3** to the lid **A10** and gently push it down until a click is heard. Now the chopper is assembled.

4. During disassembly, press and hold down the button **A4** and at the same time remove the motor unit **A3**. Then continue in reverse sequence to the assembly.

#### Hand mixer

1. Slide the whisk **A9**, into the holder **A8**, until it clicks in. Before use, always check that the whisk **A9** is securely attached.
2. Attach the holder **A8** with the whisk **A9** from underneath to the motor unit **A3**. Attachment is indicated by a click.
3. During disassembly, press and hold down the button **A4** and at the same time remove the holder **A8** with the whisk **A9**. Then continue in reverse sequence to the assembly.

### OPERATING THE APPLIANCE

1. Select the type of accessories that you wish to use and assemble the appliance according to the instructions in the chapter Assembling and disassembling the appliance.



#### Attention:

When assembling the chopper, place the food into the bowl **A12** only after placing the blade assembly **A11** on to the central pin at the bottom of the bowl **A12**. Do not fill the bowl **A12** over the maximum mark.

2. First cut the food that will be placed into the chopper bowl **A12** into small cubes measuring approximately  $2 \times 2$  cm. With vegetables like onion, it is sufficient to cut them into quarters.
3. Connect the motor unit **A3** to a power socket. Press the pulse switch **A2** to start the appliance. Regulate the speed by the pressing intensity on the pulse switch **A2**. The more you push the pulse switch **A2**, the faster it will run. The speed is signalled by indicator lights **A1**. The appliance will run as long as the power switch **A2** is pressed. When the button **A2** is released, the appliance will turn off. To prevent food from squirting out when using the stick blender or the whisks, hold the attachment submerged while the appliance is running.



#### Attention:

The maximum continuous operating time of the appliance is 1 minute. Then allow it to cool down for 3 minutes. When using the appliance to hard foodstuffs, interrupt operation already after 15 seconds. Then allow it to cool down for 1 minute. After three consecutive cycles, allow the appliance to cool down for 15 minutes.

4. After you finish using it, disconnect the power cord from the power socket. Make sure that the rotating parts have stopped rotating, and disassemble the appliance into its individual parts. Then clean all used parts according to the instructions in chapter Cleaning and maintenance.

### QUICK GUIDE TO PROCESSING INGREDIENTS

#### Stick blender

Ingredients	Amount	Speed setting	Processing time
Baby food	200 g	Medium to maximum	30 s
Spreads	200 g	Medium to maximum	20 s
Fruit and vegetables (cooked)	200 g	Medium to maximum	30 s
Sauces	500 ml	Medium to maximum	30 s
Shakes/Cocktails	500 ml	Medium to maximum	20 s

#### Chopper

Ingredients	Amount	Speed setting	Processing time
Meat	250 g	Medium to maximum	15 s
Fruit and vegetables	200 g	Medium to maximum	15 s
Hard and semi-hard cheeses	100 g	Maximum	10 s
Hard baked goods	80 g	Medium to maximum	15 s
Nuts with shells removed	150 g	Maximum	15 s
Herbs	50 g	Medium	10 s

- First, cut up the food into smaller cubes of approximately  $2 \times 2$  cm and only then process with the chopper. With vegetables like onion, it is sufficient to cut them into quarters.

#### Hand mixer

Ingredients	Amount	Speed setting	Processing time
Egg whites	4 pcs	Maximum	60 s
Whipping cream	200 ml	Maximum	60 s
Light doughs	500 g	Medium to maximum	60 s

- Whip cream and egg whites in a tall narrow beaker. When whipping egg whites, the whisk **A9** and the beaker must always be perfectly clean and dry, otherwise whipping up the egg whites may not succeed.

- The above food processing times are only a reference. The actual processing time depends on the size of the ingredients, their amount and the required final consistency. If the required consistency is not achieved during the maximum operating time of the appliance, you may continue processing the food after the appliance has cooled down.

### CLEANING AND MAINTENANCE

- Before cleaning it, make sure that the appliance is turned off, disconnected from the power socket and that the rotating parts have stopped.
- Disassemble the appliance into its individual parts. Thoroughly wash the used accessories using warm water and neutral kitchen detergent. Then rinse them with clean water and allow them to dry naturally or dry them out thoroughly using a wiping cloth. Only clean parts **A8** and **A10** using a dampened cloth. Take care that water does not enter into these parts. When cleaning the removable attachment of the stick blender **A5**, do not submerge the top end that connects to the motor unit **A3**. The beaker **A6** and bowl **A12**, the anti-slip base pad **A7**, the whisk **A9** and the blade assembly **A11** can be washed in a dishwasher. Other parts are not intended for washing in a dishwasher.
- After finishing using the stick blender, it is possible to clean the stick blender blade assembly **A5** by submerging it in warm water with kitchen detergent, and running it for a short time. Then disconnect the appliance from the power socket, disassemble it, and rinse the blade assembly with clean drinking water and dry it thoroughly.



**Attention:**  
When cleaning the blade assembly of the stick blender **A5** or the chopper **A11**, be especially careful not to injure yourself on the blades.

- To clean the outer surface of the motor unit **A3**, use a cloth lightly dampened in a weak detergent solution. After applying the detergent solution, wipe the surface with a cloth lightly dampened in clean water and then wipe dry.
- Never submerge the motor unit **A3** or the power cord in water or in any other liquid. Do not use solvents, cleaning products with an abrasive effect, etc. for cleaning the appliance. Otherwise the surface coat of the appliance may be damaged.

### STORAGE

- When not using the appliance, store it in a dry place out of children's reach.

### TECHNICAL SPECIFICATIONS

Rated voltage range .....	220–240 V
Rated frequency.....	50/60 Hz
Rated power input.....	800 W
Electrical shock protection class.....	II
Noise level .....	86 dB(A)

The declared noise emission level of the appliance is 86 dB(A), which represents a level A of acoustic power with respect to a reference acoustic power of 1 pW.

#### Explanation of technical terminology

Safety class for electrical shock protection:  
Class II – Electrical shock protection is provided by double or heavy-duty insulation.

Changes to text and technical parameters are reserved.

### INSTRUCTIONS AND INFORMATION REGARDING THE DISPOSAL OF USED PACKAGING MATERIALS

Dispose of used packaging material at a site designated for waste in your municipality.

### DISPOSAL OF USED ELECTRICAL AND ELECTRONIC EQUIPMENT



This symbol on products or original documents means that used electric or electronic products must not be added to ordinary municipal waste. For proper disposal, renewal and recycling hand over these appliances to determined collection points. Alternatively, in some European Union states or other European countries you may return your appliances to the local retailer when buying an equivalent new appliance.



Correct disposal of this product helps save valuable natural resources and prevents potential negative effects on the environment and human health, which could result from improper waste disposal. Ask your local authorities or collection facility for more details. In accordance with national regulations penalties may be imposed for the incorrect disposal of this type of waste.

#### For business entities in European Union states

If you want to dispose of electric or electronic appliances, ask your retailer or supplier for the necessary information.

#### Disposal in other countries outside the European Union.

This symbol is valid in the European Union. If you wish to dispose of this product, request the necessary information about the correct disposal method from the local council or from your retailer.



This product meets all the basic requirements of EU directives related to it.