



EN ■ Electric Coffee Grinder

READ CAREFULLY AND STORE FOR FUTURE USE.

- This appliance may be used by persons with physical or mental impairments or by inexperienced persons, if they are properly supervised or have been informed about how to use the appliance in a safe manner and understand the potential dangers. Children must not use this appliance or play with it. Keep this appliance and the power cord out of reach of children.
- This appliance is designed for household use only. It is not intended for use in locations such as:
 - staff kitchens in stores, offices and other workplaces;
 - hotel or motel rooms and other living areas;
 - agricultural farms;
 - bed and breakfast establishments.
- The appliance is designed for grinding coffee beans. Do not use it for other purposes.



Attention:

Incorrect use may lead to injuries.

- Do not use the appliance for commercial purposes, in industrial surroundings or outdoors. Do not place the appliance on an electric or gas stove, on the edge of a table, window sill, kitchen sink drainboard or on unstable surfaces. Only place it on an even, dry and stable surface.
- Before connecting the appliance to a power socket, check that the rated voltage on its rating label matches the electrical voltage in the power socket.
- Do not overfill the coffee bean hopper or fill it with ground or instant coffee, caramelised or otherwise specially modified coffee grains, cocoa beans or other ingredients or items. Otherwise, this could damage the appliance.
- Make sure that the appliance is properly assembled before putting it into operation.
- Make sure that during its operation, no parts of clothing, hair, kitchen utensils or other items enter the coffee bean hopper. The hopper must always be properly closed.
- Regularly check the filled level of the ground coffee hopper. Do not go over the designated maximum mark.
- To prevent the appliance from overheating, allow it to cool down for approximately 10 minutes after 2 minutes of operation.

- Always turn off the appliance and disconnect it from the power socket when not using it and when leaving it without supervision, before assembly, disassembly or cleaning.
- Keep the appliance clean. When cleaning it, follow the instructions in chapter Cleaning and maintenance.
- Do not wash the appliance under running water or submerge it in water or another liquid.
- Do not place heavy items on the power cord. Make sure that the power cord does not hang over the edge of a table or that it is not touching a hot surface, and that its plug does not come into contact with water or moisture.
- Disconnect the appliance from the power socket by pulling on the plug, never pulling on the power cord. Otherwise, this could damage the power cord or the socket.
- If the power cord is damaged, it must be replaced by an authorised service centre or by another similarly qualified person, this will prevent the creation of a dangerous situation. It is forbidden to use the appliance if it has a damaged power cord.
- Do not use the appliance when it is not functioning properly or showing signs of damage.
- In order to prevent a hazardous situation arising, do not repair the appliance yourself or modify it in any way. Have all repairs performed at an authorised service centre. By tampering with the appliance, you risk voiding your legal rights arising from unsatisfactory performance or quality warranty.

A

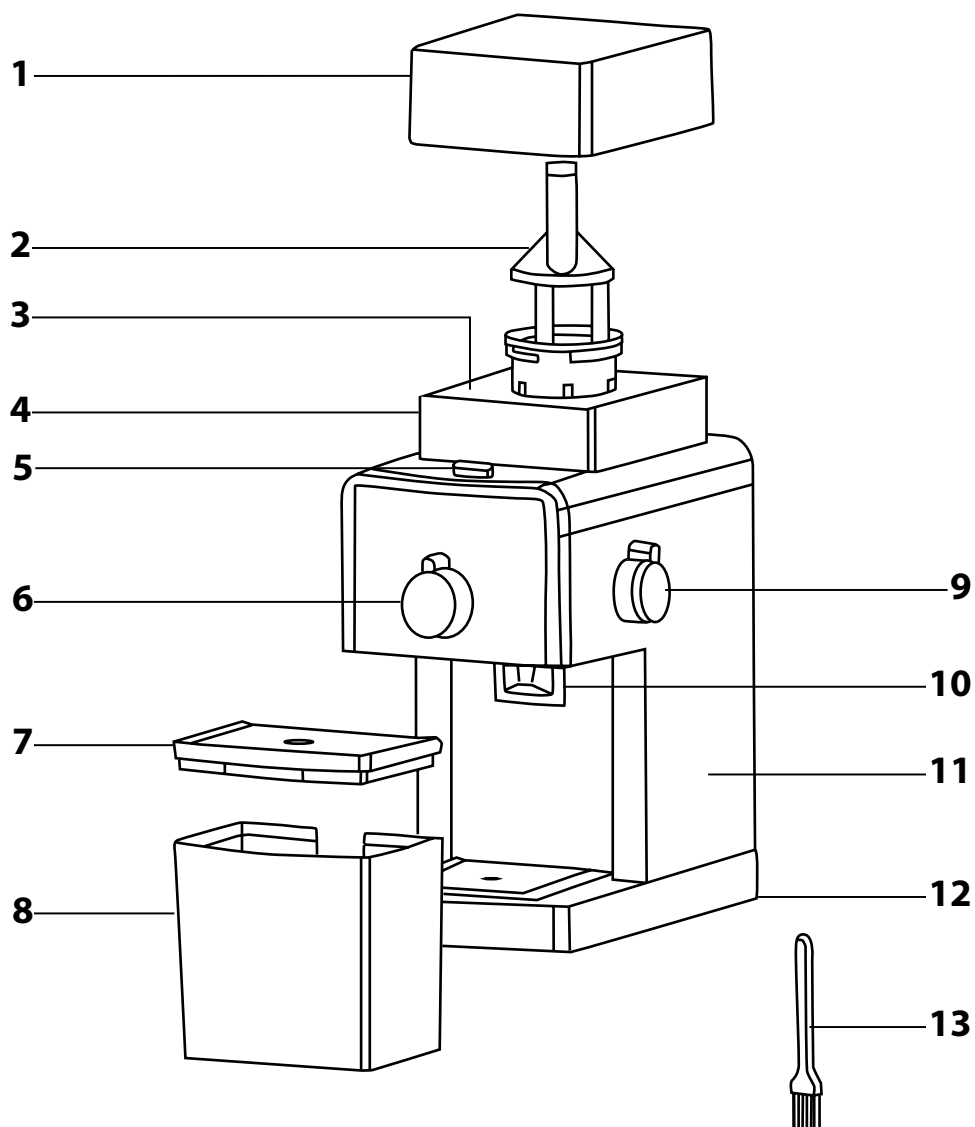

Electric Coffee Grinder

User's manual

- Prior to using this appliance, please read the user's manual thoroughly, even in cases, when one has already familiarised themselves with previous use of similar types of appliances. Only use the appliance in the manner described in this user's manual. Keep this user's manual in a safe place where it can be easily retrieved for future reference.
- We recommend saving the original cardboard box, packaging material, purchase receipt and responsibility statement of the vendor or warranty card for at least the duration of the legal liability for unsatisfactory performance or quality. In the event of transportation, we recommend that you pack the appliance in the original box from the manufacturer.

DESCRIPTION OF THE APPLIANCE

- A1** Coffee bean hopper lid
- A2** Removable top part of the grinder
- A3** Grinding mechanism with burrs from hardened steel
- A4** Coffee bean hopper with capacity for approximately 180 g of coffee beans
- A5** On/Off Button
- A6** Regulator of amount of ground coffee from 2 to 12 cups enables setting the amount of ground coffee according to number of cups.
- A7** Ground coffee container lid
- A8** Ground coffee container with capacity for 100 g of ground coffee
- A9** Grinding fineness regulator enables the selection of 17 grinding fineness levels.
- A10** Ground coffee dispenser
- A11** Body
- A12** Anti-slip feet
- A13** Cleaning brush

BEFORE FIRST USE

- Remove all packaging materials and promotional tags and labels from the appliance and its accessories.
- Wipe the coffee bean hopper area **A4** using a clean, lightly dampened cloth and then wipe thoroughly dry.
- Rinse the ground coffee container **A8** and lid **A1** and **A7** with warm water with the addition of a small amount of neutral kitchen detergent. Then rinse these parts under clean running water, dry them thoroughly and put them back in their place.



Note:

The ground coffee container **A8** and lid **A1** and **A7** can also be washed in the top rack of a dishwasher.

- Never wash the appliance under running water or submerge it in water or another liquid.

OPERATING THE APPLIANCE

- Make sure that the appliance is disconnected from the power socket. Remove the lid **A1** from the hopper **A4** and make sure that it does not contain any foreign objects. Fill the hopper **A4** with roasted coffee beans and close the lid **A1**. To prevent the coffee beans from losing their aroma and for safety reasons, do not leave it open.



Attention:

The coffee bean hopper **A4** has a maximum capacity of approximately 180 g of coffee beans. Do not overfill it past the maximum mark.

Never fill the coffee bean hopper **A4** with ground or instant coffee, caramelised or otherwise specially modified coffee beans, cocoa beans or other items. Otherwise, this could damage the appliance.

- Close the container **A8** using the lid **A7** and insert it into the body of the appliance **A11** so that it properly fits into place. For safety reasons, it will not be possible to start the appliance unless the container **A8** is properly installed in its place.
- Fully unwind the power cord and connect it to a power socket. Use the regulator **A6** to select the desired amount of ground coffee based on the number of coffee cups that you will be brewing. Use the regulator **A9** to set the desired grinding fineness. For first use, we recommend that you set the middle grinding fineness. Upon further use, adjust the grinding fineness as required. Turning the regulator **A9** clockwise sets a coarser grind, and turning it in the opposite direction sets a finer grind.
- Start the appliance by pressing button **A5**. When the selected amount of coffee has been ground, the appliance will turn off automatically. If you want to end it sooner, press button **A5** again.
- In the event that coffee beans jam inside the grinding mechanism **A3**, start the grinder by pressing button **A5** and while it is running, set the regulator **A9** to the coarsest grinding setting. This should dislodge the jammed coffee beans.
- When you have finished, take out the container **A8** with the ground coffee. Empty it out and then you can prepare another batch of ground coffee in the same way. To prevent the appliance from overheating, allow it to cool down for 10 minutes after 2 minutes of operation.
- When you have finished using it, disconnect the appliance from the power socket and clean it out according to the instructions contained in the chapter Cleaning and maintenance.

RECOMMENDATIONS FOR PURCHASING AND STORING COFFEE

- To shorten the storage time, purchase coffee beans in smaller packages.
- Use fresh roasted coffee beans with a marked roasting date and consume them within 3 weeks of the roasting date.
- Store coffee beans in a cool, dark and dry location, ideally in an air-tight container.
- We recommend grind the coffee beans immediately prior to brewing the coffee beverage. Coffee that is ground in advance loses its flavour and aroma.

RECOMMENDED COFFEE GRINDING FINENESS

- This appliance is equipped with a 17 level regulation to enable the grinding fineness to be adjusted to various coffee brewing methods. When the ground coffee is used in espresso type machines, select a finer grinding level. For brewing percolated coffee, select a coarser grind.
- When the ground coffee is used in espresso type machines, and coffee flows out too slowly and its taste is too bitter, it may mean that the coffee beans have been ground too finely and it is necessary to set a coarser grind. On the other hand, if the brewed coffee is flowing out too fast and its taste is bland, it may mean that the coffee grains are too coarsely ground and it is necessary to set a finer grind.

CLEANING AND MAINTENANCE

- To ensure that the appliance runs properly, it is very important to clean it regularly. Before cleaning, it is necessary to ensure that the inside of the hopper **A4** is empty. If there are coffee bean remaining inside after use, run the appliance until it grinds the remaining coffee beans. It is necessary to heed all safety instructions during operation.
- Before you start cleaning the appliance, turn it off and disconnect it from the power socket.
- Empty the ground coffee container **A8** and wash it in warm water with the addition of a small amount of neutral kitchen detergent. Then rinse it under running water and dry thoroughly. In the same way, clean lid **A1** and **A7**, if soiled.



Note:

The ground coffee container **A8** and lid **A1** and **A7** can also be washed in the top rack of a dishwasher.

- To remove the top part of the grinder **A2**, set the regulator **A9** to the finest grinding setting, then turn the top part of the grinder **A2** clockwise all the way and lift it up. After removing the top part of the grinder **A2**, remove and coffee bean remains and thoroughly clean out the inside of the hopper **A4** using a lightly dampened cloth. Then wipe everything so that it is thoroughly dry. To clean out the top part of the grinder **A2** and the grinding burrs **A3**, use the included brush **A13**. After putting the top part of the grinder **A2** back in its place, set the regulator **A9** to the coarsest grinding setting, then insert the top part of the grinder **A2** back in its place and turn it anticlockwise all the way.
- To clean the dispenser **A10** and the body **A11** use a dry or a lightly dampened cloth. Then wipe everything so that it is thoroughly dry and assemble the clean appliance.
- Do not use steel wool, abrasive cleaning agents, solvents, etc. to clean the appliance.
- Do not rinse or submerge the appliance or its power cord in water or any other liquids.

STORAGE

- When not using the appliance, store it in a dry place out of children's reach. To prevent dust from accumulating inside the appliance, store it assembled.

TECHNICAL SPECIFICATIONS

Rated voltage range	220–240 V
Rated frequency	50/60 Hz
Rated power input	110 W
Noise level	88 dB(A)

The declared noise emission level of the appliance is 88 dB(A), which represents a level A of acoustic power with respect to a reference acoustic power of 1 pW.

Changes to text and technical parameters are reserved.

INSTRUCTIONS AND INFORMATION REGARDING THE DISPOSAL OF USED PACKAGING MATERIALS

Dispose of used packaging material at a site designated for waste in your municipality.

DISPOSAL OF USED ELECTRICAL AND ELECTRONIC EQUIPMENT



This symbol on products or original documents means that used electric or electronic products must not be added to ordinary municipal waste. For proper disposal, renewal and recycling hand over these appliances to determined collection points. Alternatively, in some European Union states or other European countries you may return your appliances to the local retailer when buying an equivalent new appliance.

Correct disposal of this product helps save valuable natural resources and prevents potential negative effects on the environment and human health, which could result from improper waste disposal. Ask your local authorities or collection facility for more details. In accordance with national regulations penalties may be imposed for the incorrect disposal of this type of waste.

For business entities in European Union states

If you want to dispose of electric or electronic appliances, ask your retailer or supplier for the necessary information.

Disposal in other countries outside the European Union.

This symbol is valid in the European Union. If you wish to dispose of this product, request the necessary information about the correct disposal method from the local council or from your retailer.



This product meets all the basic requirements of EU directives related to it.