

# Desktop Fan

User's manual

EN



**SENCOR®**

SFE 2327WH

Prior to using this appliance, please read the user's manual thoroughly, even in cases, when one has already familiarised themselves with previous use of similar types of products. Use the appliance only as described in this manual. Keep this manual for later use.

We recommend saving the original shipping cardboard box, packaging material, receipt and warranty card for the duration of warranty. In the event of shipping, pack the appliance using the original packaging materials only.

EN-1

**CONTENTS**

IMPORTANT SAFETY INSTRUCTIONS .....	3
DESCRIPTION OF THE FAN .....	5
ASSEMBLING THE FAN .....	6
OPERATING THE FAN .....	6
CLEANING AND MAINTENANCE .....	7
TECHNICAL SPECIFICATIONS .....	7
INSTRUCTIONS AND INFORMATION REGARDING THE DISPOSAL OF USED PACKAGING MATERIALS ...	8
DISPOSAL OF USED ELECTRICAL AND ELECTRONIC APPLIANCES .....	8

## **IMPORTANT SAFETY INSTRUCTIONS**

### **READ CAREFULLY AND STORE THESE INSTRUCTIONS FOR FUTURE USE.**

- This appliance may be used by children 8 years of age and older and by persons with physical or mental impairments or by inexperienced persons if they are properly supervised or have been informed about how to use of the product in a safe manner and understand the potential dangers.
- Do not allow children to play with the appliance.
- Cleaning and maintenance performed by the user must not be performed by unsupervised children.
- Before connecting the appliance to a power socket, check that the technical details on the rating label of the appliance match the electrical voltage in the socket.
- To prevent the appliance from overheating, do not cover it with any items.
- The appliance is designed for use in households, offices and similar types of areas.
- Do not use the appliance in very dusty or humid rooms such as laundries or bathrooms, in areas where chemicals are stored, in industrial surroundings or outdoors!
- Do not place the appliance in the vicinity of an open flame or appliances that are sources of heat.
- Always place the appliance on an even, dry and stable surface.

- Do not submerge the appliance in water or in any other liquid.
- Do not insert any items though the protective grill. An electrical short circuit could occur, a fire might start or the appliance may be damaged.
- Always turn off the appliance and disconnect it from the power socket if you will not be using it and before moving, cleaning, disassembling or assembling it.
- Do not disconnect the appliance from the power socket by pulling on the power cord. This could damage the power cord or the socket. Disconnect the cord from the power socket by gently pulling the plug of the power cord.
- Make sure the power cord does not hang over the edge of a table and that it is not touching a hot surface.
- It is forbidden to use the appliance if it has a damaged power cord or plug. In the event that the power cord is damaged, it must be replaced by an authorised service centre or by a similarly qualified person, this will prevent the creation of a dangerous situation.
- Do not use the appliance if it is not working correctly, if it has been damaged or has been submerged in water. To avoid the danger of injury by electrical shock, do not repair the appliance yourself or make any adjustments to it. Have all repairs or adjustments of the appliance performed at an authorised service centre. Tampering with the appliance during the warranty period may void the warranty policy.

# Desktop Fan

SFE 2327WH

EN

## DESCRIPTION OF THE FAN

A

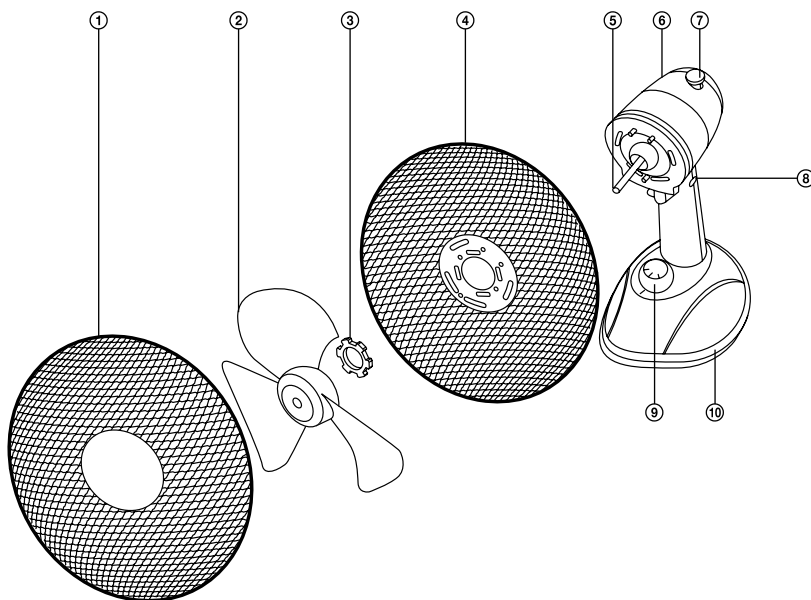

- ① Front protective grill
- ② Fan blades
- ③ Nut for fastening the rear protective grill
- ④ Rear protective grill
- ⑤ Motor shaft
- ⑥ Motor unit
- ⑦ Switch for activating and deactivating oscillation
- ⑧ Locking nut for securing the set tilt angle of the motor unit
- ⑨ Power off and fan speed dial  
(0 – off, 1 – low speed, 2 – high speed)
- ⑩ Stand

## ASSEMBLING THE FAN

- Place the stand A⑩ on an level, dry and stable surface. Screw the nut A③ out of the motor unit A⑥.
- Seat the rear protective grill A④ on to the motor shaft A⑤ in such a way that the fan carrying handle attached to the rear grill A④ points upwards. Push the rear grill A④ towards the motor unit A⑥ ensuring the lugs on the front part of the motor unit A⑥ pass through the holes in the central part of the rear grill A④. Use the nut A③ to secure the grill A④ to the motor unit A⑥.
- On to the motor shaft A⑤ place the fan blades A② and push them fully in the direction of the motor unit A⑥.
- On the outer band of the protective grill A① there are three fastening clamps, a hook and a screw hole. Release the clamps and hold the grill A① in such a way that the hook is located on the top part of the grill A①. Place the front grill A① against the back grill A④ in such a way that the outer band of the grill A④ fits into the hooks on the outer band of grill A①. Check that the outer bands and the screw holes overlap. Fold down the clamps to fasten the outer bands together. For safety reasons secure the outer band connection using the supplied screw and nut. If during the assembly of the fan you proceeded according to the above instructions, the screw holes are found in the bottom part of the outer band.
- The fan is now assembled and ready for use.

## OPERATING THE FAN

- Connect the fan to a power socket.
- 1) **Setting the speed and turning off the fan**  
Turn the dial A⑨ to position 1 to set the fan to low speed. Turn the dial A⑨ to position 2 to set the fan to high speed. Turn the dial A⑨ to position 0 to turn off the fan.
  - 2) **Activating and deactivating oscillation**  
If the fan is running, push switch A⑦ downwards to activate the oscillation of the motor unit A⑥. The motor unit A⑥ will oscillate horizontally. To deactivate the oscillation pull switch A⑦ upwards.
  - 3) **Setting the vertical tilt of the motor unit**  
Before setting the vertical tilt of the motor unit A⑥, first turn off the fan by turning the dial A⑨ to position 0 (off). Release the fastening screw A⑧ by turning it anticlockwise. Set the motor unit A⑥ at the desired vertical tilt angle. Secure the set tilt of the motor unit A⑥ by turning the fastening screw A⑧ in the clockwise direction.



### Note:

The motor unit A⑥ may only be tilted in a limited range. Do not use force to set the tilt angle of the motor unit A⑥.

- If you will not be using the fan, turn it off according to the instructions contained in paragraph "Setting the speed and turning off the fan" and disconnect it from the power socket.

## CLEANING AND MAINTENANCE

- Keep the fan clean. Before cleaning, turn the fan off and disconnect the power cord from the power socket. Do not disassemble the fan.
- To clean the outer surface of the fan, use a clean, lightly dampened cloth. Then wipe everything so that it is thoroughly dry. Take care not to allow water to enter the motor unit A⑥ or the control unit on the stand A⑩ when cleaning.
- Do not use abrasive cleaning products, petrol, solvents, etc. for cleaning.
- If you will not be using the fan for a longer period of time, store it in a clean, dry location that is out of reach of children.

## TECHNICAL SPECIFICATIONS

Nominal voltage range .....	220–240 V
Nominal frequency.....	50 Hz
Rated power input.....	30 W
Safety class (for electric shock protection) .....	II
Noise level.....	50 dB(A)
Fan blade diameter .....	23 cm
Maximum fan flow rate .....	15.5 m³/min
Service value.....	0.68 (m³/min)/W
Maximum air velocity.....	2.86 m/s
Measurement standard for service value .....	IEC 60879:1986, EN 50564:2011, EN 60704-2-7:1998, EN 60704-1:2010
Contact details for obtaining more information.....	FAST ČR, a. s., Černokostelecká 1621, 251 01 Říčany, Czech Republic

The declared noise emission level of the appliance is 50 dB(A), which represents a level A of acoustic power with respect to a reference acoustic power of 1 pW.

### Glossary of technical terms

Safety class for electric shock protection:

Class II – Electric shock protection is provided by double or heavy-duty insulation.

We reserve the right to change the text and technical specifications.

## INSTRUCTIONS AND INFORMATION REGARDING THE DISPOSAL OF USED PACKAGING MATERIALS

Dispose of packaging material at a public waste disposal site.

## DISPOSAL OF USED ELECTRICAL AND ELECTRONIC APPLIANCES



The meaning of the symbol on the product, its accessory or packaging indicates that this product shall not be treated as household waste. Please, dispose of this product at your applicable collection point for the recycling of electrical & electronic equipment waste. Alternatively in some states of the European Union or other European states you may return your products to your local retailer when buying an equivalent new product. The correct disposal of this product will help save valuable natural resources and help in preventing the potential negative impact on the environment and human health, which could be caused as a result of improper liquidation of waste. Please ask your local authorities or the nearest waste collection centre for further details. The improper disposal of this type of waste may fall subject to national regulations for fines.

### For business entities in the European Union

If you wish to dispose of an electrical or electronic device, request the necessary information from your seller or supplier.

### Disposal in other countries outside the European Union

If you wish to dispose of this product, request the necessary information about the correct disposal method from local government departments or from your seller.



This product meets all the basic EU regulation requirements that relate to it.