



## EN ■ Semi-Automatic Espresso Machine

### READ CAREFULLY AND STORE FOR FUTURE USE.

- This appliance may be used by children 8 years of age and older and by persons with physical or mental impairments or by inexperienced persons, if they are properly supervised or have been informed about how to use the product in a safe manner and understand the potential dangers.
- Children must not play with the appliance. Cleaning and maintenance performed by the user must not be performed by unsupervised children.
- If the power cord is damaged, have it replaced at a professional service centre or by a similarly qualified person, this will prevent the creation of a dangerous situation. It is forbidden to use the appliance if it has a damaged power cord.
- This appliance is designed for household use only. It is not intended for use in locations such as:
  - staff kitchens in stores, offices and other workplaces;
  - hotel or motel rooms and other living areas;
  - agricultural farms;
  - bed and breakfast establishments.
- Do not submerge the appliance, the power cord or the power plug in water or in any other liquid.



**WARNING: The water tank lid must not be opened during use.**

- Prevent the power cord and power plug from coming into contact with water or another liquid.
- Use the appliance according to the instructions in the user's manual. Otherwise, injuries, damage to the appliance or a dangerous situation may result.



**Attention: Hot surface.**

- As a result of residual heat, accessible surfaces of the appliance are hot during its use and afterwards. Do not touch hot surfaces.
- Before connecting the appliance to a power socket, check that the rated voltage on its rating label matches the electrical voltage in the power socket.
- Connect the appliance only to a properly grounded socket. For safety reasons, we do not recommend using multi-socket adapters or extension cords.
- Do not place the appliance on window sills, kitchen sink drainboards or unstable surfaces. Always place it on a stable, even and dry surface.
- Do not place the appliance on or near an electrical or gas stove, or in the vicinity of an open flame.
- Never use the appliance in the near vicinity of a bath, shower or swimming pool.
- Use the appliance only for the purposes for which it was designed.
- Only use the appliance with the original accessories that came with it.
- To ensure sufficient air circulation, free space of at least 15 cm must be maintained around and above the appliance when it is running.
- Only use the top surface of the appliance for warming cups. Do not use it as a storage rack.
- Fill the water tank with clean cold water. Do not pour hot water or other liquids into it or place any items inside it.
- Before turning on the appliance, check that:
  - the drip tray together with the grate is installed in position;
  - the water tank is filled with a sufficient amount of water and is properly installed in position. The water level must not exceed the maximum mark.
- Before you begin brewing coffee, check that the portafilter is properly attached to the brew head. Pressure is created in the portafilter during the coffee steaming process, so do not move it while it is running. Otherwise, this could result in a dangerous situation.



**Attention: Incorrect use may lead to injuries.**

- When operating the appliance, be especially careful to avoid scalding by boiling water or steam.

- Regularly inspect the water level in the water tank when using the appliance. When the water level falls below the minimum water level mark, add water. Before adding water, first turn the appliance off and disconnect it from the power socket.
- To protect the pump from damage, the appliance is equipped with a built-in thermal fuse that will disengage it when it runs empty. In the event that such a situation occurs, disconnect the power cord from the power socket and allow the appliance to cool down for at least 30 minutes. Then you may continue using it.
- Always turn off the appliance and disconnect it from the power socket when not using it, when leaving it without supervision, before disassembling or assembling it, before filling up the water tank, and before moving or cleaning it. Allow the appliance to cool down before cleaning or moving it. Do not move the appliance with a coffee cup located on the drip tray grate or with cups located on the cup warming surface.
- Keep the appliance and its accessories in clean condition. Clean and maintain it according to the instructions in chapter Cleaning and maintenance. Never wash the appliance under running water or submerge it in water or another liquid.
- Make sure that the power cord does not come into contact with a hot surface and prevent the power plug from coming into contact with water.
- Disconnect the appliance from the power socket by pulling on the plug, never pulling on the power cord. Otherwise, this could damage the power cord or the socket.
- To avoid the danger of injury by electrical shock, do not repair the appliance yourself or make any adjustments to it. Have all repairs or adjustments performed at an authorised service centre. By tampering with the appliance, you risk voiding your legal rights arising from unsatisfactory performance or quality warranty.

A

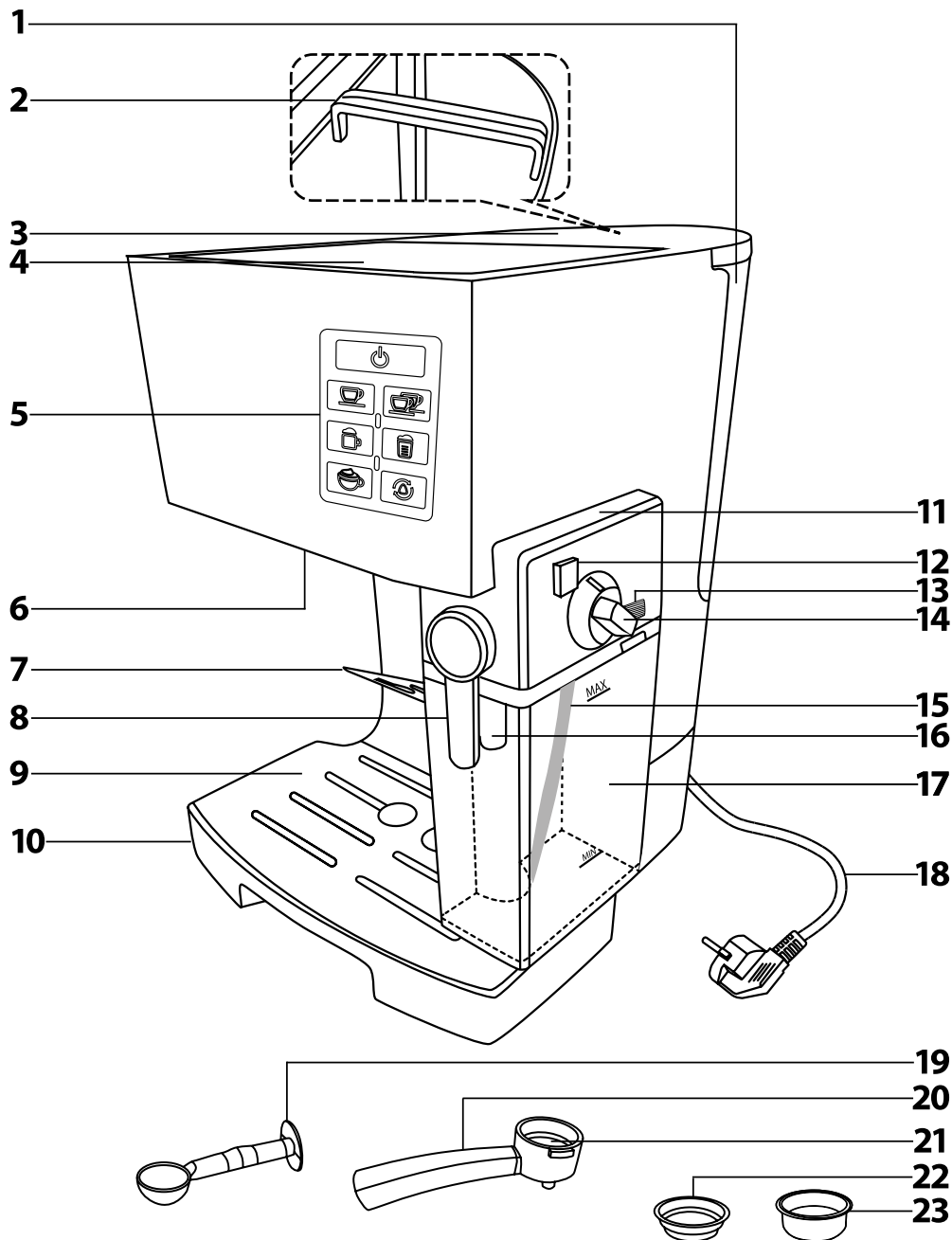

**B**

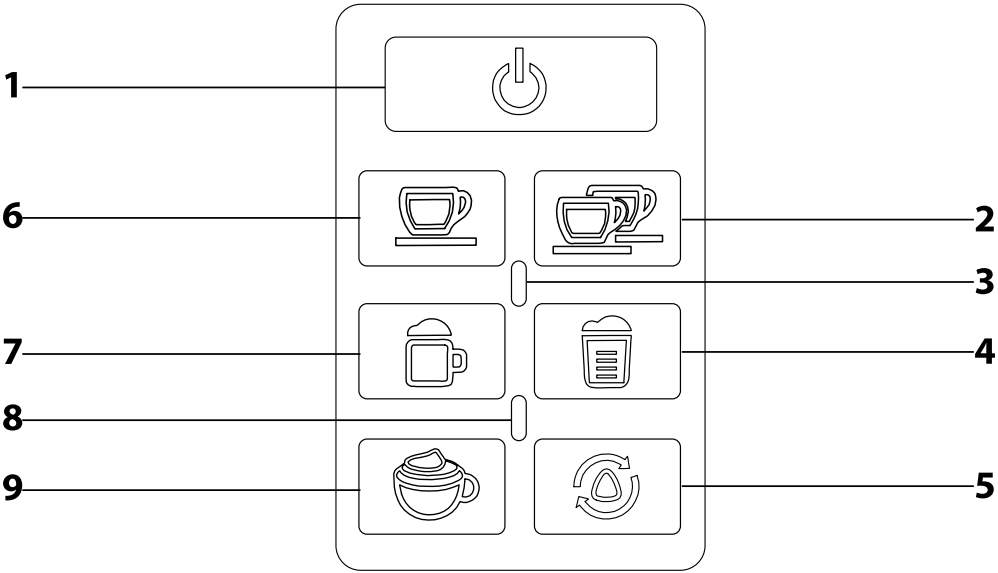

# EN Semi-Automatic Espresso Machine

## User's manual

- Prior to using this appliance, please read the user's manual thoroughly, even in cases, when one has already familiarised themselves with previous use of similar types of appliances. Only use the appliance in the manner described in this user's manual. Keep this user's manual in a safe place where it can be easily retrieved for future use.
- We recommend saving the original cardboard box, packaging material, purchase receipt and responsibility statement of the vendor or warranty card for at least the duration of the legal liability for unsatisfactory performance or quality. In the event of transportation, we recommend that you pack the appliance in the original box from the manufacturer.

### DESCRIPTION OF THE APPLIANCE

<b>A1</b> 1.4-litre removable water tank	<b>A12</b> Milk tank removal button
<b>A2</b> Water tank handle	<b>A13</b> Milk frothing setting knob
<b>A3</b> Water tank lid	<b>A14</b> Water tank lid release button
<b>A4</b> Cup warming surface	<b>A15</b> Milk hose
<b>A5</b> Control panel	<b>A16</b> Milk nozzle
<b>A6</b> Brew head	<b>A17</b> Milk tank
<b>A7</b> Folding tray	<b>A18</b> Power cord
<b>A8</b> Milk nozzle lever	<b>A19</b> Coffee measuring cup with tamper
<b>A9</b> Removable drip tray grate	<b>A20</b> Portafilter with coffee spout
<b>A10</b> Removable drip tray	<b>A21</b> Filter compartment
<b>A11</b> Milk tank lid with control elements	<b>A22</b> Stainless steel filter for brewing 1 cup
	<b>A23</b> Stainless steel filter for brewing 2 cups

### DESCRIPTION OF THE CONTROL PANEL

<b>B1</b> On/Off button	<b>B6</b> One-cup brew button
<b>B2</b> Two-cup brew button	<b>B7</b> Cappuccino brew button
<b>B3</b> Red indicator light	<b>B8</b> Yellow indicator light
<b>B4</b> Latte macchiato brew button	<b>B9</b> Milk frothing button
<b>B5</b> Automatic cleaning button	

### BEFORE FIRST USE

- Before first use, take the appliance and its accessories out of the packaging material and remove all promotional labels and stickers from it. Check that neither the appliance nor any of its parts is damaged.
- Place the appliance on an even, dry and clean surface. Wipe the outer surface of the appliance with a lightly dampened sponge and then wipe it dry.
- Take the water tank **A1** and the milk tank **A17** out of the appliance and rinse them out with clean water with the addition of a small amount of neutral dishwashing detergent. Then thoroughly rinse them out using clean water, dry them and put them back in their place. Wipe the lid water tank lid **A11** with a clean soft sponge lightly dampened in warm water.
- Take out the removable drip tray **A10** with grate **A9**, wipe with a dampened textile, wipe dry and insert it back into the bottom part of the appliance.
- Wash the portafilter **A20**, coffee measuring cup **A19** and the stainless steel filters **A22** and **A23** under clean running water with an addition of kitchen detergent. Then rinse with clean water and wipe dry.
- Prior to brewing the first cup of coffee, run the appliance empty for approximately 60 seconds, i.e. with the water tank **A1** filled with water but without coffee tampered in the filter. This will clean out the inner components and the brew head **A6**. A sufficiently large container must be placed underneath the portafilter **A20** for the hot water to flow into. Instructions for starting the appliance are provided in chapter Operating the appliance.



#### Note:

You may see a small amount of smoke when it is used for the first time. This is normal.

### OPERATING THE APPLIANCE

#### Inserting the drip tray

- The drip tray **A10** with grate **A9** catch drops of brewed coffee when the portafilter is removed, or hot water released from the milk frothing boiler, they also prevent coffee from burning and also catch any milk spilt during the frothing process. Therefore, make sure that both parts are correctly installed and inserted in the appliance. Insert or remove the drip tray **A10** and grate **A9** only when the milk tank **A17** is not installed.
- We recommend to empty out and wash the drip tray **A10** after every use. When cleaning, follow the instructions in chapter Cleaning and maintenance.



#### Note:

The drip tray **A10** has a full level indicator. This consists of 2 red tabs. As soon as the liquid level in the drip tray **A10** reaches their top, it is necessary to empty out the drip tray **A10**.

#### Filling the water tank

- Open the water tank lid **A3**. Grasp the tank by the handle **A2** and pull it upwards to remove it. Fill it up with cold drinking water up to the maximum level mark, insert it back in and tilt the handle **A2** down into the tank. Then, close the water tank lid **A3**. The water tank must be securely seated in place in order for water to be pumped out of it into the boiler.



#### Note:

The water that you pour into the water tank should ideally be at room temperature (approximately 25 °C). Water that is too cold, could negatively affect the final taste of the coffee beverage.

Do not leave any remaining water in the water tank for longer than one day. For brewing quality fresh coffee, it is necessary to use fresh water. Otherwise, the resulting flavour of the coffee beverage may be negatively affected.



#### Attention:

The water tank has a maximum capacity of 1.4 litres of water. Do not overflow it. Never fill the water tank with warm water, hot water or sparkling water, or liquids such as milk, etc. Do not fill the water tank when it is inserted in the appliance. There is a danger of splashing the appliance or overflowing the water tank.

#### Filling the milk tank

- To remove the milk tank **A17**, hold down the removal button **A12** and pull the milk tank **A17** away from the appliance.
- In order to open and remove the lid **A11**, hold down the lid release button **A14** and tilt open the lid **A11** from the milk tank **A17**.
- Pour fresh, cold milk into the milk tank **A17** no higher than the MAX. mark. Always fill to between the maximum and minimum level marks.
- The lid **A11** can only be put on in one way. Seat the side of the lid **A11** with the milk nozzle **A16** on to the side of the tank **A12** with the cut-out for the nozzle **A16** and tilt down the lid. Correct placement is indicated by a click. Check that the lid **A11** is not moving and does not extend past the edge of the tank **A17**.
- Insert the milk tank **A17** with the attached lid **A11** into the appliance from the side until you hear a click. Check that the milk tank **A17** with lid **A11** is correctly inserted and is not moving in any way.



#### Note:

In the event that you do not use up all the milk, it is necessary to pour it out of the tank **A17** into a suitable container and to store it in a refrigerator. Then thoroughly clean the milk tank **A17** according to the instructions in chapter "Cleaning and maintenance".

#### Inserting and removing the filters

- Place the selected stainless steel filter into the filter compartment **A21** and push it in firmly.
- To remove the filter from the portafilter, use your nail or a thin object (e.g. table knife) inserted between the edge of the filter and the edge of the portafilter.

#### Filling the filters with coffee

- Place the portafilter **A20** on to an even surface and pour the corresponding amount of ground coffee into the filter. The one-cup coffee filter **A22** is filled with a single level measuring cup **A19** of coffee. The two-cup coffee filter **A23** is filled with double the amount of coffee. One level measuring cup **A19** is equivalent to approx. 7 g of ground coffee. Spread the coffee out evenly inside the filter and gently tamp it down with the flat end of the measuring cup **A19**.
- Thoroughly clean ground coffee remains from the edges of the filter **A22** or **A23**.



#### Note:

Only use ground coffee intended for use in espresso machines.

Do not use ground coffee intended for use in a French press, percolator, etc.

#### Inserting and removing the portafilter

- Insert the portafilter **A20** underneath the brew head **A6** so that the handle points to the left and is aligned with the ☞ symbol on the brew head **A6**. To fasten the portafilter **A20** to the brew head **A6**, turn the handle to the right to the position marked with the ☞ symbol.
- To remove the portafilter **A20** from the brew head **A6**, turn the handle to the left to the ☞ symbol. Remove it from the brew head **A6** and move it above a rubbish bin. Turn the portafilter **A20** so that the filter with the spent coffee points downwards. Use a teaspoon to remove the coffee grounds. Avoid coming into contact with the surface of the filter or portafilter as they may still be hot. Prior to removing the filter from the portafilter, cool it down under cold running water. Then rinse the filter and the portafilter under clean running water and dry them thoroughly.

#### Warming the cups

- As soon as the appliance is turned on using button **B1**, the cup warming surface **A4** will automatically start to heat up. Place empty coffee cups upside down on to surface **A4** and allow them to warm up.

#### Turning the appliance on and off

- Turn the appliance on by pressing the On/Off button **B1**. The control panel **A5** will flash while the appliance heats up to operating temperature. Press button **B1** again to turn off the appliance.
- In the event that the appliance is turned on for the first time, place a bowl underneath the brew head **A6** and press any button except for **B1**. A pump will turn on and pump water from the water tank **A1** into the boiler. Some water may pour out of the brew head. This is normal. As soon as the control panel **A5** stops flashing, the appliance is ready for use.



#### Note:

The appliance will turn off automatically after 30 minutes of inactivity or after continuous use of the milk nozzle, or when the pump runs non-stop for 3 minutes in the coffee brewing mode.

### BREWING COFFEE

- The appliance is supplied with 2 stainless steel filters: filter for brewing 1 cup of coffee **A22** and a filter for brewing 2 cups of coffee **A23**.
- The stainless steel filter for brewing 1 cup **A22** is suitable for brewing 1 espresso, a standard cappuccino or latte macchiato.
- The stainless steel filter for brewing 2 cups **A23** is suitable for brewing a double espresso, 2 espressos, a strong cappuccino or latte macchiato.

## A. Brewing an espresso

1. Fill up the water tank **A1** with cold clean water.
2. Insert the plug on the power cord into a power socket and press the On / Off button **B1** to turn on the appliance. The control panel **A5** will flash and the appliance will start heating up to operating temperature.
3. While the appliance is heating up, insert the stainless steel filter **A22** or **A23** into the portafilter **A20**. Fill the filter with a sufficient amount of freshly ground coffee.
4. Once the appliance has heated up (control panel **A5** stops flashing), insert the portafilter **A20** into the brew head **A6**.
5. Depending on the type of filter inserted in the portafilter, place one or two cups on to the grate **A9** underneath the spouts in the portafilter.
6. Press the one-cup brew button **B6** (the filter for one cup **A22** is in the portafilter) or the two-cup brew button **B2** (the filter for two cups **A23** is in the portafilter).
7. A sound is made, the pressed button will start flashing and the coffee pouring process will start. As soon as the programmed amount of coffee is poured into the cup / cups, the coffee pouring process will stop and a sound will be made and the pressed button will stop flashing.
8. Remove the portafilter **A20** from the brew head **A6** and remove the coffee grounds from the filter. Wash the filter and the portafilter, rinse under cold water and dry.



### Note:

The pump will make a noise during the coffee pouring process. This is normal.  
In order to comfortably also use small cups for brewing espresso, the appliance has a folding tray **A7**. Tilt out the tray **A7** and put the cup on it.

## Programming the coffee volume

1. Perform steps 1–5 in chapter “A. Brewing an espresso.”
2. Hold down the one-cup brew button **B6** (the filter for one cup **A22** is in the portafilter) or the two-cup brew button **B2** (the filter for two cups **A23** is in the portafilter) until you hear two consecutive sounds.
3. Keep holding down the button, the coffee pouring process will start. As soon as the desired amount of coffee pours into the cup / cups, release the pressed button. Three sounds will be made. The new coffee volume will be stored in the appliance's memory.

## B. Brewing cappuccino / latté macchiato

1. Fill up tank **A1** with cold clean water.
2. Fill up tank **A17** with fresh cold milk.
3. Insert the plug on the power cord into a power socket and press the On / Off button **B1** to turn on the appliance. The control panel **A5** will flash and the appliance will start heating up to operating temperature.
4. While the appliance is heating up, insert the stainless steel filter **A22** or **A23** into the portafilter **A20**. Fill the filter with a sufficient amount of freshly ground coffee.
5. Once the appliance has heated up (control panel **A5** stops flashing), insert the portafilter **A20** into the brew head **A6**.
6. Turn the milk nozzle lever **A8** to the left to tilt out the milk nozzle **A16**.
7. Using knob **A13**, adjust the milk frothing settings.
8. Place the cup on to the grate **A9** in such a way that it is located underneath the spouts in the portafilter **A20** as well as underneath the milk nozzle **A16**.
9. Press the cappuccino brew button **B7** or the latté macchiato brew button **B4**.
10. A sound is made, the pressed button will start flashing and the milk frothing and pouring process will start. As soon as the require amount of heated milk pours into the cup, the coffee pouring process will start automatically.
11. As soon as the programmed amount of milk and coffee is poured into the cup / cups, the pouring process will stop and a sound will be made and the pressed button will stop flashing.
12. Remove the portafilter **A20** from the brew head **A6** and remove the coffee grounds from the filter. Wash the filter and the portafilter, rinse under cold water and dry.

## Programming the coffee and milk volume

The programming of coffee and milk needs to be performed in 2 steps. First it is necessary to program the milk volume and then the coffee volume. Perform steps 1–8 in chapter “A. Brewing a cappuccino / latté macchiato.”

### 1. step: Programming the milk volume

- Proceed according to the instructions in chapter “Programming the milk volume.”

### 2. step: Programming the coffee volume

- As soon as the desired amount of milk is poured into the cup, hold down the cappuccino brew button **B7** or the latté macchiato brew button **B4** until you hear two consecutive sounds.
- Keep holding down the button, the coffee pouring process will start. As soon as the desired amount of coffee pours into the cup, release the pressed button. Three sounds will be made. The new coffee volume will be stored in the appliance's memory.

## Frothing milk

1. Fill up tank **A1** with cold clean water.
2. Fill up tank **A17** with fresh cold milk.
3. Insert the plug on the power cord into a power socket and press the On / Off button **B1** to turn on the appliance. The control panel **A5** will flash and the appliance will start heating up to operating temperature.
4. Turn the milk nozzle lever **A8** to the left to tilt out the milk nozzle **A16**.
5. Using knob **A13**, adjust the milk frothing settings.
6. Place a cup underneath the milk nozzle **A16**.
7. As soon as the appliance has warmed up (the control panel **A5** stops flashing), press the milk frothing button **B9**. A sound is made, the pressed button will start flashing, the milk frothing process will start and the preset amount of frothed milk will pour into the cup.
8. As soon as the frothing process is finished, the pouring process will stop and a sound will be made and the pressed button will stop flashing.

## Programming the milk volume

1. Perform steps 1–6 in chapter “A. Frothing milk.”
2. Hold down the milk frothing button **B9** until you hear two consecutive sounds.
3. Keep holding down the button, the hot milk and frothed milk will start pouring out. As soon as the desired amount of hot milk and frothed milk pours into the cup, release the pressed button. A sound is made. The new milk volume will be stored in the appliance's memory.

## Setting milk frothing

- Using the knob **A13**, you can adjust the ratio between the amount of hot milk and frothed milk.
- If you wish to have more frothed milk, turn the knob **A13** to the right.
- If you wish to have more hot milk, turn the knob **A13** to the left.



### Note:

To achieve optimal results, we recommend the use of fresh full-cream or half-cream milk that is properly cooled.



### Note:

In the event that you need to immediately stop the coffee or milk pouring process, press the same button with which you started the coffee or milk pouring process.

## RESTORING FACTORY SETTINGS

In the event that you need to restore factory settings, proceed as follows:

1. Turn off the appliance by pressing button **B1**.
2. Simultaneously hold down buttons **B2** and **B6**.
3. While holding down these buttons, press button **B1** again, the control panel **A5** will flash 5x and a sound will be made 5x.
4. Release the pressed buttons. The factory settings are now restored.



### Note:

Restore factory settings will delete all the settings performed by you and restore them to those set in the factory.

## CLEANING AND MAINTENANCE

- Prior to cleaning the appliance, turn it off by pressing button **B1**, disconnect it from the power socket and allow it to cool down.
- For cleaning, do not use cleaning products with an abrasive effect, solvents, etc. that could damage the appliance. No part of this appliance is intended for washing in a dishwasher.

## Cleaning the filters, portafilter and brew head

- Release the portafilter **A20** by turning the handle to the left. Remove it from the brew head **A6** and move it above a rubbish bin. Turn the portafilter **A20** so that the filter with the spent coffee points downwards. Use a teaspoon to remove the coffee grounds. Avoid coming into contact with the surface of the filter or portafilter as they may still be hot. Prior to removing the filter from the portafilter, cool it down under cold running water. Then rinse the filter and the portafilter under clean running water and dry them thoroughly.
- If you used coffee that was ground too finely, then the holes in the filter may have become clogged. To clean them out, use a thin needle.
- Remove ground coffee remains from the brew head using a damp wiping cloth.



### Note:

It is necessary to wash the milk tank **A17**, filters **A22** and **A23** and the portafilter **A20** after every use. If they are too dirty, wash them in warm water with a small amount of neutral cleaning agent using a soft sponge. Then thoroughly rinse and allow to dry.  
To remove milk residues from the milk hose **A15** in the milk tank **A17**, rinse the nozzle with clean warm water. It is important to clean the milk hose **A15** after every use.

### Attention:

The brew head remains hot after use due to residual heat. Allow it to cool down before cleaning it.



## Cleaning the drip tray and grate

- The drip tray **A10** and grate **A9** need to be emptied and washed every time the appliance is used.
- First remove the grate **A9** from the drip tray **A10** and then remove the water from it. Wash the drip tray **A10** and the grate **A9** in warm water with neutral kitchen detergent. Then rinse both parts under running water, wipe dry and return to their place.

### Attention:

Water in the drip tray **A10** may be hot. Pay increased attention to avoid getting scalded when removing water from the drip tray.



## Cleaning the water tank

- Pour any water out of the tank **A1** and rinse it out under running cold water. In the event that the tank **A1** is dirty, wash it in warm water with neutral kitchen detergent. Rinse under running water, wipe dry and put it back in its place.



Cleaning the outer case

- Wipe the outer surface of the appliance using a lightly dampened sponge and wipe dry.

Automatic cleaning

A. Rapid cleaning of the milk tank and the milk frothing system

It is important to perform rapid cleaning of the milk tank **A17** and the milk frothing system after every use in order to remove any milk residues and to prevent to formation of bacteria, moulds and unpleasant odours. Check that the appliance is turned off and proceed as follows:

- Pour water into the milk tank up to the maximum mark.
- Turn the milk nozzle lever **A8** to the left to tilt out the milk nozzle **A16**.
- To turn on the appliance, press the On/Off button **B1**. The appliance will start heating itself up. During this time the control panel will flash.
- Place a sufficiently large cup or bowl underneath the milk nozzle **A16**.
- As soon as the appliance has warmed up (the control panel **A5** stops flashing), press the automatic wash button **B5**. A sound will be made and the button **B5** will start flashing.
- Allow the appliance to finish the program and, after it has finished, pour out the contents of the cup or bowl. If necessary, repeat the entire process.

B. Thorough cleaning of the portafilter and the milk frothing system

During this cleaning process the milk frothing system and the portafilter **A20**, or also the filters **A22** or **A23** if inserted, are cleaned. Thanks to the thorough cleaning process, you will also remove coffee and coffee oil residues. Check that the appliance is turned off and proceed as follows:

- Pour clean cold water into the water tank up to the maximum mark.
- Pour water into the milk tank up to the maximum mark.
- Turn the milk nozzle lever **A8** to the left to tilt out the milk nozzle **A16**.
- To turn on the appliance, press the On/Off button **B1**. The appliance will start heating itself up. During this time the control panel will flash.
- Insert the portafilter **A20** with an empty filter **A22** or **A23** into the brew head **A6**.
- Place a sufficiently large cup or bowl underneath the coffee spout and milk nozzle.
- As soon as the appliance has warmed up (the control panel **A5** stops flashing), hold down the automatic wash button **B5** for approximately 5 seconds. A sound will be made and the button **B5** will start flashing.
- Allow the appliance to finish the program and, after it has finished, pour out the contents of the cup or bowl. If necessary, repeat the entire process.



Note:

In the event that you need to cancel the self cleaning process, press button **B5**. The appliance will switch to the stand-by mode.

Removing limescale deposits

- It is necessary to regularly remove limescale deposits from the appliance. Limescale deposits may negatively affect the quality of the brewed coffee and the lifetime of the appliance.
- The appliance is able to self-determine when it is necessary to remove accumulated limescale deposits, in which case the yellow indicator light **B7** will be lit. The yellow indicator light **B7** will remain lit until the limescale removal process is performed.
- To remove limescale deposits, use an 8% solution of white vinegar and water (recommended dilution ratio of 1:2). Instead of the water and vinegar solution, it is possible to use citric acid or a limescale remover intended for espresso type machines. The recommended dosage for citric acid is 2 teaspoons per 0.5 l of water. Dose the limescale remover according to the manufacturer's instructions.
- To thoroughly remove limescale deposits, proceed according to the steps in chapter "Thorough cleaning of the portafilter and the milk frothing system", only with the difference that the prepared solution is poured into the water tank **A1** and milk tank **A17** instead of water.
- If necessary, repeat these steps 2–3 times.
- Finally, flush the system at least twice using clean cold water – proceed in the same way as in chapter "Thoroughly cleaning the portafilter and the milk frothing system".

Storage

- When not using the appliance for an extended period of time, disconnect the power plug from the power socket, allow the appliance to cool down and clean it according to the instructions in chapter "Cleaning and maintenance".
- Before storing it, check that the appliance and all its accessories are thoroughly clean and dry.
- Store the appliance in a dry, clean and well-ventilated location not exposed to extreme temperatures and out of children's reach.

TROUBLESHOOTING

- The appliance does not work as described in the user's manual, check the list of most frequent problems below in order to remedy the problem. In the event that your problem is not listed or if the problem persists, turn off the appliance, pull the power plug out of the power socket and contact an authorised service centre. Under no circumstances should you attempt to repair the appliance yourself.

Problem	Possible cause	Solution
The control panel <b>A5</b> is not lit / the appliance cannot be turned on.	The power plug is not inserted in a power socket.	Insert the power plug into a power socket.
	The power socket is damaged.	Insert the power plug into a different power socket.
	The power socket has no voltage.	Check fuses and the power supply.
	The control panel <b>A5</b> is broken.	Contact an authorised service centre.

Fuses are burnt.	You connected too many appliances to a single electrical circuit.	Reduce the number of appliances connected to a single circuit.
	Cause is unknown.	Contact a qualified electrician.
Water is leaking out of the appliance.	There is too much water in the water tank <b>A1</b> .	Fill the water tank <b>A1</b> only up to the MAX. mark.
	The water tank <b>A1</b> is not correctly inserted.	Insert the water tank <b>A1</b> into the appliance correctly.
A constant sound is made and red indicator light <b>B3</b> is flashing after a coffee beverage / milk frothing is selected. The control panel <b>A5</b> did not light up.	There is no water in the water tank <b>A1</b> .	Remove the water tank <b>A1</b> out of the appliance and fill it with clean cold water. Place a cup underneath the coffee spout. Press any button, some water will flow out of the appliance. The sound will stop and the red light <b>B3</b> will turn off. In this way the appliance resets itself. Select the coffee beverage / milk frothing again.
The red indicator light <b>B3</b> is constantly lit.	The appliance is damaged.	Contact an authorised service centre.
Yellow indicator light <b>B8</b> is flashing.	Limescale deposits have accumulated inside the appliance.	Perform the limescale removal process.
Coffee flows out very slowly.	The coffee spout is clogged.	Clean the portafilter.
	Limescale deposits have accumulated inside the appliance.	Perform the limescale removal process.
The brewed coffee is very weak.	There is not enough ground coffee in the filter.	Place a sufficient amount of ground coffee into the filter – 1 full measuring cup to brew 1 cup of coffee, 2 full measuring cups to brew 2 cups of coffee.
An excessive amount of steam is being released from the appliance while coffee is being extracted.	The set brewed coffee volume is too large relative to the amount of ground coffee in the filter.	The correct volume of brewed coffee should also correspond to the amount of ground coffee in the filter.
	Limescale deposits have accumulated inside the appliance.	Perform the limescale removal process.
An unpleasant odour is coming out of the appliance during use.	You selected the brewing of a cappuccino, latté macchiato or milk frothing, but there is no milk in the tank.	Wait for the brewing process to finish. Then allow the appliance to cool down for a while. Remove the milk tank from the appliance and fill it with milk. Then start the coffee brewing process again.
	Are you using the appliance for the first time?	If you are using the appliance for the first time, you may register a slight odour, which will disappear with use. This is normal.
	Did you perform the limescale removal process?	Flush the appliance with clean water.

TECHNICAL SPECIFICATIONS

Rated voltage range .....	220–240 V ~
Rated frequency .....	50/60 Hz
Rated power input .....	1,240–1,450 W
Noise level .....	70 dB(A)
Water tank capacity .....	~1.4 l
Milk tank capacity .....	~0.4 l

The declared noise emission level of the appliance is 70 dB(A), which represents a level A of acoustic power with respect to a reference acoustic power of 1 pW.

We reserve the right to change text and technical specifications.

INSTRUCTIONS AND INFORMATION REGARDING THE DISPOSAL OF USED PACKAGING MATERIALS

Dispose of used packaging material at a site designated for waste in your municipality.

DISPOSAL OF USED ELECTRICAL AND ELECTRONIC EQUIPMENT



This symbol on products or original documents means that used electric or electronic products must not be added to ordinary municipal waste. For proper disposal, renewal and recycling hand over these appliances to determined collection points. Alternatively, in some European Union states or other European countries you may return your appliances to the local retailer when buying an equivalent new appliance. Correct disposal of this product helps save valuable natural resources and prevents potential negative effects on the environment and human health, which could result from improper waste disposal. Ask your local authorities or collection facility



for more details.  
In accordance with national regulations penalties may be imposed for the incorrect disposal of this type of waste.

For business entities in European Union states

If you want to dispose of electric or electronic appliances, ask your retailer or supplier for the necessary information.

Disposal in other countries outside the European Union

This symbol is valid in the European Union. If you wish to dispose of this product, request the necessary information about the correct disposal method from the local council or from your retailer.



This product meets all the basic requirements of EU directives related to it.