

SENCOR®

SOI 3310SL / SOI 3311BK
SOI 3312WH



EN ■ Oral Irrigator

Translation of the original manual

READ CAREFULLY AND STORE FOR FUTURE USE.

General warnings

- This appliance may be used by children 8 years of age and older and by persons with physical or mental impairments or by inexperienced persons, if they are properly supervised or have been informed about how to use of the product in a safe manner and understand the potential dangers.
- Children must not play with the appliance. Cleaning and maintenance performed by the user must not be performed by unsupervised children.
- In the event that the power cord is damaged, have it repaired at a professional service centre to prevent causing a dangerous situation. It is forbidden to use the appliance if it has a damaged power cord.

Electrical safety

- Do not disconnect the power adapter from the power socket by pulling on the power cord. This could damage the power adapter or the power socket. Disconnect the power adapter from the power socket by pulling on the plug.
- Do not place the power cord of the power adapter over sharp objects. Make sure that the power cord does not hang over the edge of a table and that it is not touching a heated surface.



Attention:

The appliance must only be used with the original power adapter that came with it. In order to avoid a dangerous situation arising, never use a different type of power adapter.

- Never use the power adapter supplied with this appliance for any other purposes.
- Keep the power adapter and its power cord dry.
- Do not wind the power cord of the power adapter around the handle or the base unit of the appliance.
- Do not connect and disconnect the power adapter cord to and from the power socket with wet hands.
- Before connecting the power adapter to a power socket, check that the voltage on its rating label corresponds to the voltage in the power socket to which you wish to connect it. Do not use an extension cord.
- Store and use the appliance at an ambient temperature between 15 and 35 °C. When you have finished using it, disconnect it from the power socket.
- Do not expose the appliance to temperatures higher than 50 °C.

- Do not charge, use or store the appliance or leave it lying in a bathroom or in locations where it could fall into a bath, wash basin or other containers filled with water.
- In the event that the appliance falls into water, under no condition reach for it, rather, immediately disconnect the power adapter from the power socket. Never use an appliance or power adapter that was submerged in water. Hand it over to an authorised service centre for inspection.

Safety during use

- This oral irrigator is intended exclusively for cleaning teeth and oral hygiene of people. The oral irrigator is not intended for commercial purposes or for cleaning the teeth of animals.
- Use the oral irrigator and the individual heads in accordance with the instructions contained in this user's manual.
- In the event that you have recently had intensive dental work done, for example a tooth or gum operation, suffered with tooth problems or you have a suspicion of having dental problems (fillings, crowns, etc.), please consult your dentist prior to using the oral irrigator.
- In the event that gum bleeding occurs when the oral irrigator is used or if bleeding does not stop even after 2 weeks of its use, please contact your dentist.
- If you have any health issues, please contact your dentist prior to using the oral irrigator.
- In the event that the oral irrigator (base unit, handle or power adapter) are damaged in any way, stop using it.
- Use only the original accessories supplied with this oral irrigator. Do not use nozzle heads other than those supplied by the manufacturer.
- The oral irrigator and its power adapter must only be used in indoor areas. Do not use it outdoors.
- Do not use the oral irrigator in rooms where aerosol sprays are used or where oxygen is administered.
- Do not expose the oral irrigator and its accessories to the outdoor environment, extreme temperatures, direct sunlight, excessive humidity or excessively dusty environments.
- Do not place the oral irrigator and its accessories near heaters, open fires or other sources of heat.



Warning:

Keep the oral irrigator dry.

- Before every use, check the oral irrigator and its nozzle heads for damage. Never use an oral irrigator with a damaged nozzle head.
- Do not use the suction hose for moving the base unit of the oral irrigator. Protect the suction hose against being damaged by sharp or hot objects or by an open flame and do not bend it over sharp edges. It must also not hang loosely over the edge of a shelf, table, etc. where children could reach it.
- The oral irrigator may heat up slightly during use. This is completely normal.
- Do not push too hard on the end of the nozzle head.
- To prevent injuries, do not fill the tank with hot water. Do not place any objects into the tank.
- Do not point the nozzle head under the tongue, into an ear, a nose or eyes or other sensitive areas where injury could result.
- Do not clean the base unit and handle, nozzle heads, power adapter or the water tank in a dishwasher or microwave oven.
- For hygiene reasons, multiple people must not share a single nozzle head. This could transmit infections or inflammations in the oral cavity. Always turn off the oral irrigator and disconnect it from the power socket when not using it, when leaving it without supervision and before attaching, removing or replacing nozzle heads and before cleaning, maintenance or storage. Store the oral irrigator and its power adapter in a dry environment.
- Keep the oral irrigator clean. Perform cleaning and maintenance according to the instructions in chapter Cleaning and maintenance.
- Do not perform any maintenance on the oral irrigator other than cleaning the individual parts of the oral irrigator as described in chapter Cleaning and maintenance.
- Do not use the oral irrigator if it has fallen on the floor, if it was submerged in water, if it is not functioning correctly or if it is damaged in any other way.
- In order to prevent a hazardous situation arising, do not repair the oral irrigator or any of its accessories yourself or modify it in any way. For all repairs, contact an authorised service centre. By tampering with the appliance, you risk voiding your legal rights arising from unsatisfactory performance or quality warranty.

A

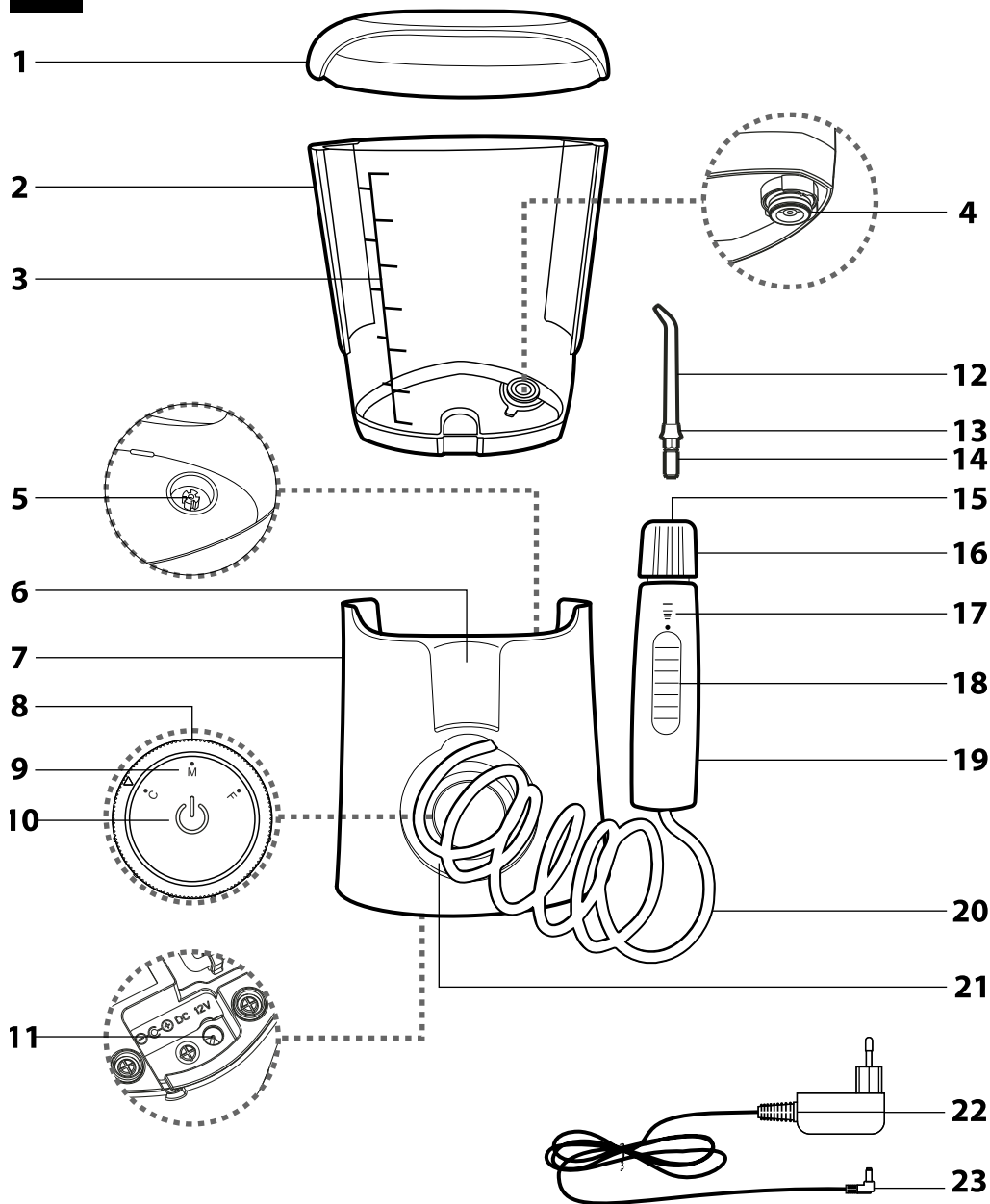

B

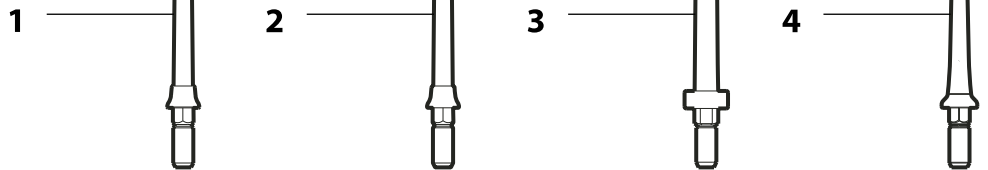

C

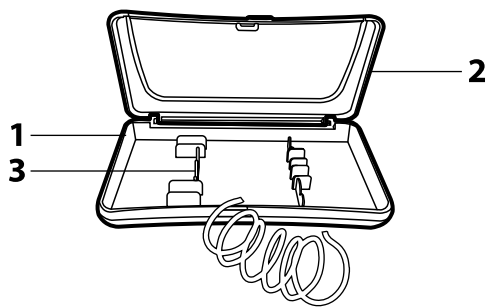

D

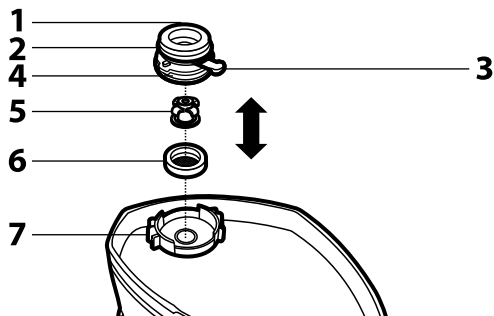

- This appliance may be used by children 8 years of age and older and by persons with physical or mental impairments or by inexperienced persons, if they are properly supervised or have been informed about how to use of the product in a safe manner and understand the potential dangers.
- Children must not play with the appliance. Cleaning and maintenance performed by the user must not be performed by unsupervised children.

DESCRIPTION OF THE ORAL IRRIGATOR AND ITS ACCESSORIES

- A1** Lid
- A2** 600 ml water tank
- A3** Scale with minimum and maximum water level marks
- A4** Water tank valve
- A5** Base unit valve
- A6** Magnetic handle holder
- A7** Base unit
- A8** Mode control knob
Turn it to select one of the following cleaning modes:
C – Everyday cleaning mode.
M – Gum massage mode.
F – Fresh mode for refreshment and surface cleaning.
- A9** Mode indicator
Operation and the selected mode are indicated by an LED colour backlight.
- A10** Main switch
Press to turn the pump of the oral irrigator on and off.
- A11** Power adapter connection socket
- A12** Nozzle head
- A13** Marking ring
- A14** Nozzle head locking pin
- A15** Nozzle head mount hole
- A16** Nozzle head coupler
- A17** Water pressure scale
- A18** On/Off switch, water current On/Off and control
- A19** Handle
- A20** Suction hose
- A21** Suction hose storage compartment
- A22** Power adapter suitable also for damp bathrooms
- A23** Power adapter plug
- B1** Standard head
Suitable for normal cleaning, removing bacteria from between teeth and the area between the tooth and the gum.
- B2** Orthodontic nozzle head
Suitable for cleaning around braces or hard-to-reach places around bridges.
- B3** Periodontal pocket cleaning nozzle head
Suitable for cleaning hard-to-reach or sensitive places. Special nozzle head design ensures quality cleaning even when low pressure is used.
- B4** Tongue cleaning nozzle head
Suitable for cleaning the tongue and face, for removing bacteria, food remains and dead cells from the surface.
- C1** Nozzle head case
- C2** Lid
- C3** Nozzle head storage compartment
- D1** Valve body
- D2** Top gasket
- D3** Lever
- D4** Bottom gasket
- D5** Inner gasket
- D6** Plug with filter
- D7** Filter mount

PURPOSE OF USE

- The oral irrigator is intended exclusively for oral hygiene. It helps to remove bacteria from the interdental area and gum folds around teeth, it quickly and gently removes food remains and plaque from interdental areas and periodontal pockets, whilst simultaneously massaging the gums. In combination with meticulous tooth brushing, it helps to actively care for the health of your teeth by helping to prevent periodontitis, formation of dental tartar and tooth decay and unpleasant bad breath.
- The oral irrigator is intended for domestic use and is not intended for business activities or other professional areas of use.

BEFORE FIRST USE

- Rinse all the nozzle heads **B1** to **B4** under running water.
- Flush out the water tank **A2** several times and fill it with clean water as described in chapter Filling the water tank with water. Insert the nozzle head **B1** into the handle **A18** as described in chapter Attaching and removing nozzle heads. Point the handle with the nozzle head into a wash basin and turn on the oral irrigator by pressing the switch **A10**. Turn the control knob **A8** to set mode C and allow water to flow through the nozzle for a while to flush out the suction hose **A20** and the nozzle head. The process is the same for nozzle heads **B2** to **B4**.

FILLING THE WATER TANK

- Remove the lid **A1** from the water tank **A2**. Take the water tank **A2** off the base unit **A7**, fill it up with water and push it back into the base unit **A7**. Carefully wipe away any spilt water both from the water tank as well as the base unit. Put the lid **A1** back on. The oral irrigator can now be used even without the lid **A1** attached.



Attention:

The water should have a pleasant temperature. Do not use water hotter than 40 °C.

- Apart from water, you can also fill the water tank **A2** with mouth wash or another solution. Using a mouth wash makes the oral irrigator even more effective. However, do not use mouth washes containing isopropyl myristate or a high concentration of essential oils. These substances are included in mouth washes sold in glass and ceramic containers and could damage the water tank **A2** and the inner parts of the oral irrigator. Mouth washes containing substance that are harmless to the oral irrigator are sold in plastic containers.

ATTACHING AND REMOVING NOZZLE HEADS

- Nozzle heads **B1** to **B4** are supplied with rings **A13** of various colours to make them discernible for other people, e.g. family members.
- Hold the handle **A19** so as not to press switch **A18** and with your fingers push the coupler **A16** down so that it is touching the top side of the handle **A19**. Hold the coupler **A16** in this position.
- Select the desired nozzle head and insert its pin **A14** from above vertically into the hole **A15** in the handle **A19**. Release the coupler **A16**. There must be a gap between the coupler **A16** and the handle **A19**. To check that the connection is correct, try pulling the nozzle head out.
- To remove the nozzle head, push down the coupler **A16** and pull the nozzle head vertically upwards from the hole **A15**. Release the coupler **A16**.

USING THE ORAL IRRIGATOR

- Before you start using the oral irrigator, acquaint yourself with all the operating instructions.
- Insert the plug **A22** of the power adapter **A21** into the socket **A11** on the underside of the base unit **A7**, and then insert the power adapter plug into a power socket and stand the oral irrigator on a stable and even surface.
- Fill the water tank **A2** with fresh water.
- Select an appropriate type of nozzle head and mount it on the handle **A19** of the oral irrigator. Before every use, check the nozzle head for damage. Never use an oral irrigator with a damaged nozzle head.
- Turn the mode control knob **A8** to select the desired cleaning mode.
- Press the main switch **A10**. The pump of the oral irrigator will start.
- Take the handle **A19** off the magnetic holder **A6**. Insert the nozzle head into an open mouth and lean over a sink to allow water and flushed out food remains to flow out. Set switch **A18** to one of the positions to turn on the water current and point it at the place that you wish to spray. There are 5 levels available for variable water pressure control. We

recommend starting with the lowest level, especially if you have a tendency towards gum bleeding or when the oral irrigator is used by children. Moving the switch **A18** between the individual levels is accompanied by an audible click.



Note:

Water pressure and the cleaning mode can be adjusted even while spraying.



Tip:

The coupler **A16** enables each nozzle head to be rotated around by 360° to enable easy access to all parts of the mouth.

- Move the nozzle head slowly from one interdental area to the next. In this way, clean all the inner and outer sides.
- Thoroughly also spray the area around crowns and bridges.
- If you have braces, point it perpendicular to the teeth at the gum line and start from the last molar (at the back). Slowly move the nozzle along the gum line and around the braces.
- When massaging gums, point the nozzle vertically at the gums and also spray the gum line.
- When cleaning the tongue, gently place the nozzle head along the axis of the tongue approximately in the middle of the oral cavity. Start with a low water pressure and gradually increase it as required.
- When cleaning periodontal pockets, set the lowest water pressure, point the soft tip at the tooth at an angle of 45 degrees, gradually place it against the edge of the gum and slide it into the pocket. Turn on the water current and finish the treatment by movement below the gum line.



Note:

The oral irrigator has a timer switch, which automatically turns off the water pump motor after 2 minutes of operation. Furthermore, it features a Quadpacer function, which after every 30 seconds of operation, i.e. 4x in total, interrupts the water current to remind you to move the current to all your teeth.

- If water stops flowing out of the nozzle, the water tank **A2** is empty. Turn off the oral irrigator by setting the switch **A18** to the lowest position (Off) and refill the water tank with water.
- After turning off the oral irrigator, set the switch **A18** to the lowest position (Off). Take the nozzle head out of your mouth only when the water current is turned off.

CLEANING AND MAINTENANCE



Attention:

When cleaning the oral irrigator, use water up to a temperature of 50 °C or a neutral cleaning agent. For cleaning, do not use steel wool, solvents or cleaning products with an abrasive effect, etc. to prevent damaging the surface being cleaned. Do not submerge the oral irrigator in water when cleaning it.

WATER TANK

- To prevent bacteria multiplying inside, empty the water tank **A2** after every use. Rinse the water tank with water, wipe it with a clean dry wiping cloth and allow it to drip dry.
- If you poured mouth wash or its solution into the water tank **A2** when using the oral irrigator, it is necessary to rinse it out. We recommend filling the water tank **A2** with clean water and then running the oral irrigator to pump all the contents of the water tank into a sink. Then rinse the water tank with water, wipe it with a clean dry wiping cloth and allow it to drip dry.

WATER TANK VALVE

- Regularly clean the valve **A4** on the underside of the water tank **A2**. Turn the water tank **A2** upside down, turn lever **D3** to release the valve **A4** in the mount **D7** and slide it out upwards. Take the plug with filter **D6** and the inner gasket out of the valve **A4**. Carefully remove the top gasket **D2** and bottom gasket **D4** from the body of the valve.
- Thoroughly wash all the disassembled parts in warm water using standard kitchen detergent, rinse under running water and wipe dry with a fine wiping cloth.
- Reassemble all the parts of the valve **A4** and reinsert the valve into the water tank in reverse sequence to disassembly.

BASE UNIT

- After every use, wipe the base unit dry, including the water tank surface **A2**.

HANDLE

- Wipe the handle **A18** with a clean dry cloth. In the event that it is very dirty, you can use a lightly dampened cloth. Then thoroughly wipe the cleaned surface until dry. Also clean the suction hose **A20** and place it into the storage compartment **A21**.



Attention:

The handle **A19** is not designed to be washed under a water tap. Do not spray the base unit of the oral irrigator **A7** or its power adapter **A22** with water or any other liquid or submerge it in water or any other liquid.

NOZZLE HEADS

- To prevent deposits from forming, rinse any used nozzle heads after every use. Then wash the surface of the nozzle head with water and then wipe with a soft wiping cloth always until dry. Open the lid **C2** of case **C1** and place the nozzle heads into the storage compartment **C3**.
- For hygiene reasons, we recommend replacing the nozzle heads every six months with new ones.

STORAGE

- When you have finished using the oral irrigator, prepare it according to the instructions in chapter Cleaning and maintenance. Store the oral irrigator in a dry place away from direct sunlight. If you wish to store the oral irrigator for an extended period of time, we recommend removing the lid **A1** from the water tank **A2**.

TROUBLESHOOTING

Problem	Possible cause	Solution
The oral irrigator does not work	The pump motor is not running.	Check that the power adapter is correctly inserted in the base unit and in a power socket.
Water pressure is very low.	The nozzle is clogged with material.	Clean out the nozzle or replace it.
	The nozzle is deformed.	Replace the nozzle.
	The water tank valve is clogged.	Clean out the valve and fill the water tank with clean water.
	The water tank is empty.	Refill with water.
Water is not spraying out of the oral irrigator.	The water pressure is set below the lowest water pressure value.	Adjust the pressure using the switch on the handle.
	The water tank valve is not working.	Replace the valve with a new one.
Water is leaking out of the water tank on to the base unit.	The water tank valve is incorrectly inserted into the water tank hole.	Insert the valve correctly into the water tank.
Water is leaking between the nozzle head and the handle.	The nozzle head is incorrectly seated.	Remove the nozzle head and reseal it.

TECHNICAL SPECIFICATIONS

Oral Irrigator	
Dimensions (height × width × depth)	245 × 135 × 97 mm
Weight with nozzle head	580 g
Water tank volume	600 ml
Pump frequency	1,400 pulses/min
Water pressure	200 – 760 kPa
Length of suction hose	1 m
Noise level	80 dB(A)
Power adapter	
Rated voltage range	100–240 V / AC
Rated frequency	50/60 Hz
Output	12 V, 1,500 mA
Length of the power cord	1.8 m

The declared noise emission level of the appliance is 80 dB(A), which represents a level A of acoustic power with respect to a reference acoustic power of 1 pW.

Changes to text and technical parameters are reserved.

INSTRUCTIONS AND INFORMATION REGARDING THE DISPOSAL OF USED PACKAGING MATERIALS

Dispose of used packaging material at a site designated for waste in your municipality.

DISPOSAL OF USED ELECTRICAL AND ELECTRONIC EQUIPMENT



This symbol on products or original documents means that used electric or electronic products must not be added to ordinary municipal waste. For proper disposal, renewal and recycling hand over these appliances to determined collection points. Alternatively, in some European Union states or other European countries you may return your appliances to the local retailer when buying an equivalent new appliance. Correct disposal of this product helps save valuable natural resources and prevents potential negative effects on the environment and human health, which could result from improper waste disposal. Ask your local authorities or collection facility for more details. In accordance with national regulations penalties may be imposed for the incorrect disposal of this type of waste.

For business entities in European Union states

If you want to dispose of electric or electronic appliances, ask your retailer or supplier for the necessary information.

Disposal in other countries outside the European Union.
This symbol is valid in the European Union. If you wish to dispose of this product, request the necessary information about the correct disposal method from the local council or from your retailer.



This product meets all the basic requirements of EU directives related to it.