



## EN ■ Men's Self-Cleaning Shaver

*Translation of the original manual*

**READ CAREFULLY AND STORE FOR FUTURE USE.****General warnings**

- This appliance may be used by children 8 years of age and older and by persons with physical or mental impairments or by inexperienced persons, if they are properly supervised or have been informed about how to use the product in a safe manner and understand the potential dangers.
- Children must not play with the appliance.
- Cleaning and maintenance performed by the user must not be performed by unsupervised children.
- In the event that the power cord is damaged, have it repaired at a professional service centre to prevent causing a dangerous situation. It is forbidden to use the appliance if it has a damaged power cord.

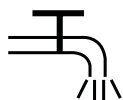

The cutting head of this appliance can be washed under a water tap.

**Warning:**

Before cleaning with water, make sure that the appliance is disconnected from the electrical power source.

- The parts of the appliance that need to be mounted or stood upright, must be mounted or stood upright in such a way that they cannot fall into water.

## ELECTRICAL SAFETY

- Before connecting the power adapter to a power socket, check that the voltage on its rating label corresponds to the voltage in the power socket to which you wish to connect it. Do not use an extension cord.
- Connect the power adapter only to a properly grounded power socket.



### Attention:

Only use the appliance with the original power adapter that came with it. In order to avoid a dangerous situation from arising, never use a different type of power adapter.

- Do not place the USB cable over sharp objects. Make sure that the cable does not hang over the edge of a table or that it is not touching a heated surface.
- Ensure that the USB cable is not clamped or crimped.
- When pulling the USB connector out of a power source or the USB adapter out of a power socket, always pull on the connector or the adapter and never on the cable itself.
- Keep the USB cable dry.
- Do not wind the USB cable around the handle of the appliance.
- Do not connect and disconnect the USB cable to and from the power source with wet hands.
- Before connecting the USB cable to a power source or a power adapter, check that the voltage on its rating label corresponds to the voltage in the power socket to which you wish to connect it. Do not use an extension cord.
- Store, charge and use the appliance at an ambient temperature of 15 °C to 35 °C. Do not charge the appliance for longer than is necessary for it to fully charge. Once it is charged, disconnect it from the power source.
- Do not expose the appliance to temperatures higher than 50 °C. Otherwise, the built-in battery could be damaged.
- The appliance is equipped with a built-in long-life battery that can only be removed at a professional service centre. Never attempt to remove it from the appliance yourself.



### Attention:

Never disassemble the appliance for the purpose of removing the battery. Never short circuit the appliance or throw it into a fire. Incorrect use, risks releasing toxic substances or causing a fire or explosion.

- Do not charge, use or store the appliance or leave it lying in a bathroom or in locations where it could fall into a bath, wash basin or other containers filled with water.
- In the event that the appliance falls into water while it is charging, under no condition reach for it, rather, immediately disconnect the USB cable from the power source. Never use an appliance or power cord that was submerged in water. Hand the appliance over to an authorised service centre for inspection.



### Warning:

Do not use the appliance in the bath or shower. Do not clean the body of the appliance under a water tap, do not spray it with water or any other liquid or submerge it in water or any other liquid.

The appliance is not intended for wet shaving.

## SAFETY DURING USE

- This electric shaver is intended for home use only and is designed for shaving and trimming beards or whiskers and facial hair. The electric shaver is not intended for commercial purposes or for trimming animal fur.
- Only use the electric shaver on dry, clean beards or whiskers. Do not use it on wet beards or whiskers on which a shaving foam or gel, etc. is applied.
- We do not recommend using the electric shaver on parts of the face where there are open wounds or lacerations, burns, blisters, etc.
- For hygiene reasons, the electric shaver should be used only by a single user.
- Use the electric shaver in accordance with the instructions contained in this user's manual.
- Use only the original accessories supplied with this electric shaver.
- The electric shaver and its USB power cable must only be used in indoor areas. Do not use it outdoors.
- Do not use the electric shaver in rooms where aerosol sprays are used or where oxygen is administered.
- Do not expose the electric shaver to the outdoor environment, extreme temperatures, direct sunlight, excessive humidity or excessively dusty environments.
- Do not place the electric shaver near heaters, open fires or other sources of heat.



### Warning:

Keep the electric shaver dry.

- Before every use, check the shaving head for damage. Never use an electric shaver with a damaged shaving head.
- The electric shaver may heat up during use or when it is being charged. This is completely normal.
- Keep the electric shaver at a safe distance from eyes.
- Always turn off the electric shaver and disconnect it from the power socket when not using it, when leaving it without supervision, before cleaning, maintenance or storage. Store the electric shaver and its USB power cable in a dry environment.
- Keep the electric shaver clean. Perform cleaning and maintenance according to the instructions in chapter Cleaning and maintenance.
- Do not perform any maintenance on the electric shaver other than cleaning the individual components as described in chapter Cleaning and maintenance.
- Never use the electric shaver or the USB power cable if it is damaged in any way.
- Do not use the electric shaver if it has fallen on the floor, if it was submerged in water, if it is not functioning correctly or if it is damaged in any other way.
- In order to prevent a hazardous situation from arising, do not repair the electric shaver or any of its accessories yourself or modify it in any way. For all repairs, contact an authorised service centre. By tampering with the product you risk voiding your legal rights arising from unsatisfactory performance or quality warranty.

A

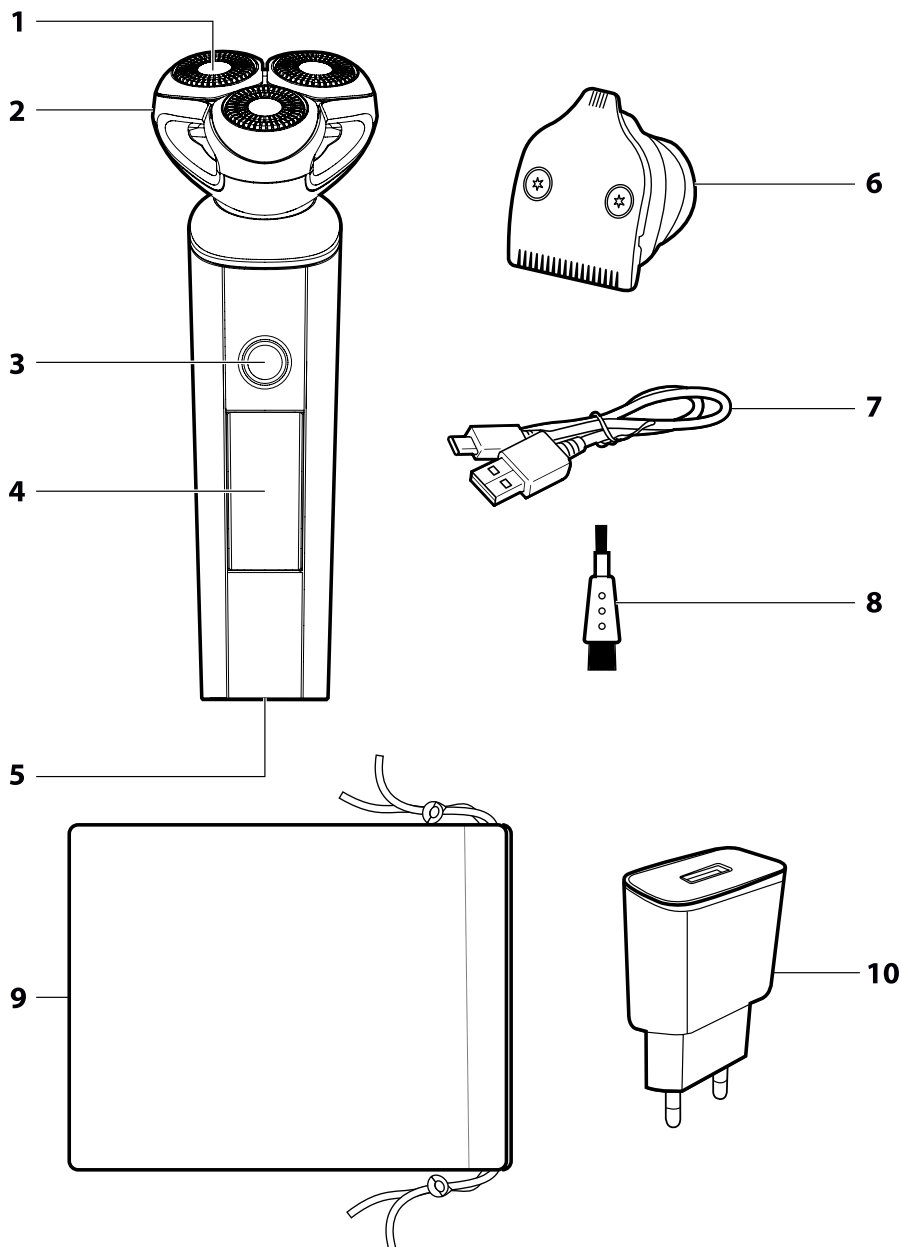

B

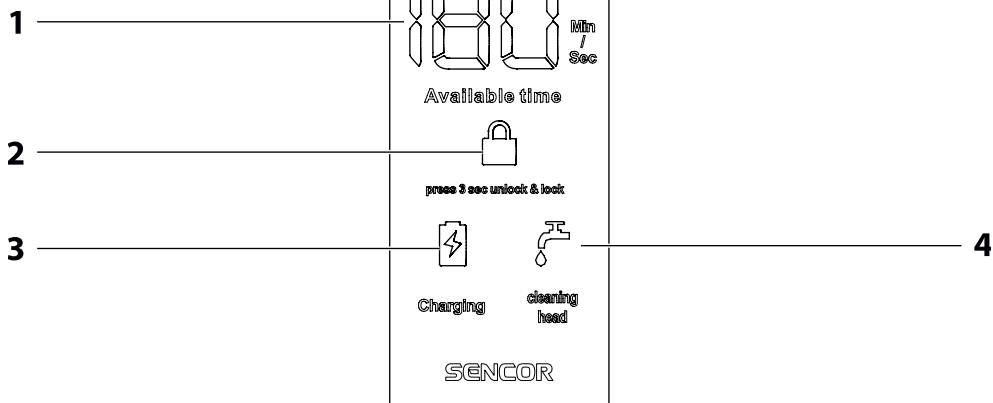

C

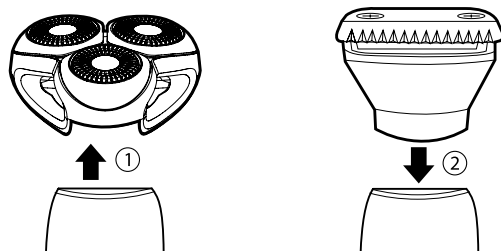

D

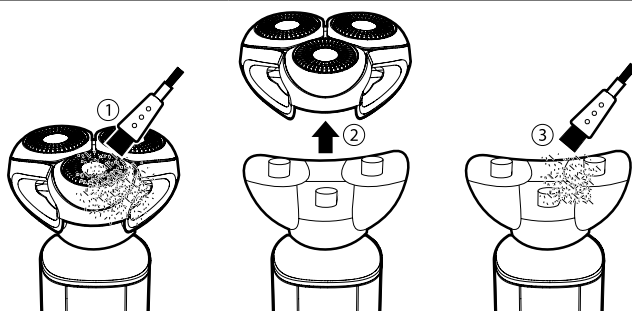

E

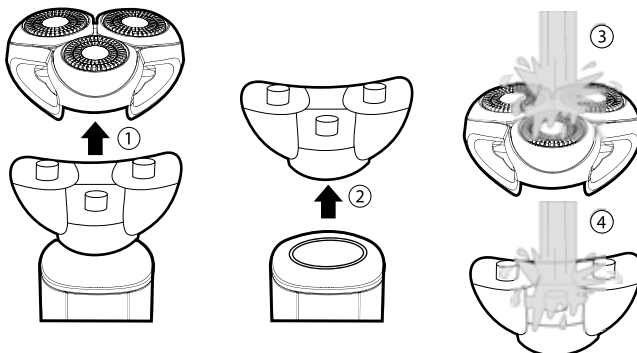

# Men's Self-Cleaning Shaver

## User's manual

Prior to using this appliance, please read the user's manual thoroughly, even in cases, when one has already familiarised themselves with previous use of similar types of appliances. Only use the appliance in the manner described in this user's manual. Keep this user's manual in a safe place where it can be easily retrieved for future use. In the event that you hand this appliance over to somebody else, make sure to also include this user's manual.

Carefully unpack the appliance and take care not to throw away any part of the packaging before you find all its parts. We recommend saving the original cardboard box, packaging material, purchase receipt and responsibility statement of the vendor or warranty card for at least the duration of the legal liability for unsatisfactory performance or quality. In the event of transportation, we recommend that you pack the appliance in the original box from the manufacturer.

## DESCRIPTION OF THE ELECTRIC SHAVER AND ITS ACCESSORIES

<b>A1</b> Cutters	<b>A7</b> USB power cable (USB/USB-C)
<b>A2</b> Shaving head with cutter holder	<b>A8</b> Cleaning brush
<b>A3</b> On/Off switch	<b>A9</b> Cloth bag
<b>A4</b> Display	<b>A10</b> USB adapter
<b>A5</b> Power cord connection socket	
<b>A6</b> Trimming attachment	

---

<b>B1</b> Battery level indicator	<b>B4</b> Cleaning indicator
<b>B2</b> Lock indicator	After 10 minutes of use, it will start flashing for 10 seconds, thereby serving as a reminder to clean the electric shaver.
<b>B3</b> Charging indicator	

## PURPOSE OF USE

- The electric shaver is intended exclusively for dry shaving of beards and trimming of sideburns, moustaches or smaller whiskers. The electric shaver is not intended for wet shaving or for cutting synthetic hair or animal fur.
- The electric shaver is intended for domestic use and is not intended for business activities or other professional areas of use.

## CHARGING

- The electric shaver has a built-in battery that enables its cordless operation. Before first use or after not using it for a long time, first allow the electric shaver battery to fully charge.
- The electric shaver can be charged in two ways:
  - by means of an external device with a USB port (e.g. computer, USB hub, powerbank, etc.).
  - by means of a standard USB adapter connected to a power socket.



### Note:

The selected power source must have an output of 5 V DC.

- Insert the smaller USB connector into the socket at the bottom of the shaver and the larger connector into the selected power source.
- The battery will start charging when connected to an electrical power source. The current remaining battery time will be lit on the display and the charging indicator **B3** will be lit.
- The charging time differs depending on the current battery power level. If the battery is completely discharged (flat), the charge may take up to 3.5 hours.
- When the battery is fully charged, the display will show the remaining battery time 180 and word "full" will appear permanently. Disconnect the charged electric shaver from the electrical power source.

### Attention:

Do not leave the electric shaver connected to the power grid for longer than is necessary to charge it.



- A fully charged battery will provide up to 180 minutes of cordless operation. Then it is necessary to charge the battery again.

## DIRECT DRIVE TECHNOLOGY

- If the battery of the electric shaver is discharged (flat) or if it is discharged during cordless operation, the shaver can be plugged into mains power and can continue to be used. This is enabled by **DIRECT DRIVE** technology used on the electric shaver. Therefore, it is not necessary to wait for a minimum charge.

## RECOMMENDATIONS FOR EXTENDING THE LIFETIME OF THE BATTERY

- In order for the built-in battery to serve you as long as possible, charge, use and store the electric shaver in a dry environment at an ambient temperature of 15–35 °C. Lower or higher temperatures have a negative impact on the lifespan of the battery.
- Do not wait for the battery to become completely flat. It is better to charge the battery before it is completely flat.
- When the electric shaver is not used for an extended period of time, charge it at least once every 6 months.

## OPERATION

### SHAVING

- Turn on the electric shaver by pressing the switch **A3**.
- Hold the electric shaver at a right angle to the skin surface and in short circular motions glide the shaving head over the skin on the face, moving against the growth direction of facial hair. Apply appropriate pressure to the skin. Do not push too hard.
- Tension the skin with your free hand when shaving hard to reach places such as, for example, on the chin. In this way you will achieve better shaving results.



### Note:

It may take your skin and facial hair two to three weeks to become accustomed to the new way of shaving. During this period, we recommend using the electric shaver every day.

- When you have finished shaving, clean the electric shaver according to the instructions in chapter Cleaning and maintenance.

## TRIMMING

- For trimming sideburns or clipping moustaches or goatees, use the trimming attachment **A6**.
- Grasp the shaving head **A2** and pull it upwards to slide it out of the body of the electric shaver. In its place, slide in the trimming attachment (fig. C).
- Turn on the electric shaver by pressing the switch **A3**. Hold the blades of the trimming attachment at a right angle to the respective part of the skin.
- When you have finished trimming, remove the trimming attachment and clean it according to the instructions in chapter Cleaning and maintenance.

## LOW BATTERY POWER INDICATION

- When the time value on the display reaches 5 minutes and less, battery level indicator **B1** will start flashing on the display. If this happens, turn off the shaver as soon as possible, plug it into mains power and continue using it.

## SHAVING HEAD CLEANING INDICATOR

- The shaver is equipped with a timer that adds up the operating time of the shaver (shaving time). When it reaches 10 minutes, the symbol **B4** will light up to indicate and beeps will be made to remind that it is necessary to clean the shaving head. If this happens, clean the shaver as soon as possible according to chapter CLEANING THE SHAVING HEAD.

## STAND-BY MODE

- When the electric shaver is turned off using the On/Off switch **A3** after use, the display will remain lit for a few more seconds. The electric shaver will then enter the stand-by mode in which the display turns off completely.
- To wake the electric shaver from the stand-by mode, simply pick it up. The display will be lit again. The electric shaver is thereby ready for operation.

## TRAVEL LOCK

- The travel lock prevents the electric shaver from being turned on accidentally, e.g. while travelling.
- The travel lock is activated by pressing and holding down button **A3** for 3 seconds. Beeps will be made, not only one, there are 6 beeps in total the lock symbol **B2** will be lit on the display. The On/Off switch **A3** does not react to being pressed.
- To deactivate the travel lock, again press and hold down button **A3** for 3 seconds. The lock symbol will turn off. Now the electric shaver is again ready for use.

## CLEANING AND MAINTENANCE

- For hygiene reasons, clean the electric shaver after every use. Regular cleaning is also important to ensure the correct operation of the electric shaver and to extend the lifespan of the cutters.
- Turn off the electric shaver before cleaning it. Never clean the electric shaver when it is charging and connected to the power supply.
- For cleaning, do not use brushes with hard bristles, cleaning products with an abrasive effect, solvents, etc. Otherwise, the cleaned surface may be damaged.

## CLEANING THE ELECTRIC SHAVER AND ADAPTER

- The electric shaver unit can be cleaned using a clean dry cloth. In the event that it is very dirty, you can use a lightly dampened cloth. Then thoroughly wipe the cleaned surface dry.
- To clean the power cable and adapter, use a clean, dry cloth.

CLEANING THE SHAVING HEAD

Cleaning with the brush

- Use the brush to clean away all hair and whisker remains from the shaving head.
- Pull upwards to remove the shaving head off the head holder, see fig. D. Use the brush to remove dirt and any whiskers from the holder and the body of the electric shaver.
- Put the shaving head back into the holder.

Cleaning with water

- Turn the electric shaver upside down and submerge the shaving head in water. Turn on the electric shaver by pressing the switch A3 and allow it to run for approximately 30 seconds. Then turn it off and take the head out of the water.
- Using a fine cloth, dry the shaving head or allow it to dry naturally. Do not use paper towels or coarse towels to dry it as this could damage the shaving blades.



Warning:

The body of the electric shaver is not intended to be washed using water. Never submerge it in water or clean it using water. There is a risk of serious injury by electrical shock!

- For a thorough clean, the shaving head can be removed by pulling on the holder and subsequently also removing the holder from the body of the electric shaver, see fig. E. Then wash both these parts under running water and allow them to dry fully and then insert them back into the body of the electric shaver.

CLEANING THE TRIMMING ATTACHMENT

- Use the cleaning brush to remove all whiskers and body hair from the trimming attachment.
- Remove the attachment from the body of the electric shaver and also clean out the mounting area for the attachment or shaving head.



Attention:

The blade edges of the trimming unit are sharp, pay increased attention when handling them.

STORAGE

- When you have finished using it, you can store the electric shaver with all its accessories in a suitable location out of children's reach. Keep the electric shaver away from extreme temperatures, direct sunlight and excessive humidity. Do not use in an overly dusty environment.

TECHNICAL SPECIFICATIONS

Electric Shaver

Built-in battery .....	Li-Ion, 3.6 V, 2,500 mAh
Dimensions (width × depth × height) .....	170 × 66 × 59 mm
Weight.....	210 g
Noise level .....	72 dB(A)

Power adapter

Input.....	100–240 V AC, 50/60 Hz, 0.2 A
Output.....	5 V/DC, 1 A
Electrical shock protection class.....	II

The declared noise emission level of the appliance is 72 dB(A), which represents a level A of acoustic power with respect to a reference acoustic power of 1 pW.

EXPLANATION OF TECHNICAL TERMINOLOGY

Safety class for electrical shock protection for contact with a liquid:

Electrical shock protection class:



Class II – Electrical shock protection is provided by double or heavy-duty insulation.

Changes to text and technical parameters are reserved.

DISPOSAL OF USED BATTERIES

Prior to handing over the appliance at a specialised collection facility, it is necessary to ensure that the built-in battery is removed. Battery removal will be performed at the authorised service centre. In the event that the product has been disassembled for the purpose of ecological disposal then it must not be reassembled.



This symbol indicates that used batteries do not belong in ordinary municipal waste. Hand over used batteries to designated collection points for proper disposal. Correct disposal of batteries will help prevent negative impacts on the environment and human health.

Disposal in other countries outside the European Union.

This symbol is valid in the European Union. If you wish to dispose of used batteries, request the necessary information about the correct disposal method from the local authorities or from your vendor.

INSTRUCTIONS AND INFORMATION REGARDING THE DISPOSAL OF USED PACKAGING MATERIALS

Dispose of used packaging material at a site designated for waste in your municipality.

DISPOSAL OF USED ELECTRICAL AND ELECTRONIC EQUIPMENT



This symbol on products or original documents means that used electric or electronic products must not be added to ordinary municipal waste. For proper disposal, renewal and recycling, hand these products over to determined collection points. Alternatively, in some European Union states or other European countries you may return your appliances to the local retailer when buying an equivalent new appliance.

Correct disposal of this product helps save valuable natural resources and prevents potential negative effects on the environment and human health, which could result from improper waste disposal. Ask your local authorities or collection facility for more details. In accordance with national regulations penalties may be imposed for the incorrect disposal of this type of waste.

For business entities in European Union states

If you want to dispose of electric or electronic equipment, ask your retailer or supplier for the necessary information.

Disposal in other countries outside the European Union.

This symbol is valid in the European Union. If you wish to dispose of this product, request the necessary information about the correct disposal method from the local council or from your retailer.



This product meets all the basic requirements of EU directives related to it.