



## EN ■ Multifunction blade

*Translation of the original manual*

**READ CAREFULLY AND STORE FOR FUTURE USE.****General warnings**

- This appliance may be used by children 8 years of age and older and by persons with physical or mental impairments or by inexperienced persons, if they are properly supervised or have been informed about how to use the product in a safe manner and understand the potential dangers.
- Children must not play with the appliance.
- Cleaning and maintenance performed by the user must not be performed by unsupervised children.
- In the event that the power cord is damaged, have it repaired at a professional service centre to prevent causing a dangerous situation. It is forbidden to use the appliance if it has a damaged power cord.

**Warning:**

Do not use the appliance in the bath or shower. Do not clean the body of the appliance under a water tap, do not spray it with water or any other liquid or submerge it in water or any other liquid.

- The parts of the appliance that need to be mounted or stood upright, must be mounted or stood upright in such a way that they cannot fall into water.

**ELECTRICAL SAFETY**

- Do not place the power cord over sharp objects. Make sure that the power cord does not hang over the edge of a table or that it is not touching a heated surface.
- Ensure that the USB cord is not clamped or crimped.
- When pulling the USB connector out of a power source or the USB adapter out of a power socket, always pull on the connector or the adapter and never on the cord itself.
- Keep the USB power cord dry.
- Do not wind the USB power cord around the handle of the appliance.
- Do not connect and disconnect the USB power cord to/from the power source with wet hands.
- Before connecting the USB power cord to a power source or power adapter, check that the voltage on its rating label corresponds to the voltage in the power socket to which you wish to connect it. Do not use an extension cord.
- Store, charge and use the appliance at an ambient temperature of 15 °C to 35 °C. Do not charge the appliance for longer than is necessary for it to fully charge. Once it is charged, disconnect it from the power source.
- Do not expose the appliance to temperatures higher than 50 °C. Otherwise, the built-in battery could be damaged.
- The appliance is equipped with a built-in long-life battery that can only be removed at a professional service centre. Never attempt to remove it from the appliance yourself.

**Attention:**

Never disassemble the appliance for the purpose of removing the battery. Never short circuit the appliance or throw it into a fire. Incorrect use, risks releasing toxic substances or causing a fire or explosion.

- Do not charge, use or store the appliance or leave it lying in a bathroom or in locations where it could fall into a bath, wash basin or other containers filled with water.
- In the event that the appliance falls into water, under no condition reach for it, rather, immediately disconnect the power cord from the power socket. Never use an appliance or power cord that was submerged in water. Hand the appliance over to an authorised service centre for inspection.

**SAFETY DURING USE**

- This multifunction blade is intended for home use only and is designed for trimming beards and nose and ear hair. The multifunction blade is not intended for commercial purposes or for trimming animal fur.
- Only use the multifunction blade on dry clean beards or nose and ear hair. Do not use it on wet or just washed beards on which a shaving foam or gel, etc. is applied.
- Use the multifunction blade and its accessories in accordance with the instructions contained in this user's manual.
- Use only the original accessories supplied with this multifunction blade.
- The multifunction blade and its USB power cord may only be used in indoor areas. Do not use it outdoors.
- Do not use the multifunction blade in rooms where aerosol sprays are used or where oxygen is administered.
- Do not expose the multifunction blade and its accessories to the outdoor environment, extreme temperatures, direct sunlight, excessive humidity or excessively dusty environments.
- Do not place the multifunction blade and its accessories near heaters, open fires or other sources of heat.

**Warning:**

Keep the multifunction blade dry.

- Before every use, check that the selected attachment is not damaged. Never use the multifunction blade with a damaged attachment.
- The multifunction blade may heat up during use or when it is charged. This is an entirely normal event.
- Keep the multifunction blade at a safe distance from eyes.
- Always turn off the multifunction blade and disconnect it from the power source when not using it, when leaving it without supervision and before attaching, removing or replacing an attachment and before cleaning, maintenance or storage. Store the multifunction blade and its USB power cord in a dry environment.
- Keep the multifunction blade clean. Perform cleaning and maintenance according to the instructions in chapter Cleaning and maintenance.
- Do not perform any maintenance on the multifunction blade other than cleaning the individual components as described in chapter Cleaning and maintenance.
- Never use a multifunction blade or USB power cord that is damaged in any way.
- Do not use the multifunction blade if it has fallen on the floor, if it was submerged in water, if it is not functioning correctly or if it is damaged in any other way.
- In order to prevent a hazardous situation from arising, do not repair the multifunction blade or any of its accessories yourself or modify it in any way. For all repairs, contact an authorised service centre. By tampering with the product you risk voiding your legal rights arising from unsatisfactory performance or quality warranty.

A

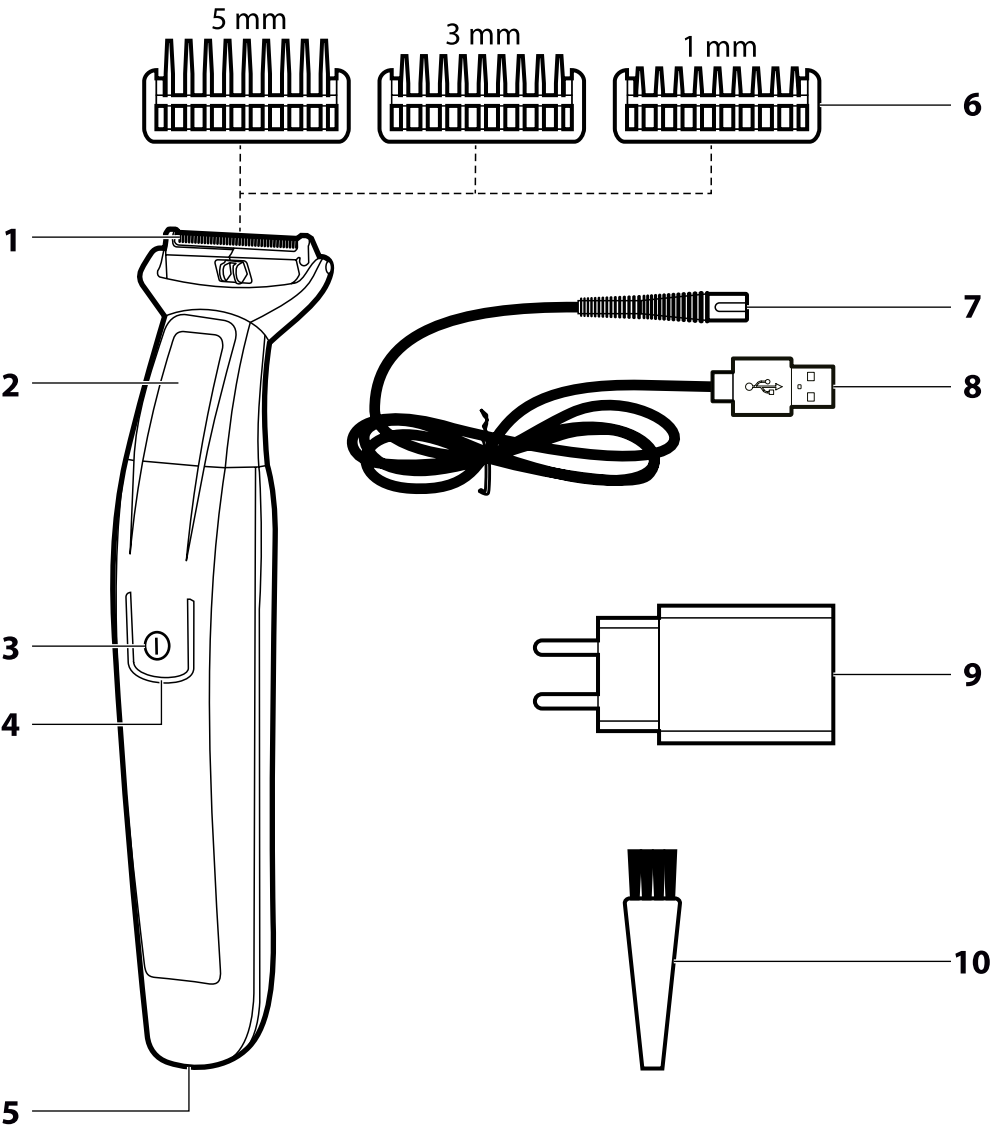

B

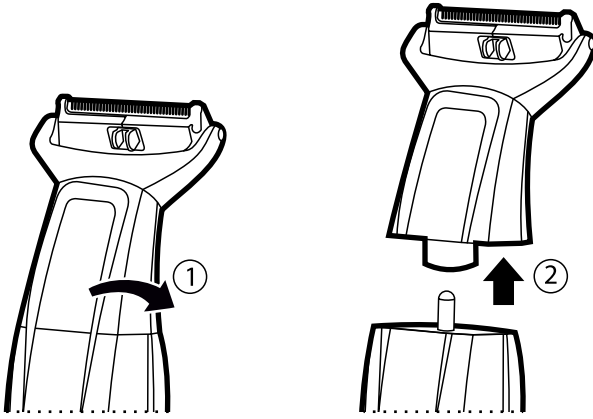

# Multifunction blade

## User's manual

- Prior to using this appliance, please read the user's manual thoroughly, even in cases, when one has already familiarised themselves with previous use of similar types of appliances. Only use the appliance in the manner described in this user's manual. Keep this user's manual in a safe place where it can be easily retrieved for future use. In the event that you hand this appliance over to somebody else, make sure to also include this user's manual.
- Carefully unpack the appliance and take care not to throw away any part of the packaging before you find all its parts. We recommend saving the original cardboard box, packaging material, purchase receipt and responsibility statement of the vendor or warranty card for at least the duration of the legal liability for unsatisfactory performance or quality. In the event of transportation, we recommend that you pack the appliance in the original box from the manufacturer.

## DESCRIPTION OF THE MULTIFUNCTION BLADE AND ITS ACCESSORIES

<b>A1</b> Cutting unit	<b>A6</b> Comb attachments of size 5 mm, 3 mm and 1 mm
<b>A2</b> Detachable part	<b>A7</b> Power cord plug
<b>A3</b> On/Off switch	Connects to the blade body
<b>A4</b> Operation/battery charge indicator	<b>A8</b> USB power cable connector
<b>A5</b> Power cord connection socket	Connects to the power adapter
	<b>A9</b> USB power adapter
	<b>A10</b> Cleaning brush

## PURPOSE OF USE

- The multifunction blade is suitable for trimming, forming and shaving beards on the face (goatee, moustache and sideburns). Shaving will deliver a smooth result, trimming with the comb beard attachment will ensure a certain length and forming will create perfect edges and sharp hair lines.
- The multifunction blade is intended for domestic use and is not intended for business activities or other professional areas of use.

## CHARGING

- The multifunction blade can be charged in two ways:
  - by means of the supplied USB adapter connected to a power socket
  - by means of an external device with a USB port (e.g. computer, USB hub, powerbank, etc.).
- Insert the power cord plug **A7** into the socket at the bottom of the multifunction blade and the USB power cable connector into the selected power source.
- The indicator **A4** flashes during the charging process. The charging time differs depending on the current battery power level. If the battery is completely discharged (flat), a full charge will take approximately 2 hours.
- When the battery is fully charged, the indicator will remain permanently lit. Disconnect the power cord from the multifunction blade and from the power source.



### Attention:

Do not leave the multifunction blade connected to the power source for longer than is necessary to charge it.

- A fully charged multifunction blade battery will provide up to 45 minutes of cordless operation. Then it is necessary to charge the battery again.

## RECOMMENDATIONS FOR EXTENDING THE LIFETIME OF THE BATTERY

- In order for the built-in battery to serve you as long as possible, charge, use and store the multifunction blade in a dry environment at an ambient temperature of 15- 35 °C. Lower or higher temperatures have a negative impact on the lifespan of the battery.
- We recommend charging the battery only after leaving it to fully discharge.
- When the multifunction blade is not used for an extended period of time, charge it at least once every 6 months.

## OPERATION

### PREPARATION BEFORE USE

- Only use the multifunction blade on dry clean beards or nose and ear hair. Do not use it on wet or just washed beards on which a shaving foam or gel, etc. is applied.



### Attention:

Do not use the multifunction blade if you have open wounds, cuts or blisters on your skin.

- Before starting any facial hair trimming, acquaint yourself with all the operating instructions.

- You can use the multifunction blade to trim your own or other people's facial hair. To minimise the soiling of clothing by the trimmed whiskers, cover yourself or the person that you intend to trim using a suitable covering.
- Prior to every use, check that the cutting unit is clean.
- Prior to every use, check the cutting unit and the attachment for damage. Never use the multifunction blade with a damaged cutting unit or attachment.

### TRIMMING WITHOUT AN ATTACHMENT

- Turn on the multifunction blade using switch **A3**. Indicator **A4** will be lit.
- Carefully apply the cutting unit to the skin and with slight downward pressure and circular motions, slowly move the multifunction blade up or counter the growth direction of the whiskers.



### Attention:

The blades of the cutting unit will cut off all beards or nose and ear hair that comes into contact with them, therefore be especially careful when handling the multifunction blade while it is running.

- Turn off the multifunction blade using switch **A3**.
- When you have finished using the multifunction blade, always clean it according to the instructions in chapter Cleaning and maintenance.

### TRIMMING WITH AN ATTACHMENT

- The multifunction blade comes with three comb attachments **A6** for greater cutting variability.



### Attention:

Put a comb attachment on to the cutting unit before turning on the multifunction blade and always turn the multifunction blade off before removing it.

- Insert the selected attachment into the multifunction blade from above. Always ensure that the attachment is properly attached.
- When using the multifunction blade for the first time, it is recommended to first try the largest attachment and only thereafter use the smaller attachment.
- Turn on the multifunction blade using switch **A3**. Indicator **A4** will be lit.
- When you have finished using the multifunction blade, always clean it according to the instructions in chapter Cleaning and maintenance.

## ADVICE AND TIPS

- Trim by slowly moving the blade from the top downwards. Ensure that the cutting unit is in full contact with the skin, therefore apply it against the skin over its complete surface.
- Perform long strokes whilst applying slight downward pressure.
- The best shaving results are achieved when the skin on the face and chin is clean.
- When trimming beards using an attachment, keep in mind that the attachment must be in constant contact with the skin in order to ensure an even cut.
- Regularly clean away whiskers from the cutting unit.

## CLEANING AND MAINTENANCE

- Turn off the multifunction blade before cleaning it. Never clean the multifunction blade when it is charging and connected to the power source.
- Regular cleaning after every use will ensure its proper operation.



### Attention:

Except for the cutting unit and the attachments, no other part of the multifunction blade is intended for cleaning under a water tap.

Do not spray the multifunction blade or its USB cable or power adapter with water or any other liquid or submerge it in water or any other liquid.

### CLEANING THE CUTTING UNIT

- If the attachment is mounted on the cutting unit, remove it.
- Use the cleaning brush to remove all facial hair and whisker remains from the cutting unit.
- Release the multifunctional blade upper part by turning it slightly and sliding it upwards (fig. B).



### Attention:

The edges of the cutting unit are sharp, pay increased attention when handling them.

- Use a brush to remove whisker remains from the cutting unit and from the inner area of the multifunction blade underneath the cutting unit.
- After cleaning it, reattach the cutting unit on to the handle of the multifunction blade. First insert the bottom side of the cutting unit into the handle of the multifunction blade and then turn it until you hear an audible click.

CLEANING AN ATTACHMENT

- Clean a used attachment using a brush or rinse it under running lukewarm water. After washing it, carefully wipe it with a soft, dry cloth and then allow it to dry naturally.

CLEANING THE MULTIFUNCTION BLADE

- The body of the multifunction blade can be cleaned using a clean dry cloth. In the event that it is very dirty, you can use a lightly dampened cloth. Then thoroughly wipe the cleaned surface dry.
- To clean the power adapter, use a clean, dry cloth.
- For cleaning, do not use brushes with hard bristles, cleaning products with an abrasive effect, solvents, etc. Otherwise, the cleaned surface may be damaged.

STORAGE

- When you have finished using it, you can store the multifunction blade with all its accessories in a suitable location out of children's reach. Keep the multifunction blade away from extreme temperatures, direct sunlight and excessive humidity. Do not use in an overly dusty environment.

TECHNICAL SPECIFICATIONS

Multifunction blade

Built-in battery.....	Li-ion, 3.7 V, 500 mAh
Input.....	5 V, 1 A
Dimensions (width × depth × height) .....	165 × 40 × 40 mm
Weight.....	103 g
Noise level.....	72 dB(A)

USB power adapter

Input.....	100-240 VAC, 50/60 Hz, 0.2 A
Output.....	5 VDC, 1 A, 5 W
Electrical shock protection class.....	II
Safety class for electrical shock protection.....	IP20

The declared noise emission level of the appliance is 72 dB(A), which represents a level A of acoustic power with respect to a reference acoustic power of 1 pW.

EXPLANATION OF TECHNICAL TERMINOLOGY

Safety class for electrical shock protection:

**IP20** – The appliance is constructed in such a way that it is not possible for any dangerous live parts of the appliance to come into contact with the human body and at the same time the appliance is protected against the damaging effects of water that could enter into the appliance.



**Electric shock protection class:**  
Class II – Electrical shock protection is provided by double or heavy-duty insulation.

Changes to text and technical parameters are reserved.

DISPOSAL OF USED BATTERIES

Prior to handing over the multifunction blade at a specialised collection facility, it is necessary to ensure that the built-in battery is removed. Battery removal will be performed at the authorised service centre. In the event that the product has been disassembled for the purpose of ecological disposal then it must not be reassembled.



This symbol indicates that used batteries do not belong in ordinary municipal waste. Hand over used batteries to designated collection points for proper disposal. Correct disposal of batteries will help prevent negative impacts on the environment and human health.



**Disposal in other countries outside the European Union.**  
This symbol is valid in the European Union. If you wish to dispose of used batteries, request the necessary information about the correct disposal method from the local authorities or from your vendor.

A HASZNÁLT CSOMAGOLÓANYAGOKRA VONATKOZÓ UTASÍTÁSOK ÉS TÁJÉKOZTATÓ

A használt csomagolóanyagot az önkormányzat által kijelölt hulladékgyűjtő helyen adja le.

AZ ELHASZNÁLÓDOTT ELEKTROMOS ÉS ELEKTRONIKUS BERENDEZÉSEK MEGSEMMISSÍTÉSE



Ez a jel a terméken vagy a kísérő dokumentációban arra hívja fel a figyelmét, hogy az elektromos vagy elektronikus termék nem dobható a háztartási hulladék közé. A megfelelő ártalmatlanításhoz és újrafelhasználáshoz a terméket kijelölt gyűjtőhelyen adja le. A fentiek alternatívájaként az EU országokban, illetve más európai országokban, hasonló termék vásárlása esetén az elhasználdott termék az üzletben is leadható.

 A termék megfelelő módon történő megsemmisítésével segít megőrizni az értékes természeti erőforrásokat, és hozzájárul a nem megfelelő hulladék-megsemmisítés által okozott esetleges negatív környezeti és egészségügyi hatások megelőzéséhez. A további részletekről a helyi önkormányzati hivatal vagy a legközelebbi hulladékgyűjtő hely ad tájékoztatást.

Az ilyen típusú hulladék nem megfelelő módon történő megsemmisítése esetén a helyi előírások értelmében bírság szabható ki.

Az Európai Unió országaiban működő vállalkozások részére

Ha elektromos vagy elektronikus berendezést kíván ártalmatlanítani, akkor erre vonatkozóan kérjen információkat a termék eladójától vagy forgalmazójától.

Megsemmisítés az Európai Unió országain kívül

Ez a jel az Európai Unióban érvényes. Amennyiben ezt a terméket ártalmatlanítani kívánja, akkor tájékoztatásért forduljon a termék eladójához vagy a helyi önkormányzati hivatal illetékes osztályához.



A termék megfelel az adott termékekre vonatkozó összes európai uniós műszaki és egyéb előírásnak.