

SENCOR®

SVC 7814VT / SVC 7822TQ



2-IN-1 UPRIGHT VACUUM CLEANER

Translation of the original manual



SENCOR®

SVC 7814VT / SVC 7822TQ



A

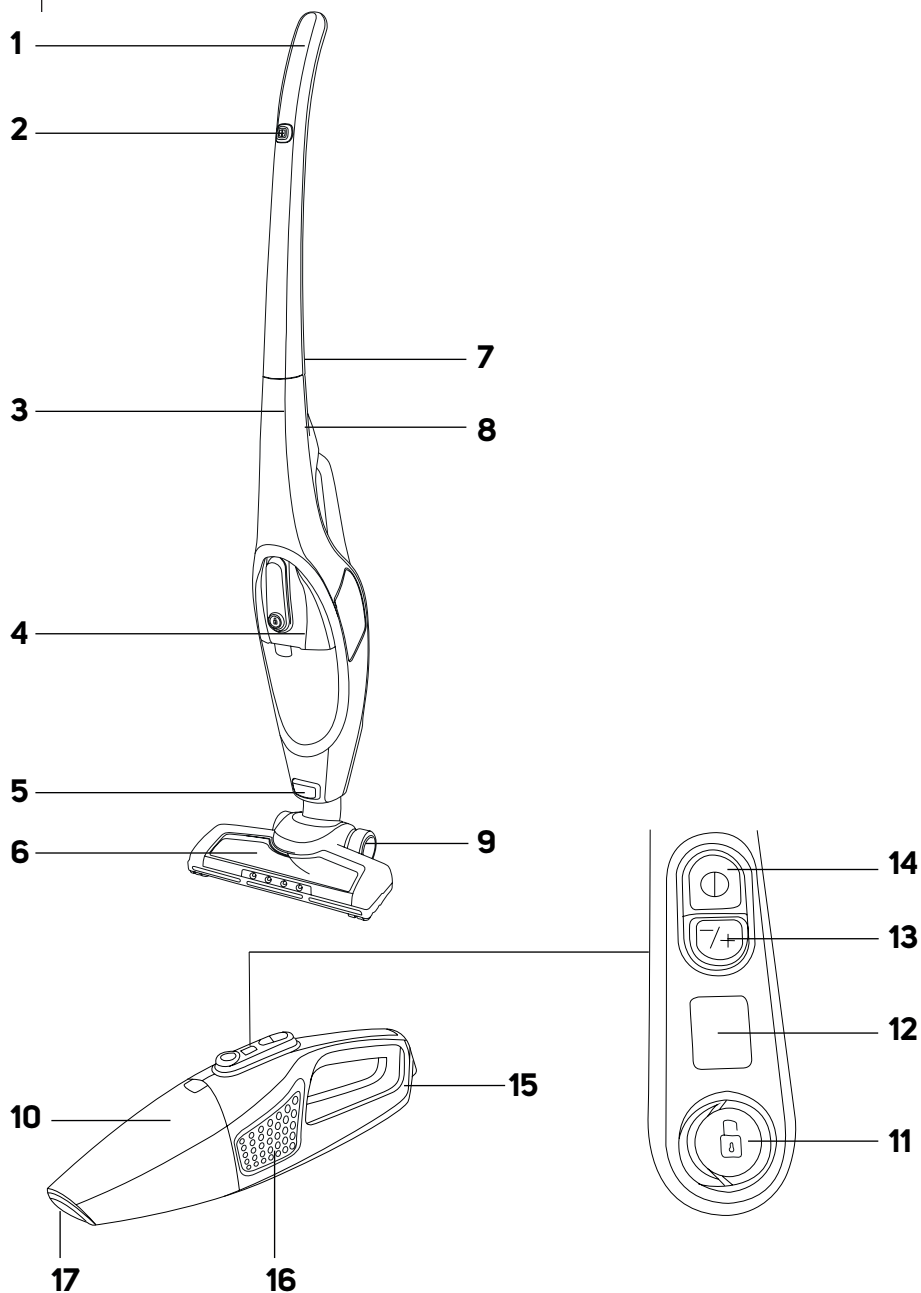

A

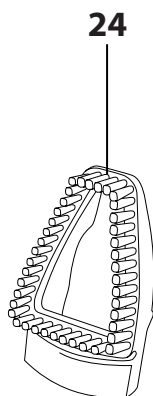
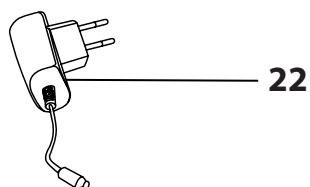
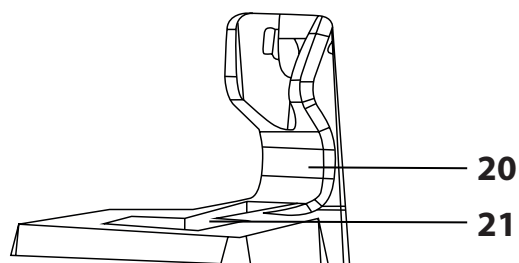
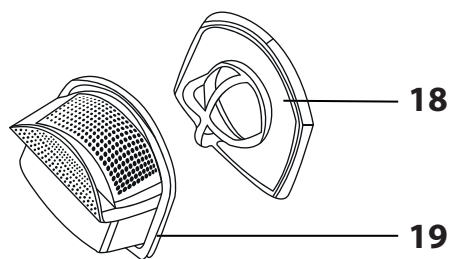

B1

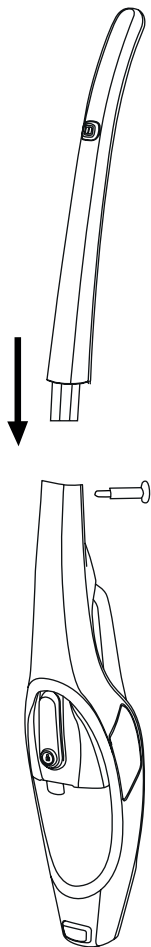

B2

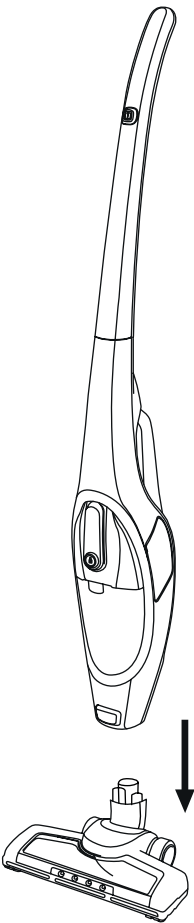

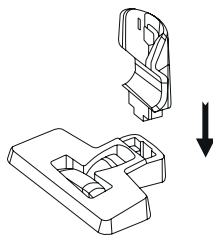
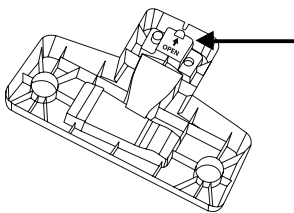
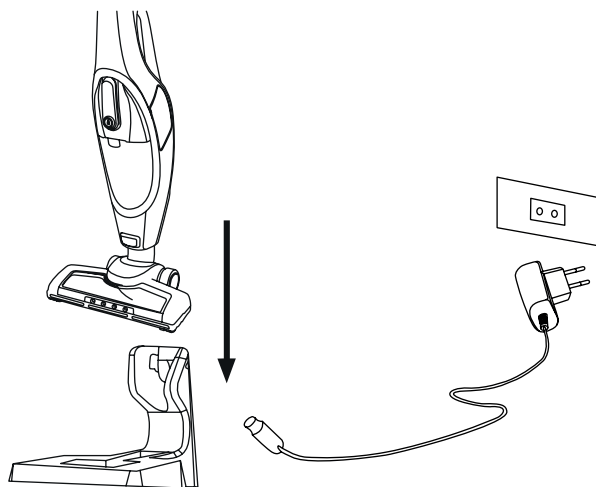
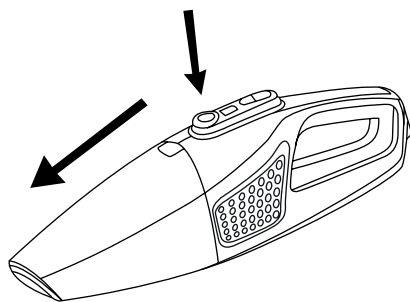
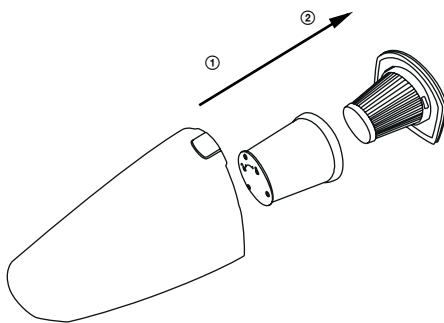
C1**C2****D****E1****E2**

F

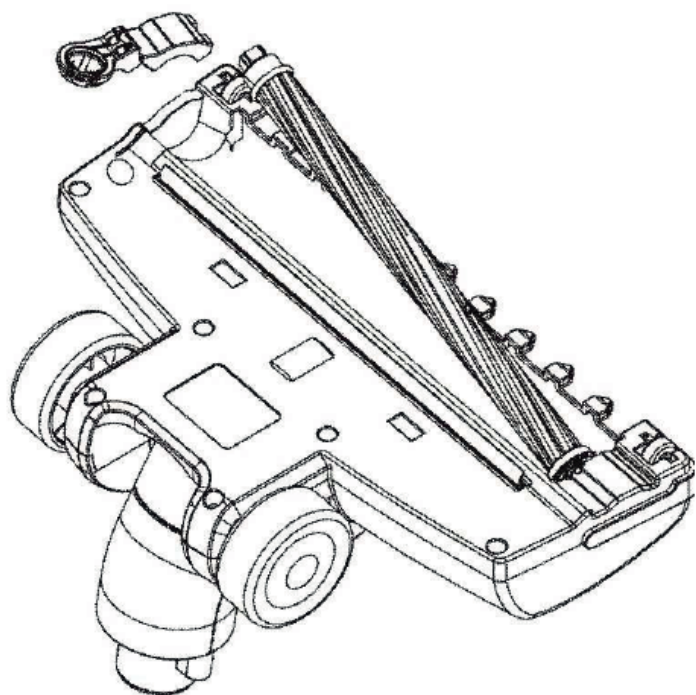

EN 2-in-1 Upright vacuum cleaner

Important safety instructions

READ CAREFULLY AND STORE FOR FUTURE USE.

- This vacuum cleaner may be used by children 8 years of age and older and by persons with physical or mental impairments or by inexperienced persons, if they are properly supervised or have been informed about how to use this vacuum cleaner in a safe manner and understand the potential dangers.
- Children must not play with the appliance. Cleaning and maintenance performed by the user must not be performed by unsupervised children.
- In the event that the power adapter is damaged, it must be replaced with an original type. For a replacement power adapter, please contact an authorised service centre. It is forbidden to use the appliance if it has a damaged power adapter.
- Only use the vacuum cleaner with the original power adapter, charging base and accessories that were supplied with it.

- Keep the vacuum cleaner and its accessories out of reach of children that are younger than 8 years of age.
- Disconnect the power adapter from the power socket before cleaning or performing maintenance on the appliance.
- This vacuum cleaner is designed for use in households, offices and similar types of areas. Do not use in industrial surroundings.
- Do not expose the vacuum cleaner to direct sunlight and do not place it near an open fire or appliances that are a source of heat.
- Before connecting the power adapter to a power socket, check that the technical details on the vacuum cleaner's rating label match the electrical voltage in the socket.
- Make sure the adapter power cord is not touching a hot surface or sharp objects. Position the adapter power cord so that it will not be tripped over.
- Never submerge the vacuum cleaner, the charging base or the power adapter in water or any other liquid and do not wash it under running water.
- Prior to turning on the vacuum cleaner, check that the dust container is correctly installed and the filters are correctly inserted.
- When the vacuum cleaner is running, ensure that the air outlets and the suction hole are not blocked.
- Do not use the vacuum cleaner to vacuum the following items:
 - smouldering cigarettes, burning items, matches or embers;
 - water and other liquids;
 - flammable or volatile materials;
 - sharp items, e.g. broken glass, needles, pins, etc.;
 - flour, wall plaster, cement and other building materials;
 - larger pieces of paper or plastic bags, which can easily block the suction hole.
- Vacuuming of some types of floors or floor surfaces can create an electrostatic discharge, which presents no danger to the user.
- Always turn off the vacuum cleaner when you have finished using it, before cleaning or seating it in the charging base.
- Disconnect the power adapter from the power socket before cleaning it and after it has finished charging.
- Disconnect the power adapter from the power socket by pulling on the plug, never pulling on the power cord. Otherwise, this could damage the power adapter or the socket.
- Do not use the vacuum cleaner if it is not working correctly, if it has been damaged or has been submerged in water. Do not repair the vacuum cleaner yourself or make any adjustments to it. Have all repairs performed at an authorised service centre. By tampering with the appliance, you risk voiding your legal rights arising from unsatisfactory performance or quality warranty.

2-in-1 Upright vacuum cleaner

User's manual

- Thank you for purchasing a SENCOR brand product and we hope that you will be happy with it.
- Prior to using this appliance, please read the user's manual thoroughly, even in cases, when one has already familiarised themselves with previous use of similar types of appliances. Only use the appliance in the manner described in this user's manual. Keep this user's manual in a safe place where it can be easily retrieved for future use.
- We recommend saving the original cardboard box, packaging material, purchase receipt and responsibility statement of the vendor or warranty card for at least the duration of the legal liability for unsatisfactory performance or quality. In the event of transportation, we recommend that you pack the appliance in the original box from the manufacturer.

DESCRIPTION OF THE VACUUM CLEANER AND ITS ACCESSORIES

A1 Handle	A13 Suction power adjustment button of the upright vacuum cleaner
A2 On/Off button of the upright vacuum cleaner	
A3 Body of the upright vacuum cleaner	A14 On/Off button of the hand vacuum cleaner
A4 Hand vacuum cleaner	A15 Hand vacuum cleaner handle
A5 Floor nozzle release button	A16 Air outlets
A6 Floor nozzle with an electric rotary brush	A17 Suction hole
A7 Locking screw	A18 Washable inner HEPA type filter.
A8 Hand vacuum cleaner release button	A19 Washable outer filter
A9 Travel wheels	A20 Charging base
A10 Dust container	A21 Accessory storage compartment
A11 Dust container release button	A22 Power adapter
A12 Battery level indicator	A23 Brush nozzle
	A24 Crevice nozzle

BEFORE FIRST USE

- Before first use, take the appliance and its accessories out of the packaging material and remove all promotional labels and stickers. Check that neither the appliance nor any of its parts is damaged.

ASSEMBLY AND DISASSEMBLY

Assembling and disassembling the hand vacuum cleaner

- When assembling the hand vacuum cleaner **A4**, proceed as follows:
 1. Insert the inner filter **A18** into the outer filter **A19**.
 2. Insert both filters into the dust container **A10** and check that they are properly inserted.
 3. Put the dust container **A10** on to the motor unit of the hand vacuum cleaner.

If you need to disassemble the hand vacuum cleaner **A4**, proceed as follows:

1. Press button **A11**, to release the dust container **A10**. Take the dust container **A10** off the motor unit.
2. Out of the dust container **A10**, remove the outer filter **A19** and the inner filter **A18**.

Assembling and disassembling the upright vacuum cleaner

- For reasons of safety during transport, the upright vacuum cleaner is supplied disassembled.
 1. Attach the handle of the upright vacuum cleaner **A1** to the body of the vacuum cleaner **A3** so that the handle is aligned with the hole in the body of the vacuum cleaner. Insert the supplied screw **A7** into the

hole and screw it in properly – see figure **B1**. Check that the handle is correctly attached and not moving in any way.

2. Into the free space in the body of the vacuum cleaner **A3**, insert the hand vacuum cleaner **A4** by first inserting the suction hole **A17** into the bottom part of the body of the vacuum cleaner **A3** and then carefully tilt down the handle **A15** until you hear a click.
3. Insert the floor nozzle **A6** into the suction hole **A17** of the hand vacuum cleaner – see figure **B2** until you hear a click.
4. If you need to disassemble the upright vacuum cleaner, first remove the hand vacuum cleaner **A4** from the body **A3** by pressing button **A8**. Then press button **A5** to release the floor nozzle **A6**. Finally screw out the locking screw **A7** and carefully pull out the handle **A1** from the body of the vacuum cleaner **A3**.

Assembling the charging base

- For reasons of safety during transport, the charging base **A20** is supplied disassembled.
- Insert the vertical part of the charging base into the horizontal part – see figure **C1**, until you hear a click.
- If you need to disassemble the charging base **A20**, first press the button in the bottom part of the charging base **A20** – see figure **C2**. Then you can slide out the vertical part.

CHARGING THE VACUUM CLEANER

- Place the assembled charging base **A20** on an even, dry and stable surface within reach of a power socket.
- Insert the power adapter plug **A22** into the socket on the underside of the charging base **A20**. Plug the power adapter plug **A22** into a power socket.
- Turn off the upright vacuum cleaner and set it to the vertical parking position. Insert it into the charging base – see figure **D**.
- After insertion into the charging base **A20**, the built-in battery will start being charged and the battery level indicator **A12** will indicate the charging level. A full charge requires approximately 4.5 hours. The actual charging time depends on the power level of the battery.
- When the charging process is completed, all the LED diodes of the indicator **A12** will be lit.
- When you finish cleaning and have cleaned out the appliance, place it back into the stand so that the battery can recharge.
- Keep the charging adapter plugged in permanently. The electronics in the appliance control the battery charging process and ensure that it is always optimally charged. When the battery is fully charged, the electronics interrupt the charging process and resume it when it is necessary to charge the battery again. There is no need to worry about wasting electricity.
- Disconnect the charging adapter from the power socket only in the event of a long term absence. When you return, plug it back into the socket so that the vacuum cleaner is again ready for use.
- The LED diodes of the battery level indicator **A12** indicate the charge level of the battery. The individual LED diodes will turn off as the battery gradually discharges. When the battery is almost flat, the bottom LED diode will start flashing. When it turns off completely, the battery is completely flat.



Note:

Prior to starting recharging, it is important for the vacuum cleaner to be turned off and standing in the vertical parking position. Do not turn on the vacuum cleaner when it is being recharged and the power adapter **A22** is connected to the power socket.

PARKING POSITION OF THE VACUUM CLEANER

- Put the upright vacuum cleaner into the parking position by placing the tip of your foot on top of the floor nozzle **A6** and with a simple forward movement of the handle secure the vacuum cleaner in the vertical position. The latch located at the front on the elbow of the floor nozzle **A6** will slide into the groove on the top cover of the floor nozzle **A6**.
- To release the upright vacuum cleaner from the parking position, place the tip of your foot on top of the floor nozzle **A6** and tilt the handle backwards. The latch located at the front on the elbow of the floor nozzle **A6** will slide out of the groove on the top cover of the floor nozzle **A6**.

USING THE VACUUM CLEANER

Upright vacuum cleaner

- You may use the upright vacuum cleaner for vacuuming various types of floor coverings such as for example hard floor coverings, carpets, etc.
- Hold the vacuum cleaner by the handle and release it from the parking position. After releasing it from the parking position, the handle may be moved in the vertical direction.
- Start the vacuum cleaner by pressing button **A2**. The vacuum cleaner will start at full suction power. If you need to reduce the suction power, press button **A13**. The suction power of the vacuum cleaner will be reduced. Press button **A13** again to again increase the suction power.
- When you have finished using it, turn off the vacuum cleaner by pressing button **A2**. Clean it according to the instructions contained in chapter "Cleaning and maintenance", and allow it to charge according to the instructions contained in chapter "Charging the vacuum cleaner".
- In the event that the rotary brush is clogged while vacuuming, e.g. by a larger amount of vacuumed hair or fur, the automatic safety mechanism is activated, which will stop the rotary brush to prevent it from becoming damaged. Turn off the vacuum cleaner using button **A2** and remove the wound on hair or fur from the rotary brush – more in chapter "Cleaning and maintenance". Prior to turning on the vacuum cleaner again, check that the rotary brush, the dust container **A10** and the filters **A18** and **A19** are clean.

Hand vacuum cleaner

- The hand vacuum cleaner is suitable for vacuuming locally soiled floor coverings, furniture, etc.
- In order to remove the hand vacuum cleaner from the body of the upright vacuum cleaner, press button **A8** and the top part of the hand vacuum cleaner will be released. Hold the hand vacuum cleaner by the handle **A15** and carefully remove it from the body of the upright vacuum cleaner.
- Turn on the hand vacuum cleaner by pressing button **A14**.
- To vacuum dust and dirt from hard-to-reach places, put the crevice nozzle **A24** on to the suction hole **A17**.
- If you need to vacuum dust and dirt from upholstered furniture, put the brush nozzle **A23** on to the suction hole **A17**.
- When you have finished using it, turn off the vacuum cleaner using button **A14**. Clean it according to the instructions contained in chapter "Cleaning and maintenance", and insert it back into the body of the upright vacuum cleaner. Allow it to recharge according to the instructions in chapter "Charging the vacuum cleaner".

CLEANING AND MAINTENANCE

- Before cleaning, make sure that the vacuum cleaner is turned off and the power adapter is disconnected from the power socket. In order to extend the lifetime of the vacuum cleaner, we recommend you perform cleaning and maintenance after every use.



Warning:

To prevent the risk of injury by electrical shock, do not submerge the appliance, power cord or power plug in water or any another liquid.

Dust container and filters

- Press button **A11** to release the dust container **A10** from the body of the hand vacuum cleaner – see figure **E1**. Move the dust container **A10** over a waste bin. Carefully pull the filters **A18** and **A19** out of the dust container **A10** – see figure **E2**.
- Tip out all the contents of the dust container **A10** and rinse it out as necessary under a current of cold running water. Allow it to dry and check that the dust container **A10** is completely dry before reassembly.
- Pull the inner filter **A18** out of the outer filter **A19**. Remove dust and dirt from the outer filter **A19** rinse it out as necessary under a current of cold running water. Allow it to dry and check that the outer filter **A19** is completely dry before reassembly.
- Carefully remove any soils from the inner filter **A18**. If the inner filter **A18** is excessively soiled, rinse it under running water. Allow it to dry naturally.
- Assemble the dust container **A10** and filters **A18** and **A19** in reverse sequence.



Warning:

Before assembling the vacuum cleaner, make sure that all its parts are completely dry. Prior to starting it, make sure that all the filters are properly installed in their place. Otherwise, this could damage the vacuum cleaner. When filters are soiled, their effectiveness is reduced, so do not neglect their cleaning.

- It is recommended to replace the inner filter **A18** with a new one after 6 months of use. Spare filters are available at brick and mortar, and online stores.

Floor nozzle

- If the rotary brush is soiled, turn the floor nozzle **A6** so that the rotary brush is pointing upwards. On the left side of the nozzle **A6** there is a latch that secures the brush cover in place. Release the latch, tilt open the cover and take out the brush – see figure **F**.
- Remove all dirt and dust from the rotary brush and the internal space of the floor nozzle **A6**. After cleaning, return the rotary brush back in its place. Tilt the cover back and secure it in place.
- For cleaning the surface of the floor nozzle **A6**, use a dry or a lightly dampened cloth. Then wipe everything so that it is thoroughly dry.

Outer surface of the vacuum cleaner

- Clean the outer surface of the vacuum cleaner using a dry or a lightly dampened cloth. Then wipe everything so that it is thoroughly dry.



Warning:

Do not clean any part of the vacuum cleaner using steel wool, abrasive cleaning products, petrol, solvents or any other similar products.

Storage

- When not using the vacuum cleaner for an extended period of time, clean it according to the instructions provided above.
- Before storing it, check that the vacuum cleaner is perfectly clean and dry.
- Store the vacuum cleaner in a dry, clean and well-ventilated location not exposed to extreme temperatures and out of children's reach.

TECHNICAL SPECIFICATIONS

SVC 7822TQ

Power adapter

Input.....100 – 240 V ~, 50/60 Hz, 0.35 A
Output.....26 V  0.5 A
Electrical shock protection class.....II

Vacuum cleaner

Power input110 W
Electric rotary brush.....10 W
Li-Ion battery22.2 V  Li-Ion / 2,200 mAh
Time required for charging to full capacityapproximately 4.5 hours
Operating time when fully charged (high / low power).....up to 20 / 45 min
Noise level.....≤ 76 dB(A)
Dust container capacity0.5 l

SVC 7814VT

Power adapter

Input.....100 – 240 V ~, 50/60 Hz, 0.35 A
Output.....18 V  0.5 A
Electrical shock protection class.....II

Vacuum cleaner

Power input110 W
Electric rotary brush.....10 W
Li-Ion battery14.8 V  Li-Ion / 2,200 mAh
Time required for charging to full capacityapproximately 4.5 hours
Operating time when fully charged (high / low power).....up to 16 / 35 min
Noise level.....≤ 76 dB(A)
Dust container capacity0.5 l

The declared noise emission level of models SVC 7822TQ a SVC 7814VT is ≤ 76 dB(A), which represents level A of acoustic power with respect to a reference acoustic power of 1 pW.



Safety class for electrical shock protection:
Class II – Electrical shock protection is provided by double or heavy-duty insulation.



The product is intended for household use only. The product is not intended for outdoor use.

We reserve the right to change text and technical specifications.
.....

INSTRUCTIONS AND INFORMATION REGARDING THE DISPOSAL OF USED PACKAGING MATERIALS

Dispose of used packaging material at a site designated for waste in your municipality.

DISPOSAL OF USED ELECTRICAL AND ELECTRONIC EQUIPMENT



This symbol on products or original documents means that used electric or electronic products must not be added to ordinary municipal waste. For proper disposal, renewal and recycling hand over these appliances to determined collection points. Alternatively, in some European Union states or other European countries you may return your appliances to the local retailer when buying an equivalent new appliance.

Correct disposal of this product helps save valuable natural resources and prevents potential negative effects on the environment and human health, which could result from improper waste disposal. Ask your local authorities or collection facility for more details.

In accordance with national regulations penalties may be imposed for the incorrect disposal of this type of waste.

For business entities in European Union states

If you want to dispose of electric or electronic appliances, ask your retailer or supplier for the necessary information.

Disposal in other countries outside the European Union.

This symbol is valid in the European Union. If you wish to dispose of this product, request the necessary information about the correct disposal method from the local council or from your retailer.



This product meets all the basic requirements of EU directives related to it.

DISPOSAL OF BATTERIES



Prior to disposing of the product or handing it over at a specialised collection facility, it is necessary to ensure that the built-in battery is removed. Before removing the battery, it is necessary to start the vacuum cleaner and wait until it is completely flat. Battery removal will be performed at the authorised service centre.

The battery contains environmentally damaging substances and therefore does not belong in standard household waste. Their correct disposal will be performed by the respective collection facility.

