



FIELDMANN®
Home & Garden Performance

20V Li-ION
FASTPOWER



FDW 70905-0

English	7-22
Čeština.....	23-40
Slovenčina	41-58
Magyarul	59-74
Polski	75-92

1

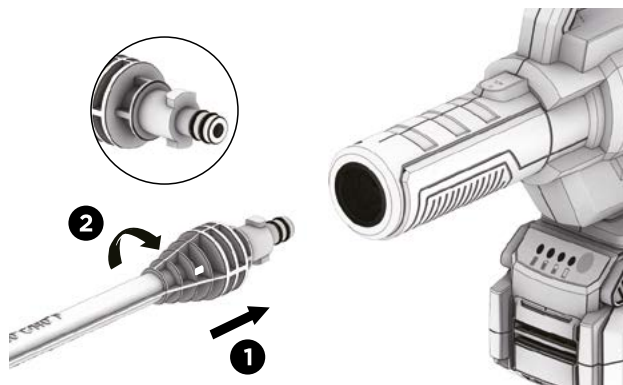

2

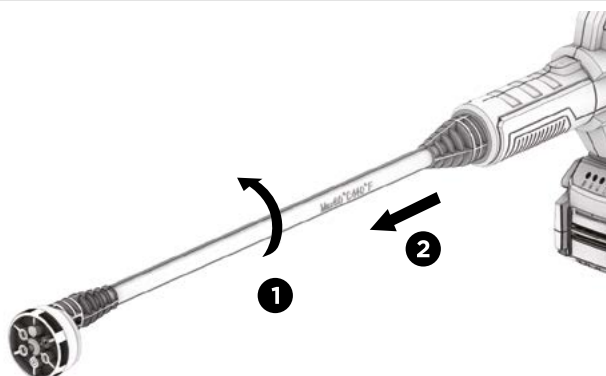

3

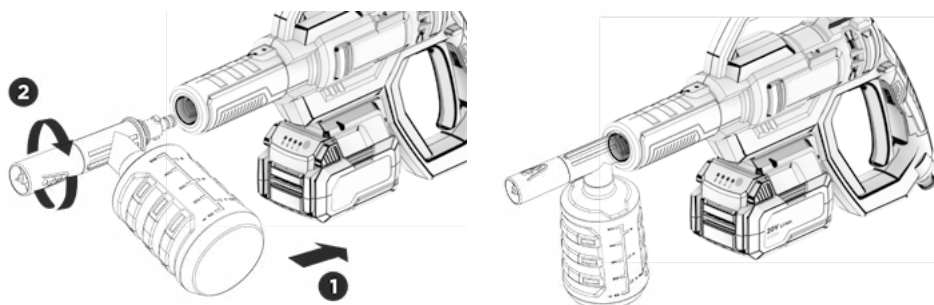

4

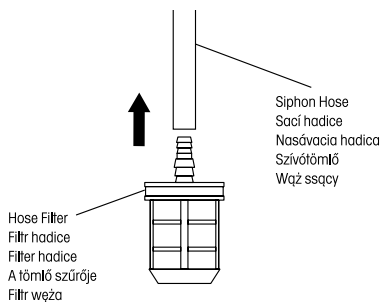
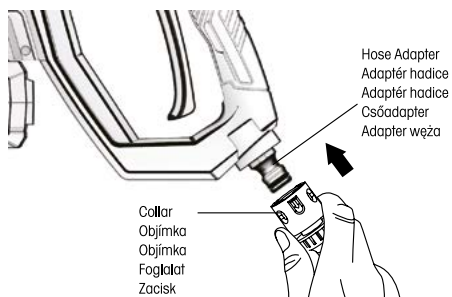

5

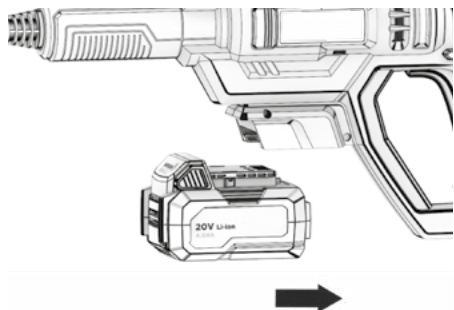

6

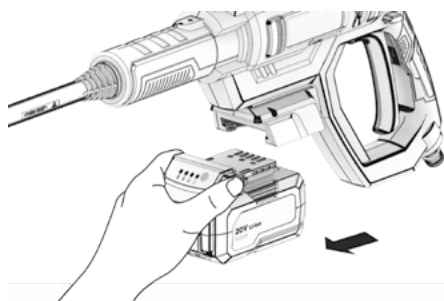

7

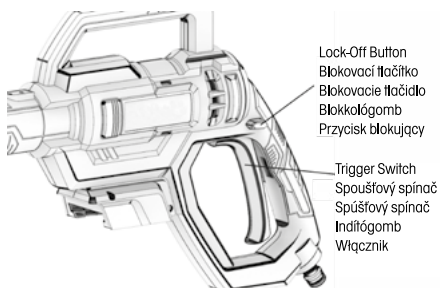

8

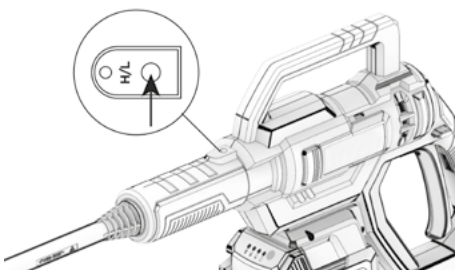

9

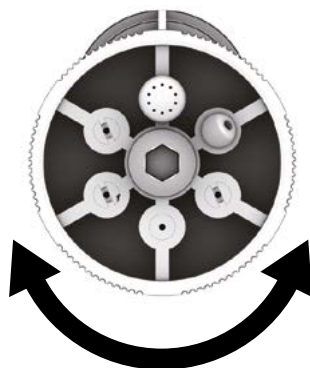

10

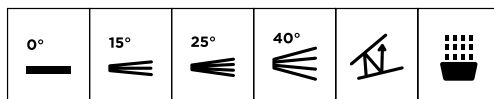

11

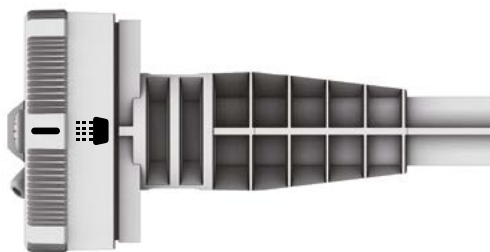

Cordless High Pressure Washer



USER'S MANUAL

Thank you for purchasing this Cordless High Pressure Washer. Before you start using it, please carefully read this user's manual and save it for possible future use.

TABLE OF CONTENTS

1. General power tool safety warnings.....	8
2. Symbols.....	11
3. Description.....	12
4. Technical data	12
5. Assembly	14
6. Operation.....	15
7. Maintenance	18
8. Troubleshooting.....	20
9. Disposal.....	21
10. Declaration of conformity	22

1. GENERAL POWER TOOL SAFETY WARNINGS

- ✿ This device is suited solely for the blowing of light and dry materials such as leaves, garden waste, grass, small branches, and small pieces of paper.
- ✿ This appliance is intended for use on private properties only.
- ✿ This product is not intended for commercial use. Generally acknowledged accident prevention regulations and enclosed safety Instructions must be observed.
- ✿ Only perform work described in these Instructions for use. Any other use is improper. The manufacturer will not assume responsibility for damage resulting from such use.

⚠ WARNING!

Read and understand all instructions. Failure to follow the warnings and Instructions may result in electric shock, fire and/or serious injury. Save all warnings and instructions for future reference. The term „power tool“ in the warnings refers to your mains-operated (corded) power tool or battery-operated (cordless) power tool.

Work area safety

- a. Keep work area clean and well lit. Cluttered or dark areas invite accidents.
- b. Do not operate power tools in explosive atmospheres, such as in the presence of flammable liquids, gases or dust. Power tools create sparks which may ignite the dust or fumes.
- c. Keep children and bystanders away while operating a power tool. Distractions can cause you to lose control.

Electrical safety

- a. Power tool plugs must match the outlet. Never modify the plug in any way. Do not use any adapter plugs with earthed (grounded) power tools.
Unmodified plugs and matching outlets will reduce risk of electric shock.
- b. Avoid body contact with earthed or grounded surfaces, such as pipes, radiators, ranges and refrigerators.
There is an increased risk of electric shock if your body is earthed or grounded.
- c. Do not expose power tools to rain or wet conditions.
Water entering a power tool will increase the risk of electric shock.
- d. Do not abuse the cord. Never use the cord for carrying, pulling or unplugging the power tool. Keep cord away from heat, oil, sharp edges or moving parts. Damaged or entangled cords increase the risk of electric shock.
- e. When operating a power tool outdoors, use an extension cord suitable for outdoor use. Use of a cord suitable for outdoor use reduces the risk of electric shock.

Personal safety

- a. Stay alert, watch what you are doing and use common sense when operating a power tool. Do not use a power tool while you are tired or under the influence of drugs, alcohol or medication. A moment of inattention while operating power tools may result in serious personal injury.
- b. Use personal protective equipment. Always wear eye protection. Protective equipment such as dust mask, non-skid safety shoes, hard hat, or hearing protection used for appropriate conditions will reduce personal injuries.
- c. Prevent unintentional starting. Ensure the switch is in the off-position before connecting to power source and/or battery pack, picking up or carrying the tool. Carrying power tools with your finger on the switch or energising power tools that have the switch on invites accidents.

- d. Remove any adjusting key or wrench before turning the power tool on. A wrench or a key left attached to a rotating part of the power tool may result in personal injury.
- e. Do not overreach. Keep proper footing and balance at all times. This enables better control of the power tool in unexpected situations.
- f. Dress properly. Do not wear loose clothing or jewellery. Keep your hair, clothing and gloves away from moving parts. Loose clothes, jewellery or long hair can be caught in moving parts.
- g. If devices are provided for the connection of dust extraction and collection facilities, ensure these are connected and properly used. Use of dust collection can reduce dust-related hazards.

Power tool use and care

- a. Do not force the power tool. Use the correct power tool for your application. The correct power tool will do the job better and safer at the rate for which it was designed.
- b. Do not use the power tool if the switch does not turn it on and off. Any power tool that cannot be controlled with the switch is dangerous and must be repaired.
- c. Disconnect the plug from the power source and/or the battery pack from the power tool before making any adjustments, changing accessories, or storing power tools. Such preventive safety measures reduce the risk of starting the power tool accidentally.
- d. Store idle power tools out of the reach of children and do not allow persons unfamiliar with the power tool or these instructions to operate the power tool. Power tools are dangerous in the hands of untrained users.
- e. Maintain power tools. Check for misalignment or binding of moving parts, breakage of parts and any other condition that may affect the power tool's operation. If damaged, have the power tool repaired before use. Many accidents are caused by poorly maintained power tools.
- f. Keep cutting tools sharp and clean. Properly maintained cutting tools with sharp cutting edges are less likely to bind and are easier to control.
- g. Use the power tool, and accessories in accordance with these Instructions, taking into account the working conditions and the work to be performed. Use of the power tool for operations different from those intended could result in a hazardous situation.
- h. This appliance is not intended for use by persons (including children) with reduced physical, sensory or mental capabilities, or lack of experience and knowledge, unless they have been given supervision or instruction concerning use of the appliance by a person responsible for their safety.
- i. Children should be supervised to ensure that they do not play with the appliance.

Battery tool use and care

- a. Ensure the switch is in the off position before inserting battery pack. Inserting the battery pack into power tools that have the switch on invites accidents.
- b. Recharge only with the charger specified by the manufacturer. A charger that is suitable for one type of battery pack may create a risk of fire when used with another battery pack.
- c. Use power tools only with specifically designated battery packs. Use of any other battery packs may create a risk of injury and fire.
- d. When battery pack is not in use, keep it away from other metal objects like paper clips, coins, keys, nails, screws, or other small metal objects that can make a connection from one terminal to another. Shorting the battery terminals together may cause burns or a fire.
- e. Under abusive conditions, liquid may be ejected from the battery; avoid contact. If contact accidentally occurs, flush with water. If liquid contacts eyes, additionally seek medical help. Liquid ejected from the battery may cause irritation or burns.

Service

- a. Have your power tool serviced by a qualified repair person using only identical replacement parts. This will ensure that the safety of the power tool is maintained.

ADDITIONAL SAFETY INSTRUCTIONS

Wear ear protectors.

Exposure to noise can cause hearing loss.

Loss of control can cause personal injury.

- ✿ If possible, always use clamps or a vice to hold your work piece.
- ✿ Always switch off before you put the tool down.
- ✿ Ensure that the lighting is adequate.
- ✿ Do not put pressure on the tool, such that it slows the motor down.
- ✿ Keep the area free of tripping hazards.
- ✿ Do not let anyone under 18 years operate this tool.
- ✿ Only use accessories in good condition.
- ✿ Do not touch the blade after operation. It will be very hot.
- ✿ Keep your hands away from under the workpiece.
- ✿ Never use your hands to remove sawdust, chips or waste close by the blade.
- ✿ Rags, cloths, cord, string and the like should never be left around the work area.
- ✿ Support the work properly.
- ✿ If you are interrupted when operating the tool, complete the process and switch off before looking up.
- ✿ Periodically check that all nuts, bolts and other fixings are properly tightened.
- ✿ When using the tool, use safety equipment including safety glasses or shield, ear defenders, and protective clothing including safety gloves.
- ✿ Wear a dust mask if the cutting or sanding operation creates dust.

If in doubt, do not plug in the tool. Using a power source with a voltage less than the nameplate rating is harmful to the motor.

The tool must be used only for its prescribed purpose. Any use other than those mentioned in this Manual will be considered a case of misuse. The user and not the manufacturer shall be liable for any damage or injury resulting from such cases of misuse.

To use this tool properly, you must observe the safety regulations, the assembly instructions and the operating instructions to be found in this Manual. All persons who use and service the machine have to be acquainted with this Manual and must be informed about its potential hazards.

Children and frail people must not use this tool. Children should be supervised at all times if they are in the area in which the tool is being used, it is also imperative that you observe the accident prevention regulations in force in your area. The same applies for general rules of occupational health and safety.

The manufacturer shall not be liable for any changes made to the tool nor for any damage resulting from such changes. Even when the tool is used as prescribed it is not possible to eliminate all residual risk factors. The following hazards may arise in connection with the tool's construction and design:

Damage to the lungs if an effective dust mask is not worn.

Damage to hearing if effective ear defenders are not worn.

⚠ WARNING!

To reduce the risk of Injury, the user must read and understand the operator's manual before using this product.

SAVE THIS MANUAL FOR FUTURE REFERENCE

2. SYMBOLS

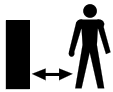
**Keep other persons in distance!**

WARNING! When operating the device, take care that no other persons are nearby (safe distance: 5m). This is particularly valid for children and animals.



Read the Instruction Manual attentively prior to use.



Protect the tool from the damp and never expose it to rain!



Use ears protective equipment



Use eyes protective equipment

3. DESCRIPTION

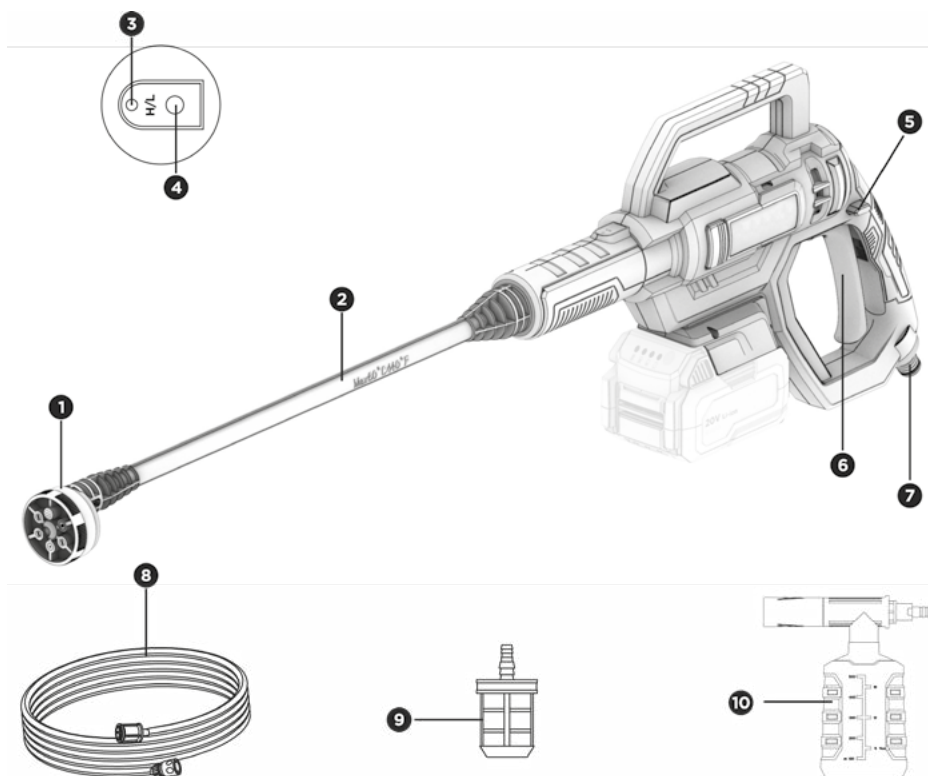

1. 6-in-1 Nozzle
2. Spray Wand
3. Pressure LED Indicator
4. Pressure Setting Button
5. Lock-Off Button

6. Trigger Switch
7. Hose Adapter
8. Siphon Hose
9. Hose Filter
10. Soap Bottle

4. TECHNICAL DATA

MODEL	FZF 70905-0
Voltage	1 x 20 V
Working Pressure	22 bar
Self-priming Hose included	yes
Max. Flow Rate	2,5 l/min

Accessories

Item number	Accessory
FDUZ 79020	Battery pack 2 Ah
FDUZ 79040	Battery pack 4 Ah
FDUZ 79100	Fast charger
FDUZ 79110	Fast dual charger

Packing list

Part Name	Quantity
Cordless High Pressure Washer	1
Spray Wand (with 6-in-1 Nozzle)	1
Hose Filter	1
Soap Bottle	1
Self-priming Hose	1

5. ASSEMBLY

UNPACKING

- ✿ This product requires assembly.
- ✿ Carefully remove the product and any accessories from the box. Make sure that all items listed in the packing list are included.
- ✿ Inspect the tool carefully to make sure that no breakage or damage occurred during shipping.
- ✿ Do not discard the packing material until you have carefully inspected and satisfactorily operated the tool.
- ✿ If any parts are damaged or missing, please contact Litheli Customer Service.

ASSEMBLING THE SPRAY WAND WITH THE 6-IN-1 NOZZLE

⚠ WARNING! Do not insert the battery until assembly is complete. Failure to comply could result in accidental starting and possible property damage.

⚠ WARNING! If any parts are damaged or missing do not operate this product until the parts are replaced. Use of this product with damaged or missing parts could result in serious personal injury.

📖 Note: The 6-in-1 nozzle is integrated with the spray wand and they are non-detachable. No additional assembly between the nozzle and the spray wand is required.

- ✿ Insert the inlet end of the spray wand into the power cleaner and rotate clockwise to secure (when the power cleaner is pointing at the user) **(Fig. 1)**.
- ✿ Pull on the spray wand to be certain it is properly secured.
- ✿ To remove, rotate the spray wand counterclockwise (when the power cleaner is pointing at the user) and pull it out from the power cleaner. **(Fig. 2)**

ASSEMBLING THE SOAP BOTTLE (Fig. 3)

- ✿ Insert the inlet end of the soap bottle into the power cleaner and rotate clockwise to secure (when the power cleaner is pointing at the user).
- ✿ Pull on the soap bottle to be certain it is properly secured.
- ✿ To remove, rotate the soap bottle counterclockwise (when the power cleaner is pointing at the user) and pull it out from the power cleaner.

CONNECTING THE SIPHON HOSE TO THE POWER CLEANER (Fig. 4)

- ✿ Completely uncoil and straighten the siphon hose to prevent kinks.
- ✿ Align the quick connect collar on the siphon hose to the hose adapter on the power cleaner.
- ✿ Push the collar onto the hose adapter until it clicks securely into place.
- ✿ Pull on the hose to be certain it is properly secured.
- ✿ Insert the hose filter into the other end of siphon hose.
- ✿ Drop the other end with the filter into a bucket of water or into fresh water.

6. OPERATION

⚠ WARNING! To reduce the risk of fire, personal injury, and product damage due to a short circuit, never immerse your tool, battery pack or charger in fluid or allow a fluid to flow inside them. Corrosive or conductive fluids, such as seawater, certain industrial chemicals, and bleach or bleach-containing products, etc., can cause a short circuit.

⚠ WARNING! If any parts are damaged or missing, do not operate this product until the parts are replaced. Use of this product with damaged or missing parts could result in serious personal injury.

⚠ WARNING! Do not attempt to modify this product or create accessories not recommended for use with this tool. Any such alteration or modification is misuse and could result in a hazardous condition leading to possibly serious personal injury.

⚠ WARNING! Always remove the battery pack from the product when you are assembling parts, making adjustment, cleaning, or when the product is not in use.

To install/remove battery pack (not supplied)

✿ Lock the trigger switch “OFF” on the tool by depressing the lock-off button to the locked position. NOTICE: Battery pack is not supplied with this machine.

To install the battery pack (Fig. 5)

✿ Align the raised rib on the battery pack with the grooves in the tool, and then slide the battery pack onto the tool. Push to the end with a sufficient force until the battery pack clicks to lock in place.

To remove the battery pack (Fig. 6)

✿ Depress the battery release button to release the battery pack. Pull the battery pack out and remove it from the tool.

📖 **Note:** When placing the battery pack on the tool, be sure that the raised rib on the battery pack aligns with the groove inside the tool and that the latches snap into place properly. Improper attachment of the battery pack can cause damage to internal components.

⚠ WARNING! Battery tools are always in operating condition. Therefore, the lock off button should always be depressed and in the locked position when the tool is not in use or carrying at your side.

STARTING/STOPPING THE POWER CLEANER

⚠ WARNING! Hold the power cleaner securely with both hands. Expect the power cleaner to move when the trigger is pulled due to reaction forces. Failure to do so could cause loss of control and injury to yourself and others.

📖 **Note:** Never place or immerse the unit in standing water.

To Start the Power Cleaner (Fig. 7)

- ✿ Connect the filtered end of siphon hose into water source.
- ✿ Install the battery pack.
- ✿ Place the lock-off button in the unlocked position.
- ✿ Squeeze and hold the trigger switch to operate.

 **Note:** Start with the nozzle 1-2 ft. away from the cleaning surface and carefully approach the surface just until the desired level of cleaning is achieved. If the spray is too close it can damage the cleaning surface.

TO STOP THE POWER CLEANER

- ✿ Release the trigger switch to stop the flow of water through the nozzle.
- ✿ Place the lock-off button in the locked position.
- ✿ Remove the battery pack.













ADJUSTING THE CLEANING PRESSURE

- ✿ Your tool is equipped with a two-setting pressure for cleaning at “L” or “H” pressure. A button is located on the front of the tool to select either “L” or “H” speed (**Fig. 8**).

SELECTING THE NOZZLE PATTERN

- ✿ Before starting any cleaning job, determine and choose a best nozzle pattern for your job. Refer to the Nozzle Selection Guide (**Fig. 12**) for more information. Rotate the 6-in-1 nozzle until the desired position is selected (**Fig. 9**).

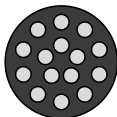
Fig. 12 | Nozzle Selection Guide

	0° 	It sprays a straight water column.
	15° 	It sprays a 15° fan-shaped water jet.
	25° 	It sprays a 25° fan-shaped water jet.
	40° 	It sprays a 40° fan-shaped water jet.
		The water column is ejected with a fixed bevel angle of 45°. For example, the water column could be ejected upwards while the power cleaner is pointing downwards. It can be used for cleaning the underside of vehicles or furniture.
		Showering mode. It is best for watering.

⚠ CAUTION! Never change spray pattern without stopping the power cleaner and the battery removed.

⚠ WARNING! High-pressure jets can be dangerous if subject to misuse. The jet must not be directed at persons, pets, live electrical equipment, or the appliance itself.

CHANGING THE NOZZLE PATTERN

- ✿ Turn off the power cleaner and shut off the water supply.
- ✿ Engage the lock off on the trigger by moving the lock-off button to the locked position.
- ✿ Select a right nozzle pattern for the job.
Refer to SELECTING THE NOZZLE PATTERN above.
- ✿ Rotate the 6-in-1 nozzle to the desired position (**Fig. 10**). Make sure the right nozzle pattern symbol located on the rotary nozzle plate is aligned with the indicator mark  located on the fixed spray wand (**Fig. 11**).
- ✿ Start at the top of the area to be rinsed and work down, overlapping the strokes.

USING THE SOAP BOTTLE

Soap bottle provides detergent suds for deeper cleaning of dirt. It is used in conjunction with power cleaner.

7. MAINTENANCE

⚠ WARNING! To avoid serious personal injury, always remove the battery pack from the tool when cleaning or performing any maintenance.

⚠ WARNING! Never use water or any liquids to clean or rinse off your product and do not expose the product to rain. Store indoors in a dry area. Corrosive liquids, water, and chemicals can enter the product's electronic components and/or battery compartment and damage electronic components and/or the battery pack, which can result in a short circuit, increased risk of fire, and serious personal injury. Remove any buildup of dirt and debris by wiping the product clean with a dry cloth occasionally.

SERVICE

⚠ WARNING! Preventive maintenance performed by unauthorized personnel may result in misplacing of internal wires and components which could cause serious hazard. We recommend that all tool service be performed by a Litheli Customer Service Center.

GENERAL MAINTENANCE

⚠ WARNING! When servicing, use only identical replacement parts. Use of any other parts could create a hazard or cause product damage.

Periodically inspect the entire product for damaged, missing, or loose parts such as screws, nuts, bolts, caps, etc. Securely tighten all fasteners and caps and do not operate this product until all missing or damaged parts are replaced. Please contact Litheli Customer Service for assistance.

CLEANING THE PORTABLE POWER CLEANER

Avoid using solvents when cleaning plastic parts. Most plastics are susceptible to damage from various types of commercial solvents and may be damaged by their use. Use clean cloths to remove dirt, dust, oil, grease, etc.

⚠ WARNING! Do not at any time let brake fluids, gasoline, petroleum-based products, penetrating oils, etc., come in contact with plastic parts. Chemicals can damage, weaken or destroy plastic which could result in serious personal injury.

PUMP LUBRICATION

The pump on this unit is lubricated with a sufficient amount of high-grade lubricant for the life of the unit under normal operating conditions.

Therefore, no further lubrication is required.

STORING THE PORTABLE POWER CLEANER

Store in a dry, covered area where the weather can't damage it. It is important to store this product in a frost-free area. Always empty water from all hoses, and the pump, before storing.

☼ Remove the battery and store in a secure location out of the reach of children.

- ✿ Disconnect all hoses. Before removing the battery, press the switch to allow all water to drain from the power cleaner.
- ✿ Neatly coil the siphon hose and store with power cleaner.
- ✿ Remove the spray wand as described in ASSEMBLING THE SPRAY WAND WITH THE 6-IN-1 NOZZLE. Store the spray wand and nozzle with the cleaner.
- ✿ Store the unit and accessories in an area that does not reach freezing temperatures. Do not store near furnace or other sources of heat that could dry out the pump seals.

STORING THE BATTERY PACK (Not supplied)

- ✿ Protect the battery against moisture and water.
- ✿ Store the battery only within a temperature range from 41°F(5°C) to 104°F(40°C). As an example, do not leave the battery in a vehicle or in the machine in direct sunlight.
- ✿ Clean the ventilation slots of the battery occasionally with a soft, clean and dry brush. A considerably shortened operating time after charging is an indication that the battery is exhausted and must be replaced.
- ✿ If you do not use the product for a long time, please charge and discharge the battery pack once every month.

8. TROUBLESHOOTING

Problem	Possible Cause	Solution
Tool will not start.	Battery pack is depleted.	Charge the battery pack.
	Battery pack is not installed properly.	Make sure battery is locked and secured to the tool.
	Burned out switch.	Contact Litheli Customer Service.
Machine turns on but it does not draw any water or there is not sufficient pressure.	Power nozzle is too high from the water source surface.	Lower the machine below 5ft/1.5m.
	Hose filter is blocked.	Take out the hose filter and rinse the parts with clean water.
	Pump, hose, or other parts are frozen due to outside temperatures.	Wait for the pump, hose or other parts to thaw.
	Hose kinks.	Straighten out the hose.
6-in-1 nozzle leaks.	The selected nozzle pattern symbol is not aligned well with the indicator mark.	Make sure the nozzle pattern symbol aligns with the indicator mark on the spray wand.
Outlet pressure increases suddenly.	6-in-1 nozzle is blocked.	Replace with a new spray wand (with 6-in-1 nozzle).
Machine drains out water after stopping.	There is water remaining in the spray wand and pump after stopping.	Drain all the water completely before storage.
Soap bottle cannot spray out any detergent.	Blockage in the soap bottle.	Clean it with fresh water.
Machine pressure is not consistent.	Additional air could be sucked into the machine.	Check connection between the hose adapter and the siphon hose.
	It is at low pressure setting.	No action needed.
Machine stops automatically.	Battery pack is empty.	Replace with a new battery pack or recharge the battery pack.
	The 6-in-1 nozzle is blocked. The current protection is activated.	Remove the 6-in-1 nozzle with the spray wand and turn on the machine. If the machine works normally, replace with a new spray wand (with 6-in-1 nozzle).

9. DISPOSAL



The machine, rechargeable batteries, accessories and packaging should be sorted for environmental friendly recycling.

Do not dispose of power tools and batteries/rechargeable batteries into household waste!

Only for EC countries:



According to the European Guideline 2012/19/EU, power tools that are no longer usable, and according to the European Guideline 2006/66/EC, defective or used battery packs/batteries, must be collected separately and disposed of in an environmentally correct manner.

INSTRUCTIONS AND INFORMATION ON DISPOSING OF USED PACKAGING MATERIALS

Put any used package material to the place determined by the municipality for waste disposal.

DISPOSAL OF USED ELECTRIC AND ELECTRONIC EQUIPMENT

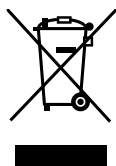

This symbol on products or accompanying documents means that used electric or electronic products must not be put to ordinary municipal waste. Hand over such products to determined collection points for proper disposal, restoration and recycling. Alternatively, in some countries of the European Union or other European countries you can return your products to your local dealer when you buy an equivalent new product. By dutiful disposal of this product you can preserve precious natural resources and you help prevent any potential adverse effects on the environment and human health which could be the results of wrong waste disposal. Ask your local authority or the nearest collection point for additional details. In case of improper disposal of this waste kind penalties can be imposed in accordance with national regulations.

For companies in the European Union countries

Should you want to dispose of electric and electronic devices, ask your dealer or vendor for necessary information.

Disposal in other countries outside the European Union

Should you want to dispose of this product, ask your local authorities or your dealer for necessary information about disposal method.



This product fulfils all basic requirements of the EU directives that apply to it.

Text, design and technical specifications can change without prior notice and we reserve the right for their change.

User manual in the original language.

10. DECLARATION OF CONFORMITY

FAST®

FAST ČR, a.s.
Černokostelecká 2111, 100 00 Praha 10, Czech Republic
tel.: +420 323 204 111, fax: +420 323 204 110

EU DECLARATION OF CONFORMITY

Product/ brand: Battery High Pressure Cleaner / **FIELDMANN**

Type/ model: **FDW 70905-0** as factory model Q0W-WYT01-18Li
DC 20 V, 150 W, IPX0, Class III

Manufacturer: FAST ČR, a.s.
Černokostelecká 2111, 100 00 Praha 10, Czech Republic
VAT no: CZ26726548

The product is inline with directives and regulations listed below:

Directive LVD 2014/35/EU

Directive EMC 2014/30/EU

Directive RoHS 2011/65/EU

and norms:

EN 60335-1:2012+A11+A13+A1+A14+A2

EN 60335-2-54:2008+A1+A11

EN 62233:2008

EN 55014-1:2017

EN 55014-2:2015



Place of issuance: Prague

Name: Ing. Zdeněk Pech
Chairman of the Board

Date of issuance: 4. 12. 2020

Signature:

FAST® FAST ČR, a.s.
Černokostelecká 2111, 100 00 Praha 10
IČO: 26726548 tel.: +420 323 204 111
DIČ: CZ26726548 fax: +420 323 204 110

20V LITHION
FASTPOWER



 **FIELDMANN®**
Home & Garden Performance