



20V LI-ION
FASTPOWER



FZS 70101-0

English	5-22
Čeština	23-42
Slovenčina	43-62
Magyarul	63-80
Polski	81-107

1

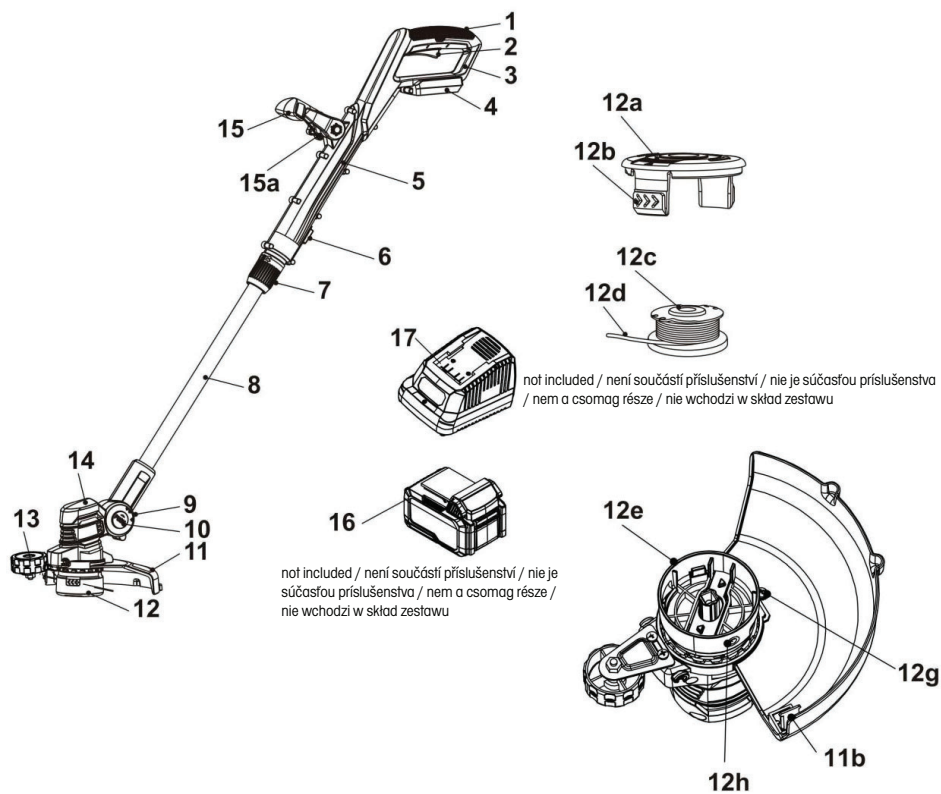

Cordless grass trimmer

USER'S MANUAL

**Thank you for purchasing this garden cordless grass trimmer.
Before you start using it, please read this user manual carefully and save it for future use.**

CONTENTS

1. GENERAL SAFETY REGULATIONS	6
2. SYMBOLS.....	7
3. DESCRIPTION OF THE MACHINE	8
4. ASSEMBLY AND OPERATION	8
5. SAFETY INSTRUCTIONS.....	17
6. TECHNICAL DATA.....	19
7. MAINTENANCE AND STORAGE.....	20
8. TROUBLESHOOTING.....	20
9. DISPOSAL.....	21
10. DECLARATION OF CONFORMITY.....	22

1. GENERAL SAFETY REGULATIONS

Important safety notice

- ✿ Carefully unpack the product and take care not to throw away any part of the packaging until all the product parts have been identified.
- ✿ Store the trimmer in a dry place out of reach of children.
- ✿ Read all warnings and instructions. Failure to comply with the warnings and instructions may lead to electric shock, fire and/or serious injuries.

Packaging

The product's packaging prevents damage during transport. This packaging is a resource and can be recycled.

User manual

Before you start working with your grass trimmer, read the following safety and usage instructions. Get familiar with the controls and correct use of the equipment. Keep the User manual in a safe place where it can be easily found for future use. Save the original packaging, including the internal packing material, guarantee card and proof of purchase receipt for at least the time of the guarantee.

If you need to ship this machine, pack it in the original cardboard box to ensure maximum protection during shipping or transport (e.g. when moving or when you need to send this product for repair).

-  **Note:** If you hand over the appliance to somebody else, do so together with this user's manual. Following the instructions in the included user's manual is a prerequisite for the proper use of the trimmer. The user's manual also contains operating, maintenance, and repair instructions.

The manufacturer assumes no responsibility for accidents or damages arising from failure to comply with these instructions.

2. SYMBOLS



Risk of injury when instructions are not followed.



Danger of injury!

Beware of hurled-away objects.
Keep bystanders away.



Keep other persons in distance!

WARNING! When operating the device, take care that no other persons are nearby (safe distance: 5m). This is particularly valid for children and animals.



Read the Instruction Manual attentively prior to use.



Protect the tool from the damp and never expose it to rain!



Guaranteed sound power level L_{WA} 88 dB (A)



Use ears protective equipment



Use eyes protective equipment

3. DESCRIPTION OF THE MACHINE

Machine description (see fig. 1)

1. Main handle
2. On/off switch
3. Rear safeguard
4. Battery docking port
5. Upper pole
6. Unlock button for angle adjustment
7. Locking sleeve for length adjustment
8. Lower pole
9. Pole support
10. Unlock button for tilt adjustment
 - a. Indicator triangle*
11. Guard
 - a. Screw*
 - b. Knife
 - c. Screw hole*
 - d. Knife protector*
12. Trimmer head
 - a. Cover
 - b. Release latch (x2)
 - c. Trimming spool
 - d. Trimming line
 - e. Housing
 - f. Sliding slot (x2)*
 - g. Release push button
 - h. Eyelet
 - i. Screw hole*
13. Trimming wheel Screw (x2)*
14. Air vents
15. Auxiliary handle
 - a. Lock button
16. Battery pack (not included)
17. Charger (not included)

4. ASSEMBLY AND OPERATION

1. Turn the trimmer head (12) upside down.
2. Align two tips of the guard (11) with the sliding slots (12f) of the trimmer head (12) (Fig. 1, step 1). Fully insert the guard (11) and make sure that the screw holes (11c, 12i) are well aligned.
3. Secure the guard (11) with the screw (11a) in clockwise (Fig. 1, step 2).

Fig. 1

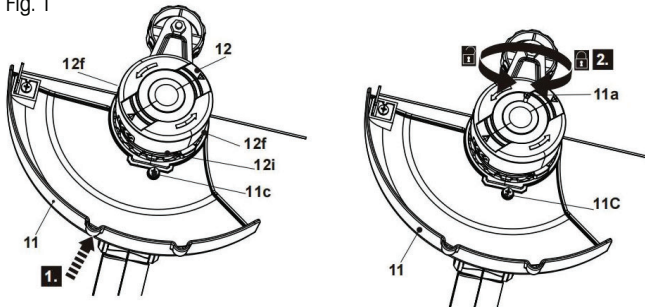

⚠ WARNING!

Never use the trimmer head (12) without the guard (11) properly fitted.

Attaching / releasing the battery pack

- ✿ Align the battery pack (16) with the sliding slots of the battery docking port (4) under the rear safeguard (3) and slide the battery pack in to attach it. Ensure it clicks in place (Fig. 2).
- ✿ Press the release button (16c) and remove the battery pack (16) from the battery docking port (4) (Fig. 3).

Fig. 2

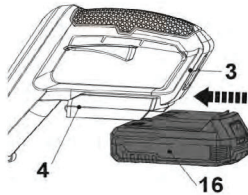
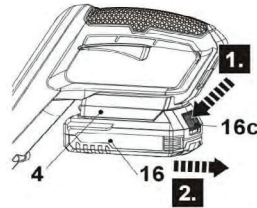

Fig. 3



Charging the battery pack

- ✿ The battery pack (16) for this product has been shipped in a low charge condition.

Auxiliary handle adjustment

Adjust the angle of the auxiliary handle (15) to fit the intended application.

- ✿ Loosen the lock button (15a) in clockwise (Fig.5, step 1), then rotate the auxiliary handle (15) forward or backward to adjust the angle (Fig. 5, step 2).
- ✿ Tight the lock button (15a) in anti- clockwise to secure the auxiliary Length adjustment in position (Fig.5, step 3).

Fig. 5

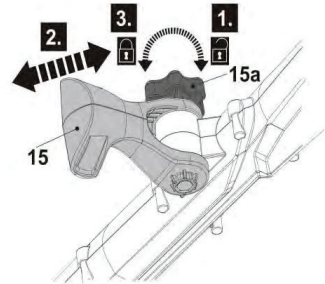

Length adjustment

Adjust the pole length to fit the body length.

- ✿ Loosen the locking sleeve (7) in clockwise (Fig. 6, step 1).
- ✿ Pull the lower pole (8) out or push it together to adjust the desired length (Fig. 6, step2).
- ✿ Tighten the locking sleeve (7) in anticlockwise (Fig. 6, step 3).

Fig. 6



Main handle angle adjustment

Adjust the main handle (1) to either 0° for trimming or 180° for edging.

- ✿ Press down the unlock button (6) and turn the main handle (1) clockwise while holding lower pole (8) to adjust the trimmer head (12) to an angle of 180° (Fig. 7). Release the unlock button (6) and keep turning the main handle (1) until it locks in place. Ensure the unlock button (6) snaps into place.
- ✿ Press down the unlock button (6) and turn the main handle (1) anticlockwise while holding lower pole (8) to adjust the trimmer head (12) to an angle of 0° (Fig. 8). Release the unlock button (6) and keep turning the main handle (1) until it locks in place. Ensure the unlock button (6) snaps into place.

Fig. 7 (initial position 0°)

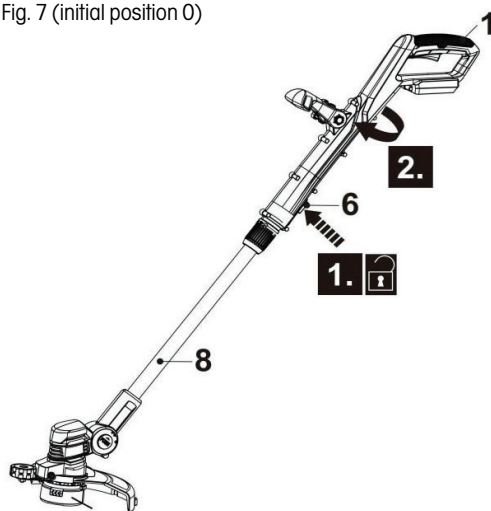
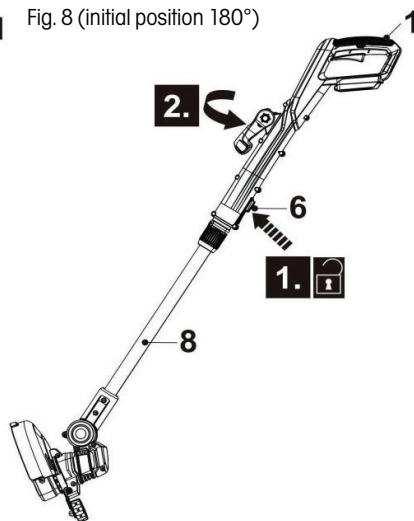

Fig. 8 (initial position 180°)



⚠ WARNING! Always ensure that the unlock button (6) snaps into place after adjusting the main handle in one of the end positions! Never adjust to an intermediate position!

Trimmer head tilt adjustment

Tilt the angle of trimmer head to fit the ground conditions for trimming or edging use by aligning the indicator triangle (10a) on unlock button (10) with one of three indicators of the pole support (9) (Fig. 9).

- ✿ Push the unlock button (10) and hold it in position (Fig.10, step 1).
- ✿ Move the lower pole (8) slightly up or downward (Fig.10, step 2).
- ✿ Release the unlock button (10) and keep moving the lower pole (8) until it locks in place.

Fig. 9

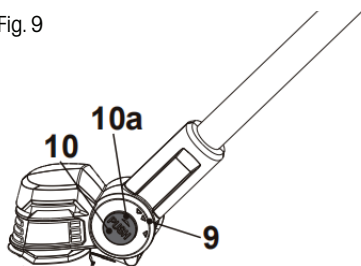
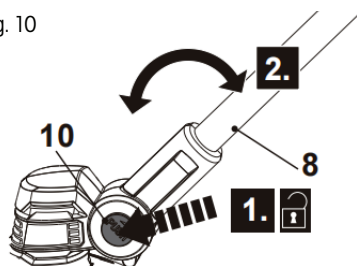

Fig. 10



⚠ WARNING! Always ensure that the unlock button (10) snaps into place after adjusting the trimmer head (12) in one of the required positions! Never adjust to an intermediate position!

Trimmer wheel

- ✿ Use the trimmer wheel (13) to keep distance to obstacles that could be hit by the cutting device.
- ✿ Use the trimmer wheel (13) to cutting the grass at the edges.

Guard

The guard (11) protects the operator against thrown objects during operation. It is equipped with a knife (11b) that cuts the trimming line (12d) (Fig. 13).

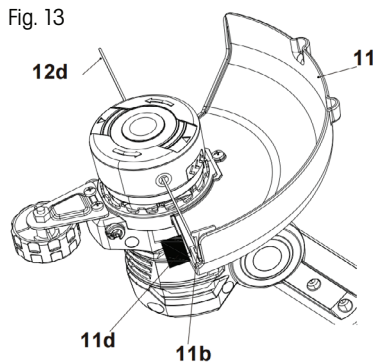

NOTE: Always remove knife protection (11d) before use.

Switching on/off

- ✿ Hold the product with one hand at the auxiliary handle (15) and with the other at the main handle (1).
- ✿ Squeeze the on/off switch (2) to switch the product on (Fig. 14).
- ✿ Release the on/off switch (2) to switch the product off.

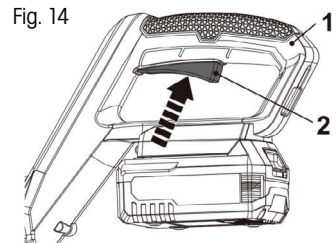

General operation

- ✿ Check the product, its battery pack and charger as well as accessories for damage before each use. Do not use the product if it is damaged or shows wear.
- ✿ Double check accessories or attachments are properly fixed.
- ✿ Always hold the product by its handles. Keep the handles dry to ensure safe support.
- ✿ Ensure that the air vents are always unobstructed and clear. Clean them if necessary with a soft brush. Blocked air vents may lead to overheating and damage the product.
- ✿ Switch the product off immediately if you are disturbed while working by other people entering the working area. Always let the product come to complete stop before putting it down.
- ✿ Do not overwork yourself. Take regular breaks to ensure you can concentrate on the work and have full control over the product.

Trimming

- ✿ Make sure that the knife protector (11d) is removed, the trimming wheel (13) is fixed for use and the battery pack (16) is assembled before operation.
- ✿ Adjust the main handle (1) angle to 0° for trimming.
- ✿ Hold the product firmly with a gap between the product and your right side.
- ✿ Stand upright, do not lean forward and pay attention to posture. Keep both feet apart to help retain your balance.
- ✿ Hold the trimmer head (12) just above the ground at an angle of approximately 30° (Fig. 15).
- ✿ Move the product with a slow regular arc from left to right before moving it back to the starting position before trimming the next area (Fig. 16).

Fig. 15



Fig. 16



- ✿ Ensure the cutting device remains clean and free from off-cuts that may cause it to jam. Check regularly. Release the on/off switch (2) and remove the battery pack (16) before checking.
- ✿ Trim longer grass in stages; do not cut long grass in one cut (Fig. 17). For the best results, cut longer grass in steps (Fig. 18).

Fig. 17

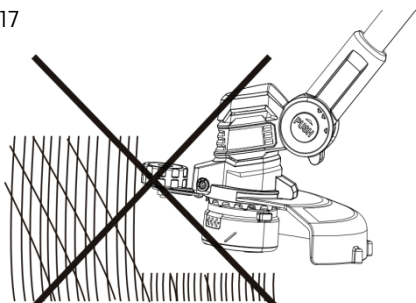
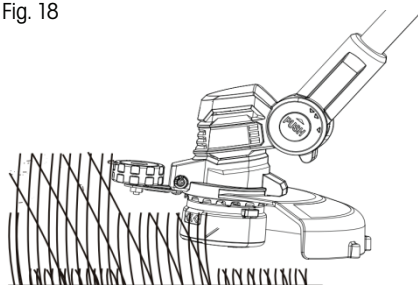

Fig. 18



Edging

- ✿ Make sure that the knife protector (11d) is removed, the trimming wheel (13) is fixed for use and the battery pack (16) is assembled before operation.
- ✿ Adjust the main handle (1) angle to 180° for edging (Fig. 19).

Tips

- ✿ For best results, do not cut wet grass because it tends to stick to the cutting head and guard, prevents proper discharge of grass trimmings, and could cause you to slip and fall.
- ✿ Do not allow the spool cover to drag on the ground or other surfaces.
- ✿ Pay special attention when performing the work close to trees and bushes. The cutting head could damage sensitive bark, and damage fence posts.
- ✿ Use the trimming wheel to trimming / edging position to avoid bringing the cutting device into contact with hard objects such as walls and kerbstones (Figs. 20, 21).

Fig. 19

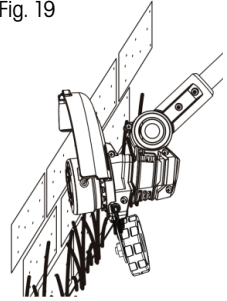

Fig. 20

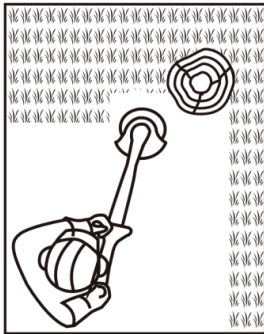
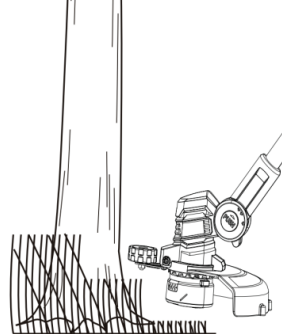



Fig. 21



 **NOTE:** The trimming line will wear faster and require more replacement if cutting is done along sidewalks or other abrasive surfaces or heavier weeds are being cut.

 **NOTE:** While trimming, the cutting device is possible to be blocked by grass or unevenly ground. So the product will turn off automatically due to over current. Therefore release the on/off switch for over 3s and then press down again to go on with trimming.

Line feeding

During use, the tip of the trimming line will get shorter due to wear and the trimming line may break. Regularly check the condition of the trimming line (12d) and adjust if necessary.



WARNING! Always switch the product off, remove the battery pack and let the product cool down before performing inspection, maintenance and cleaning work!

 **NOTE:** This product is equipped with an auto-feed head. Do not bump the trimmer head on the ground as this would damage the product.

Manual feeding

- ✿ Turn trimmer head (12) upside down.
- ✿ Press the release push button (12g) while pulling on the trimming line (12d). The trimming spool (12c) will release the trimming line (Fig. 22).
- ✿ Repeat until the worn part of the trimming line (12d) exceeds the distance to the knife (11b).
- ✿ Attach the battery pack and use the product as described. Excess line will be cut by the knife (11b) and should always remain inside the radius of the guard (11).



WARNING! The trimming line will be throw out! Danger of injury especailly for bystanders!

Auto-feeding

With the product running, release on/off switch (2) to let it stop completely. Press the on/off switch (2) to start the product.

 **NOTE:** The trimming line will extend about 3-5 mm with each stop and start until the line reach the length of the knife. Avoid stop and start frequently as the trimming line may auto-feed unintentionally and causes waste a lot of line.

After use

- ✿ Switch the product off, remove the battery back and let it cool down.
- ✿ Attach the knife protector (11d) if necessary.
- ✿ Check, clean and store the product as described below.

The golden rules for care



WARNING! Always switch the product off, remove the battery pack and let the product cool down before performing inspection, maintenance and cleaning work!

- ✿ Keep the product clean. Remove debris from it after each use and before storage.
- ✿ Regular and proper cleaning will help ensure safe use and prolong the life of the product.
- ✿ Inspect the product before each use for worn and damaged parts. Do not Operate if you find broken and worn parts.

 **WARNING!** Only perform repairs and maintenance work according to these instrustions! All futher works must be performed by a qualified specialist!

General Clean

- ✿ Clean the product with a damp cloth and pH-neutral soap. Use a brush for areas that are hard to reach.
 - ✿ Remove stubborn dust with high pressure air (max. 3 bar).
-  **NOTE:** Do not use chemical, alkaline, abrasive or other aggressive detergents or disinfectants to clean this product as they might be harmful to its surfaces.
- ✿ Check for worn or damaged parts. Replace worn parts as necessary or contact an authorised service centre for repair before using the product again.

Guard

- ✿ Keep the guard (11) clean and free of debris. Remove trimmings.
- ✿ Replace the guard (11) with one of the same type when it is worn or shows damage.

Trimming line

Replace the trimming spool.

Replace the line spool when it is empty or worn.

- ✿ Turn the product upside down to access the trimming line.
- ✿ Hold the trimmer head (12) steady with one hand. Press the release latches (12b) on both sides, then lift the cover (12a) and remove it (Fig. 23).
- ✿ Remove the trimming spool (12c) from the housing (12e) (Fig. 24).

Fig. 23

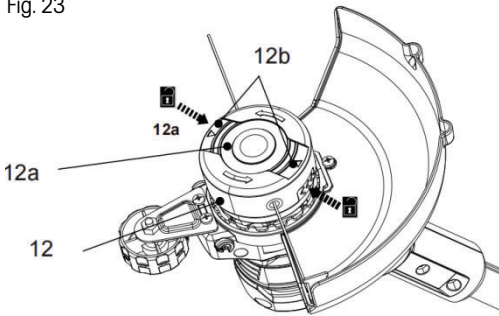
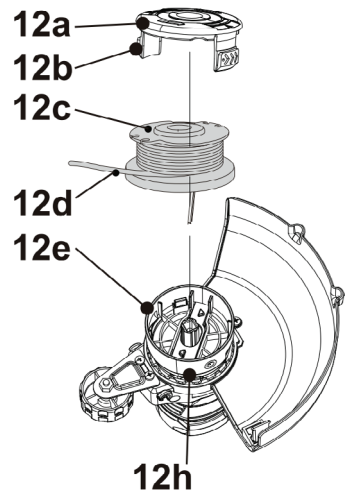
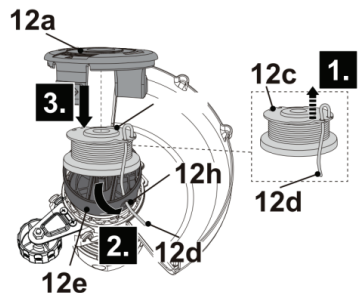

Fig. 24



- ✿ Clean the housing (12e) before inserting a new spool (12c) of the same type.
- ✿ Pull the line from the new spool for a length of approx. 12 cm.
- ✿ Release the trimming line (12d) from the notches and hold it in position. Avoid the trimmer line (12d) scattered from the trimming spool (12c) (Fig. 25, Step 1).
- ✿ Lead the trimming line (12d) ending through the eyelet (12h) of the housing (12e) (Fig. 25, Step 2).
- ✿ Insert the trimming spool (12c) into the housing (12e) (Fig. 25, Step 3). Twist the trimming spool (12c) until it locks into place.
- ✿ Refit the cover (12a) and make sure it snaps into place.

Fig. 25



Refill the trimming line in trimming spool

- ✿ Turn the product upside down to access the trimming line.
- ✿ Hold the trimmer head (12) steady with one hand. Press the release latches (12b) on both sides to remove the cover (12a).
- ✿ Remove the trimming spool (12c) from the housing (12e).
- ✿ Discard all the remaining line (12d) from the trimming spool (12c).
- ✿ Clean the housing (12e) and the trimming spool (12c) .
- ✿ Cut a new 4 m long trimming line with a spool (12c) in direction of the arrows (Fig. 26).
- ✿ Lead one end of the new trimming line (12d) through the small eyelet on the trimming spool (12c) in direction of the arrows (Fig. 26).
- ✿ Pull the trimming line (12d) and bend it over (Fig.27).
- ✿ Wind all the trimming line (12d) firmly around the spool in direction of the arrows on the trimming spool (12c) (Fig. 28).

Fig. 26

Fig. 27

Fig. 28

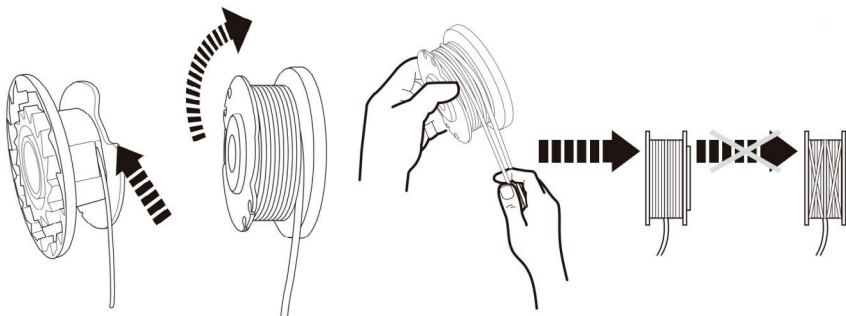

Storage

- ✿ Switch the product off and remove the battery pack.
- ✿ Clean the product as described above.
- ✿ Remove the trimming wheel (13) to storage position if necessary.
- ✿ Store the product and its accessories in a dark,dry,frost-free,well-ventilated place.
- ✿ Always store the product in a place that is inaccessible to children. The ideal storage temperature is between 10 °C and 30 °C.
- ✿ We recommend using the original package for storage or covering the product with a suitable cloth or enclosure to protect it against dust.

Transportation

- ✿ Switch the product off and remove the battery pack.
- ✿ Attach the knife protector (11d) if necessary.
- ✿ Remove the trimming wheel (13) to storage position if necessary.
- ✿ Always carry the product by its handles (1, 15).
- ✿ Protect the product from any heavy impact or strong vibrations which may occur during transportation in vehicles.
- ✿ Secure the product to prevent it from slipping or falling over.

5. SAFETY INSTRUCTIONS

⚠ ATTENTION! Before you start working with your cordless string grass trimmer, read the following safety and usage instructions. Get familiar with the controls and correct use of the equipment. Keep the User manual in a safe place where it can be easily found for future use.

Safety Instruction for your new trimmer

- ✿ Wear protective glasses designed for working with a machine.
- ✿ Wear safety gloves designed for working with a machine.
- ✿ Do not expose the machine to rain or moisture.
- ✿ Get acquainted with operation and correct use of your string trimmer.
- ✿ Do not allow children to operate the trimmer. All persons working with the grass trimmer must well acquainted with the user's manual.
- ✿ Keep other persons (mainly children) and animals out of the trimmer's reach as the cut grass may contain stones or debris. Stop the trimmer if there are children, adults or animals in the vicinity.
- ✿ Keep other persons (particularly children) and animals out of range, at least 15 m from the working area.
- ✿ Work only in sufficient light.
- ✿ Before each use or after a strike, please check for any signs of damage and repair as needed. Do not use the string grass trimmer if damaged or the security is not guaranteed.
- ✿ On regular basis and before each use, please check the trimmer condition (mainly if all screws and nuts are tightened and the safety cover is attached). If the trimmer is not in good condition, it's cannot be used safely.
- ✿ The protective cover must be attached at all times during trimming.
- ✿ Do not use the trimmer if the cover is damaged.
- ✿ Prior to starting the string trimmer, make sure that the nylon cutting edge is not touching the ground, stones or other items.
- ✿ Keep your hands and feet sufficiently apart from the rotating string, mainly after starting the motor.
- ✿ Protect yourself from injuries that may be caused by the rotating string that may be turning for a while after the machine is turned off. After prolonging the string, always return your trimmer to its original working position.
- ✿ Do not use metallic mowing parts for grass trimming.
- ✿ Always use only original spare parts.
- ✿ Disconnect the battery before maintenance or cleaning or if you don't use your trimmer.
- ✿ Always make sure that the ventilation openings are clean.
- ✿ Prevent the trimmer from being started at random. Never carry the trimmer with your finger on the trigger.
- ✿ When operating the trimmer, make sure it's in a safe and stable position.
- ✿ Before starting the trimmer, check the work area and remove wires, stones, debris etc.
- ✿ Do not trim against solid objects. This could lead to injury or damage to the grass trimmer.

⚠ ATTENTION! Mowing parts rotate even after the trimmer is turned off.

- ✿ Do not attempt to stop the string (nylon) with your hand! Let the string run out on its own.
- ✿ Do not use the trimmer to cut grass that doesn't contact the ground such as grass growing on stones, walls etc.
- ✿ Keep off pavement, gravel paths etc. while string is still rotating.

Safety instructions for the battery and charger

Battery

- * Never open the battery.
- * Do not expose the battery to water.
- * Do not throw the battery in fire as there is a risk of explosion!
- * Do not store the battery in locations where the temperature could exceed 40°C.
- * Do not leave the battery in charger if the charging is finished. Otherwise, electrolyte could leak out of the battery.
- * Charge at room temperature only.
- * Use only original charger supplied by the battery.
- * Before charging check that the battery is dry and clean.
- * Use only the battery types approved by the manufacturer.
- * Do not put the battery in common household waste but return it in a battery recycling centre instead.
- * Under extreme conditions there is a risk of the electrolyte leaking out of the battery. If the electrolyte leaks, proceed as follows:
 - Carefully wipe the electrolyte away with a dry cloth. Avoid contact with skin.
 - If contact with skin or eyes does occur, proceed according to the instructions below.
- * The battery contains a 25-30% potassium hydroxide solution, which may be harmful. If contact with the skin occurs, immediately wash with large amounts of water. Neutralise with a mild acid, e.g. lemon juice, vinegar. When eyes are affected, thoroughly rinse with water (for at least 10 minutes) and seek medical attention.

 **NOTE:** The batteries are Li-Ion types. Do not throw the batteries in household waste, fire or water. The batteries must be disposed of in environmentally friendly manner.

Charger

- * Never replace any electric cord, risk of injury could occur!
- * Only use the charger for charging the original batteries supplied with the product. When charging a different battery type there is danger of sudden combustion, serious injury to persons, damage to property.
- * Only two batteries can be charged continuously one after another, otherwise charger overheating might occur. Allow the charger to cool down before a new charging.
- * When the charging process is complete, unplug the charger from the power socket remove the battery.
- * Do not leave the battery in the charger.
- * When carrying the charger, do not hold the cord or the plug. To disconnect the charger from a power socket, do not pull the cord but hold plug instead. Protect the charger from heat and contact with sharp objects.
- * Never charge non-rechargeable batteries.
- * Do not use the charger cord if damaged in any way.
- * Do not expose the charger to water or rain effects and do not use it in wet environment.
- * Do not open the charger.
- * Do not disassemble the charger.
- * Do not use the charger outdoors as it's designed for indoor use only.

6. TECHNICAL DATA

MODEL NO	FZS 70105-0
Rated voltage	18V
Rated no load speed n ₀	8000 min ⁻¹
Cutting width	23 cm
Trimming line	Non-metallic, Ø 1.6 mm, length 4m
Protection class	III
Weight	approx. 1.3 kg
Dimensions	approx. 1100x240x320mm

Accessories

Item number	Accessory
FDUZ 79020	Battery pack 2 Ah
FDUZ 79040	Battery pack 4 Ah
FDUZ 79100	Fast charger
FDUZ 79110	Fast dual charger

The sound values have been determined according to noise test code given in EN 50636-2-91, using the basic standards EN ISO 11201 and EN ISO 3744.

The sound intensity level for the operator may exceed 80 dB(A) and ear protection measures are necessary.

7. MAINTENANCE AND STORAGE

Maintenance

- ✿ When finished, remove the battery from the string trimmer.
- ✿ Only use spare parts and accessories approved by the manufacturer.
- ✿ To keep the trimmer in a perfect condition, please store its parts - coils - in a closeable bag.
- ✿ Disconnect the battery before cleaning. For cleaning, use only a cloth moistened in water (you can also use soap solution). Never immerse the trimmer in water. Never rinse the trimmer under water jet (such as with a garden hose). No water may get inside the machine. Do not clean with a pressure washer.
- ✿ The cutting tool on the cover edges may get blunt over time. We recommend to check the cutting tool sharpness on regular basis.

Storage

- ✿ Store the trimmer in a dry room.
- ✿ Do not place any other items on the machine.
- ✿ At the end of the season, perform a complete inspection of the trimmer and remove accumulated grass clippings.
- ✿ If a repair is necessary, contact an authorised customer service centre or your vendor.

8. TROUBLESHOOTING

Fault/malfunction	Cause	Remedy
Product not running	Battery discharged?	Charge rechargeable battery.
	Battery pack does not sit its place correctly?	Install the battery pack once again.
	Device defective?	Contact service partner.
The tool is vibrating	The tool is clean? There are more grasses accumulated in the line spool and safety guard?	Clean the tool, remove grass in between the line spool and the safety guard.
	Does the Line spool have been installed correctly?	Insert the Line Spool correctly.

9. DISPOSAL



The machine, rechargeable batteries, accessories and packaging should be sorted for environmentally friendly recycling.

Do not dispose of power tools and batteries/rechargeable batteries into household waste!

Only for EC countries:



According to the European Guideline 2012/19/EU, power tools that are no longer usable, and according to the European Guideline 2006/66/EC, defective or used battery packs/batteries, must be collected separately and disposed of in an environmentally correct manner.

INSTRUCTIONS AND INFORMATION ON DISPOSAL OF USED PACKAGING.

Put any used package material to the place determined by the municipality for waste disposal.

DISPOSAL OF USED ELECTRIC AND ELECTRONIC EQUIPMENT

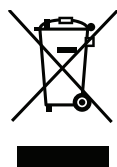

This symbol on products or accompanying documents means that used electric or electronic products must not be put to ordinary municipal waste. Hand over such products to determined collection points for proper disposal, restoration and recycling. Alternatively, in some countries of the European Union or other European countries you can return your products to your local dealer when you buy an equivalent new product. By dutiful disposal of this product you can preserve precious natural resources and you help prevent any potential adverse effects on the environment and human health which could be the results of wrong waste disposal. Ask your local authority or the nearest collection point for additional details. In case of improper disposal of this waste kind penalties can be imposed in accordance with national regulations.

For companies in the European Union countries

Should you want to dispose of electric and electronic devices, ask your dealer or vendor for necessary information..

Disposal in other countries outside the European Union

Should you want to dispose of this product, ask your local authorities or your dealer for necessary information about disposal method.



This product fulfils all basic requirements of the EU directives that apply to it.

Text, design and technical specifications can change without prior notice and we reserve the right for their change.

User manual in the original language.

10. DECLARATION OF CONFORMITY

FAST®

FAST ČR, a.s.
U Sanitasy 1621, 251 01 Říčany, Czech Republic
tel.: +420 323 204 111, fax: +420 323 204 110

EU DECLARATION OF CONFORMITY

Product / brand: Cordless Grass Trimmer / **FIELDMANN**

Type / model: **FZS 70101-0** as factory model L05-001A
DC 18V (battery powered); cutting length 230mm; Class III; IPX0
 $L_{PA} = 68,3 \text{ dB(A)}$; $L_{WA} = 88 \text{ dB(A)}$

Manufacturer: FAST ČR, a.s.
U Sanitasy 1621, 251 01 Říčany, Czech Republic
VAT no: CZ24777749

This declaration of conformity is issued under the sole responsibility of the manufacturer.

The object of the declaration described above is in conformity with the relevant Union harmonization legislation:

Directive MD 2006/42/EC

Directive EMC 2014/30/EU

Directive NEOE 2000/14/EC

Directive RoHS 2011/65/EU

The relevant harmonized standards and the other technical specifications:

EN 60335-1:2012+AC+A11+A13+A1+A14+A2

EN 55014-1:2017+A11

EN 50636-2-91:2014

EN 55014-2:2015

EN 62233:2008+AC



Place of issuance: Prague
Date of issuance: 30. 09. 2022

Name: Petr Uher - Responsible Person
Signature:

FAST FAST ČR, a.s.
U Sanitasy 1621, 251 01 Říčany
tel.: +420 323 204 111
IČO: 247 77 749, DIČ: CZ 247 77 749

IČO: 24777749, DIČ: CZ24777749

Bankovní spojení: Komerční banka Praha 1, č.ú. 89309011/0100, ČSOB Praha 1, č.ú. 8010-0116233383/0300
Česká spořitelna Praha 4, č.ú. 2375682/0800

20V Li-ION
FASTPOWER



 **FIELDMANN**[®]
Home & Garden Performance